

# Section J Index

**DN412 Series**

Flanged and Surface Type Enclosures..... J6

**DFNP, NP, DF Series**

"L" Shaped Back Panel, Standard Back Panel, Allen Bradley Drive Plates & Blank Plates ..... J7

**DSNF and DTSF Series**

Schneider and Toshiba Drive Plates..... J8

**D Series**

AC and Heat Exchanger Plates ..... J9

**DFNCVP, D3R, DHMIN, DWHD DWA and DWTTUP Series**

Drive Fan, Filter & Louver plate, Door HMI Plate, Weather Hood, Blank Adapter & Touch up paint ..... J10

**DRIVE ENCLOSURES**





Carbon Steel with HMI



Stainless Steel with HMI

### Industry Standards

UL 508A & 508E, Types 4/4X, 12, 3R  
 CSA Certified, Types 4/4X, 12, 3R  
 NEMA/EEMAC Types 4/4X, 12, 3R

 UL Fi I e E64791

 CSA Fi I e LL66078

 Recognized Accessories

## FEATURES-SPECIFICATIONS

### Applications

Ultimate Drive Enclosures from Wiegmann are designed to control the environment that

surrounds the Variable Frequency Drive Motor. For use where dirt, dust, oil, water or other contaminants are present, including NEMA 3R and NEMA 4 (hose-down) requirements.

Typical applications include:

- Industrial and Commercial Facilities
- Municipal Infrastructure
- Data Centers
- Irrigation Systems & Pumping Stations
- Water Treatment Plants
- VFD's requiring a wide horsepower range (1-350 HP)

### Features/Benefits

- Exchanging/Fan System), reduces long term operating cost
- Extended range of Temperature Control with just 3 drive enclosure sizes
- UL recognized mounting plates designed for field installation
- Interchangeable Plate System with future adaptability
- Closed Loop System permits high HP drive applications to be used in smaller size enclosure
- System accommodates Allen-Bradley® 750 Series drives plus other manufacturer's drives
- Human-Machine Interface (HMI) interaction

- Built-in Disconnect for short circuit protection
- 80 to 115 Degree F ambient temperature operating range
- Interior and exterior of enclosure with white reflective powder coating provides additional heat reduction
- Sizing Software Program matches user specific needs to exact environmental/enclosure requirements

### Construction

- Enclosure bodies and doors fabricated from 14 gauge carbon steel with 10 gauge side plates and drive plates
- Available in 304 or 316 Stainless Steel
- Continuously welded seams ground smooth and painted
- Grounding studs welded to the door and body assuring a positive ground
- Flange type VFD enclosure mounting brackets of 10 gauge steel
- Surface type VFD enclosures have standard N412C style mounting holes
- Collar studs provided for optional back panel
- Doors sealed with foam-in-place gasket and are provided with 3 point keylocking/padlocking combination handle
- Integral print pocket and hole seal for weep hole application

### Finish

- Interior/Exterior of enclosures with white textured paint to reflect and reduce heat
- Factory installed back panels are unpainted galvanized steel for conductive finish
- Accessory drive plates, AC & heat exchanger plates, blank fan plates, louver plates and HMI enclosures finished in white to match enclosure
- Stainless Steel enclosures with stock brushed finish or white powder coat over SS available.
- Back Panels (L Style and Full)
- Weather Hood in 3 sizes
- Drive Plates for Allen Bradley and other VFD brands
- AC/Heat Exchanger Plates for sidewall mounting of Environmental Control
- Blank Cover Plates available for all enclosure openings
- N412MFK Mounting Foot Kit for surface mount enclosures (N412MFKSS for SS)
- HMI Enclosures for flange and surface mounted enclosures
- Fans, Filters & Louver Plate assemblies
- All mounting hardware and gasketing included with accessories.

**VFD FLANGED STYLE ENCLOSURES**

- A. L-Shaped Drive Sub Panel
- B. Blank Adapter/Sealing Plate
- C. NEMA 4 Hole Seal
- D. Blank Adapter Plate
- E. Adapter Plate for Heat Exchanger
- F. Adapter Plate for AC Unit (3,000 BTU)
- G. Adapter Plate for AC Unit (5,000 BTU)
- H. Adapter Plate for AC Unit (14,000 BTU)
- I. Adapter Plate for Heat Exchanger
- J. Adapter Plate for Heat Exchanger
- K. Drive Weather Hood
- L. Pre Punched Adapter Plates for Multiple VFD Brands
- M. Blank Drive Adapter Plate
- N. NEMA 3R Fan Kit (for Intake or Exhaust)
- O. Fan Cutout Sealing Plate (for Enclosure)
- P. NEMA 3R HMI Enclosure
- Q. NEMA 4 HMI Enclosure
- R. HMI Cutout Sealing Plate
- S. Fan Cutout Sealing Plate (for Door)
- T. NEMA 3R Fan Kit (for Intake or Exhaust)

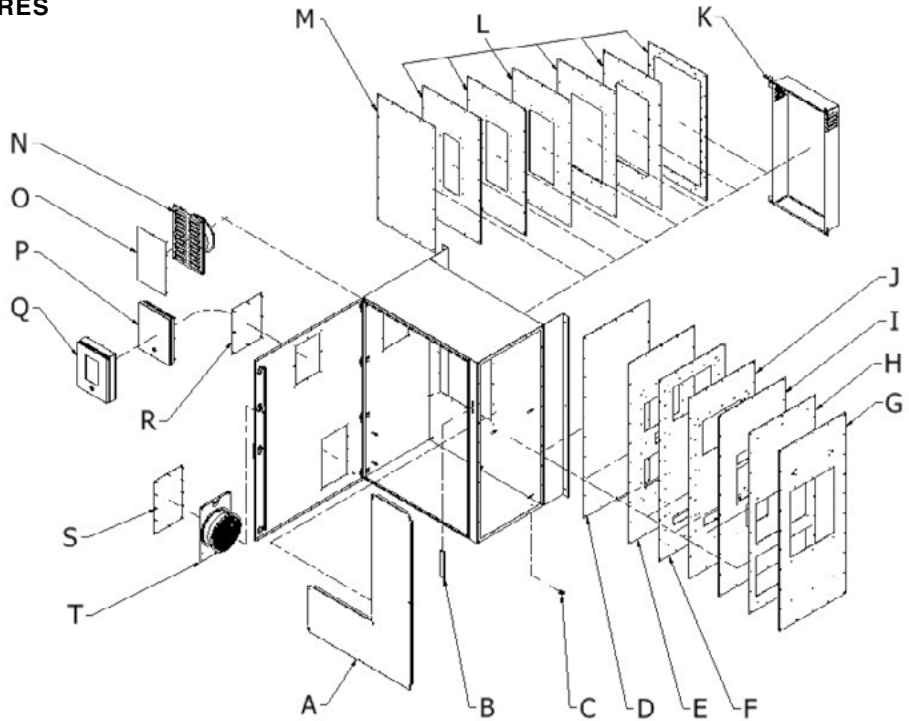

Black denotes standard with drive enclosure.  
Red optional.

**VFD SURFACE STYLE ENCLOSURES**

- A. Drive Sub Panel
- B. Blank Adapter/Sealing Plate
- C. NEMA 4 Hole Seal
- D. Adapter Plate for AC Unit (14,000 BTU)
- E. Adapter Plate for AC Unit (3,000 BTU)
- F. Adapter Plate for AC Unit (5,000 BTU)
- G. Adapter Plate for Heat Exchanger
- H. Adapter Plate for Heat Exchanger
- I. Adapter Plate for Heat Exchanger
- J. Blank Adapter Plate
- K. NEMA 3R Fan Kit (for Intake or Exhaust)
- L. Fan Cutout Sealing Plate (for Enclosure)
- M. NEMA 12 HMI Enclosure
- N. NEMA 4 HMI Enclosure
- O. HMI Cutout Sealing Plate
- P. Fan Cutout Sealing Plate (for Door)
- Q. NEMA 3R Fan Kit (for Intake or Exhaust)

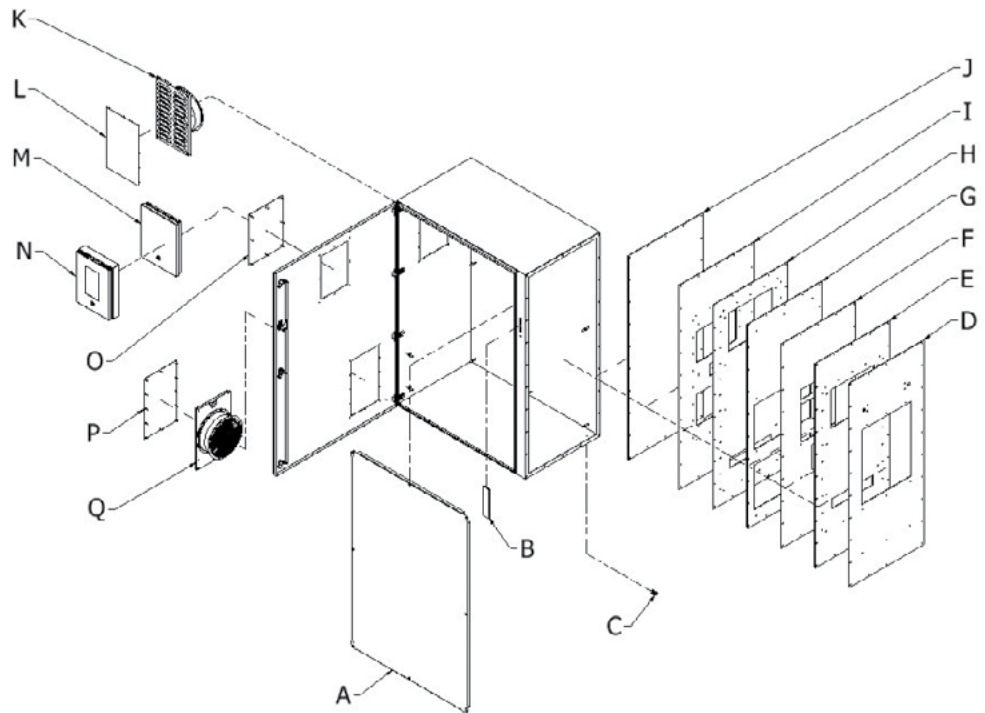

Black denotes standard w/ drive enclosure.  
Red optional.

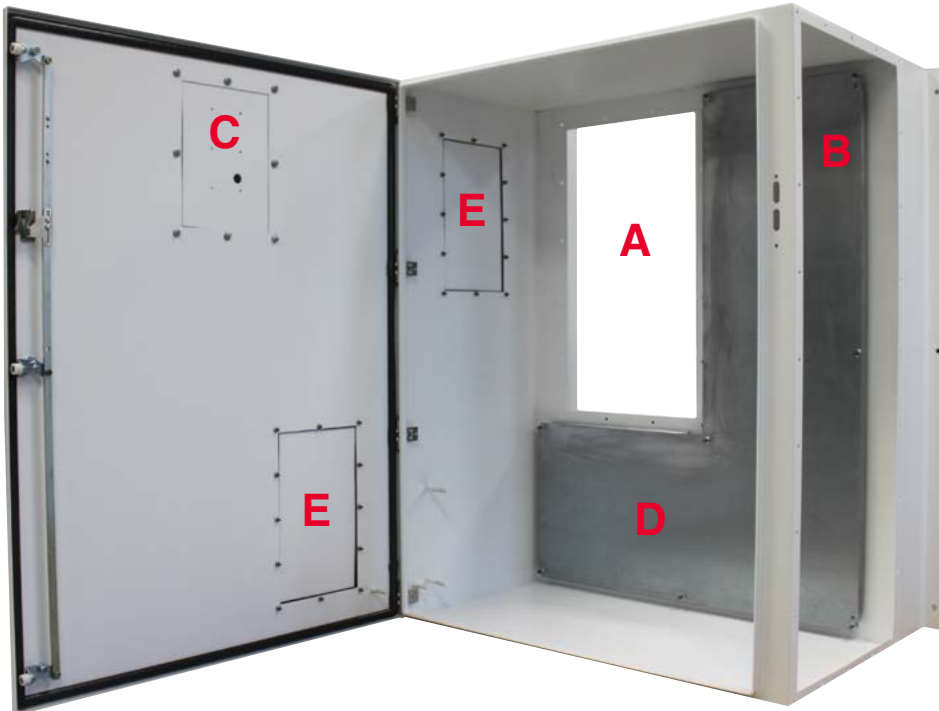

- L - Shaped subpanel with Allen-Bradley® Drive installed.
  - Enclosure shown with cooling unit mounted to right side.
- \*Allen-Bradley® Copyright of Rockwell Automation.

- A** - Opening for flange type enclosure houses multiple sized (flange mounted) VFD's that extend through the back
- B** - Opening for A/C or heat exchanger unit provides 'closed loop' system
- C** - Enclosure door designed for HMI capability
- D** - "L" Shaped subpanel allows installation of flange style VFD's and associated components
- E** - Opening for open loop fan system



**Versatile, Interchangeable & Temp Control**

The Flange Drive Enclosure for external drive motor application. The external drive keeps excess heat on the outside of the cabinet and allows for more useable internal space.



HMI available as optional accessory on Flange and Surface Mounted Drives.



The Surface Mount Drive Enclosure for internal drive motor application. The internal drive mounts directly to back panel of cabinet



## Flange Type Enclosures

House Multiple Sized (flange mounted) VFDs that extend through the back.



### Current Available Drive Plate Brands

- Allen - Bradley
- Schneider
- Toshiba
- Brands to Follow - ABB and Siemens

### DN412CDF SERIES SINGLE DOOR ENCLOSURES

Catalog Number	Body/Door Steel Gauge	Enclosure Size HxWxD	L Style Back Panel Catalog Number	L Type Back Panel Size	Number of Hinges	Mounting Style	Paint Color
DN412363816CDF*†	14/14	36.00 x 38.00 x 16.38 (914 x 965 x 416)	DFNP3636CG	34.2 x 34.2 (869 x 869)	3	FLANGE MTG BRACKETS	WHITE TEXTURE
DN412483819CDF*†	14/14	48.00 x 38.00 x 19.25 (1219 x 965 x 489)	DFNP4836CG	46.2 x 34.2 (1173 x 869)	4	FLANGE MTG BRACKETS	WHITE TEXTURE
DN412523822CDF*†	14/14	52.00 x 38.00 x 22.00 (1321 x 965 x 559)	DFNP5236CG	50.2 x 34.2 (1275 x 869)	4	FLANGE MTG BRACKETS	WHITE TEXTURE

\* Add Suffix SS for Grained Stainless Steel  
 † Consult Factory for 316 Stainless Steel

## Surface Type Enclosures

House Multiple Sized (surface internally mounted) VFDs



### DN412CDS SERIES SINGLE DOOR ENCLOSURES

Catalog Number	Body/Door Steel Gauge	Enclosure Size HxWxD	L Style Back Panel Catalog Number	L Type Back Panel Size	Number of Hinges	Mounting Style	Paint Color
DN412363816CDS*†	14/14	36.00 x 38.00 x 16.38 (914 x 965 x 416)	NP3636CG	34.2 x 34.2 (869 x 869)	3	MOUNTING HOLES	WHITE TEXTURE
DN412483819CDS*†	14/14	48.00 x 38.00 x 19.25 (1219 x 965 x 489)	NP4836CG	46.2 x 34.2 (1173 x 869)	4	MOUNTING HOLES	WHITE TEXTURE
DN412523822CDS*†	14/14	52.00 x 38.00 x 22.00 (1321 x 965 x 559)	NP5236CG	50.2 x 34.2 (1275 x 869)	4	MOUNTING HOLES	WHITE TEXTURE

\* Add Suffix SS for Grained Stainless Steel  
 † Consult Factory for 316 Stainless Steel

**ULTIMATE DRIVE ENCLOSURES**

**"L" SHAPED DRIVE ENCLOSURE BACK PANELS**

Catalog Number	Steel Gauge	Description	L Type Back Panel Size	Galvanized
DFNP3636CG	12	"L" SHAPED GALVANIZED PANEL	34.2X34.2 (869X869)	NO PAINT
DFNP4836CG	12	"L" SHAPED GALVANIZED PANEL	46.2X34.2 (1173X869)	NO PAINT
DFNP5236CG	12	"L" SHAPED GALVANIZED PANEL	50.2X34.2 (1275X869)	NO PAINT

**STANDARD DRIVE ENCLOSURE BACK PANELS**

Catalog Number	Steel Gauge	Description	L Type Back Panel Catalog Number	Galvanized
NP3636CG	12	STD GALVANIZED FLANGED PANEL	34.2X34.2 (869X869)	NO PAINT
NP4836CG	12	STD GALVANIZED FLANGED PANEL	46.2X34.2 (1173X869)	NO PAINT
NP5236CG	12	STD GALVANIZED FLANGED PANEL	50.2X34.2 (1275X869)	NO PAINT

**Drive Plates**

The standardized pattern allows for an interchangeable system to accommodate many manufacturers VFDs.

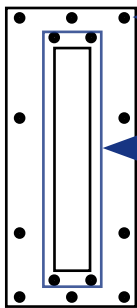

Standardized Punch Pattern For Bolting to Enclosure

Punch Pattern Installed for Specific VFD with Heat Sink

Blank Plates Available for Custom Installations

**Wiegmann Ultimate® Drive Selector Software**

The selector software makes it easy to match specific user needs to exact environmental and enclosure requirements.

GO TO  
[www.hubbell-wiegmann.com](http://www.hubbell-wiegmann.com)  
FOR SIZING SOFTWARE

**ALLEN-BRADLEY® ACCESSORY DRIVE PLATES\* & BLANK PLATES\*\***

Carbon Steel Catalog Number	Stainless Steel† Catalog Number	Description	HP/Punching	750 Allen Bradley Series
DF36CVP	DF36CVPSS	BLANK DRIVE PLATE	BLANK (includes mounting holes)	**See Note Below
DF36CVPF2	DF36CVPF2SS	DRIVE FRAME SIZE 2	1-15HP	750 AC DRIVE (AB)
DF48CVP	DF48CVPSS	BLANK DRIVE PLATE	BLANK (includes mounting holes)	**See Note Below
DF48CVPF2	DF48CVPF2SS	DRIVE FRAME SIZE 2	1-15HP	750 AC DRIVE (AB)
DF48CVPF3	DF48CVPF3SS	DRIVE FRAME SIZE 3	20-30HP	750 AC DRIVE (AB)
DF48CVPF4	DF48CVPF4SS	DRIVE FRAME SIZE 4	40-50HP	750 AC DRIVE (AB)
DF48CVPF5	DF48CVPF5SS	DRIVE FRAME SIZE 5	60-70HP	750 AC DRIVE (AB)
DF48CVPF6	DF48CVPF6SS	DRIVE FRAME SIZE 6	100-150HP	750 AC DRIVE (AB)
DF52CVP	DF52CVPSS	BLANK DRIVE PLATE	BLANK (includes mounting holes)	**See Note Below
DF52CVPF2	DF52CVPF2SS	DRIVE FRAME SIZE 2	1-15HP	750 AC DRIVE (AB)
DF52CVPF3	DF52CVPF3SS	DRIVE FRAME SIZE 3	20-30HP	750 AC DRIVE (AB)
DF52CVPF4	DF52CVPF4SS	DRIVE FRAME SIZE 4	40-50HP	750 AC DRIVE (AB)
DF52CVPF5	DF52CVPF5SS	DRIVE FRAME SIZE 5	60-70HP	750 AC DRIVE (AB)
DF52CVPF6	DF52CVPF6SS	DRIVE FRAME SIZE 6	100-200HP	750 AC DRIVE (AB)
DF52CVPF7	DF52CVPF7SS	DRIVE FRAME SIZE 7	250-350HP	750 AC DRIVE (AB)

\*Stock Drive Plate accommodates Allen-Bradley PowerFlex 750 Series AC Drives

\*\*Blank Plate available which can be modified for use with other brands.

†Consult factory for 316 stainless steel

ULTIMATE DRIVE ENCLOSURES

SCHNEIDER\* ACCESSORY DRIVE PLATES\*\*

Carbon Steel Catalog Number	Stainless Steel† Catalog Number	Description	HP/Punching	Schneider Driver Series
DSNF48CVPF5B	DSNF48CVPF5BSS	48" SCHNEIDER DRIVE PLATE	20-25HP	ATV71 / ATV61
DSNF48CVPF6	DSNF48CVPF6SS	48" SCHNEIDER DRIVE PLATE	30HP	ATV71 / ATV61
DSNF48CVPF5A	DSNF48CVPF5ASS	48" SCHNEIDER DRIVE PLATE	15HP	ATV71 / ATV61
DSNF48CVPF4	DSNF48CVPF4SS	48" SCHNEIDER DRIVE PLATE	7.5-10HP	ATV71 / ATV61
DSNF48CVPF3	DSNF48CVPF3SS	48" SCHNEIDER DRIVE PLATE	4-5HP	ATV71 / ATV61
DSNF48CVPF2	DSNF48CVPF2SS	48" SCHNEIDER DRIVE PLATE	1-3HP	ATV71 / ATV61
DSNF52CVPF2	DSNF52CVPF2SS	52" SCHNEIDER DRIVE PLATE	1-3HP	ATV71 / ATV61
DSNF52CVPF3	DSNF52CVPF3SS	52" SCHNEIDER DRIVE PLATE	4-5HP	ATV71 / ATV61
DSNF52CVPF4	DSNF52CVPF4SS	52" SCHNEIDER DRIVE PLATE	7.5-10HP	ATV71 / ATV61
DSNF52CVPF5A	DSNF52CVPF5ASS	52" SCHNEIDER DRIVE PLATE	15HP	ATV71 / ATV61
DSNF52CVPF5B	DSNF52CVPF5BSS	52" SCHNEIDER DRIVE PLATE	20-25HP	ATV71 / ATV61
DSNF52CVPF6	DSNF52CVPF6SS	52" SCHNEIDER DRIVE PLATE	30HP	ATV71 / ATV61
DSNF52CVPF7A	DSNF52CVPF7ASS	52" SCHNEIDER DRIVE PLATE	40-50HP	ATV71 / ATV61
DSNF52CVPF8	DSNF52CVPF8SS	52" SCHNEIDER DRIVE PLATE	60-100HP	ATV71 / ATV61
DSNF52CVPF9	DSNF52CVPF9SS	52" SCHNEIDER DRIVE PLATE	125-150HP	ATV71 125HP Only /ATV61 125-150HP

\*Stock Drive Plates above accommodate Schneider Drives ATV 71 & 61 without choke.

\*\*Blank Plate available which can be modified for use with other brands.

†Consult factory for 316 stainless steel

TOSHIBA ACCESSORY DRIVE PLATES\*\*

Carbon Steel Catalog Number	Stainless Steel† Catalog Number	Description	HP(kW)/Punching	Voltage
DTSF48CVPF2	DTSF48CVPF2SS	48" DRIVE PLATE -TOSVERT VFAS1	0.5 - 2HP (0.37 - 1.5)	230
			1 - 3HP (0.75 - 2.2)	460
DTSF48CVPF3	DTSF48CVPF3SS	48" DRIVE PLATE -TOSVERT VFAS1	3 - 5HP (2.2 - 4)	230
			5HP (4)	460
DTSF48CVPF4	DTSF48CVPF4SS	48" DRIVE PLATE -TOSVERT VFAS1	7.5HP (5.5)	230
			7.5 - 10HP (5.5 - 7.5)	460
DTSF48CVPF5A	DTSF48CVPF5ASS	48" DRIVE PLATE -TOSVERT VFAS1	10HP (7.5)	230
			15HP (11)	460
DTSF48CVPF5B	DTSF48CVPF5BSS	48" DRIVE PLATE -TOSVERT VFAS1	15 - 20HP (11 - 15)	230
			20 - 25HP (15 - 18)	460
DTSF48CVPF6	DTSF48CVPF6SS	48" DRIVE PLATE -TOSVERT VFAS1	25 - 30HP (18 - 22)	230
			30HP (22)	460
DTSF52CVPF2	DTSF52CVPF2SS	52" DRIVE PLATE -TOSVERT VFAS1	0.5 - 2HP (0.37 - 1.5)	230
			1 - 3HP (0.75 - 2.2)	460
DTSF52CVPF3	DTSF52CVPF3SS	52" DRIVE PLATE -TOSVERT VFAS1	3 - 5HP (2.2 - 4)	230
			5HP (4)	460
DTSF52CVPF4	DTSF52CVPF4SS	52" DRIVE PLATE -TOSVERT VFAS1	7.5HP (5.5)	230
			7.5 - 10HP (5.5 - 7.5)	460
DTSF52CVPF5A	DTSF52CVPF5ASS	52" DRIVE PLATE -TOSVERT VFAS1	10HP (7.5)	230
			15HP (11)	460
DTSF52CVPF5B	DTSF52CVPF5BSS	52" DRIVE PLATE -TOSVERT VFAS1	15 - 20HP (11 - 15)	230
			20 - 25HP (15 - 18)	460
DTSF52CVPF6	DTSF52CVPF6SS	52" DRIVE PLATE -TOSVERT VFAS1	25 - 30HP (18 - 22)	230
			30HP (22)	460
DTSF52CVPF7A	DTSF52CVPF7ASS	52" DRIVE PLATE -TOSVERT VFAS1	40 - 50HP (30 - 37)	460
DTSF52CVPF7B	DTSF52CVPF7BSS	52" DRIVE PLATE -TOSVERT VFAS1	40 - 60HP (30 - 45)	230
DTSF52CVPF9	DTSF52CVPF9SS	52" DRIVE PLATE -TOSVERT VFAS1	60 - 100HP (45 - 75)	460

\*\*Blank Plate available which can be modified for use with other brands.

†Consult factory for 316 stainless steel

**AC PLATE (shown) FAN PLATES AVAILABLE**

The standardized pattern allows for an interchangeable and versatile system.

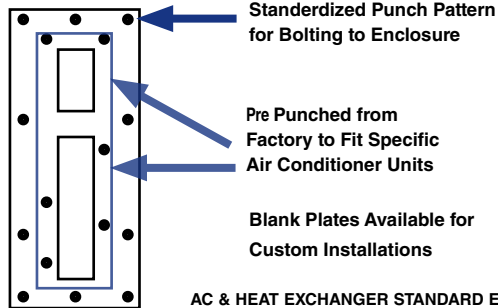

**Wiegmann Ultimate® Drive Selector Software**

The selector software makes it easy to match specific user needs to exact environmental and enclosure requirements.

GO TO  
[www.hubbell.com/wiegmann/en](http://www.hubbell.com/wiegmann/en)  
FOR SIZING SOFTWARE

**AC & HEAT EXCHANGER STANDARD ENVIRONMENTAL PLATES\*\***

Catalog Number	Description	BTU / Heat Ex	Paint Color
D36CVP	36 BLANK AC / HEAT EX PLATE	BLANK (includes mounting holes)	**See Note Below
D36CVPKN34C3DP24	36 PUNCHED AC PLATE	3,000 BTU	WHITE TEXTURE
D36CVPKNHX32	36 PUNCHED HEAT EX PLATE	WATTS/F 21	WHITE TEXTURE
D48CVP	48 BLANK AC / HEAT EX PLATE	BLANK (includes mounting holes)	**See Note Below
D48CVPKN34C3DP24	48 PUNCHED AC PLATE	3,000 BTU	WHITE TEXTURE
D48CVPK3N4C5DP38	48 PUNCHED AC PLATE	5,000 BTU	WHITE TEXTURE
D48CVPKNHX32	48 PUNCHED HEAT EX PLATE	WATTS/F 21	WHITE TEXTURE
D52CVP	52 BLANK AC / HEAT EX PLATE	BLANK (includes mounting holes)	**See Note Below
D52CVPKN34C3DP24	52 PUNCHED AC PLATE	3,000 BTU	WHITE TEXTURE
D52CVPK3N4C5DP38	52 PUNCHED AC PLATE	5,000 BTU	WHITE TEXTURE
D52CVPK36C14DP50	52 PUCHED AC PLATE	14,000 BTU	WHITE TEXTURE
D52CVPKNHX32	52 HEAT EX PLATE	WATTS/F 21	WHITE TEXTURE
D52CVPKNHX38	52 HEAT EX PLATE	WATTS/F 44	WHITE TEXTURE
D52CVPKNHX47	52 HEAT EX PLATE	WATTS/F 54	WHITE TEXTURE

\*Stock Drive Plate accomadates Allen-Bradley PowerFlex 750 Series AC Drives  
\*\*Blank Plate available which can be modified for use with other brands.

**STAINLESS STEEL AC & HEAT EXCHANGER ENVIRONMENTAL PLATES\***

Catalog Number	Description	BTU / Heat Ex	Stainless Steel
D36CVPSS	36 BLANK AC / HEAT EX PLATE	BLANK (includes mounting holes)	**See Note Below
D36CVP34C3DP24SS	36 PUNCHED AC PLATE	3,000 BTU	GRAINED SS
D36CVPHX32SS	36 PUNCHED HEAT EX PLATE	WATTS/F 21	GRAINED SS
D48CVPSS	48 BLANK AC / HEAT EX PLATE	BLANK (includes mounting holes)	**See Note Below
D48CVP34C3DP24SS	48 PUNCHED AC PLATE	3,000 BTU	GRAINED SS
D48CVP34C5DP38SS	48 PUNCHED AC PLATE	5,000 BTU	GRAINED SS
D48CVPHX32SS	48 PUNCHED HEAT EX PLATE	WATTS/F 21	GRAINED SS
D52CVPSS	52 BLANK AC / HEAT EX PLATE	BLANK (includes mounting holes)	**See Note Below
D52CVP34C3DP24SS	52 PUNCHED AC PLATE	3,000 BTU	GRAINED SS
D52CVP34C5DP38SS	52 PUNCHED AC PLATE	5,000 BTU	GRAINED SS
D52CVP36C14DP50SS	52 PUCHED AC PLATE	14,000 BTU	GRAINED SS
D52CVPHX32SS	52 HEAT EX PLATE	WATTS/F 21	GRAINED SS
D52CVPHX38SS	52 HEAT EX PLATE	WATTS/F 44	GRAINED SS
D52CVPHX47SS	52 HEAT EX PLATE	WATTS/F 54	GRAINED SS

\*Stock Drive Plate accomadates Allen-Bradley PowerFlex 750 Series AC Drives  
\*\*Blank Plate available which can be modified for use with other brands.



**ULTIMATE DRIVE ENCLOSURES**

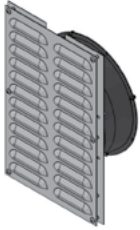

**DRIVE FAN, FILTER & LOUVER PLATE ASSEMBLIES**

Catalog Number	Body/Door Steel Gauge	Description	Hood Size	Paint Color
DFNCVP*†	10	BLANK FAN CUTOOUT COVER PLATE	15.31 X 9.50	WHITE TEXTURE
D3R10FN*†	N/A	FAN, FILTER, LOUVER ASSEMBLY	15.31 X 9.50 LOUVER	WHITE TEXTURE
D3RFN*†	N/A	FILTER & LOUVER ASSEMBLY ONLY	15.31 X 9.50 LOUVER	WHITE TEXTURE

\* Add Suffix SS for Grained Stainless Steel  
 † Consult Factory for 316 Stainless Steel

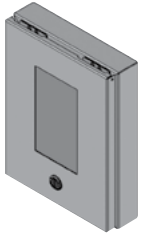

**DOOR HMI PLATE & ENCLOSURES**

Catalog Number	Body/Door Steel Gauge	Description	Hood Size	Paint Color
DHMICVP*†	10	BLANK HMI COVER PLATE	13.00 X 10.00 (330 X 254)	WHITE TEXTURE
DHMIN3R*†	14	N12/3R DOOR HMI ENCLOSURE	13.00 X 10.00 X 1.63 (330 X 254 X 41)	WHITE TEXTURE
DHMIN4*†	14	N4 DOOR HMI ENCLOSURE	13.00 X 10.00 X 2.00 (330 X 254 X 51)	WHITE TEXTURE

\* Add Suffix SS for Grained Stainless Steel  
 † Consult Factory for 316 Stainless Steel

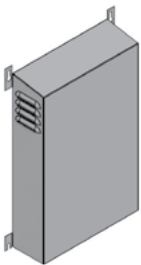

**N3R-DRIVE WEATHER HOOD**

Catalog Number	Body/Door Steel Gauge	Description	Hood Size HxWxD	Paint Color
D36WHD*†	10	36" WEATHER HOOD	21.75 x 10.91 x 5	WHITE TEXTURE
D48WHD*†	14	48" WEATHER HOOD	30.25 x 17.41 x 5	WHITE TEXTURE
D52WHD*†	14	52" WEATHER HOOD	36.25 x 19.41 x 5	WHITE TEXTURE

\* Add Suffix SS for Grained Stainless Steel  
 † Consult Factory for 316 Stainless Steel



**BLANK ADAPTER / SEALING PLATE**

Catalog Number	Description	Size H x W x D	Finish
DWA3456BAP*†	BLANK ADAPTER / SEALING PLATE	1.25 X 2.75	WHITE TEXTURE

\* Add Suffix SS for Grained Stainless Steel  
 † Consult Factory for 316 Stainless Steel



**DRIVE ENCLOSURE TOUCH UP PAINT**

Catalog Number	Description	Quantity	Paint Color
DWTUP	TOUCH-UP PAINT DRIVE ENCLOSURE TEXTURE	12 OZ. SPRAY CAN	WHITE TEXTURE

**ENCLOSURE ENVIRONMENTAL CONTROL**

When components made to perform electro-technical tasks are confined within an enclosure, the topic of heat loss should be considered. Fluctuations in ambient temperatures and environmental conditions can considerably reduce the service life of electronic components.

**BASIC COOLING METHODS**

**FORCED-AIR FAN COOLING**

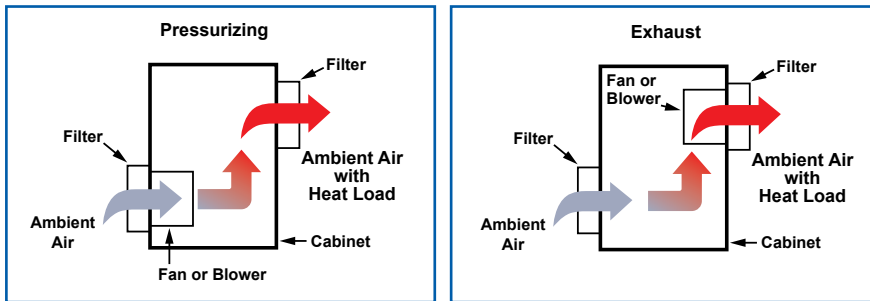

If the installation will be in a clean, non-hazardous environment with an acceptable ambient (outside the enclosure) temperature range, a simple forced-air cooling system utilizing outside air is usually adequate. Combined with an air filter, such devices generally meet the heat removal needs of typical electronic equipment and many electrical applications.

**CLOSED-LOOP AC COOLING**

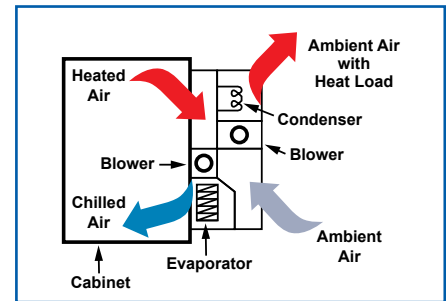

Used for more demanding temperature and hazardous environments. Closed-loop cooling consists of two separate circulation systems. One system seals out the ambient air and recirculates clean cool air throughout the enclosure. The second system uses ambient air or water to remove and discharge the heat.

**YOU CAN PUT IT ALL TOGETHER FROM STOCK!**

**Wiegmann Ultimate® Drive Selector Software**

The selector software makes it easy to match specific user needs to exact environmental and enclosure requirements.

Selecting attributes generates an **'Ordering Code'** that is provided to a Wiegmann Representative or directly to the factory.

The Ordering Code is then translated to: DRIVE SYSTEM PART NUMBERS & BILL OF MATERIALS, with PRICING provided and ENGINEERED DRAWINGS if required.

**GO TO**  
[www.hubbell.com/wiegmann/en](http://www.hubbell.com/wiegmann/en)  
**FOR SIZING SOFTWARE**

Drive Power (HP):	125	
Mounting Type:	<input type="radio"/> Surface	<input checked="" type="radio"/> Flange
Location:	<input checked="" type="radio"/> Outdoor	<input type="radio"/> Indoor
Rating:	<input type="radio"/> NEMA 3R	<input checked="" type="radio"/> NEMA 4
System:	<input type="radio"/> Open	<input checked="" type="radio"/> Closed
Ambient Temp:	110	
Internal Temp:	104	
Line Reactors:	2	
Transformer, VA:	100	
HMI:	<input checked="" type="radio"/> Yes	<input type="radio"/> No
Hood:	<input checked="" type="radio"/> Yes	<input type="radio"/> No
Heater:	<input type="radio"/> Yes	<input checked="" type="radio"/> No
<input type="button" value="Generate Code"/>		

Ordering Code:  
**D-N4-46-F-CT100-2LR125HP-A110-1104-HMI-HOOD-460-3KAC**

**QUICK LOCATOR TO PRODUCTS IN THIS DOCUMENT & WEB**

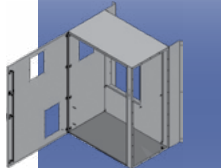
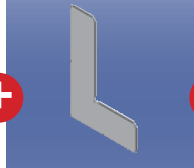
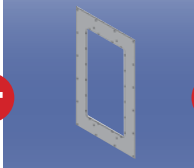
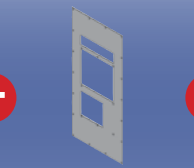
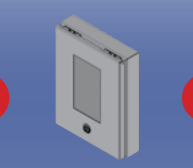
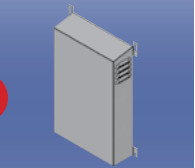
<p><b>DRIVE ENCLOSURE</b></p>  <p>Flange Mount Page J?  Surface Mount Page J?</p>	+	<p><b>BACK PANEL</b></p>  <p>"L" and Standard Back Panels Page J?  "Exclusively Included with Enclosure"</p>	+	<p><b>DRIVE PLATE</b></p>  <p>Accessory Drive Plates Page J?</p>	+	<p><b>AC PLATE or FAN APPLICATION</b></p>  <p>Flange Mount Page J? (Drive Selector Software)</p>	+	<p><b>HMI ENCLOSURE OPTION</b></p>  <p>Operator Interface Page J? Stainless Steel Available</p>	+	<p><b>WEATHER HOOD</b></p>  <p>Flange Type Drive Protection Page J?</p>
--	---	---	---	---	---	--	---	--	---	--

