

Why use this version:

- Allow connection direct to the main conductor without the need of bails or stirrups
- Easy to install and remove without damaging the conductor
- Robust extruded Aluminum body construction provides excellent conductivity
- Stainless steel eye bolt ensures maximum safety and efficiency during installation

Selling Points:

- Range taking
- Tin Plating options available
- High strength aluminum and Stainless-steel eye bolt
- Clamp wedge design
- Meets ANSI C119.4
- Variety of options

Benefits

- Reduced inventory
- Suitable for aluminum and copper conductors
- Robust design construction with excellent conductivity
- Wedge design maximizes connecting force with min damage to conductor
- Tested for reliability
- Angled and Straight taps

Key Competitors:

- Utilco
- Alcon Inc.
- Aluma-Form
- AFL

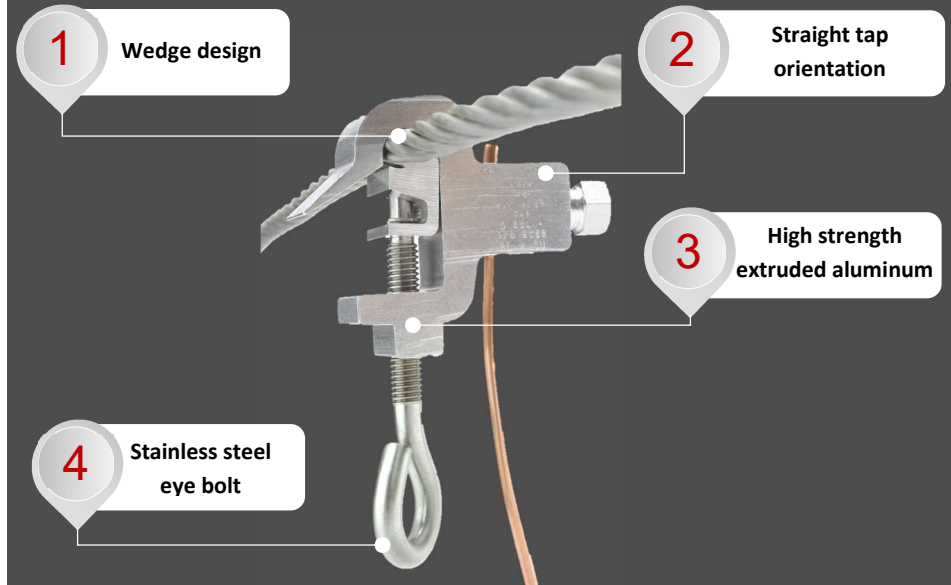

Angled Series

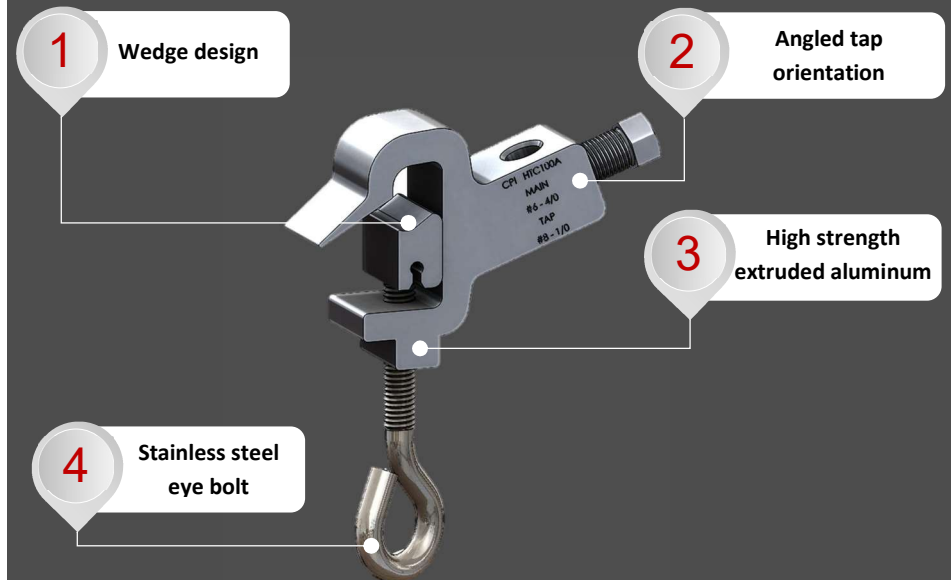



Hot Line Clamps

Model	Type	Conductor Range – Main		Conductor Range - Tap	
		Conductor	Diameters	Conductor	Diameters
HTC100	HTC Straight	#6 Sol. - 4/0 - ACSR	0.162" - 0.563"	#8 Sol - 1/0 - ACSR	0.128" - 0.398"
HTC100-4	HTC Straight	#6 Sol. - 4/0 - ACSR	0.162" - 0.563"	#8 Sol - 4/0 - ACSR	0.128" - 0.563"
HTC200	HTC Straight	2/0 AAC - 556.5kcmil - AAC	0.414" - 0.858"	#8 Sol - 2/0 - ACSR	0.128" - 0.447"
HTC200-4	HTC Straight	2/0 AAC - 556.5kcmil - AAC	0.414" - 0.858"	#8 Sol - 4/0 - ACSR	0.128" - 0.563"
HTC300	HTC Straight	4/0 AAC - 954kcmil - AAC	0.522" - 1.125"	#8 Sol - 4/0 - ACSR	0.128" - 0.563"
HTC100-4A	HTC Angled	#6 Sol. - 4/0 - ACSR	0.162" - 0.563"	#8 Sol - 4/0 - ACSR	0.128" - 0.563"
HTC100A	HTC Angled	#6 Sol. - 4/0 - ACSR	0.162" - 0.563"	#8 Sol - 1/0 - ACSR	0.128" - 0.398"
HTC200A	HTC Angled	2/0 AAC - 556.5kcmil - AAC	0.414" - 0.858"	#8 Sol - 2/0 - ACSR	0.128" - 0.447"
HTC212A	HTC Angled	#6 Sol. - 636kcmil - AAC	0.162" - 0.905"	#8 Sol - 266.8kcmil - AAC	0.128" - 0.593"
HTC300-2	HTC Angled	4/0 AAC - 954kcmil - AAC	0.522" - 1.125"	#8 Sol - #2 - AAC	0.128" - 0.292"
HTC300A	HTC Angled	4/0 AAC - 954kcmil - AAC	0.522" - 1.125"	#8 Sol - 4/0 - ACSR	0.128" - 0.563"

Available Options:

- Add suffix **"R"** to add full radius edges for transmission applications.
- Add suffix **"E"** to replace tap bolt with 1/2" eyebolt.
- Add suffix **"T"** for Tin Plating.

