



# DPL Series

PHOTOLUMINESCENT EXIT SIGNAGE

Exit compliance with UL Listed legible viewing distances of 50', 75' and 100'

®

[WWW.DUAL-LITE.COM](http://WWW.DUAL-LITE.COM)





**DPLAF**  
[Aluminum Frame]



**DPLP**  
[ABS Thermoplastic]

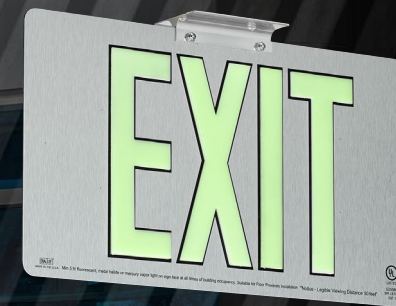

**DPLPM**  
[Poly-Metal]



**DPLA**  
[Acrylic]

Application Note: Install photoluminescent exit signs only in locations where an external illumination source is present, is deemed reliable, and is supplied by a circuit not controlled by automatic timers or sensors, and where controls are accessible only to authorized personnel. A minimum of 5 foot-candle(54lux) external illumination of unfiltered metal halide, fluorescent, mercury vapor or LED charging light sources required on sign face at all times of building occupancy.



# DPLAF

# DPLP



Red or green letters with a photo-luminescent background



Includes an aluminum mounting bracket in matte finish

- Can be ceiling, end or surface mounted for indoor use only
- Available in single or double face
- Can be mounted over exit doorways, or for low-level exit illumination

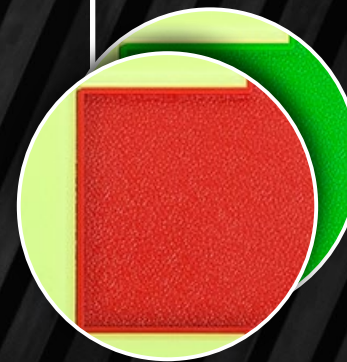
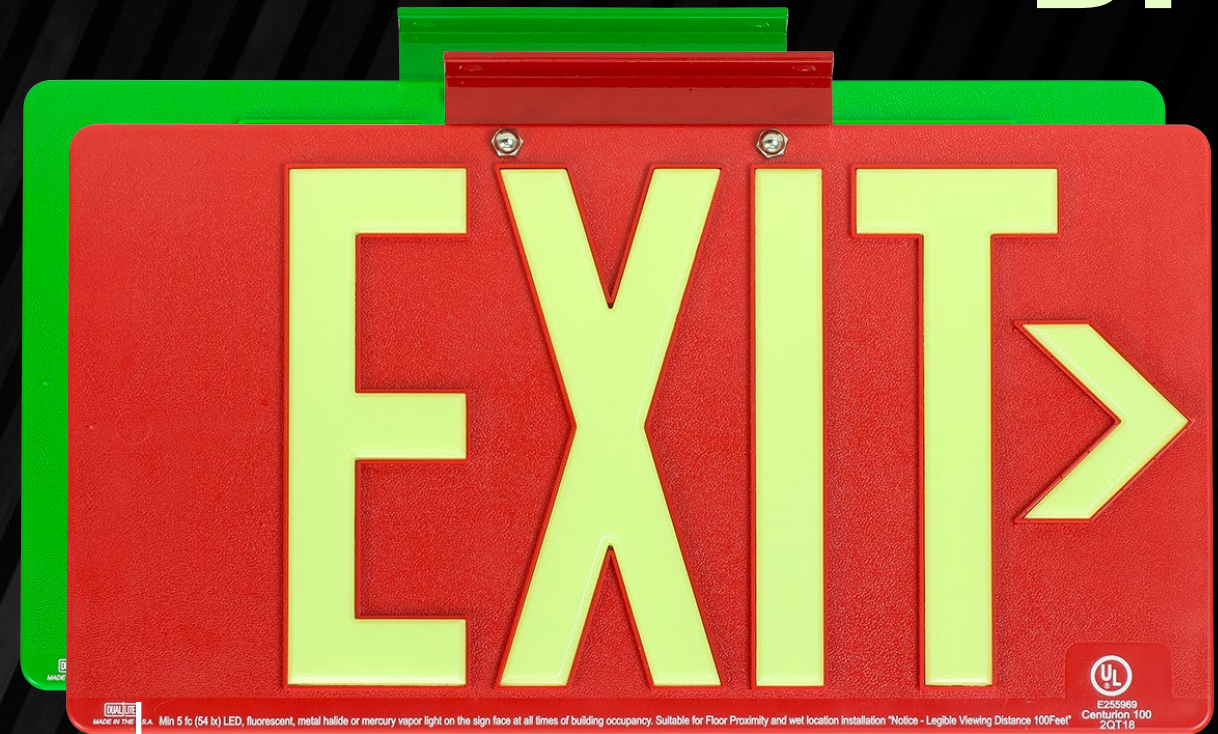

Constructed of injection molded ABS thermoplastic with red or green background

- Includes color-matched powder coated bracket
- Offers UL listed viewing distance of 100'
- Is suitable for wet location and indoor or outdoor use.
- The word EXIT and applied chevrons illuminate in darkness

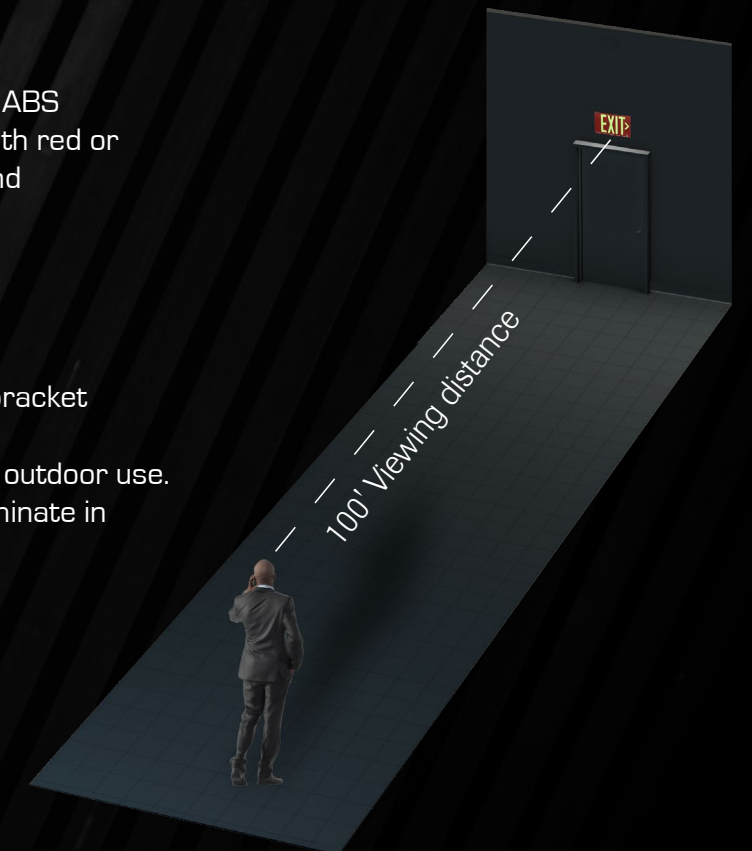



# DPLPM

Includes polished aluminum mounting bracket

Available in red, green or brushed aluminum face



Aluminum face and back.

- Constructed of high-density polyethylene (HDPE)
- 50' or 75' viewing distance
- The 75' sign is suitable for wet location
- Available in single or double-face



# DPLA



The DPLA is constructed of high gloss acrylic in fire engine red or vivid green in single or double-face, and offers a 75' viewing distance. The DLPA is for indoor use only and is supplied with a chrome plated mounting bracket







ALERA LIGHTING  
ARCHITECTURAL AREA LIGHTING  
BEACON PRODUCTS  
COLUMBIA LIGHTING  
COMPASS  
DUAL-LITE  
HUBBELL CONTROL SOLUTIONS  
HUBBELL INDUSTRIAL LIGHTING  
HUBBELL OUTDOOR LIGHTING  
KIM LIGHTING  
KURT VERSEN  
LITECONTROL  
PRESCOLITE



701 Millennium Blvd. Greenville, SC 29607  
Tel 864.678.1000  
[www.dual-lite.com](http://www.dual-lite.com)

DL-DPL-B-0604089 09/18

Copyright © 2018 *Dual-Lite*, a division of Hubbell Lighting, Inc. All rights reserved. Please refer to online specifications for most up-to-date content as specifications are subject to change without notice.