



TELECOM & GROUND CONNECTORS VISE TYPE BRONZE

BRONZE
GC5000

- For copper connections-splice, loop deadend or service entrance tap
- One piece design for easier, faster installation
- Bolt head design for use with standard ratchet wrench
- Vise design achieves high connector pressure with low wrench force
- Easily installs with live line and standard tools

Material: **Body** - Copper Base Alloy
Hardware - Stainless or Silicon Bronze Alloy

Note: For Tin Plated Connector, add "P" Suffix (See Notes).

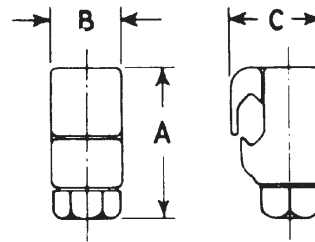

Product Data & Conductor Size

CATALOG NUMBER	CONDUCTOR RANGE		DIA. RANGE (2 COND. COMBO.)	DIMENSIONS INCHES (MM)			WT. LB. (KG)	BOLT HEAD (HEX)
	MAX. 2 CONDUCTORS	MIN. 2 CONDUCTORS	DIA. EA. COND. MAX. - MIN.	A	B	C		
GC5008SH*	#8 STR.	#11 SOL.	.146" - .091" (3.72-2.32)	7/8" (22.7)	5/8" (15.91)	5/8" (15.91)	.06 (.03)	3/8" (10)
GC5006 GC5006SH*	#6 SOL.	#10 SOL.	.162"-.101" (4.12-2.57)	1" (25.45)		3/4" (19.09)	.09 (.04)	
GC5004†	#4 STR.	#8 SOL.	.232"-.128" (5.9-3.26)	1-1/4" (31.81)		7/8" (22.27)	.16 (.07)	9/16" (14)
GC5002†	#2 SOL.	#6 SOL.	.286"-.162" (7.28-4.12)	1-3/8" (34.99)	3/4" (19.09)	1" (25.45)	.18 (.08)	
GC5002S†	#2 STR.	#5 SOL.	.320"-.181" (8.14-4.61)	1-5/8" (41.36)		1-1/8" (28.63)	.28 (.13)	
GC5020†	1/0 STR.	#4 SOL.	.390"-.204" (9.93-5.19)	1-7/8" (47.72)		1-1/4" (31.81)		
GC5020S†	2/0 STR.	#3 SOL.	.438"-.229" (11.15-5.83)	2" (50.90)	7/8" (22.27)	1-1/4" (31.81)	.48 (.22)	
GC5040†	4/0 STR.	#1 SOL.	.552"-.289" (14.05-7.36)	2-1/8" (54.08)	1" (25.45)	1-3/8" (34.99)		

* SH suffix indicates a slotted hex-head bolt.
 Note: All connectors will accept one or two of the conductors listed and any combination in between.
 For tin plated bronze connectors, add suffix "P" to catalog number (not available on GC5008SH, GC5006S & GC5006SH).
 † For "Torque Head" bolts for permanent ground or concentric neutral applications, add suffix "O" to catalog number.



GROUNDING STUD, VISE TYPE BRONZE

BRONZE/ALUMINUM

GC200

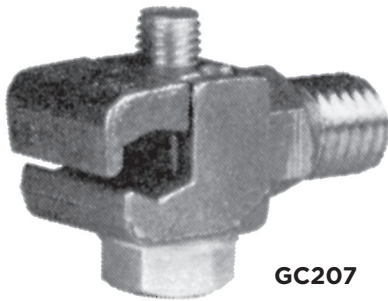

GC207

Provides a permanent vibration proof connection. The large flat surface of the male casting provides secure mounting, while the “V” shaped conductor groove assures alignment of grounding connector.

- For grounding applications conductor to conductor or mounting plate to conductor.
- Provided with standard 1/2-13 thread studs and flat surfaces for easy one wrench installation.

Material: Body - Copper Alloy
Hardware - Stainless Steel

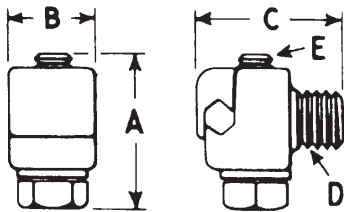

GC207, GC209

Product Data & Conductor Size

BRONZE GROUNDING CONNECTOR

CATALOG NUMBER	CONDUCTOR RANGE	DIMENSIONS INCHES (MM)					WT. LB. (KG)
		A	B	C	D	E	
GC207+	6 Sol. To 1/0 Str.	1-1/4 (31.81)	3/4 (19.09)	1-7/8 (47.72)	1/2 (12.73)	5/16 (7.95)	.21 (.10)
GC208+	4 Str. To 2/0 Str.	1-5/16 (33.40)	13/16 (20.68)	1-7/8 (47.72)	1/2 (12.73)	5/16 (7.95)	.29 (.13)
GC209*+	3 Sol. To 4/0 Str.	1-1/2 (38.18)	1-1/8 (28.63)	1-3/4 (44.54)	1/2 (12.73)	5/16 (7.95)	.40 (.18)

*GC209 is furnished with bronze jam nut on stud.

Fargo recommends bronze connectors (GC207 through GC209) for copper ground conductors, and aluminum connectors.

+Add Suffix “P” for Tin Plated Connector.

NOTE: GA220 available for aluminum ground conductors.

DH
2

TELECOM CONNECTORS VISE TYPE BRONZE

BRONZE/ALUMINUM
GC100/GC200

For Bonding Ribbon, Braid and Tape

Bonding ribbon or braid to bonding ribbon, braid, conductor, or bus and tape to messenger.

CATALOG NUMBER	BONDING RIBBON OR BRAID		DIMENSIONS INCHES (MM)					WT. LB. (KG)
	CONNECT	TO	A	B	C	BOLT		
						DIA.	WRENCH	
GC164 GC164P†	Ribbon or Braid	Ribbon, Braid, #6 or Bus	1 (25.45)	5/8 (15.90)	1 (25.45)	1/4 (6.36)	3/8 (10)	.12 (.05)

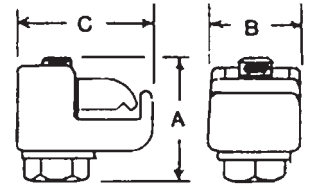

For Ground Rods

Conductor to ground rods, using vise-type compression connector.

CATALOG NUMBER	RANGE		DIMENSIONS INCHES (MM)					WT. LB. (KG)
	ROD DIA. IN. (MM)	CONDUCTOR	A	B	C	BOLT		
						DIA.	WRENCH	
GC268†	1/4 - 5/8 (6.36-15.90)	6-1/0	2 (50.80)	1 (25.45)	1-3/8 (35.00)	3/8 (9.54)	9/16 (14)	.43 (.19)

GC164

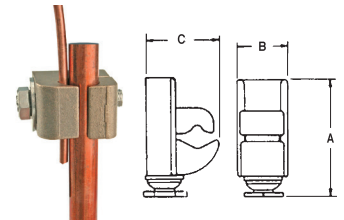

GC268

* Torque head bolts available for tamperproof, removeable connection.

† Complies with UL-467 and ETL listed

For Lashing Wire

Connect small diameter lashing wires to messengers.

CATALOG NUMBER	MESSENGER DIAMETER RANGE	LASHING WIRE	DIMENSIONS INCHES (MM)					WT. LB. (KG)
	CONNECT (MM)		TO	A	B	C	BOLT	
		DIA.					WRENCH	
GC166 GC166P	.245" - .500" (6.23-12.73)	All Sizes	1-1/2 (38.18)	7/8 (22.26)	1 (25.45)	1/4 (6.36)	3/8 (10)	.16 (.07)

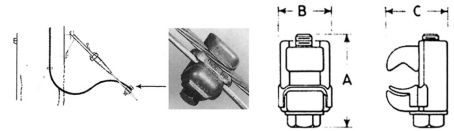

GC166

Suffix P- Plated Bronze

For Guy Strand

Aluminum bodied connectors for connecting galvanized or aluminum clad strand to copper conductors. Vise Type Parallel Connector.

CATALOG NUMBER	STRAND RANGE (IN.) (MM)	CONDUCTOR RANGE	DIMENSIONS INCHES (MM)			WT. LB. (KG)
			A	B	C	
GA9003L**	1/4 (6.36)	4-8	7/8 (22.26)	1-1/4 (31.81)	1-3/4 (44.54)	.17 (.08)
GA9002L**	1/4 - 3/8 (6.36-9.54)	4-8	1-1/8 (28.63)	1-7/8 (47.72)	2-1/8 (54.08)	.23 (.10)
PARALLEL GROOVE TYPE						
LC52AXB** LC522AXB***	1/4 - 3/8 (6.36-9.54)	2/0 - 8	2-3/8 (60.44)	1-5/8 (41.36)	1-3/8 (35.00)	.20 (.09)

GA9000 Series

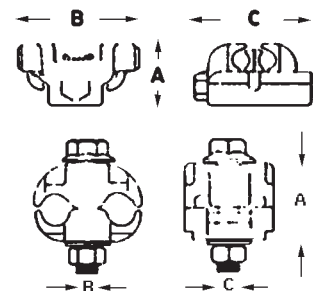

LC50 Series

* Inhibitor Protected and Individually Packaged - Standard

† Bimetallic Liner on Top Side - Copper

** RUS Listed



BRONZE GROUNDING CONNECTOR WIRE TO ROD OR PIPE

BRONZE
GC/C203

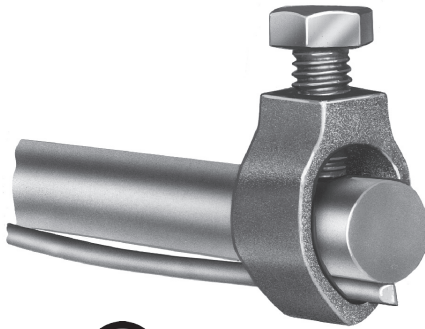

Bronze alloy ground clamp for grounding copper cable parallel to a ground rod or tube.

- Suitable for Direct Burial

Material: GC-Casting - Bronze Alloy
Hardware - Stainless Steel
C203-Casting - Galvanized Steel
Hardware - Zinc Plated

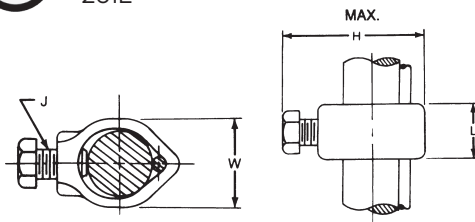

Product Data & Conductor Size

CATALOG NUMBER	COPPER CABLE RANGE	ROD DIA.	DIMENSIONS INCHES (MM)				WT. LB. (KG)
			L	H	W	J	
GC4	#8 Sol.—#4 Str.	1/2"	5/8 (15.88)	1-7/8 (47.62)	13/16 (20.64)	3/8 (9.52)	.09 (.04)
GC5G5	#10 Sol.—#2 Str.	5/8"	5/8 (15.88)	1-19/32 (40.39)	29/32 (23.11)	3/8 (9.52)	.11 (.05)
GC6	#8 Sol.—#4 Str.	3/4"	3/4 (19.05)	2-1/8 (53.98)	1-1/32 (26.19)	3/8 (9.52)	.13 (.06)
C2030344 Heavy Duty	#8 Sol.—2/0 Str.	5/8"	1-1/8 (28.6)	2-7/8 (73.0)	1-15/32 (37.3)	1/2 (12.7)	.34 (.15)
C2030345 Heavy Duty	#8 Sol.—2/0 Str.	3/4"	1-1/8 (28.6)	2-7/8 (73.0)	1-15/32 (37.3)	1/2 (12.7)	.30 (.14)

* For silicon bronze bolt, order as "GC5".

DH
4



SPECIAL TELECOM VISE TYPE BRONZE GROUNDING APPLICATIONS

BRONZE
GC100/GC200/
GC5000

For copper to copper connections or conductor to conductor and conductor/cable sheath to bar.

Material: **Body** - Copper Alloy
Bolt - Stainless Steel or Silicon Bronze Slotted Head Hex



GC5000 Series

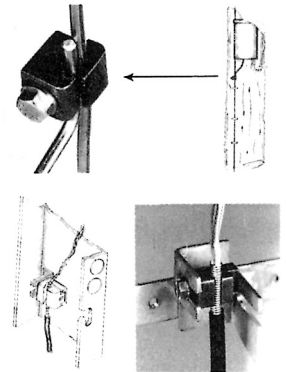

CATALOG NUMBER	RANGE				DIMENSIONS INCHES (MM)					WT. LB. (KG)
	CONDUCTOR COMBINATIONS		CABLE SHEATH BONDING		A	B	C	BOLT		
	RUN	TAP						DIA.	WRENCH	
GC271**	4-6 4 Sol - 6 Str.	6-14	1 to 3	2 pair	1 (25.45)	5/8 (15.90)	3/4 (19.08)	1/4 (6.36)	3/8 (10)	.08 (.04)
GC5006SH**	6	6-14	1 to 3	2 pair	1 (25.45)	5/8 (15.90)	3/4 (19.08)	1/4 (6.36)	3/8 (10)	.09 (.04)
GC5006***	6	6-14	1 to 3	2 pair	1 (25.45)	5/8 (15.90)	3/4 (19.08)	1/4 (6.36)	3/8 (10)	.09 (.04)
GC5004***	4	4-8	1 to 3	2 pair	1-1/4 (31.81)	5/8 (15.90)	7/8 (22.26)	5/16 (7.95)	9/16 (14)	.16 (.07)
			1	5 pair						
GC5002**	2	2-6	—	—	1-3/8 (35.00)	3/4 (19.08)	1 (25.45)	5/16 (7.95)	9/16 (14)	.18 (.08)

* Slotted Head Bolt
† Complies with UL-467 and ETL listed
** RUS Listed

For Figure 8 or IM Cable - Insulation Piercing

The piercing teeth of the connector puncture the messenger insulation during tightening to form a positive ground without skinning.

Material: **Body** - Copper Alloy
Hardware - Stainless Steel

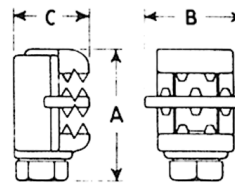

GC167

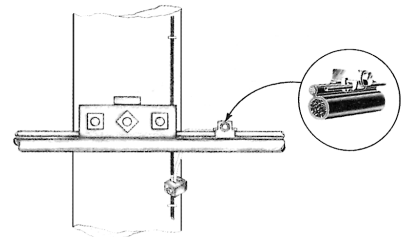

CATALOG NUMBER	DIAMETER		DIMENSIONS INCHES (MM)					WT. LB. (KG)
	MESSENGER (MM)	GROUND TAP (MM)	A	B	C	BOLT		
						DIA.	WRENCH	
GC167	.146" - .312"	.146" - .312"	1-5/8 (41.36)	1-1/4 (31.81)	1 (25.45)	5/16 (7.95)	9/16 (14)	.21 (.10)
GC167P	(3.71-7.94)	(3.71-7.94)						.21 (.10)

* Suffix P - Tin-Plated Bronze

DH
5