

Switches

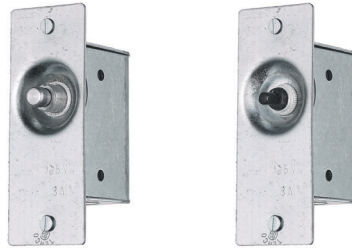

Door Switch Accessories

Compact Design Door Switches and Replacement Switches



Description	ON When Door is Open	OFF When Door is Open
Door switch with cover plate and box, zinc plated steel, 3A 125V AC	RDS50*	RDS30*
Replacement switch only complete with #18 AWG wire leads and adjustable plunger, 6A 125V, 3A 250V	1205BRY**	1206BRY**

Note: *Not UL Listed.
**Not UL Listed or CSA Certified.

Product Dimensions Inches (mm)

A	4.00" (10.16)
B	3.13" (7.95)
C	1.50" (3.81)
D	1.76" (4.47)
E	2.67" (6.78)
F	1.34" (3.40)
G	KO 0.87" (2.21)

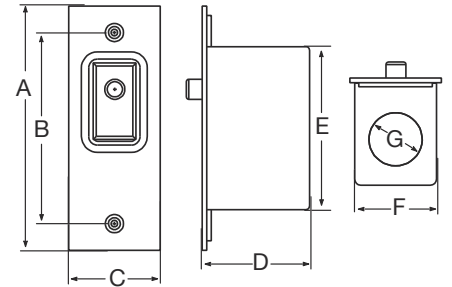

In-Line Cord Switches

In-Line Cord Switches



Mini In-Line Cord Switch		
Description	Color	Catalog Number
Mini in-line cord switch, #18 AWG, for use with flat lamp cord, SPT 1 and SPT 2, 6A 125V AC	White	RS100W



Heavy Duty In-Line Cord Switch		
Description	Color	Catalog Number
Heavy duty in-line cord switch, #18/2-#16/2, SPT 1 and SPT 2, 6A 125V AC, 1/6 HP	Ivory White	RS101I RS101W