

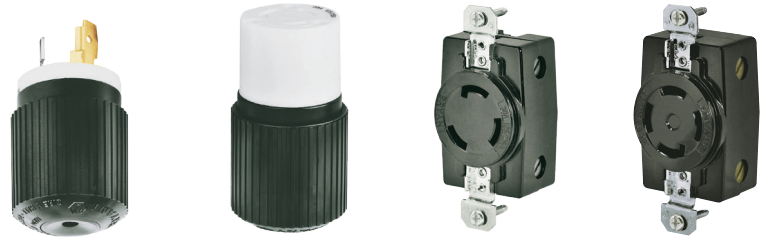







# Locking Devices



## 30 Amp Non-NEMA Locking Devices

30A 125/250V, 250V AC and 3ØY 120/208V AC Locking Devices, Grounding and Non-Grounding Inches (mm)



Rating	Poles/ Wires	Cord Diameter	Description	Triple Gripper		Single Receptacle Back and Side Wired
				Nylon Plug	Nylon Connector	All Black Urea
30A 125/250V AC, Non-Grounding	3-Pole 3-Wire	.300"-.950" (7.6- 24.1)	Black/White	<b>3331</b>	<b>3333</b>	<b>3330</b>
 						
30A 250V AC, Grounding	2-Pole 3-Wire		All Black	—	—	<b>3330G*</b>
 						
30A 3ØY 120/208V, Non-Grounding	4-Pole 4-Wire	.625"-1.150" (15.9-29.2)	Black/White	<b>3431</b>	<b>3433</b>	<b>3430BRY</b>
 						
30A 250V AC, Grounding	3-Pole 4-Wire		All Black	—	—	<b>3430G*</b>
 						

**Note: Rating Change:** Effective July 1, 1981, the ratings of devices listed on this page were changed from 30 Amp 250V to 30 Amp 125/250V in order to comply with Underwriters Laboratories' requirements. Note that although the voltage rating has changed, the configuration will remain the same. Suffix "G" devices are intended for equipment grounding applications and formerly complied with UL Standards. However, due to revisions of these Standards, suffix "G" devices are no longer UL Listed. Devices listed on this page are intended for replacement use only. For new installations, refer to the NEMA configuration chart on page H-2 for your particular current and voltage requirements. **CAUTION:** To Avoid Electric Shock-Review premises carefully and do not use if slot or blade configuration (design) is already in a circuit having a rating differing from the rating of this device. See page H-20 for weather protective boots for 30 amp nylon locking plugs. \*Not UL Listed. For Replacement use only.

## Product Dimensions Inches (mm)

Plug	
A	2.85" (72.4)
B	1.89" (48.0)
C	2.13" (54.1)

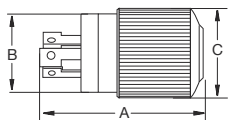

Connector	
A	3.90" (99.1)
B	1.89" (48.0)
C	2.13" (54.1)

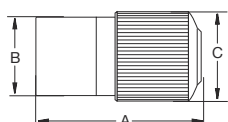

Single Receptacle	
A	3.28" (83.3)
B	2.38" (60.5)
C	1.56" (39.6)
D	1.71" (43.4)
E	2.50" (63.5)
F	1.20" (30.5)

