

Locking Devices



20 Amp Plugs, Connectors Flanged Devices and Receptacles

20A 125V, 250V, 277V AC, 480V AC and 600V AC Locking Devices,
2-Pole 3-Wire Grounding Inches (mm)

TECH·SPEC®



Rating	Cord Diameter	Description	Tripple Gripper		Flanged Devices Equipment Base with Nylon White Cup		Weather Protective Power Inlets Die Cast Aluminum Plate*	Single Nylon Receptacle, All Black
			Nylon Plug	Nylon Connector	Male	Female		
NEMA L5-20, 20A 125V	.300"-.655" (7.6-16.6)	Black/White	70520NP	70520NC	70520MB	70520ER	70520MBWP	—
		All Black	70520NPB	70520NCB	—	—		70520FR
		Corrosion-Resistant Yellow/White	70520NPCR	70520NCCR	—	—		70520FRCR
		Isolated Ground Orange	—	—	—	—	70520IG	
NEMA L6-20, 20A 250V	.300"-.655" (7.6-16.6)	Black/White	70620NP	70620NC	70620MB	70620ER	70620MBWP	70620FR
		Corrosion-Resistant Yellow/White	70620NPCR	70620NCCR	—	—		—
		Isolated Ground Orange	—	—	—	—		70620IG
NEMA L7-20, 20A 277V AC	.300"-.655" (7.6-16.6)	Black/White	70720NP	70720NC	70720MB	70720ER	—	70720FR
NEMA L8-20, 20A 480V AC	.300"-.950" (7.6-24.1)	Black/White	70820NP	70820NC	70820MB	70820ER	—	70820FR
NEMA L9-20, 20A 600V AC	.300"-.950" (7.6-24.1)	Black/White	70920NP	70920NC	70920MB	70920ER	—	70920FR

Note: *Supplied with gaskets, mounting screws and spring-loaded, self-closing lift cover.
See Section D for more information on isolated ground devices and Section J for more information on corrosion-resistant devices.
See page H-20 for weather protective boots for 20 amp nylon locking plugs.

Product Dimensions Inches (mm)

Plug	
A	2.86" (72.4)
B	1.89" (48.0)
C	2.13" (54.1)

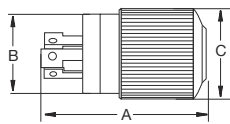

Connector	
A	3.90" (99.1)
B	1.89" (48.0)
C	2.13" (54.1)

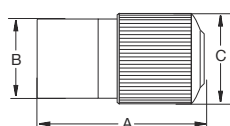

	Receptacle	Flanged Devices
	Single	Male/ Female
A	3.28" (83.3)	2.88" (73.2)
B	2.38" (60.5)	120
C	1.56" (39.6)	2.00" (50.8)
D	1.70" (43.2)	2.02" (51.3)
E	2.67" (67.8)	2.05" (52.1)
F	1.24" (31.5)	(3) 0.19" (4.8)

Note: See page S-8 for horsepower ratings.

