

Lampholders, Starters and Adapters



Incandescent Lampholders



Incandescent Lampholders:

- 2 or 4 screw termination allows for quick feed through
- 6 inch pigtail accommodates twist on wire connectors

Fluorescent Lampholders:

- Thermoplastic construction available for HO (High Output), slimline, or Bi-pin types

Porcelain Lampholders



Catalog Number	RL8804	RL8806	RL8812	RL8816	RL8822
Description	Keyless, white, 4 terminal screws	Keyless, white, 6 inch pigtails	Pull chain, white, 2 terminal screws	Pull chain, white, 6 inch pigtails	Pull chain with receptacle, white, 2 terminal screws
Rating	660W 250V	660W 250V	660W 250V	660W 250V	660W 125V, 15A 125V, NEMA 5-15R

Plastic Lampholders



Catalog Number	RL8504	RL8506	RL8512	RL8516
Description	Keyless, white, 4 terminal screws	Keyless, white, 6 inch pigtails	Pull chain, white, 2 terminal screws	Pull chain, white, 6 inch pigtails
Rating	660W 600V	660W 600V	660W 250V	660W 250V

Incandescent Brass Lampholders



Catalog Number	RL101*	RL102*	RL105*	RL106*	RL100**
Description	Turn knob, single	Turn knob, 3-way	Push through	Pull chain	Keyless, brass
Rating	250W 250V	250W 250V	660W 250V	660W 250V	660W 250V

Note: *UL and cUL. **UL and CSA.

Product Dimensions Inches (mm)

Porcelain	RL8804	RL8806	RL8812	RL8816	RL8822
A	4.35" (110.5)	4.35" (110.5)	4.55" (115.6)	4.55" (115.6)	4.55" (115.6)
B	1.50" (38.1)	1.50" (38.1)	1.55" (39.4)	1.55" (39.4)	1.55" (39.4)
C	1.84" (46.7)	1.84" (46.7)	1.84" (46.7)	1.84" (46.7)	1.84" (46.7)

Plastic	RL8504	RL8506	RL8512	RL8516
A	4.55" (115.6)	4.55" (115.6)	4.55" (115.6)	4.55" (115.6)
B	1.55" (39.4)	1.55" (39.4)	1.55" (39.4)	1.55" (39.4)
C	1.57" (39.9)	1.57" (39.9)	1.57" (39.9)	1.57" (39.9)

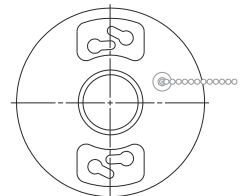
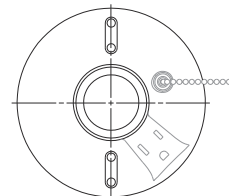
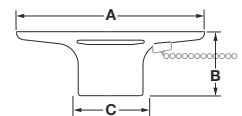
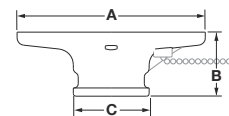

Porcelain

Plastic