



## Performance

All connectors are ETL verified to Category 6 performance.

## Durability

Rugged construction for the most punishing environments.



## Interface

User-friendly quick connect positive indication when fully engaged.



## Installation

Standard 3/4" conduit knockout simplifies installation

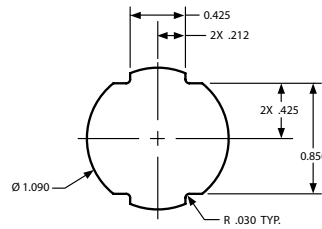

## Specifications



- Vibration: frequency range: 10-500Hz
- Acceleration: 5g (operational)
- Mating cycles: 750 minimum
- HI-Impact housing: Thermoplastic, UL 94V-0

## Standards

- TIA-568.2-D Category 6 Component
- IEEE 802.3bt 4PPoE
- Ingress protection: IP67 (dust/water)



①



②

## HI-Impact Copper Panel Mount Connectors

Includes (1) housing, (1) jack, (1) flat bulkhead gasket, and (1) retaining nut

Description	Catalog No.
HI-Impact Category 6A Unshielded Jack	<b>HI6A</b>
HI-Impact Category Shielded 6A Jack	<b>HIS6A</b>
HI-Impact Category 6A Shielded Coupler	<b>HIS6AC</b>
HI-Impact Category Unshielded 6 Jack	① <b>HI6</b>
HI-Impact Category Unshielded 6 Coupler	<b>HI6C</b>
HI-Impact Protective Cap	② <b>HIC</b>