

HERMOSA

Outdoor Mediterranean-style lanterns in the Hermosa family complement Transitional, Rustic Farmhouse and Modern Farmhouse exteriors. These large-scale pieces feature beautiful detail and a die cast aluminum frames. Wrought iron styling perfectly frames beautiful clear, water glass shades.

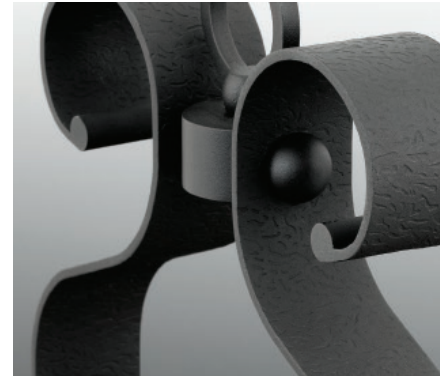

P550027-031



P560074-031



P560075-031



P560076-031



P550027-031



P540027-031

FINISH
● Black - 031

POST LANTERN
P540027-031 Black
12" dia., 28" ht.
Fits 3" post (order separately).
One medium base lamp,
100w max.

HANGING LANTERN
P550027-031 Black
12" dia., 26-1/2" ht.
Overall ht. w/chain 101-1/2", wire 10'.
One medium base lamp,
100w max.

SMALL WALL LANTERN
P560074-031 Black
8" W., 21" ht.
Extends 8-1/4". H/CTR 12-7/8".
One medium base lamp,
100w max.

MEDIUM WALL LANTERN
P560075-031 Black
10" W., 26" ht.
Extends 10-1/8". H/CTR 16-1/8".
One medium base lamp,
100w max.

LARGE WALL LANTERN
P560076-031 Black
12" W., 32" ht.
Extends 12-1/4". H/CTR 20-1/8".
One medium base lamp,
100w max.