

# Hospital Products

## Hubbellock® Plugs, Connector Bodies and Receptacles

### For Hospital Use Only



### Hubbellock® Plugs and Connector Bodies

Description	Plugs	Connector Bodies
Nylon cover, thermoset interior.	<b>HBL23014HGB</b>	<b>HBL23001HGB</b>
Armored, epoxy filled, rubber cord grip.	<b>HBL23004HG</b>	-

Note: Cord clamp range for plug and connector .300" to .660" (7.6 to 16.8).



20A 125V AC



20A 125V AC

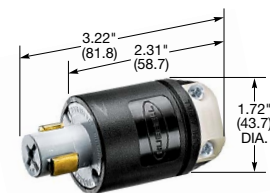

**HBL23014HGB**

### Receptacles

Description	Catalog Number
Black, back wired.	- <b>HBL23000HG</b>



**HBL23001HGB**

### Wallplates

Description	Catalog Number
Stainless steel 302/304, single-gang.	<b>HBL23901HG</b>
Stainless steel 302/304, three-gang for two receptacles.	<b>HBL23909HG</b>

Note: Suffix HG or HGB type for hospital use only.



**IP30**  
SUITABILITY

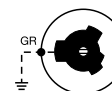

20A 125V AC

### Explosion Proof Plug

Description	Catalog Number
Plug, with, epoxy kit, accepts #12 or #14 type SO cable.	<b>HBL24312</b>

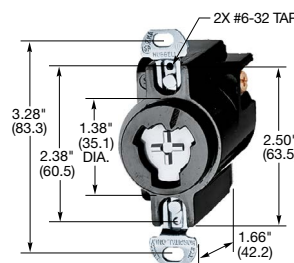

**HBL23000HG**

### Hazardous to Non-hazardous Location Receptacle Conversion Kits

Conversion kits for replacement of explosion proof receptacles listed above, with non-explosion proof receptacles, in the hospital areas formerly classified as hazardous locations and now classified non-hazardous locations due to the change from flammable anesthetizing gases to nonflammable anesthetizing gases.

For Conversion To:	Catalog Number
20A, 125V, duplex receptacle (Hubbell HBL830 Series). Includes adapter ring and stainless steel wall plate for duplex receptacle (receptacle not included).	<b>HBL24300RKD</b>
20A, 125V, Hospital Hubbellock receptacle (Hubbell HBL23000HG) or 20A, 125V, straight blade single receptacle (Hubbell HBL8310 series). Includes adapter ring and stainless wall plate for single receptacle (receptacle not included).	<b>HBL24300RKS</b>

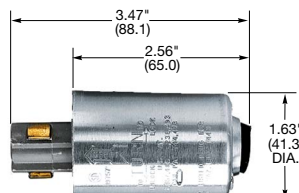

**HBL24312**

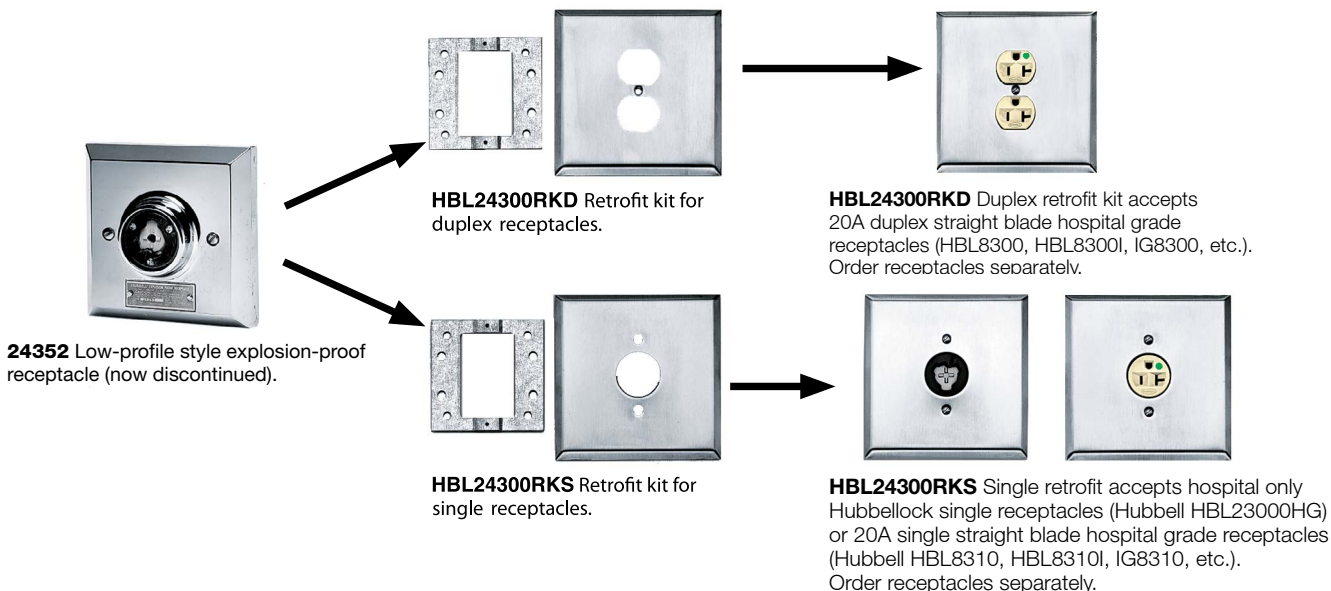

Dimensions in Inches (mm)