

**IP44**  
SUITABILITY

## Weatherproof Covers for Receptacles with Face Dia. of 1.36–1.39 in. (34.5–35.3)

| Description  | Catalog Number             |
|--|----------------------------|
| Thermoplastic, wet and damp locations with cover “open”, gray.           | <b>HBL7423WO</b>           |
| Thermoplastic, wet and damp locations with cover “open”, yellow.         | <b>HBL74CM23WO</b>         |
| Cast aluminum, wet location only when cover “closed” and damp locations. | <b>HBL7420</b>             |
| Cast aluminum, no lift cover, NOT weatherproof.                          | <b>HBL7320<sup>▲</sup></b> |



HBL7423WO

## Weatherproof Covers for Switches & Receptacles with Face Dia. of 1.55–1.58 in. (39.4–40.1)

| Description  | Catalog Number                 |
|--|--------------------------------|
| Thermoplastic, wet and damp locations with cover “open”, gray.   | <b>HBL7425WOA</b>              |
| Thermoplastic, wet and damp locations with cover “open”, yellow. | <b>HBL74CM25WOA</b>            |
| Thermoplastic, wet and damp locations with cover “open”, white.  | <b>HBL74CM25WOAW</b>           |
| Cast aluminum, wet and damp locations with cover “closed.”       | <b>HBL7420<sup>*</sup></b>     |
| Cast aluminum, no lift cover, NOT weatherproof.                  | <b>HBL7320<sup>▲</sup></b>     |
| Thermoplastic, wet and damp locations with cover “open”, gray.   | <b>HBL7428WOG<sup>**</sup></b> |
| Thermoplastic, wet and damp locations with cover “open”, yellow. | <b>HBL7428WOY<sup>**</sup></b> |
| Thermoplastic, wet and damp locations with cover “open”, red.    | <b>HBL7428WOR<sup>**</sup></b> |



HBL7425WOA

## Weatherproof Covers for Receptacles with Face Dia. of 1.68–1.72 in. (42.7–43.7)

| Description  | Catalog Number             |
|--|----------------------------|
| Thermoplastic, wet and damp locations with cover “open”, gray.           | <b>HBL7424WO</b>           |
| Thermoplastic, wet and damp locations with cover “open”, yellow.         | <b>HBL74CM24WO</b>         |
| Cast aluminum, wet location only when cover “closed” and damp locations. | <b>HBL3393</b>             |
| Cast aluminum, no lift cover, NOT weatherproof.                          | <b>HBL3394<sup>▲</sup></b> |



HBL7420

Note: <sup>\*</sup>Cast aluminum lift cover with fibershield for standard toggle and PresSwitch<sup>®</sup> Switches.

<sup>\*\*</sup>Features two #6-32 threaded inserts to back mount device to cover.

<sup>▲</sup>IP20 SUITABILITY.

All weatherproof lift cover plates on this page are UL Listed as “WDL Closed” for use in wet locations with cover closed and in damp locations.

## Weatherproof Covers for Single Receptacles on FS/FD Boxes

All weatherproof covers are UL Listed for WET LOCATIONS WITH COVER CLOSED for intermittent use in wet locations or use in damp locations. Those with suffix “WO” are listed for WET LOCATIONS with cover open in continuous use. All plates are gasketed and self-closing.



HBL7320

## 2023 National Electrical Code (NEC<sup>®</sup>) Requirement

406.9 Receptacles in Damp or Wet Locations.

### 406.9 Receptacles in Damp or Wet Locations.

#### (B) Wet Locations

##### (1) Receptacles of 15 and 20 Amperes in a Wet Location.

Receptacles of 15 and 20 amperes, 125 and 250 volts installed in a wet location shall have an enclosure that is weatherproof whether or not the attachment plug cap is inserted. An outlet box hood installed for this purpose shall be identified as “extra-duty.” Other listed products, enclosures, or assemblies providing weatherproof protection that do not utilize an outlet box hood need not be marked “extra-duty.”

All 15- and 20-ampere, 125- and 250-volt nonlocking-type receptacles shall be listed and so identified as weather-resistant type.

(2) **Other Receptacles.** All other receptacles installed in a wet location shall comply with 406.9(B)(2)(a) or (B)(2)(b).

(a) A receptacle installed in a wet location, where the product intended to be plugged into it is not attended while in use, shall have an enclosure that is weatherproof with the attachment plug cap inserted or removed.

(b) A receptacle installed in a wet location where the product intended to be plugged into it will be attended while in use (e.g., portable tools) shall have an enclosure that is weatherproof when the attachment plug is removed.

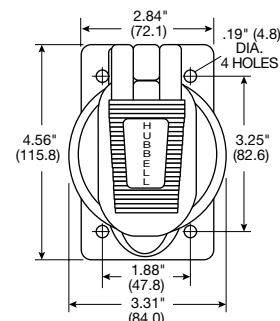

Typical Plate, 1-Gang



HBL7424WO



HBL3393

Dimensions in Inches (mm)

NEC<sup>®</sup> is a registered trademark of the The National Electrical Code.