

# Fresno FN

## Bollards

- Rotatable LED assembly adjustment for ideal placement and aiming of asymmetric light pattern
- 24 high brightness LEDs at 500mA deliver symmetric distribution at 46w
- 12 high brightness LEDs at 700mA deliver asymmetric distribution at 30w
- Available in three different color correlated temperatures
- >60,000 HOUR L90
- Extruded aluminum housing with single screw access for top relamping; Decorative cast top with tamper resistant hardware
- Sealed one-piece, clear acrylic lens
- Durable Lektrocote® TGIC thermoset polyester powder coat paint finish assures long life and maintenance-free service
- Concealed, cast aluminum anchor base; Four 1/2" x 10" anchor bolts on 4" diameter bolt circle
- Listed to UL1598 for use in wet locations
- 5 year limited system warranty



FRESNO SQUARE

FRESNO ROUND



BOLLARDS

### MADE-TO-ORDER ORDERING INFORMATION

SERIES	SOURCE/WATTAGE/LED	VOLTAGE	COLOR	OPTIONS <sup>1</sup>
<b>FN1</b> Fresno Square	<b>12LU-3K</b> asymmetric, 27W, 3000K CCT	<b>U</b> 120V-277V	<b>DB</b> Dark Bronze	<b>CD</b> 0-10V dimmable
<b>FN2</b> Fresno Round	<b>12LU-4K</b> asymmetric, 27W, 4000K CCT	<b>1</b> 120	<b>BL</b> Black	<b>24</b> 24" OAH <sup>2</sup>
	<b>12LU-5K</b> asymmetric, 27W, 5000K CCT	<b>2</b> 277	<b>WH</b> White	<b>30</b> 30" OAH <sup>2</sup>
	<b>24LU-3K</b> symmetric, 41W, 3000K CCT	<b>3</b> 240	<b>GR</b> Gray	<b>36</b> 36" OAH <sup>2</sup>
	<b>24LU-4K</b> symmetric, 41W, 4000K CCT	<b>4</b> 277	<b>PS</b> Platinum Silver	<b>F(X)</b> Fusing <sup>3</sup>
	<b>24LU-5K</b> symmetric, 41W, 5000K CCT	<b>5</b> 480	<b>RD</b> Red (premium color)	<b>P(X)</b> Button Photocell <sup>3</sup>
	<b>24LU-AM</b> symmetric, 20W, Amber 590nm	<b>6</b> 347	<b>FG</b> Forest Green (premium color)	<b>ABS</b> Bolts shipped ahead
			<b>CC</b> Custom Color (consult factory)	

<sup>1</sup> Any or all options may be used together

<sup>2</sup> Standard fixture height is 42", only one overall height (OAH) may be selected

<sup>3</sup> Replace '(X)' with corresponding voltage (1=120, 2=208, 3=240, 4=277, 5=480, 6=347), Button Photocell not available in 480V

### DIMENSIONS

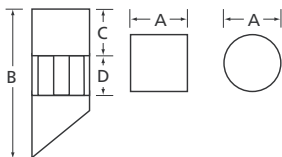

	A	B	C	D	Weight
<b>FN1</b>	6 3/4" sq.	42"	6"	4"	41 lbs.
	171 mm	1067 mm	152 mm	102 mm	18.6 kg
	7" dia.	42"	6"	4"	41 lbs.
<b>FN2</b>	178 mm	1067 mm	152 mm	102 mm	18.6 kg