

INSTALLATION INSTRUCTIONS

FIXTURE TYPE _____

**FAI/ACC, FAI/ACC/V, FAI/ACC/F
FIELD ADJUSTABLE CABLES**

P/C **510245-7000**

DATE: 9-29-08

PG. 1 OF 2

DO NOT MODIFY OR ALTER THIS PRODUCT IN ANY WAY, OR INSTALL IN ANY FASHION WHICH IS CONTRARY TO THE INSTRUCTIONS CONTAINED HEREIN.
IF YOU HAVE ANY QUESTIONS REGARDING THIS PRODUCT OR THE INSTALLATION OF IT, PLEASE CALL LITECONTROL ENGINEERING AT 781-294-0100.

GENERAL NOTES:

1. For all aircraft cable assemblies except FAI/ACC/F (cable assy w/feed), the contractor must securely install one 1/4-20 stud at each aircraft cable location, extending 3/4" below ceiling line. See individual fixture sheets for locations of cables. The FAI/ACC/F assembly is made to install over the following

- * outlet boxes; (3-1/2" octagonal 4" x 2-1/8" Handy box, 3" x 2" Switchbox and plaster ring with 2-3/4" mtg. holes).

WARNING: The National Electric Code requires that any fixture weighing more than (50) pounds be independently supported of an outlet box.

2. Fixtures in rows must be supported by a minimum of one cable (or stem) at the junction of each two fixtures plus one at each end of the row.

This is considered by "Underwriters Laboratories" as equivalent to two cables (or stems) per fixture.

3. These fixture supports are to be used only in conjunction with LITECONTROL products for which they were furnished. DO NOT use them for support of any other items or in any fashion which is contrary to this instruction sheet.

4. Cable assemblies are bulk packed and assembled as shown in View "A". Cables are provided in (3) lengths for ceiling to heights of 6"-48", 6"-84" and 6"-216".

* Note: Support straps are also shipped with FAI/ACC/V assemblies for installation over non-feed outlet boxes.

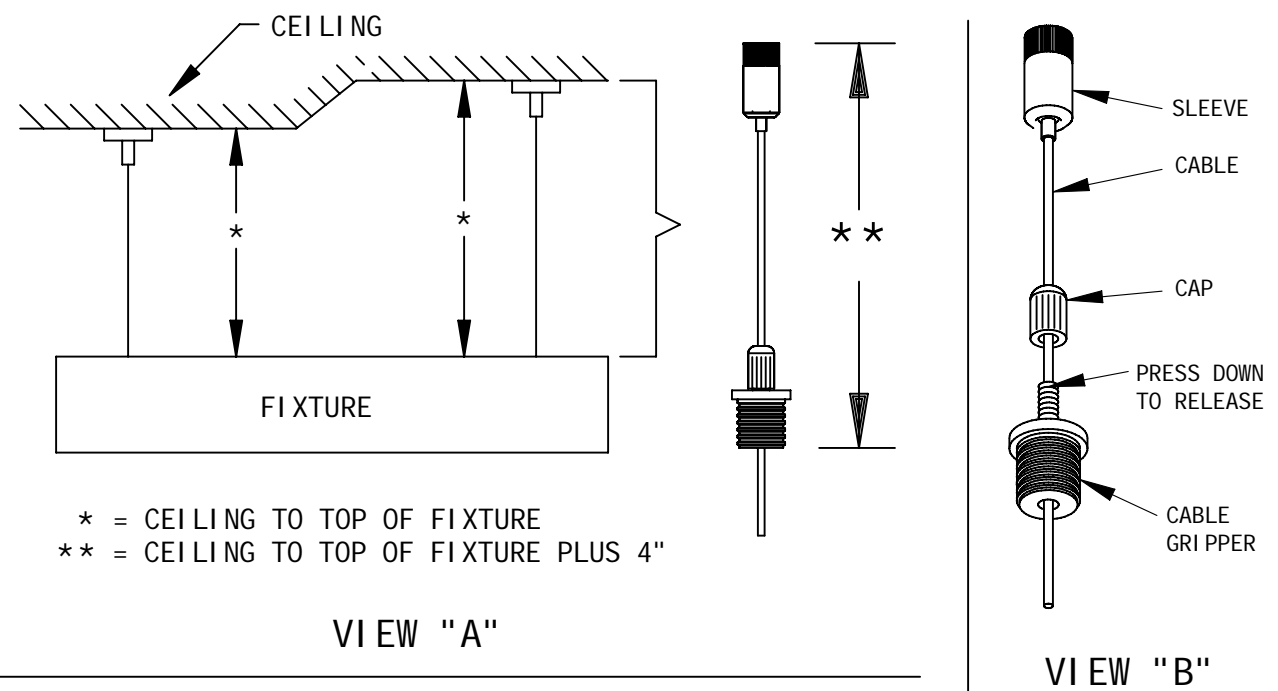
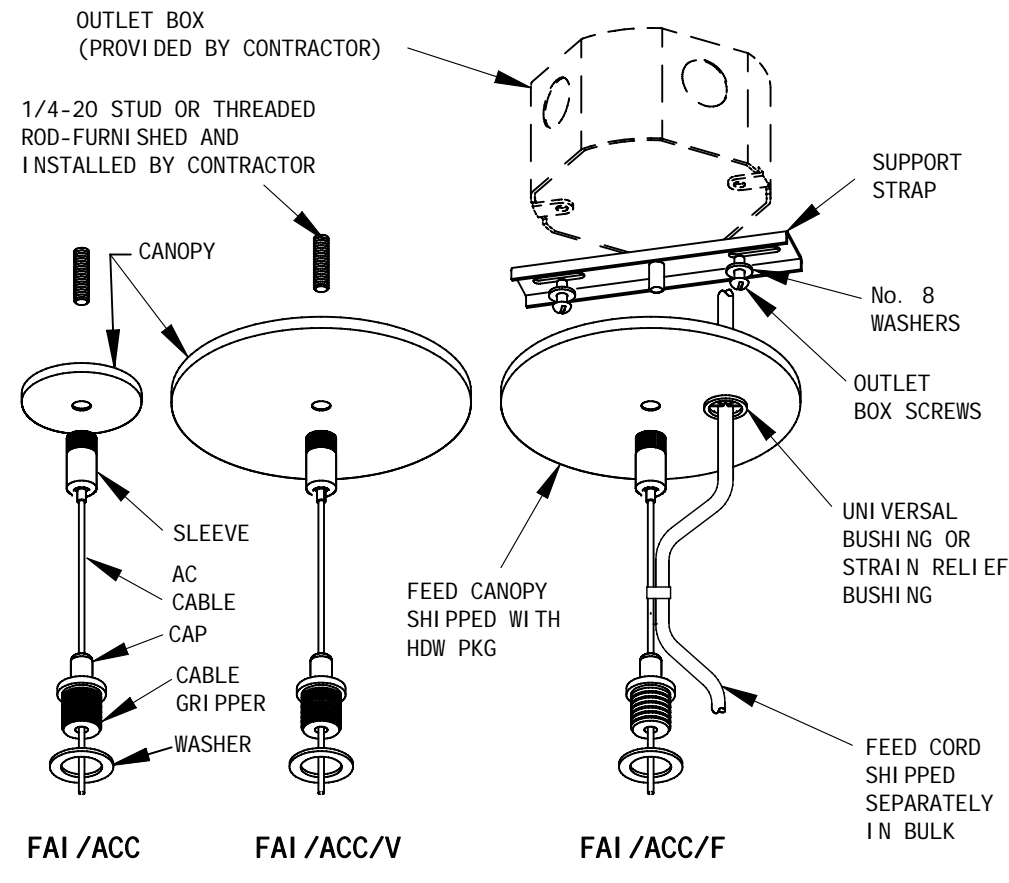

PREPARATION OF CABLE ASSEMBLY:

- A) Unscrew cap from cable gripper as shown in View "B".
- B) Determine the distance from the ceiling to the top of the fixture and add 4" as shown in View "A". This is an approximate ceiling to fixture distance: final adjustment will be made after fixture(s) are hung. Slide gripper to length **, by pressing down on the spring loaded top as shown in View "B". DO NOT screw cap back on at this time.

1. INSTALLATION OF AIRCRAFT CABLE ASSEMBLIES TO CEILING: (Refer to view on the left)

FAI/ACC and FAI/ACC/V:

Place canopy over ceiling stud and screw sleeve to stud.

FAI/ACC/F: Making sure that outlet box is flush with ceiling, mount support

strap to outlet box with outlet box screws and #8 washers. Make wiring connections at box and let feed cord hang down. Press universal bushing into canopy and raise canopy to support strap while leading the feed cord thru bushing. Screw cable sleeve onto support strap stud making sure that canopy is up against ceiling.

INSTALLATION
INSTRUCTIONS

FIXTURE TYPE _____

FAI/ACC, FAI/ACC/F, FAI/ACC/V
FIELD ADJUSTABLE CABLES

P/C 510245-7000

DATE: 9-29-08

PG. 2 OF 2

DO NOT MODIFY OR ALTER THIS PRODUCT IN ANY WAY, OR INSTALL IN ANY FASHI ON WHICH IS CONTRARY TO THE INSTRUCTIONS CONTAINED HEREIN. IF YOU HAVE ANY QUESTIONS REGARDING THIS PRODUCT OR THE INSTALLATION OF IT, PLEASE CALL LITECONTROL ENGINEERING AT 781-294-0100.

2. INSTALLATION OF FIXTURES TO AIRCRAFT CABLE:

Refer to instructions packaged with fixture to prepare it for hanging.

A) FIXTURES MOUNTED THRU A 7/8" DIA. KO: See View "C"

Remove 7/8" KO's in housing and lift fixture up to cable grippers.

Mount gripper thru knockout's in housing. Washer is placed on outside of the housing and Flat strap is threaded onto gripper from inside of housing.

B) FIXTURES MOUNTED WITH FLAT STRAP: See View "D"

INDIVIDUAL FIXTURES: Attach a flat strap to the underside of support angle at each end of fixture using (1) #8-32 x 3/8" hex head screw.

ROW OF FIXTURES: A Flat Strap is attached underneath the fixture support angle at the end of the row where end cap is located. At row joint between two fixtures another Flat Strap is attached with (1) #8-32 hex head screw and positioned so that half of it protrudes out from end of fixture. Abutting fixture is lifted onto this strap and secured with another #8-32 screw.

C) Lift fixture up to cable assemblies, slide washer onto gripper and thread grippers into flat straps until tight against fixture support angles.

3. While holding fixture, adjust gripper up or down on cable to position fixture in its final location and level. Thread caps back onto grippers.

4. Tie a knot in cables 2-3" from inside of fixture and trim any excess cable. (Use a tool such as locking pliers to tighten knot).

5. INSTALLATION OF FEED CORD INTO FIXTURE: (CATALOG DESIGNATOR "FAI/ACC/F")

Note: Feed cord is shipped separately in bulk. Bushings and canopy are shipped in hardware package.

A) Remove a 5/8" or 7/8" knockout at feed location. Run feed cord down along aircraft cable and insert into knockout with strain relief bushing.

Both straight and right angle strain relief bushings have been provided: use the one which best suits your particular wire routing situation and discard the other.

B) Make wiring connections inside fixture wireway in accordance with the NEC and any local codes.

C) Using the nylon tie fasteners provided, secure feed cord to cable every 4-5". Snip off loose ends of the fasteners.

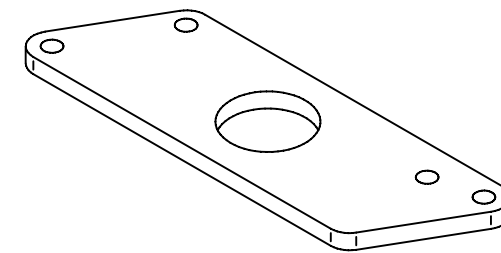

FLAT STRAP MOST FIXTURES

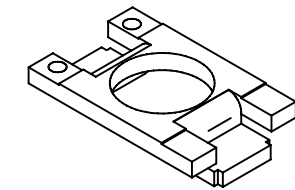

EXTRUDED FLAT STRAP

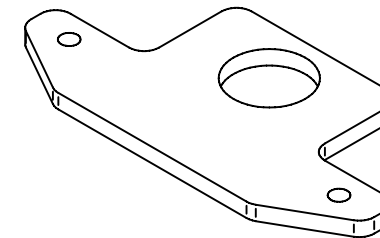

FLAT STRAP 4 LITE PI 9800

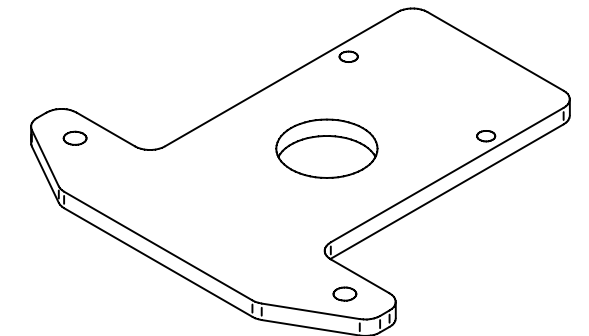

FLAT STRAP 4 LITE PI 9800
ROW JOINT

NOTE: PENDING TYPE OF FIXTURE, EITHER OF THE ABOVE FLAT STRAPS MAY BE SHIPPED IN HARDWARE PACKAGE. REFER TO FIXTURE INSTRUCTIONS FOR ATTACHMENT.

