

IMPORTANT SAFETY INFORMATION. READ AND FOLLOW ALL SAFETY INSTRUCTIONS. Follow label information and instructions concerning Wet or Damp Locations, installation near combustible materials, insulation, building materials, and proper lamping. Do not install in areas subject to combustible vapors or gases. Before wiring to power supply and during servicing or relamping, turn off power at fuse or circuit breaker. **All servicing or relamping must be performed by qualified service personnel. Product must be grounded to avoid potential electric shock or other potential hazard. Product must be mounted in locations and at heights and in a manner consistent with its intended use, and in compliance with the National Electrical Code and local codes.** The use of accessory equipment not recommended by the manufacturer or installed contrary to instructions may cause an unsafe condition. Do not block light emanating from product in whole or part, as this may cause an unsafe condition. Do not allow items such as drapes, curtains, screens or the like to come into contact with the product or to block light from the product, as this may cause an unsafe condition.

INSTALLATION INSTRUCTIONS AKTMNA / AKTMDA

FOR USE WITH PRESCOLITE AKTM SERIES TRACK HEADS ONLY.

THE AKTM SERIES LENS HOLDERS ARE DESIGNED TO ACCOMMODATE UP TO 2 LENS/LOUVER MEDIA (ORDERED SEPARATELY).

DO NOT ATTEMPT TO DISASSEMBLE THE EXISTING TRACK HEAD LENS.

1. Place desired lens/media into silicone spacer. (Repeat if (2) desired.)
2. Position lens/media assembly into bottom of lens holder as shown in Fig 2.
3. Insert (1) provided thumb screw into track head.
4. Slide lens/media holder over track head aligning open slot with thumb screw.
*Push all the way up, engaging into fixture. Securely finger tighten thumb screw.
5. Insert second thumb screw through other slot and securely finger tighten.

ENSURE CORRECT LINEAR
LENS ORIENTATION
PRIOR TO INSTALLATION

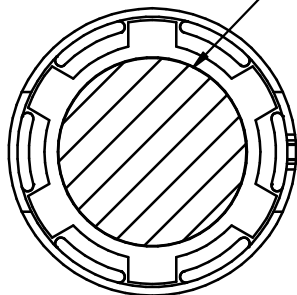

FIG. 2

AKTM SERIES TRACK HEAD
(ORDER SEPARATELY)

THUMB SCREW
x2

LENS
(ORDER SEPARATELY)

SILICONE SPACER
x2

LENS HOLDER
CLOSED SLOT

LENS HOLDER
OPEN SLOT

LENS HOLDER

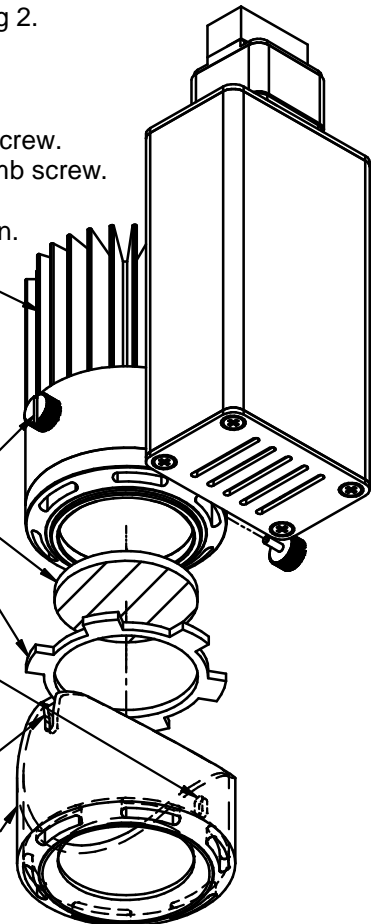

FIG. 1

KEEP THESE INSTALLATION INSTRUCTIONS



701 Millennium Blvd • Greenville, SC 29607
With representatives offices in principal cities throughout North America.
Copyright 2018, 07/09/18 revision, All Rights Reserved - Printed in U.S.A.

Hubbell Lighting, Inc.

