

**IMPORTANT SAFETY INFORMATION. READ AND FOLLOW ALL SAFETY INSTRUCTIONS.** Follow label information and instructions concerning Wet or Damp Locations, installation near combustible materials, insulation, building materials, and proper lamping. Do not install in areas subject to combustible vapors or gases. Before wiring to power supply and during servicing or relamping, turn off power at fuse or circuit breaker. **All servicing or relamping must be performed by qualified service personnel. Product must be grounded to avoid potential electric shock or other potential hazard. Product must be mounted in locations and at heights and in a manner consistent with its intended use, and in compliance with the National Electrical Code and local codes.** The use of accessory equipment not recommended by the manufacturer or installed contrary to instructions may cause an unsafe condition. Do not block light emanating from product in whole or part, as this may cause an unsafe condition. Do not allow items such as drapes, curtains, screens or the like to come into contact with the product or to block light from the product, as this may cause an unsafe condition.

## INSTALLATION INSTRUCTIONS LITEISTRY™ LTR-3/4/6SQD/SQW

**CAUTION: TO REDUCE THE RISK OF ELECTRICAL SHOCK, MAKE CERTAIN THAT THE POWER SUPPLY IS OFF BEFORE INSTALLING OR SERVICING THIS FIXTURE!**

### Fixture Housing and Hanger Mount

1. Install the fixture in the ceiling using the two hanger bars (1) (supplied), or mounting channel or bars (by others) placed in the adjustable mounting brackets (2). Mount the fixture in the ceiling so that the weight of the fixture is supported by the hanger bars, mounting channel, bar, and/or hanger wires secured to the building structure.
2. Adjust the fixture so the bottom of the plaster flange opening is flush with the finished ceiling line and in alignment with adjacent fixtures. Secure mounting brackets by tightening two wing nuts (3) on either side of the fixture.
3. Determine where the supply wiring conduit will enter the J-Box, remove knockout, and fasten the conduit in conformance with the National Electric Code.
4. Remove J-Box cover plate (4). Assemble using appropriate connectors for the supply wire used. Connect ground wires to green ground lead(s). Connect white (common) to white lead(s). Connect power supply (line) to black lead(s). Reinstall J-Box cover (4). **WARNING: DO NOT pinch wires between J-Box/ballast cover and J-Box. Consult a qualified electrician for all other options that require other wiring configurations.**
5. Pull electrical cover (5) and power cable down below ceiling through opening in fixture.

### For LTR-4/6 Fixtures:

6. Insert connector (6) into connector (7) and snap firmly together.
7. Carefully feed wire and connectors (6) & (7) into electrical box (8). Place electrical cover (5) with attached thumbscrew (10) into position on electrical box. Tighten thumbscrew (10) to secure cover (5) into place.
8. Squeeze two torsion springs (12) together and insert ends into two brackets (13). Push trim assembly up towards ceiling until springs draw trim firmly against the ceiling. (**NOTE:** For wall wash fixtures, insert the trim so that the plastic lens faces toward the wall. See illustration on sheet 2.)

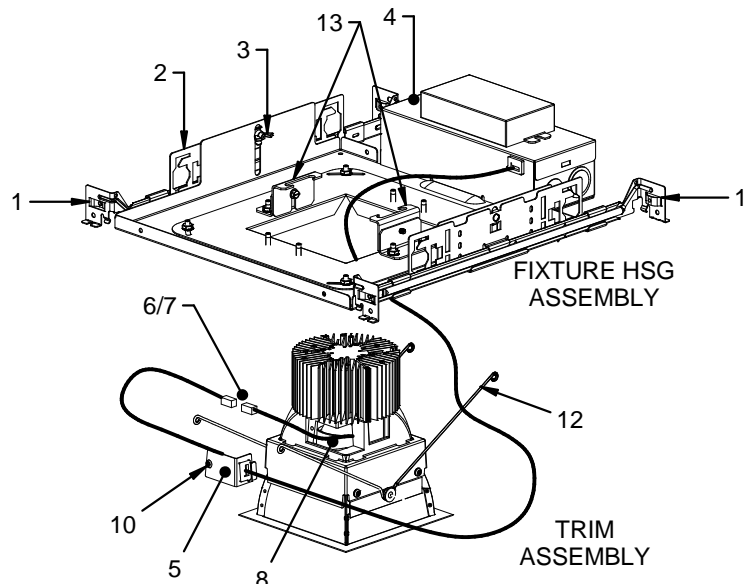
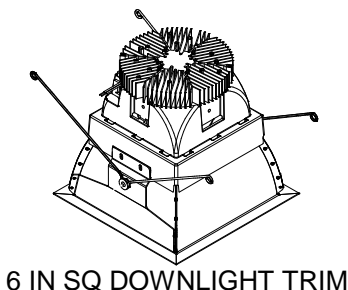
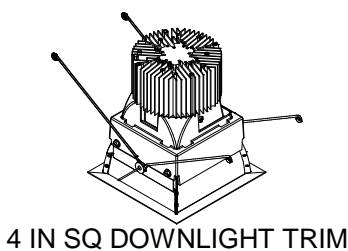

## INSTALLATION INSTRUCTIONS LITEISTRY™ LTR-3/4/6SQD/SQW

**CAUTION: TO REDUCE THE RISK OF ELECTRICAL SHOCK, MAKE CERTAIN THAT THE POWER SUPPLY IS OFF BEFORE INSTALLING OR SERVICING THIS FIXTURE!**

### CORRECT ORIENTATION OF WALL WASH TRIMS

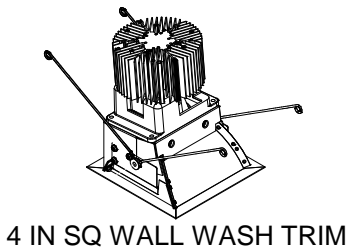
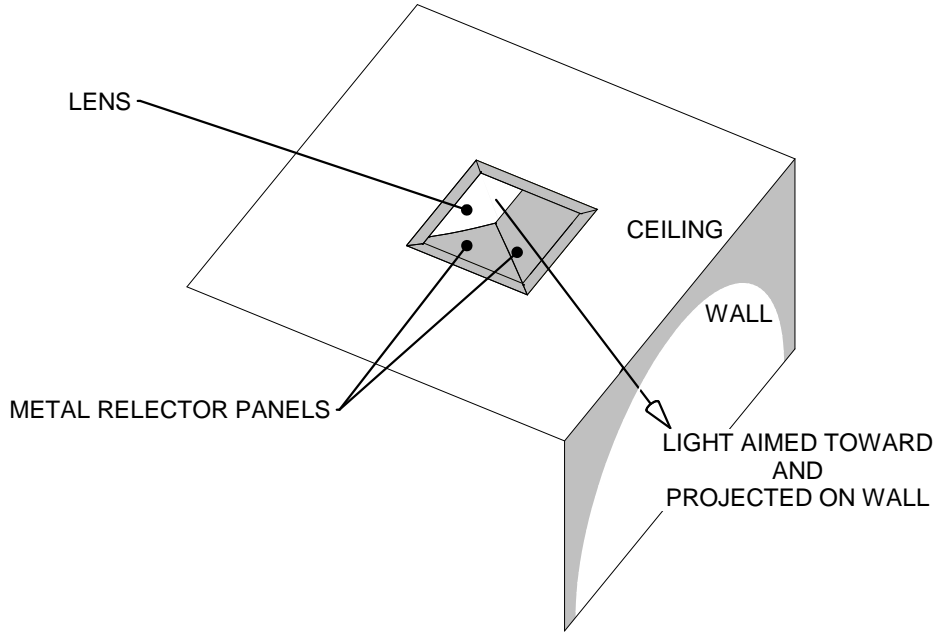

4 IN SQ WALL WASH TRIM

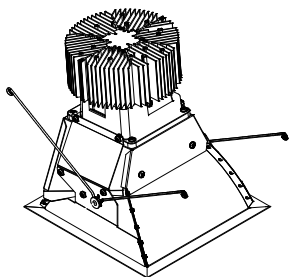

6 IN SQ WALL WASH TRIM

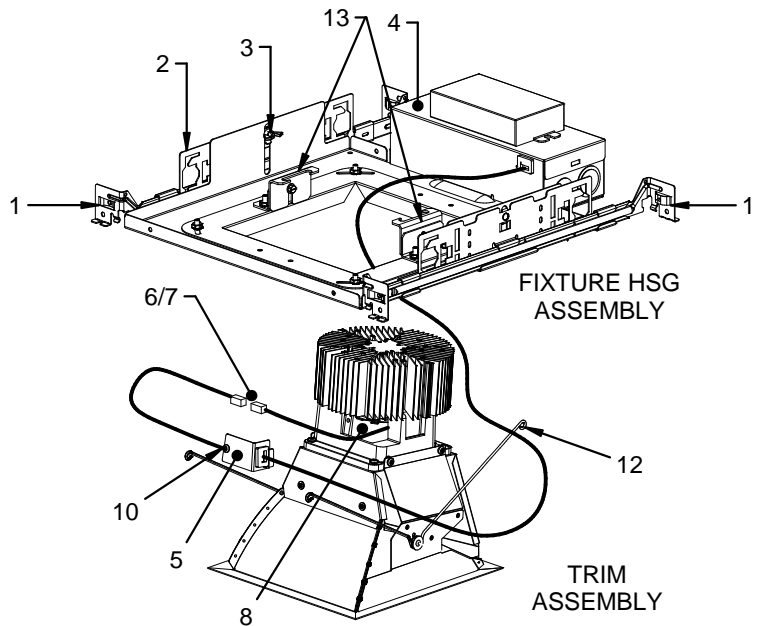

**CAUTION: DO NOT ATTEMPT TO MODIFY OR REWIRE FACTORY-INSTALLED WIRING ON THE FIXTURE. SAFETY AND PROPER OPERATION OF THE FIXTURE DEPEND ON THE INTEGRITY OF THE WIRING.**

KEEP THESE INSTALLATION INSTRUCTIONS



Hubbell Lighting, Inc.

701 Millennium Blvd • Greenville, SC 29607  
With representatives offices in principal cities throughout North America.  
Copyright 2019, 08/08/19 revision, All Rights Reserved - Printed in U.S.A.



## INSTALLATION INSTRUCTIONS LITEISTRY™ LTR-3/4/6SQD/SQW

**CAUTION: TO REDUCE THE RISK OF ELECTRICAL SHOCK, MAKE CERTAIN THAT THE POWER SUPPLY IS OFF BEFORE INSTALLING OR SERVICING THIS FIXTURE!**

### Fixture Housing Mount with Hanger

1. Install the fixture in the ceiling using the two hanger bars (1) (supplied), or mounting channel or bars (by others) placed in the adjustable mounting brackets (2). Mount the fixture in the ceiling so that the weight of the fixture is supported by the hanger bars, mounting channel, bar, and/or hanger wires secured to the building structure.
2. Adjust the fixture so the bottom of the plaster flange opening is flush with the finished ceiling line and in alignment with adjacent fixtures. Secure mounting brackets by tightening two wing nuts (3) on either side of the fixture.
3. Determine where the supply wiring conduit will enter the J-Box, , remove knockout, and fasten the conduit in conformance with the National Electric Code.
4. Remove J-Box cover plate (4). Assemble using appropriate connectors for the supply wire used. Connect ground wires to green ground leads. Connect white (common) to white lead(s). Connect power supply (line) to black lead(s). Reinstall J-Box cover (4). **WARNING: DO NOT pinch wires between J-Box/ballast cover and J-Box. Consult a qualified electrician for all other options that require other wiring configurations.**
5. Pull electrical cover (5) and power cable down below ceiling through opening in fixture.

### For LTR-3SQ Fixtures:

6. Insert connector (6) into connector (7) and snap firmly together.
7. Carefully route wires and connectors (6) & (7) into opening area on side of electrical box (8). Slide electrical cover assembly (10) onto electrical box (8) by placing tab (9) on top of cover into notch (10) on top of box, then guide slot (4) on cover over loosened thumb screw (5). Tighten thumb screw (5) to secure electrical cover assembly (10) to the electrical box (8) to each other.
8. Feed the electrical box (10+8) and cable up through the 3x3 opening in the fixture panel and out of the way.
9. Rotate two torsion springs (12) upward along the sides of the trim and insert through opening. Push trim assembly up towards ceiling through the 3x3 opening until springs draw trim firmly against the ceiling. (**NOTE:** For wall wash fixtures, insert the trim so that the plastic lens faces toward the wall. See illustration on sheet 2)

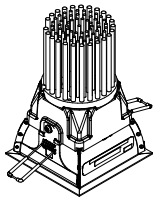

3 IN SQ DOWNLIGHT TRIM

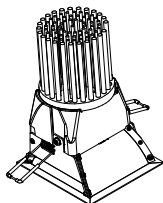

3 IN SQ WALL WASH TRIM

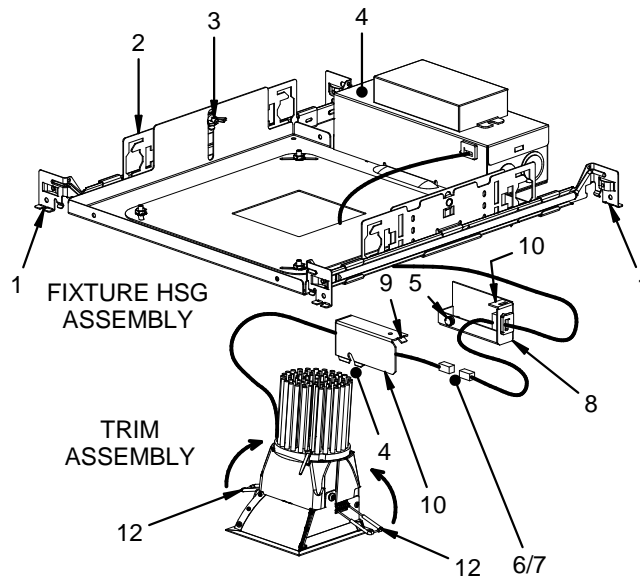

**CAUTION: DO NOT ATTEMPT TO MODIFY OR REWIRE FACTORY-INSTALLED WIRING ON THE FIXTURE. SAFETY AND PROPER OPERATION OF THE FIXTURE DEPEND ON THE INTEGRITY OF THE WIRING.**

KEEP THESE INSTALLATION INSTRUCTIONS



Hubbell Lighting, Inc.

701 Millennium Blvd • Greenville, SC 29607  
With representatives offices in principal cities throughout North America.  
Copyright 2019, 08/08/19 revision, All Rights Reserved - Printed in U.S.A.



## INSTALLATION INSTRUCTIONS LITEISTRY™ LTR-3/4/6SQD/SQW

**CAUTION: TO REDUCE THE RISK OF ELECTRICAL SHOCK, MAKE CERTAIN THAT THE POWER SUPPLY IS OFF BEFORE INSTALLING OR SERVICING THIS FIXTURE!**

### LTR-3SQ DL and LWW Remodel Installation

This version consists of two main components: the power cable assembly and the trim assembly. The power cable with a J-Box (1+2), the LED Driver attached to a metal electrical box (8+10) at the other, connected with a length of flexible metal conduit (11). The trim, which is the light fixture portion of the product, also has a thin cable and a metal plate and connector on the other end.

Before the ceiling is finished, run the appropriate line voltage wiring (and 0-10V dimming control wiring if applicable) to the approximate location where the fixture will be installed.

1. Precisely layout and cut a 3.3 x 3.3 inch square opening in the ceiling, aligning the cutout with adjacent fixture cutouts (if any) and keeping the straight edges of the cutout perpendicular and parallel with any adjacent walls and fixtures. Slight position adjustment of each trim is possible once installed.
2. Pull the supply wiring conduit through the opening. This will be wired and attached to the J-Box (1) in conformance with the National Electric Code.
3. Loosen (but do not remove) screw (3) and remove J-Box cover plate (2). Remove appropriate knockout and fasten to the J-Box using the appropriate connector for the conduit used. Connect ground wires to green ground lead(s). Connect white (common) to white lead(s). Connect power supply (line) to black lead(s). Reinstall J-Box cover (2). **WARNING: DO NOT pinch wires between J-Box/ballast cover and J-Box. Consult a qualified electrician for all other options that require other wiring configurations.**
4. Push the J-Box through the opening and out of the way.
5. Insert connector (6) into connector (7) and snap firmly together.
6. Carefully route wires and connectors (6) & (7) into opening area on side of electrical box (8). Slide electrical cover (10) onto electrical box (8) by placing tab (9) on top of cover into notch (10) on top of box, then guide slot (4) on cover over loosened thumb screw (5). Tighten thumb screw (5) to secure electrical covers (8/10) to each other.
7. Feed electrical cover assembly (8+10) into ceiling cutout and out of the way.
8. Rotate the two spring loaded arms (12) upward (in direction shown) along the sides of the fixture and carefully insert the trim assembly through the ceiling cutout. Push trim assembly up into ceiling until springs draw trim firmly against the ceiling and the outer flanges are flush with the ceiling. (NOTE: For wall wash fixtures, insert the trim so that the inside reflective surface of the wall wash kicker faces the wall.)

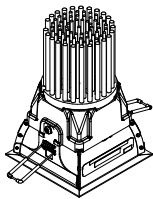

3 IN SQ DOWNLIGHT TRIM

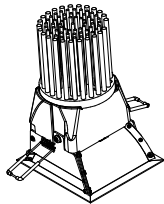

3 IN SQ WALL WASH TRIM

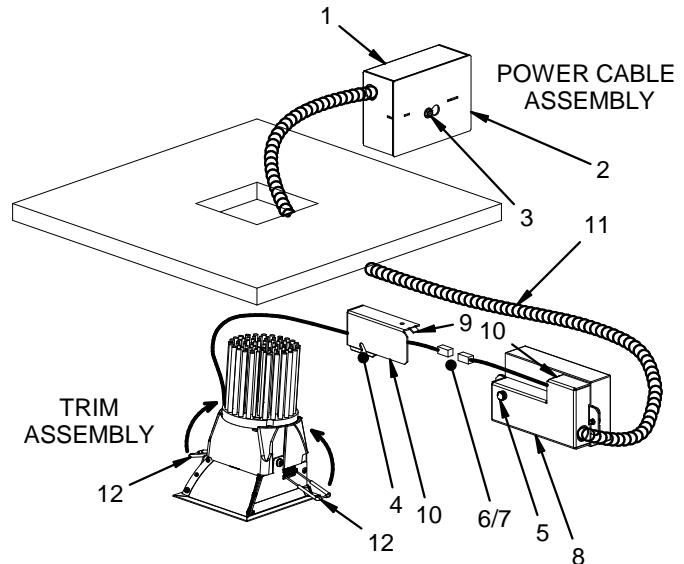

**CAUTION: DO NOT ATTEMPT TO MODIFY OR REWIRE FACTORY-INSTALLED WIRING ON THE FIXTURE. SAFETY AND PROPER OPERATION OF THE FIXTURE DEPEND ON THE INTEGRITY OF THE WIRING.**

KEEP THESE INSTALLATION INSTRUCTIONS



Hubbell Lighting, Inc.

701 Millennium Blvd • Greenville, SC 29607  
With representatives offices in principal cities throughout North America.  
Copyright 2019, 08/08/19 revision, All Rights Reserved - Printed in U.S.A.

