

Overhead Secondary Networks

Insulation Piercing Connector

BIPC



WIRE CONNECTOR
54DB

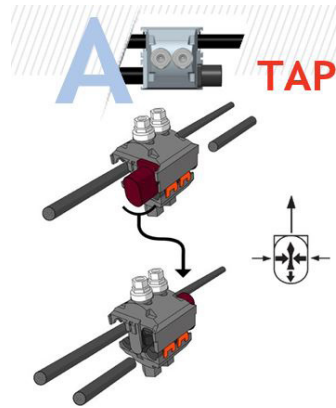

Remove the main cap and adjust the position of the tap seal cap as needed.

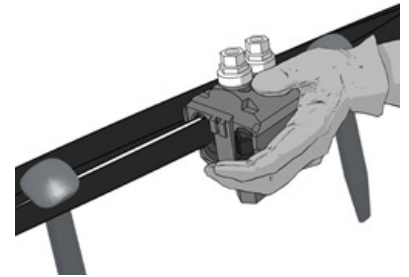

Place the 'Main' interface of the connector onto the main conductor.

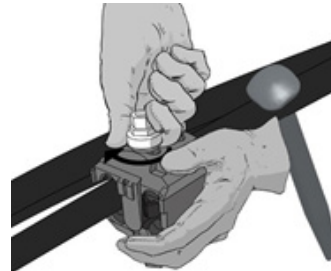

Hand-tighten the connector onto the main cable until it maintains its position.



Ensure the tap cable is fully inserted into the cap, continuing until it reaches a stop.

SUITABLE FOR USE ON THE LINE SIDE OF SERVICE EQUIPMENT.

This product should only be installed by a competent person with sufficient training in safety and installation practices regarding electrical equipment. Local legislation and work instructions issued by the employer per training and installation of such electrical equipment shall be respected at all times by said person, and take precedence over this instruction. BURNDY® accepts no liability concerning claims resulting from misuse, improper installation, ignored instructions or other national provisions, or neglected safety regulations.

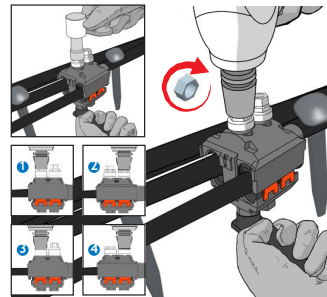

Utilize either an impact wrench or a hex socket wrench for manual connector tightening. Alternate tightening as demonstrated in the image.



Secure the tap cable by using a plastic tie.



IMPACT
WRENCH

This BURNDY® product may be installed with an impact wrench.

BURNDY® BIPC insulation piercing connectors can be installed with circular, regular-stranding, rigid and solid cable cores. The cables' working temperature is up to 194°F / 90°C.

If you have any questions or concerns regarding proper installation, please delay installation and seek clarification.



B SPLICE

C DEAD-END

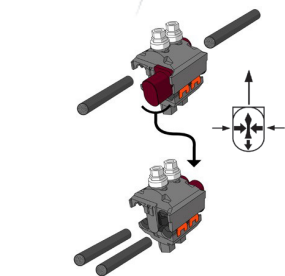

Change the position of the seal cap as necessary.

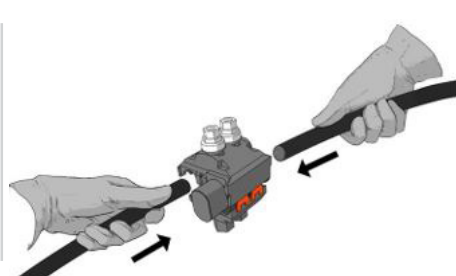

Ensure the cables are fully inserted into the caps, continuing until it reaches a stop.

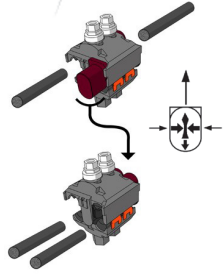

Change the position of the seal cap as necessary.

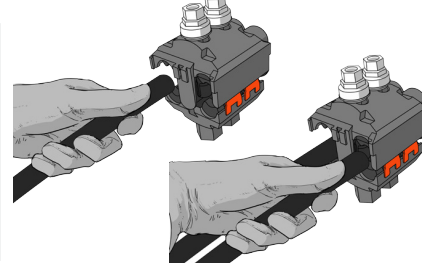

Ensure the cables are fully inserted into the caps, continuing until it reaches a stop.

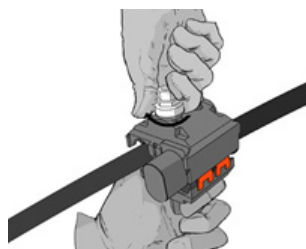

Hand-pretighten the connector onto the cables.

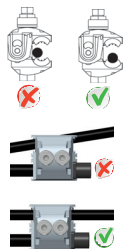

Make sure the conductors are well positioned in the connector interfaces.

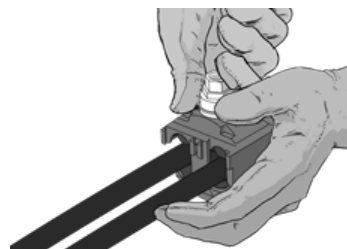

Hand-pretighten the connector onto the cables.

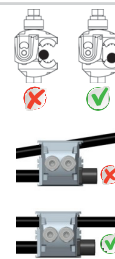

Make sure the conductors are well positioned in the connector interfaces.

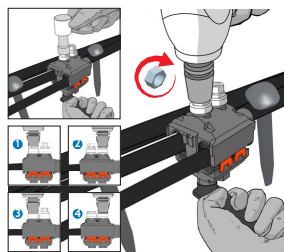

Utilize either an impact wrench or a hex socket wrench for manual connector tightening. Alternate tightening as demonstrated in the image.

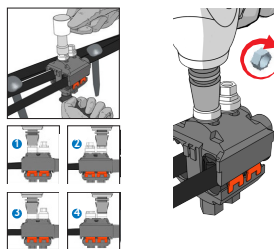
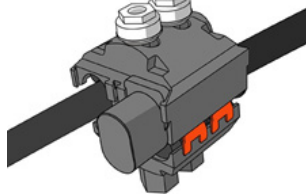

Utilize either an impact wrench or a hex socket wrench for manual connector tightening. Alternate tightening as demonstrated in the image.

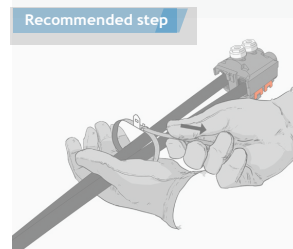

Secure the tap cable by using a plastic tie.

Size Marked on Connector, TTD_10	Catalog Number	Run	Range	Thickness Range	Wire Size (Blue: Run Range; Red:Tap Range)																	
		14			12	10	8	6	4	3	2	1	1/0	2/0	3/0	4/0	250	300	350	500	750	
10	BIPC1/010SC	Run	#8 -1/0	.045 - .080																		
		Tap	AL - #8-#2 CU - #10-#2	.030 - .060																		
18	BIPC1/08SC	Run	#8-1/0	.040 - .080																		
		Tap	#8-1/0	.040 - .080																		
5	BIPC2/014S	Run	AL - #4-2/0 CU - #6-2/0	.045 - .080																		
		Tap ***	AL - #12-#10 CU - #14-#8	.030 - .060																		
15	BIPC4/010S	Run	#3-4/0	.040 - .080																		
		Tap	AL - #8-#2 CU - #10-#2	.030 - .060																		
27	BIPC2506SC	Run	#4-250	.040 - .095																		
		Tap	#6-4/0	.040 - .080																		
40	BIPC3501/0SC	Run	1/0-350	.045 - .095																		
		Tap	1/0-350	.045 - .095																		
29	BIPC50010SC*	Run	3/0-500	.050 - .110																		
		Tap	#10-#2	.030 - .060																		
43	BIPC5004SC	Run	2/0-350(500**)	.045 - .130																		
		Tap	#4-4/0	.040 - .080																		
45	BIPC5001/0S	Run	4/0-500	.050 - .130																		
		Tap	1/0-350	.045 - .095																		
50	BIPC5004/0SC*	Run	4/0-500	.050 - .130																		
		Tap	4/0-500	.050 - .130																		
8	BIPC75014	Run	3/0-750	.050 - .110																		
		Tap ***	AL - #12-#10 CU - #14-#10	.030 - .045 .030 - .044																		
53	BIPC7502SC*	Run	250-500(750**)	.060 - .130																		
		Tap	#2-4/0	.040 - .080																		
55	BIPC750250SC	Run	250-500(750**)	.060 - .130																		
		Tap	250-500	.060 - .130																		

The above table denotes the cable range for each size of BURNDY BIPC connector as well as the corresponding TTD marking on the connector

* NOT cULus LISTED

** WIRE SIZE IN PARENTHESES INDICATES THE EXPANDED WIRE RANGE. TO ACHIEVE A SEAL WITH ANY SIZES ABOVE THE STANDARD RUN RANGE, UP TO THIS SIZE, THE CONNECTOR MUST BE IN TAP ORIENTATION WITH THE RUN CAP REMOVED. OTHERWISE, ADDITIONAL MEANS TO SEAL THE CUT-END OF THE CABLE ARE REQUIRED FOR CONNECTORS USED IN SPLICE OR DEAD-END

*** FOR SVC APPLICATIONS, TAP RANGE ONLY APPLIES TO Cu CONDUCTOR.

NOTE:

Burndy Catalog Numbers showing suffix 'S' come with red spacer component, to be left in during install.

Burndy Catalog Numbers showing suffix 'SC' come with red spacer component as well as end caps installed, end caps can be rearranged to meet connector install requirements (tap, splice, or dead end).

!! IMPORTANT REMINDER !!

MAIN side of the connector is the "open side."
TAP side of the connector is the side where the marking is located.

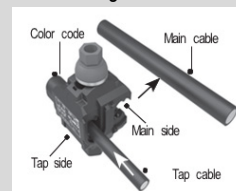

BURNDY, LLC
47 East Industrial Park Drive
Manchester, NH 03109

1-800-346-4175 www.hubbell.com

ITEM # 50124720
REV. G