

RATCHET LOCK USE

Engage ratchet lock by pulling cable out to desired position and letting it retract SLOWLY until lock engages. To release lock, pull cable out a short distance and allow it to begin to rewind—it operates like a window shade.

DANGER

DO NOT allow cable to retract in an uncontrolled manner. Always guide cable back to reel. Failure to do so can result in damage to reel or personal injury.

SERVICE

REGULAR MAINTENANCE

1. No lubrication is required.
2. Periodically check cable for wear. **If wear is detected, cable should be replaced immediately.** If cable replacement is required, order cable kit of required length and connector type. Refer to Parts List (inside).

NOTE: When installing new cable, be sure tension ball near spool end of cable is on outside of spool with cable in keyed slot and eye secured on stud **with star washer on both sides of eye.** To facilitate winding cable on spool, it is recommended that springs be removed so that spool can “free wheel”. Refer to “Spring Replacement” (below) and Illustrated Parts List.

DANGER

DO NOT attempt to remove spring motor from its canister. Doing so can result in damage to reel or personal injury.

SPRING REPLACEMENT

Spring motors are self-contained for safe and easy handling. If replacement of both spring motors is required, order one each of items 2 and 3. If only one spring needs replacing, be sure to order correct unit (with or without arbor). See Parts List (inside) for details. When installing springs, slide each spring onto shaft in turn and make sure end of each spring is hooked to step on arbor. Use a small screwdriver through holes in spring housing to guide hook into place.

RATCHET LOCK REPLACEMENT

For your convenience, the locking dog for the ratchet has been included in an easily installed, pre-assembled kit, Item No. 5.



600 South Clark St.
Mayville, WI 53050
Phone: 920-387-4120 | Fax: 920-387-4189
www.hubbell-gleason.com

INSTALLATION & MAINTENANCE INSTRUCTIONS

OPEN SPOOL STATIC DISCHARGE REELS

INSTALLATION

CAUTION

Be sure reel base is securely grounded to mounting surface. On painted surfaces, remove paint at bolt location, use external tooth lockwashers, or run ground wire from reel base to grounded object. **Check for continuity following installation. Failure to ground will prevent reel from performing its intended function and could result in personal injury.**

Mount reel to grounded, metal surface using four holes in mounting base. To minimize wear on cable and cable guide, reel should be mounted in direct line with work so that cable is pulled out as straight as possible during use. See figures 1 & 2.

Figure 1

Avoid pulling cable out of reel at an angle.

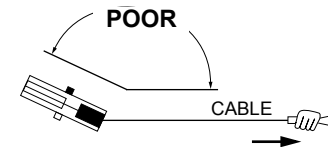
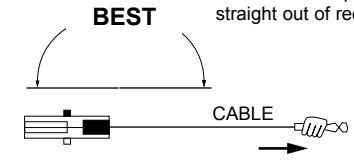

Figure 2

For best results and long cable life, mount reel so that cable can be pulled straight out of reel.



TENSION ADJUSTMENT

INCREASE TENSION only if reel will not completely wind cable so that cable stop reaches guide.

1. While holding spool so it will not turn, pull cable that does not automatically rewind onto reel back through guide and loop around spool (Fig. 3).
2. Pull out 10' of cable and allow to rewind. Repeat step 1 until cable rewinds completely with cable stop barely reaching guide.

Figure 3

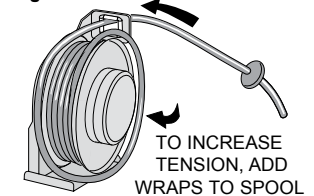

TO INCREASE TENSION, ADD WRAPS TO SPOOL

DECREASING TENSION is NOT recommended and should not be necessary as the reel is shipped with minimum tension required to wind installed cable.

1. While holding spool so it will not turn, remove one loop of cable from spool (Fig. 4).
2. Test by pulling out cable and allowing it to rewind. Repeat step 1 if necessary.

Figure 4

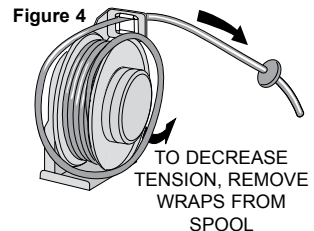

TO DECREASE TENSION, REMOVE WRAPS FROM SPOOL

OPEN SPOOL STATIC DISCHARGE REEL ILLUSTRATED PARTS LIST

Only parts listed below are available for replacement.

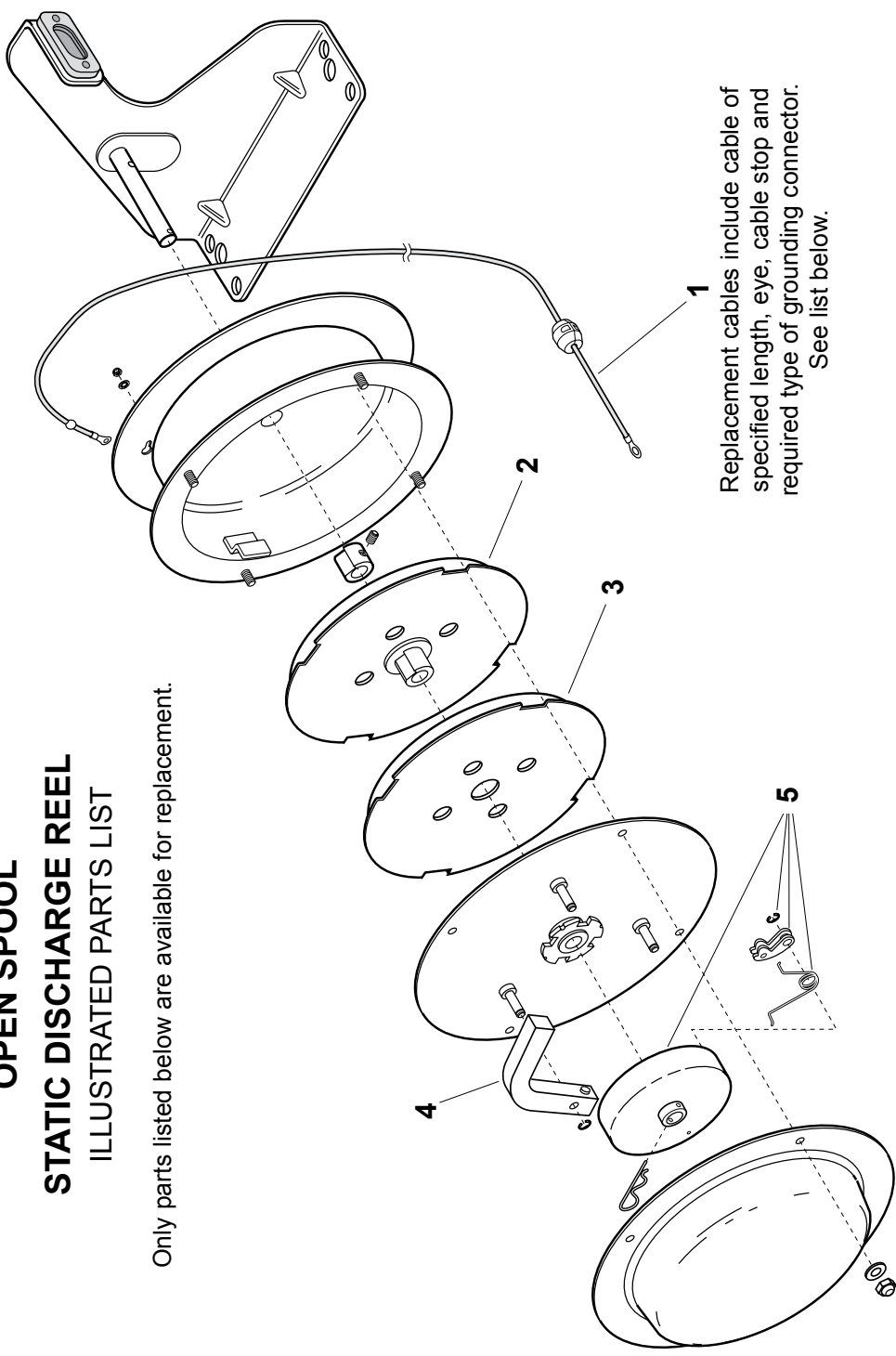

Replacement cables include cable of specified length, eye, cable stop and required type of grounding connector. See list below.

ITEM NO.	QTY.	DESCRIPTION	PART/KIT NUMBER
1	1	50' Cable Assembly with Alligator Clip	60919204
1	1	50' Cable Assembly with Hand Clamp w/ Screws	60919205
1	1	50' Cable Assembly with Aircraft Clamp	60919206
1	1	50' Cable Assembly with Plug w/ Round Knurled Grip	60919207
1	1	50' Cable Assembly with Plug w/Hex Body	60919208
1	1	75' Cable Assembly with Alligator Clip	60919004
1	1	75' Cable Assembly with Hand Clamp w/ Screws	60919005
1	1	75' Cable Assembly with Aircraft Clamp	60919006
1	1	75' Cable Assembly with Plug w/ Round Knurled Grip	60919007
1	1	75' Cable Assembly with Plug w/Hex Body	60919008
1	1	100' Cable Assembly with Alligator Clip	60919104
1	1	100' Cable Assembly with Hand Clamp w/ Screws	60919105
1	1	100' Cable Assembly with Aircraft Clamp	60919106
1	1	100' Cable Assembly with Plug w/ Round Knurled Grip	60919107
1	1	100' Cable Assembly with Plug w/Hex Body	60919108
2	1	Spring Motor Assembly w/Arbor (inside spring)	609159
3	1	Spring Motor Assembly w/out Arbor (outside spring)	609165
4	3	Brake Bar Assembly	609172
5	1	Ratchet Dog Housing Kit Includes Housing, Locking Dog Pawl, Spring and Retaining Ring	609176

