

INSTALLATION & MAINTENANCE INSTRUCTIONS

RETRIEVER REELS

INSTALLATION

To minimize wear on cable and cable guide, reel should be mounted in direct line with work so that cable is pulled out as straight as possible during use. Reels are available in two mounting types: (A) with pull parallel to mounting surface. (B) with pull perpendicular to mounting surface. See figures 1 & 2. Choose type which provides payout in most direct line to attachment. In addition, mount reel so that axis is perpendicular to most common payout. See figures 3 & 4.

1. Mount reel to firm, secure surface using four holes in mounting base.

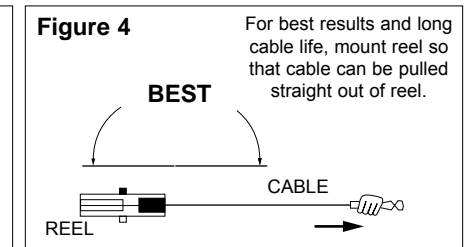
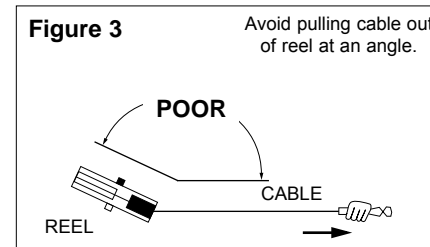
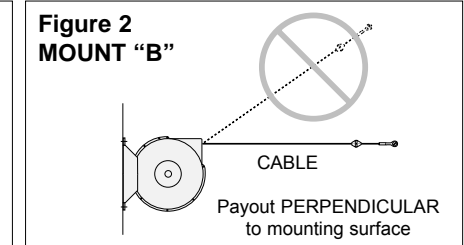
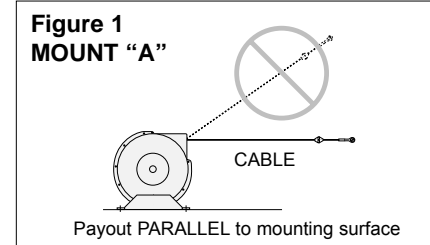

TENSION ADJUSTMENT

INCREASE TENSION if reel will not completely wind cable so that cable stop reaches guide.

1. Allow cable to retract as far as possible.
2. Place wrench on flats of shaft. Turn shaft **counter-clockwise** until cable stop reaches guide.

DECREASING TENSION is NOT recommended and should not be necessary as the reel is shipped with minimum tension required to wind installed cable.

1. Place wrench on flats of shaft.
2. Hold shaft **firmly** with wrench. Depress spring on opposite side of reel.
3. Allow shaft to turn **SLOWLY** in **clockwise** direction until desired tension is achieved. If shaft will not turn in clockwise direction **UNASSISTED**, reel is at minimum tension and further tension reduction should not be attempted.

⚠ DANGER

DO NOT allow cable to retract in an uncontrolled manner. Always guide cable back to reel. Failure to do so can result in damage to reel or personal injury.

SERVICE

REGULAR MAINTENANCE

1. Reel is factory lubricated for life. No additional lubrication is required.
2. Periodically check cable for wear. **If wear is detected, cable should be replaced immediately.** If cable replacement is required, order cable Assembly Kit No.5 which contains cable and related parts, hardware and instructions. See Parts List (inside) for details.

SPRING REPLACEMENT

⚠ DANGER

DO NOT attempt to remove spring motor from its canister. Doing so can result in damage to reel or personal injury.

Spring motors are self-contained for safe and easy handling. If spring motor replacement is required, it should be replaced as a unit by ordering Spring Motor Assembly Kit No. 1 which contains the spring motor, spool, shaft & bushings in a sealed canister. See Parts List (inside) for details.



Workplace Solutions

600 South Clark St.
Mayville, WI 53050
Phone 920-387-4120
FAX 920-387-4189

CONTINUED ON BACK PAGE

RETRIEVER REEL ILLUSTRATED PARTS LIST

Replacement parts available as kits only.

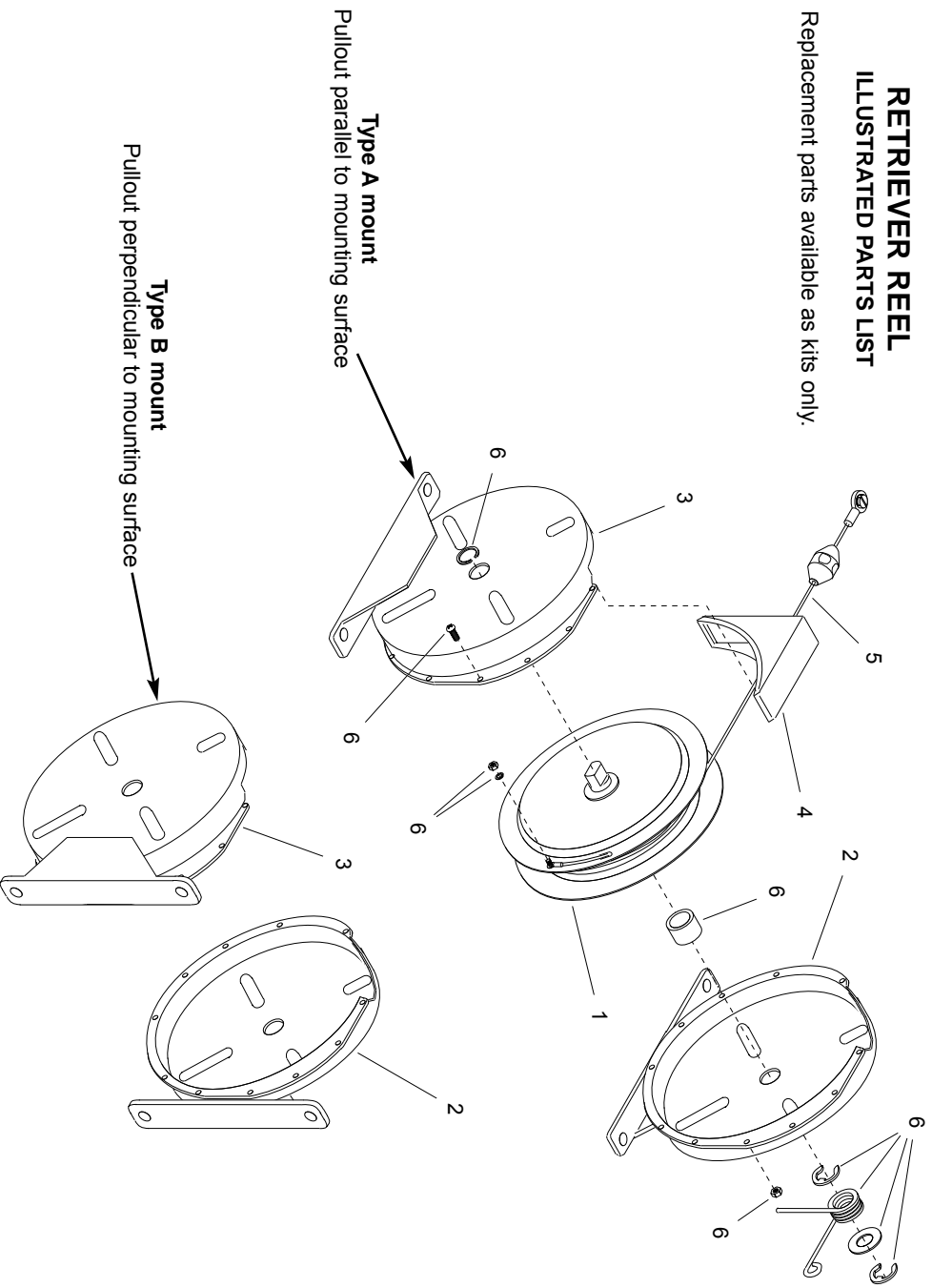

RETRIEVER REEL

REPLACEMENT PARTS KITS

| REFERENCE NUMBER | KIT NUMBER | | KIT DESCRIPTION |
|------------------|-------------|-------------|--|
| | Mount "A" | Mount "B" | |
| 1 | TQR0850-K01 | TQV0850-K01 | SPRING MOTOR ASS'Y: Spring Motor, Spool, Shaft & Bushings in sealed canister. Specify model number of your reel. |
| | TQR1215-K01 | TQV1215-K01 | |
| | TQR1230-K01 | TQV1230-K01 | |
| | TQR2215-K01 | TQV2215-K01 | |
| | TQR3008-K01 | TQV3008-K01 | |
| 2 | TQR-K02* | TQV-K02* | RH HOUSING ASS'Y: RH Housing Half |
| 3 | TQR-K03* | TQV-K03* | LH HOUSING ASS'Y: LH Housing Half, Nameplate. |
| 4 | TQR-K04** | | CABLE GUIDE |
| 5 | TQR0850-K05 | TQV0850-K05 | CABLE ASS'Y: Cable, Cable Stop, Eye. Specify model number of your reel. |
| | TQR1215-K05 | TQV1215-K05 | |
| | TQR1230-K05 | TQV1230-K05 | |
| | TQR2215-K05 | TQV2215-K05 | |
| | TQR3008-K05 | TQV3008-K05 | |
| 6 | TQR-K06** | | HARDWARE PACKAGE: Spacer, Torsion Spring, Pan Head Screw M4 x 10mm (8), Locknut M4 (8), #8-32 Hex Nut, #8 Int. Tooth Lock Washer, Retaining Ring (3). |

* Common to all cable lengths and spring configurations.

** Common to all models.