

## ASSEMBLY AND PARTS INFORMATION

- Step #1** Position hanger bracket (Item 1) as required and tighten locking nut 1/3 turn past finger tight.
- Step #2** Pilot light assembly (Item 2) if used -- push out plug (P/N 28338) from rear. Insert light assembly. Insert pilot light legend plate. Install locking ring.
- Step #3** \*Install button assembly (not Pictorially shown). Align keying tabs and holes and press push button assembly into terminal boards. Tighten hold down screws. (Not used on MS2 & MS5). AVOID OVERTIGHTENING
- Step #4** \*Install terminal board with button assembly working from top to bottom. Use 8-32 x 1/2" (P/N 47661-098) "sems" screws (Item 4) where single thickness terminal board is fastened. Observe "Top" marking on each board. AVOID OVERTIGHTENING
- Step #5** \*Use 8-32 x 5/8" (P/N 47661-100) "sems" screws (Item 5) where two terminal boards overlap. AVOID OVERTIGHTENING
- Step #6** Use 8-32 x 1/2" (P/N 47243-059) pan head screws (Item 6) to install button guards and back cover. CAUTION: DO NOT OVERTIGHTEN THESE SCREWS. Recommended torque is 10 in. lbs. To 12 in. lbs. Maximum. A slight rubber bulging is allowed.

\* Where direct wired push buttons are used, Steps #3, #4, & #5 do not apply.

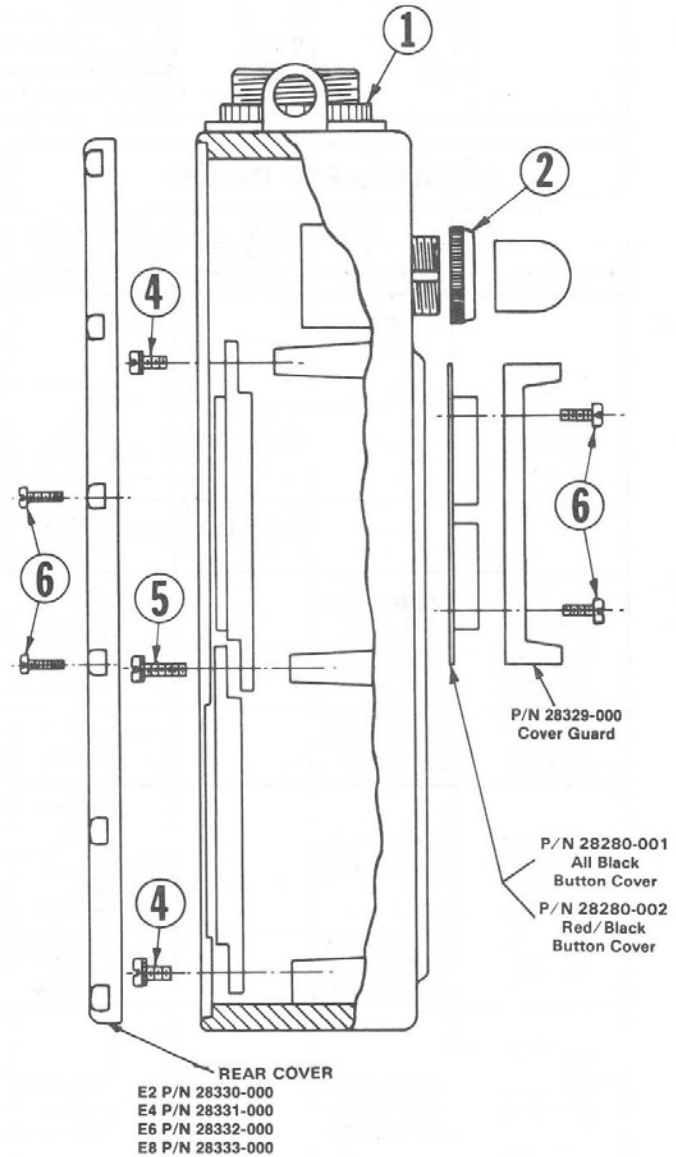

## PILOT LIGHTS

DESCRIPTION	CATALOG NUMBER	LAMP PART NO.
Pilot Light 120v AC/DC	PL1	57470-070
Pilot Light 240v AC/DC	PL2	57470-068



# Single Speed Plug-In Inserts

## Momentary N.O.

Cat# PG1

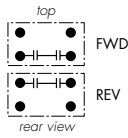

## Momentary N.O. & N.C. Maintained N.O. & N.C. Maintained/Momentary Lift-Drop

Cat# PG2/3/4

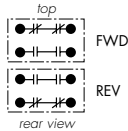

## Momentary/Maintained Start-Stop Momentary Start-Stop/Reset-Stop

Cat# PG5/6

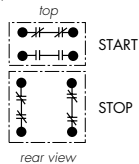

## Momentary Stop-Start/Stop-Reset

Cat# PG7

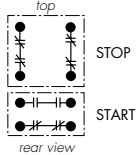

# Multi-Speed Plug-In Inserts

Two and Three Speed – Cat# MS2

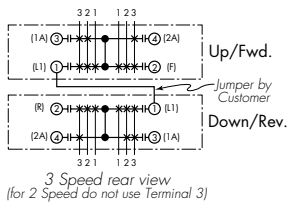

Four and Five Speed – Cat# MS5

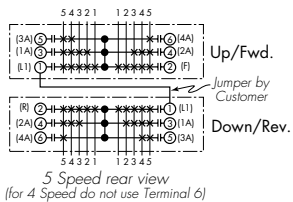

PG4 and PG5 inserts have one button maintained and one button momentary. "Off-On" buttons recommended to comply with provision of NEMA ICS 3-442.15.

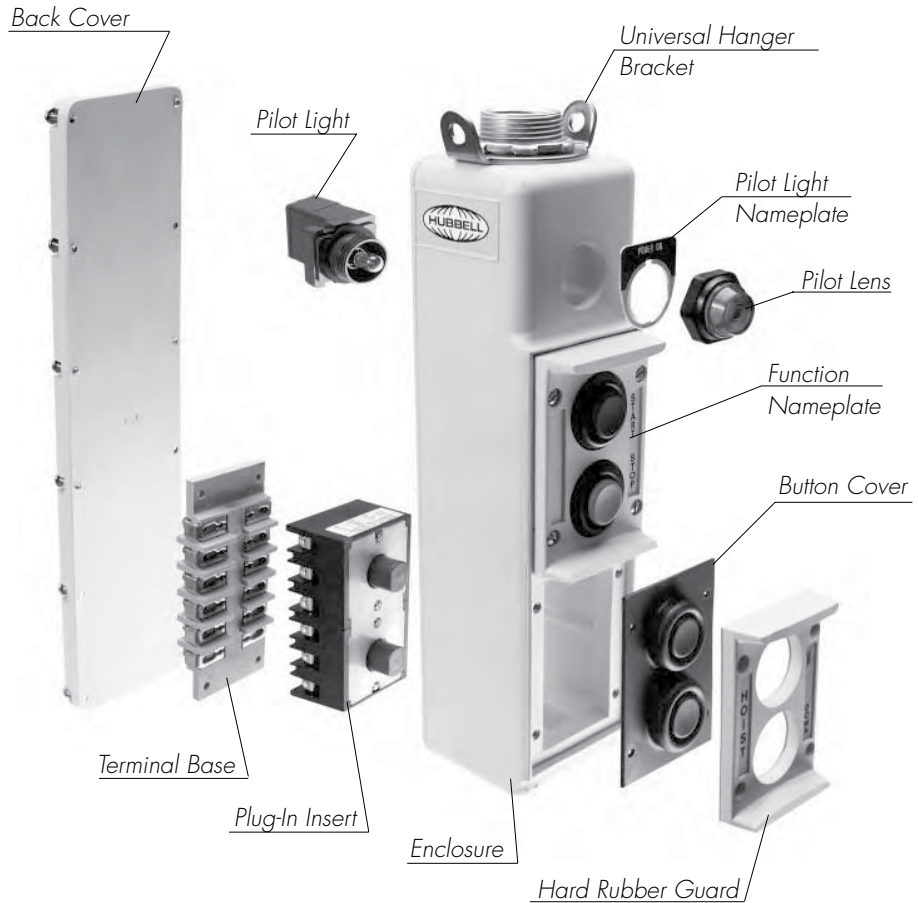

## Dimensions

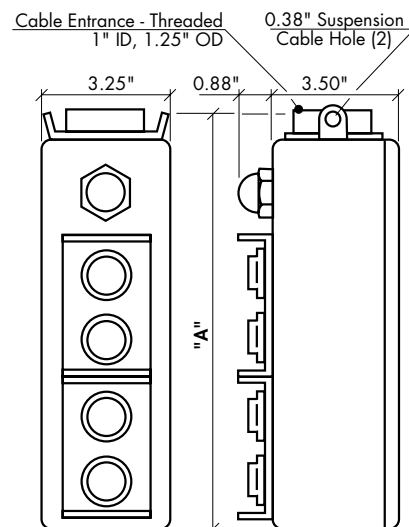

Number of Buttons	"A"	Approx. Wt. (lbs.)
2	7.87"	2.5
5†	13.69"	4.5
7†	18.00"	5.5
9†	22.31"	7.0

† Enclosures include extra 30mm hole at top for pilot light, toggle switch, etc. (N/A for 2 button case).

## Contact Ratings – Single Break

Single Speed		Multi Speed	
AC NEMA A300	120V 6A	AC NEMA A300	120V 6A
	240V* 3A		240V* 3A
DC NEMA P300	125V 1.1A	DC NEMA R300†	125V 0.4A
	250V 0.55A		250V 0.2A

\* OSHA limits pendant voltage to 150VAC or 300VDC  
† Closest NEMA rating.



Hubbell Industrial Controls, Inc.  
a subsidiary of Hubbell Incorporated  
4301 Cheyenne Drive, Archdale, NC 27263  
Phone (336) 434-2800 | Fax (336) 434-2801  
www.hubbell-icd.com  
sales@hubbell-icd.com