



FORM K1162 - INSTALLATION DATA SHEET MOUNTING PAN KEY FOR B7C CIRCUIT BREAKER ENCLOSURES CATALOG NO. B7CE (600 amp max. Circuit Breakers)

CIRCUIT BREAKER MANUFACTURER	BREAKER FRAME	BREAKER STYLE	MOUNTING HARDWARE	QTY
GENERAL ELECTRIC	J600 FRAME	TJK6, THJK6	1/4-20	4
SIEMENS-ITE	LD-FRAME	LXD6, LD6, HLD6, HHLD6, CLD6	1/4-20	4
EATON	PDG	PDG5	10-32	4
ABB	XT	XT3	10-32	4
SQUARE-D	LC-FRAME	LCL	10-32	4
WESTINGHOUSE	L-FRAME	LDB, LD, HLD, LDC	1/4-20	4

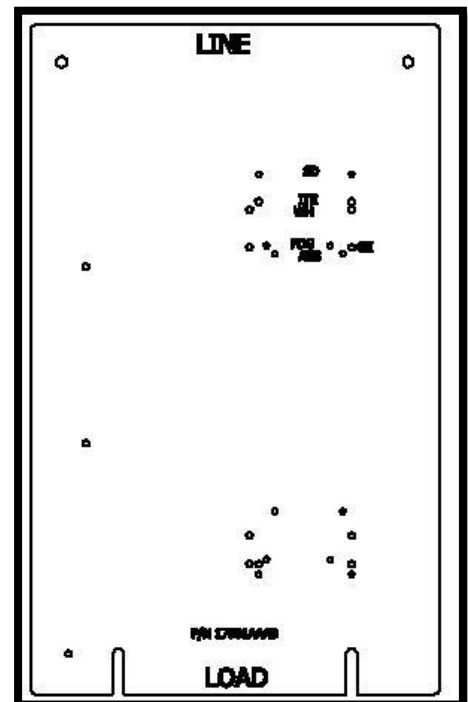
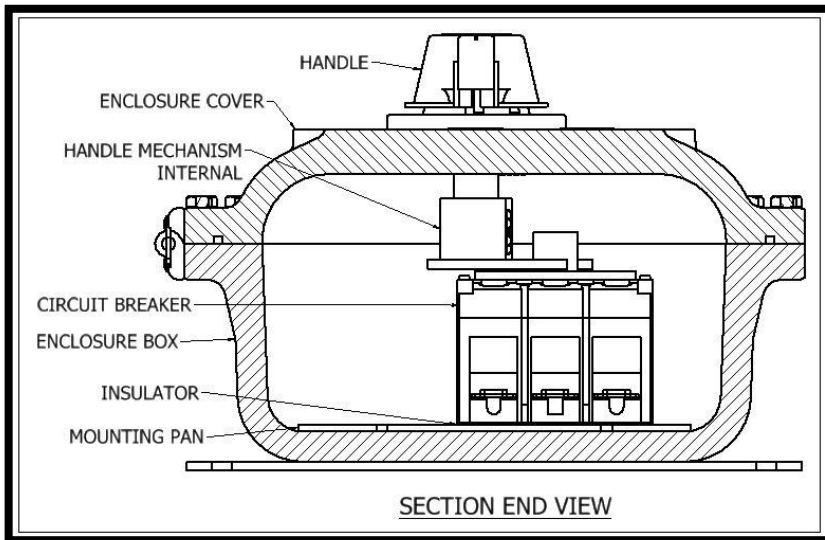

FIGURE 1

FIGURE 2

CIRCUIT BREAKER INSTALLATION

- 1) Referring to Figure 2 and the above Table, select the proper mounting pan location for the circuit breaker manufacturer.
 - 2) Select the insulating paper for the circuit breaker being installed, discard the remaining.
 - 3) Align the insulating paper with the mounting holes located on the mounting pan.
 - 4) Install the circuit breaker onto the mounting pan using fasteners supplied by the circuit breaker manufacturer.
 - 5) Wire the circuit breaker per the governing codes and electrical standards of your area.
- * See Breaker Manufacturer for mounting hardware.

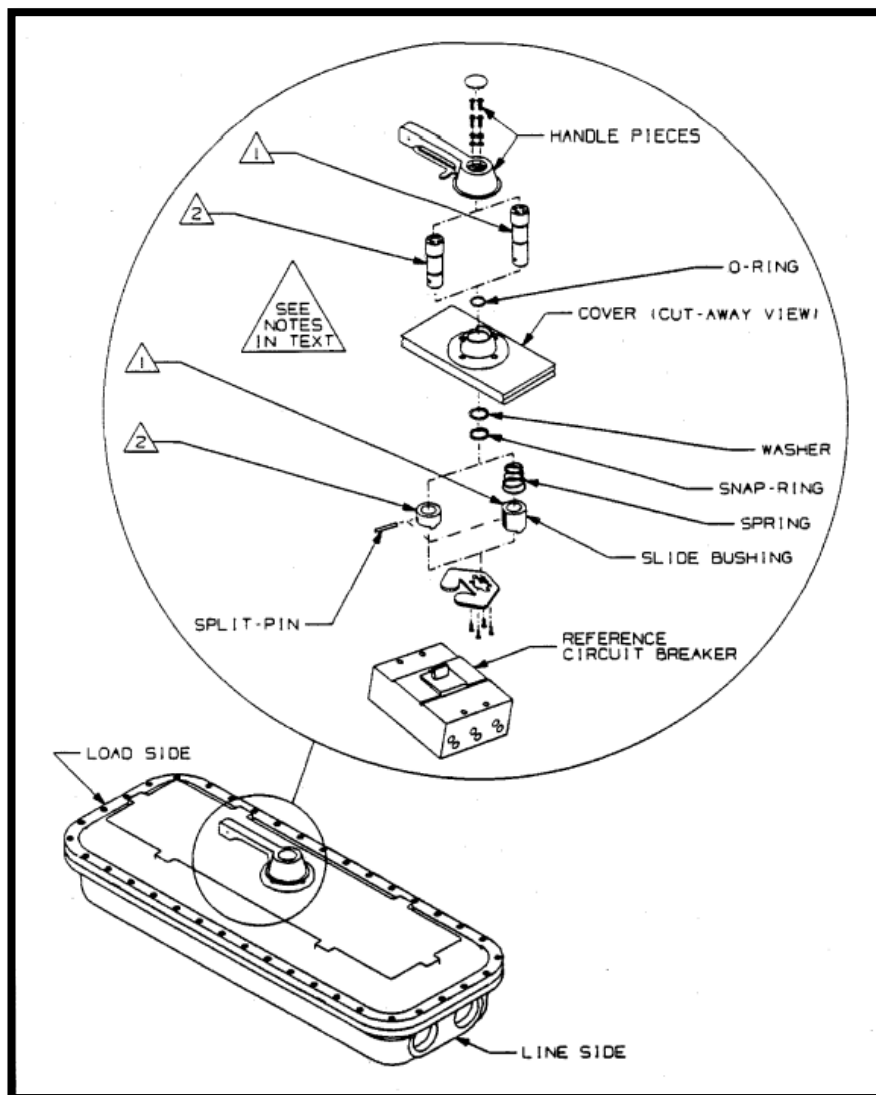

FIGURE 3

HANDLE INSTALLATION FOR:

General Electric, Siemens-ITE, Westinghouse

HANDLE INSTALLATION FOR:

Square-D

Refer to FIGURE 3. Install items that are identified with a number 1 in the above shown sequence.

- Install O-Ring onto shaft.
- Lubricate entire shaft with Killark "LUBG".
- Install (short) shaft into the enclosure, slide on washer, install snap-ring into the groove on shaft.
- Install spring & slide bushing as shown in Figure 3
- Using channel-lock pliers, press the split-pin thru the slide bushing and into the shaft. DO NOT use a hammer to install the split-pin.
- Install the plate (which engages the circuit breaker) onto the slide bushing using four screws.
- With the circuit breaker in the "off" position, align the plate/shaft with the circuit breaker switch.
- Install the handle with the four screws and lock-washers as shown. Install the circular screw cover.

Refer to FIGURE 3. Install items that are identified with a number 2 in the above shown sequence.

- Install O-Ring onto shaft
- Lubricate entire shaft with Killark "LUBG"
- Install (long) shaft into the enclosure, slide on washer, install snap-ring into the groove on shaft.
- Install the bushing as shown in Figure 3.
- Using channel-lock pliers, press the split-pin thru the bushing and into the shaft. DO NOT use a hammer to install the split-pin.
- Install the plate (which engages the circuit breaker) onto the bushing using four screws
- With the circuit breaker in the "off" position, align the plate/shaft with the breaker switch.
- Install the handle with the four screws and lock-washers as shown. Install the circular screw cover.