

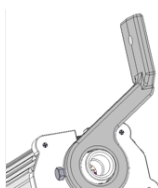

KILLARK®

INSTALLATION, OPERATION & MAINTENANCE DATA SHEET

LAL SERIES LED ACCESSORIES

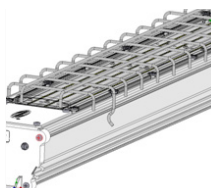

LAL SERIES LED ACCESSORIES

CAUTION:

Before installing, make sure you are compliant with area classifications, failure to do so may result in bodily injury, death and property damage. Do not attempt installation until you are familiar with the following procedures. All installation must comply with the applicable Electrical Code.

Make sure that the circuit is de-energized before starting installation or maintenance.

Verify that the installation is grounded. Failure to ground will create electrical shock hazards, which can cause serious injury and or death.

ATTENTION:

Avant d'installer le luminaire, s'assurer que le luminaire est conforme à la classification des zones, le non-respect de cette règle risque d'entraîner des dommages corporels et / ou matériels. Ne pas tenter d'entreprendre l'installation avant d'être familiarisé avec les procédures suivantes. Toute installation doit être conforme au code électrique local et / ou national et être effectuée par un électricien qualifié.

Veiller à ce que le circuit soit mis hors tension avant de commencer l'installation ou la maintenance.

Vérifier si le luminaire est mis à la terre. S'il n'est pas mis à la terre il pourrait causer des risques de choc électrique susceptibles d'entraîner des blessures graves ou la mort.

Technical information, advice and recommendations contained in these documents is based upon information that Killark believes to be reliable. All the information and advice contained in these documents is intended for use only by persons having been trained and possessing the requisite skill and know-how and to be used by such persons only at their own discretion and risk. The nature of these instructions is informative only and does not cover all of the details, variations or combinations in which this equipment may be used, its storage, delivery, installation, check out, safe operation and maintenance. Since conditions of use of the product are outside of the care, custody and control of Killark, the purchaser should determine the suitability of the product for his intended use, and assumes all risk and liability whatsoever in connection therewith.

KILLARK®



3940 Dr. Martin Luther King Drive
St. Louis, MO 63113

P/N KIL00921467 FORM NO. K1467 ERO-6-074-15 12/15

Page 1 of 3

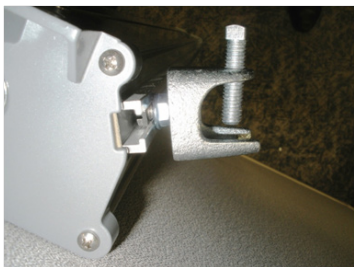

NOTE- For Class I, Division 2 / Class II, Division 1 / Class I, Zone 2 Hazardous Locations, use rigid conduit or appropriate cable connectors/ glands rated for Class I, Division 2 Groups BCD (or IEC Zone 2 IIC, IEC Zone 21 IIIC) hazardous areas.

Pour les endroits dangereux Classe I, Division 2 / Classe II, Division 1 / Classe I, Zone 2 utiliser des Conduits rigides.

1. LAL BEAM CLAMP **INSTALLATION INSTRUCTIONS**

1. Slide 5/16-18 screw down desired track.
2. Tighten 5/16-18 nut onto screw to keep screw from sliding in track.
3. Thread beam clamp onto screw. Tighten beam clamp onto screw as much as possible, then orient beam clamp to mount to beam.

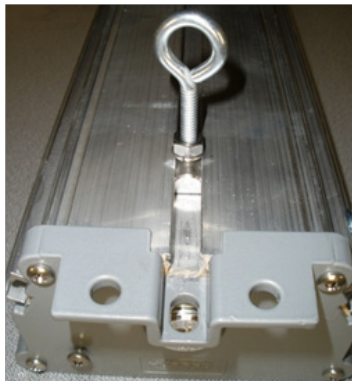

2. LAL EYE BOLT **INSTALLATION INSTRUCTIONS**

1. Slide barrel nut screw down desired track.
2. Place lock washer and nut on eyebolt.
3. Thread eyebolt into barrel nut. Thread eyebolt into barrel nut as far as it will go. Adjust eyebolt to desired position.
4. Tighten nut against housing to keep eyebolt from shifting.

3. LAL GUARD **INSTALLATION INSTRUCTIONS**

1. Place guard over lens. Snap over housing
2. The guard locates on the lens to keep the guard in place.
3. Bend guard if necessary to ensure a tight fit.

4. LAL RIG BRACKET **INSTALLATION INSTRUCTIONS**

Wall bracket shown. Ceiling bracket similar.

1. Place bracket over boss on end cap.
2. Tighten the set screws to keep the fixture in place.
3. Attach to mounting surface with 5/16" screw or similar.

NOTE: Fixture must have an LALR end cap to use this bracket.

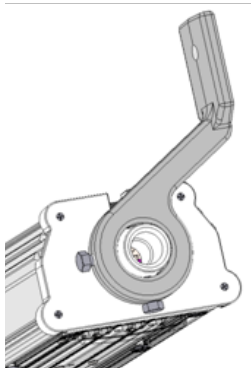
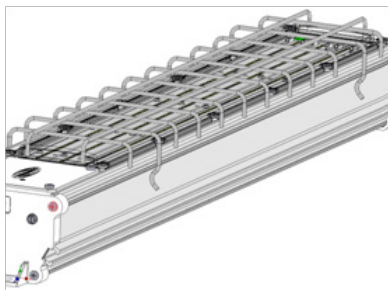

KILLARK® **Chalmit**

Victor
Lighting

Vantage
Technology

RIG POWER

HAWKE
International

3940 Dr. Martin Luther King Drive
St. Louis, MO 63113

P/N KIL00921467 FORM NO. K1467 ERO-6-074-15 12/15

Page 2 of 3

5. MAINTENANCE INSTRUCTIONS

CAUTION

Disconnect the supplying circuit before opening fixture or removing optics. To maintain maximum light output, this fixture should be cleaned periodically. Maintenance procedures sometimes require fixtures to be hosed down for good housekeeping. The supply circuit must be turned OFF and the fixture lens must be allowed to cool to the ambient room temperature before cleaning. Only mild, non-abrasive cleaning agents should be used. The force of water applied by a hose must not exceed 65 gallons per minute coming from a 1" diameter hose applied at a distance of 10 feet. These periodic cleaning procedures are important to prevent the accumulation of dust and dirt which will impair the light output of the fixture. The polycarbonate lens should be regularly inspected for scratches and chips and, if damaged, must be replaced.

HIGH VIBRATION AREAS

Periodic inspection of fastener tightness is required; recommended every six (6) months.

REMEMBER TO SAVE ONE OF THESE SHEETS FOR MAINTENANCE PERSONNEL

KILLARK®

Chalmit

Victor
Lighting

Vantage
Technology

RIG POWER

HAWKE
International

3940 Dr. Martin Luther King Drive
St. Louis, MO 63113

P/N KIL00921467 FORM NO. K1467 ERO-6-074-15 12/15

Page 3 of 3