

# 4 GANG CFB CAST IRON CONCRETE FLOOR BOX AND ACCESSORIES

## Installation Instructions

Catalog no. CFB4G30CI

English

**CAUTION:** RISK OF ELECTRIC SHOCK. Disconnect power before installing or servicing.

**NOTICE:** For installation by a qualified electrician in accordance with national and local electrical codes, communication standards, the following instructions, and any instruction included with individual devices.

**NOTICE:** Ensure data/communications circuits are separated from lighting/power circuits in accordance NEC® and CE code requirements.

**Use with 24GTCVRxx, 24GCCVRxx, and 2GAFBCVRxx series rectangular covers.**

**Use with 24GTFFCVRxx, and 24GCFFCVRxx series furniture feed rectangular covers**

**Use with “CFBS1R8CVRxx” series round covers when used with the CFB4GS1R8ADAPT round cover adapter.**

**CAUTION:** PLEASE READ ALL INSTRUCTIONS BEFORE BEGINNING. FINISHED FLOOR TYPES CERAMIC TILE, VCT (Vinyl Composition Tile) FLOORING, CARPET FLOORING, LAMINATE FLOORING, AND FINISHED CONCRETE FLOORING AFFECT THE INSTALLATION METHOD.

See Figures 3 or 4 for applications of desired floor finishes.

For desired flange types FLUSH or FLAT styles see installation applications Fig. A, Fig. B, Fig. C, Fig. D, Fig. E, and Fig. F.

**Figure 1**

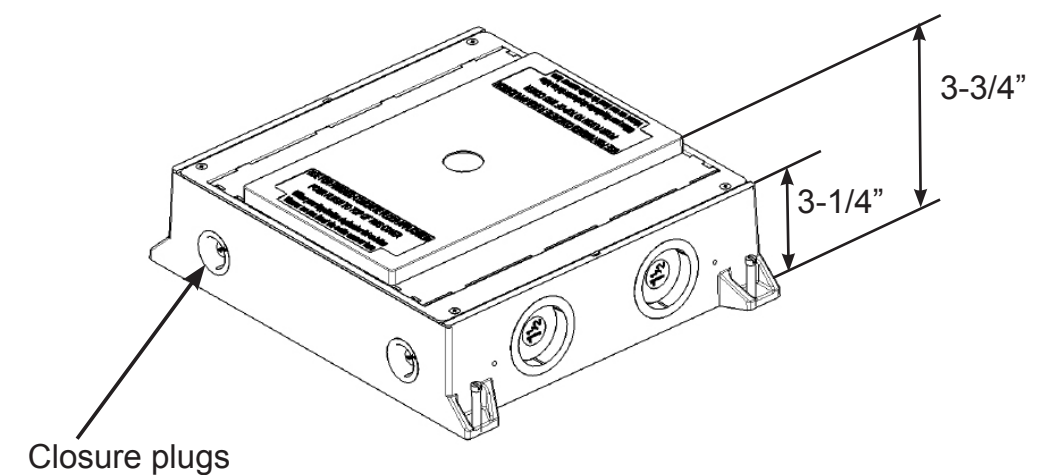

**Catalog No.  
CFB4G30CI**

**Before Concrete Pour Box installation:** (See Figure 2.)

1. Remove and retain four #8-32 flat head screws [1] from top four corners of the box.
2. Remove top mounting flange [2] with temporary concrete cover [4] and plastic Cover [5] from box.
3. Install four leveling screws [3] to outside tabs of box. Level box as required. Be sure to set height of the top of box or temporary plastic cover to be flush with the finished level of the concrete pour.
4. Remove closure plugs [8] as needed. Install conduits runs as required. Unused conduit ports should be left covered with closure plugs [8]. See Figure 2.
5. Re-install top mounting flange [2] with temporary cover [4] and plastic Cover [5] using 4 screws removed in step 1. (**NOTICE:** plastic Cover [5] is optional for certain floor applications, see Figures 3 or 4 for desired floor application). Ensure that top plate notches [6] align with wiring channel [7] used for feed through applications.
6. Use tape or other to seal all seams and openings outside of box. See figure 3.
7. Secure and verify box is level to finished concrete pour height using screws installed during step 3.

**Figure 2**

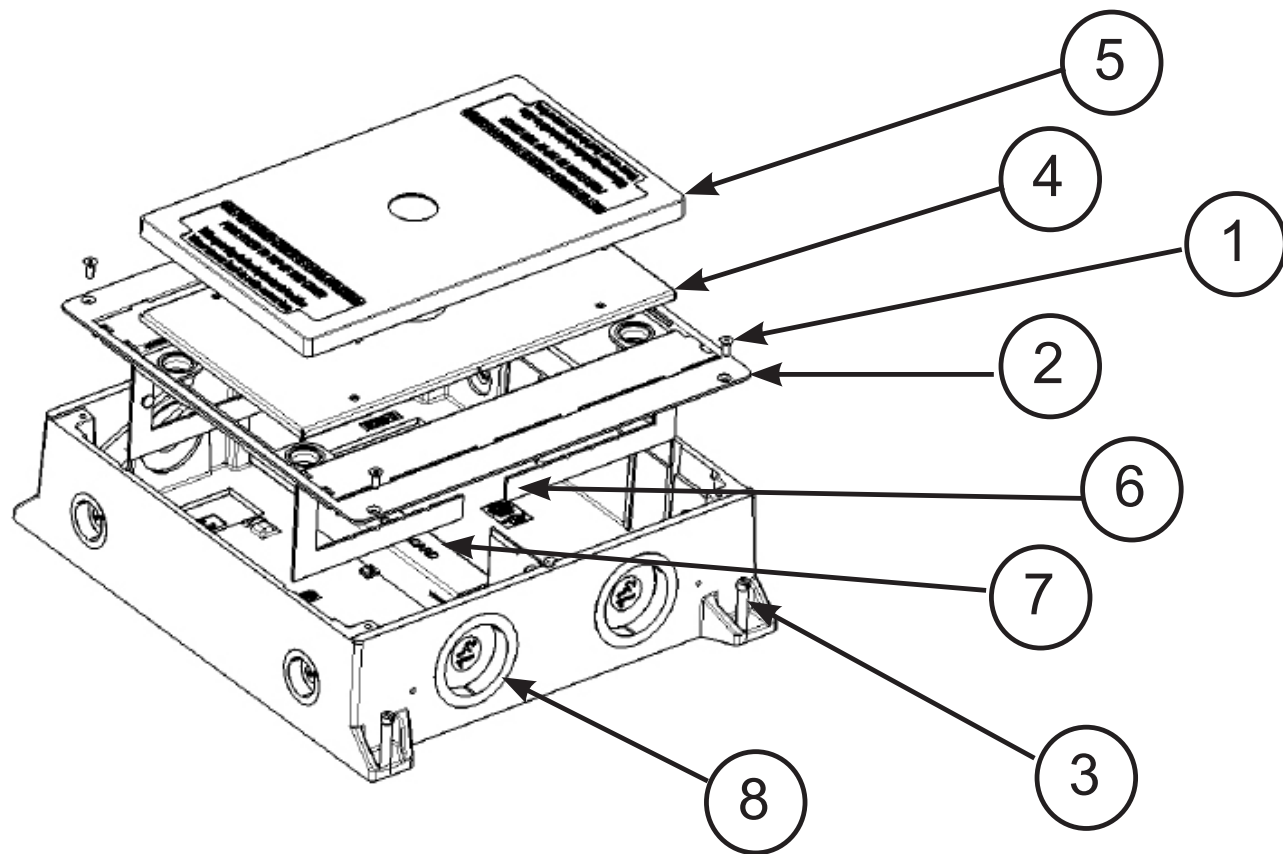

**FLUSH Flange Carpet Installation – FLUSH (shown):** Open Cover and turn four Jack Screws to raise Flush Flange with Cover flush to surface of Carpet floor.

**Figure F**

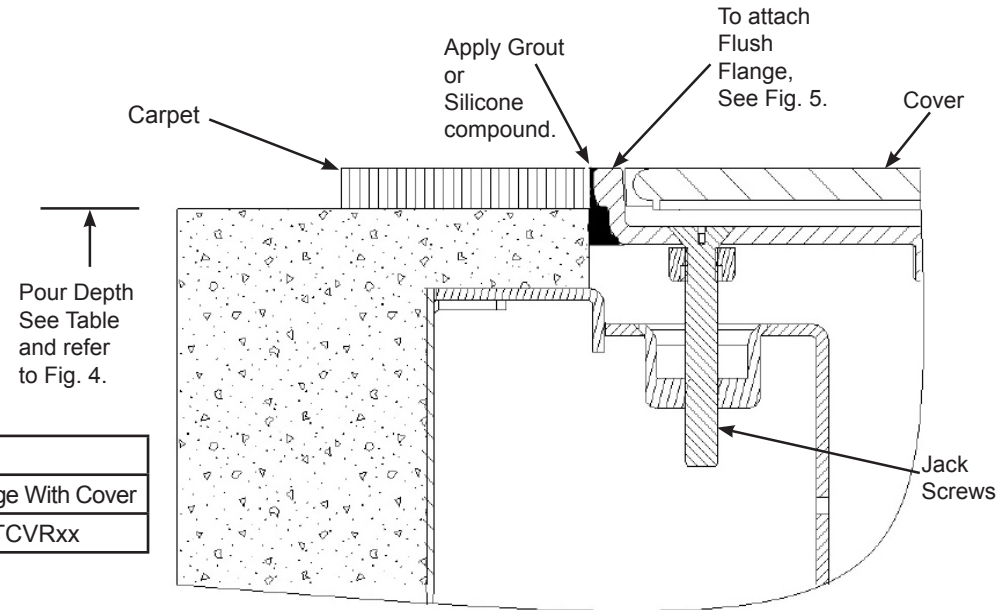

Carpet Flooring		
Floor Box	Pour Depth	Flush Flange With Cover
CFB4G30CI	3-3/4"	24GTCVRxx

**ATTACHING THE COVER:** 24GCCVxx rectangular cover assembly shown

- NOTICE: Use only electrical grade type RTV silicone sealant to insure scrub water tightness.
- Slide Gasket to underneath of Flat Flange or apply bead of Silicone compound as shown depending on application Tile or Carpet.
- Pull and Lift Cover upright at 90° as shown to access Jack Screws.
- Attach cover assembly to top mounting plate using jack screws [7]. Fasten until flange is level and secure to floor.
- To adjust cover assembly turn jack screws [7] counter clockwise to raise or clockwise to lower. Sequentially turn four jack screws as needed for proper leveling of flange to floor. The jack screws have a 1 inch maximum adjustment.

**Figure 5**

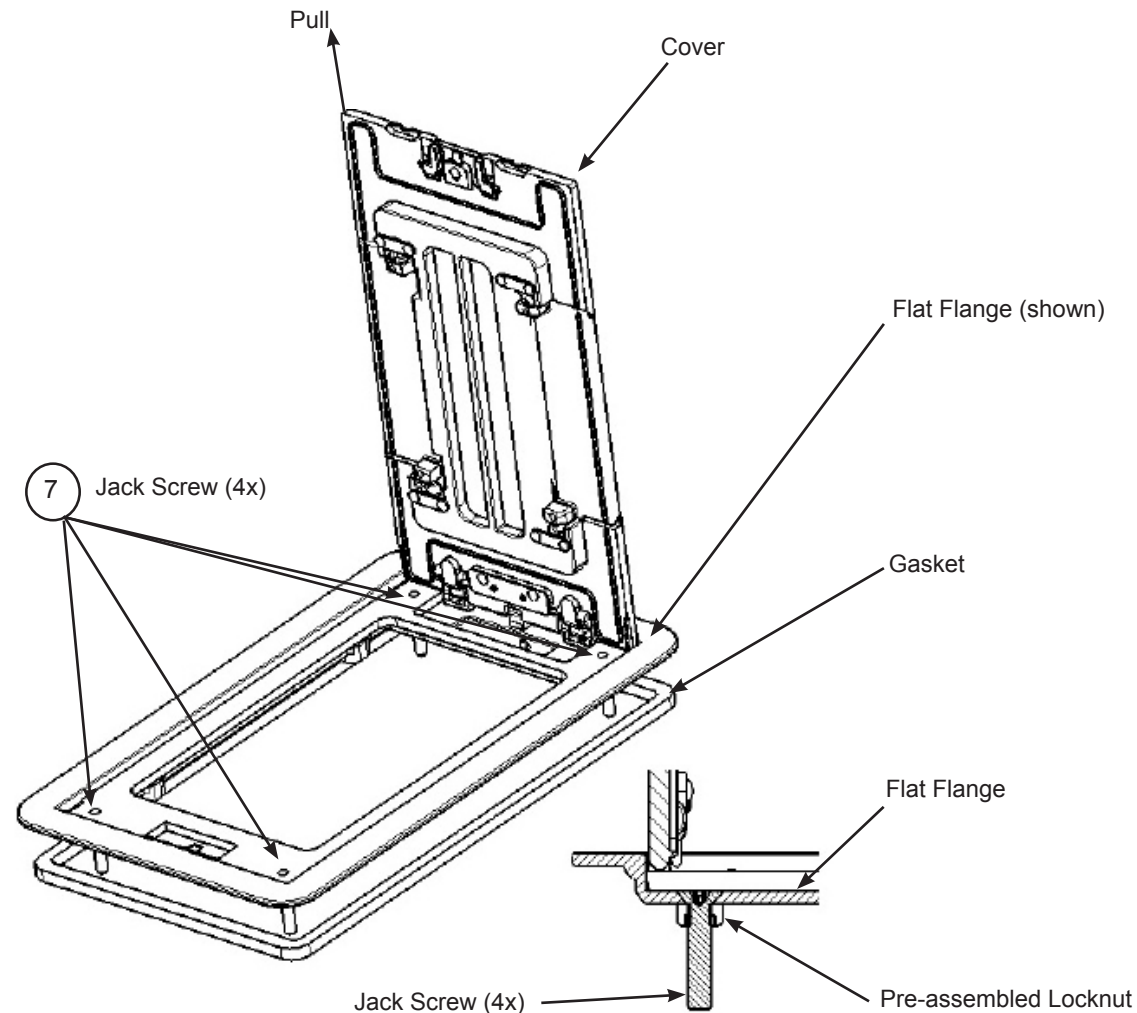

**After Concrete Pour Box installation:**

**CAUTION:** Temporary concrete covers are intended to keep concrete residue from entering box during pour and are not intended to support loads. Replace with permanent flange/cover immediately after concrete has hardened or temporarily reinstall concrete metal cover [4].

8. After concrete has hardened, remove temporary concrete metal cover [4] and plastic cover [5]. Retain these temporary covers.
9. Use wiring channel [6] for feed through. Wiring channel areas given in Table 1. (Wiring channel must be removed for feed through applications.)
10. Pull and dress wires.
11. Reinstall wiring channel. Align with notches [2]
12. Consult electrical device mounting plate installation instructions for wiring device installation.
13. Attach Flange with Cover (see Figure 5). For desired flange styles see Figures A,B,C,D,E or F.

Ensure to set height of the top of the box (Figure 4) with plastic cover [5] or without plastic cover (Figure 3) as indicated. See Figures A, B, C, D, E, or F with tables for desired floor finish.

**Table 1**

Catalog No.	Wiring Channel Area
CFB4G30CI	(1) 0.856 in <sup>2</sup> [552,7 mm <sup>2</sup> ]

**Figure 3**

**WITHOUT PLASTIC COVER**

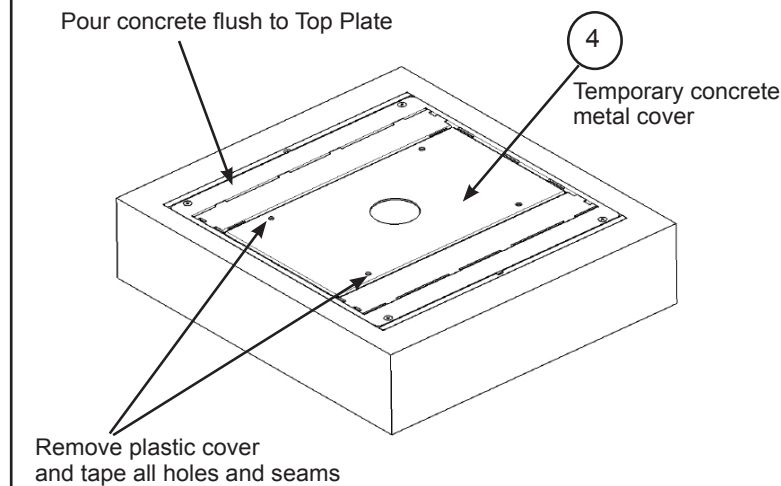

**Applications:**

- Ceramic Tile (See Fig. A, Fig. B or Fig. C)
- Laminate Flooring (See Fig. A, Fig. B or Fig. C)
- Carpet Flooring with Flat Flange (See Fig. E)
- VCT with Flat Flange (1/8" Min. Thick. See Fig. B)

**Figure 4**

**WITH PLASTIC COVER**

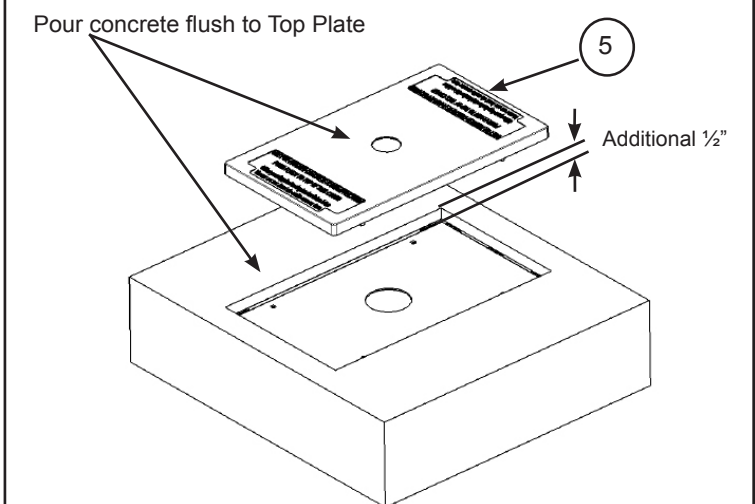

**Applications:**

- Finished Concrete with Flush Flange (See Fig. D)
- VCT with Flush Flange (See Fig. D)
- Carpet Flooring with Flat Flange (See Fig. F)

**Flat Flange Installation – FLUSH (shown):** Open Cover and turn four Jack Screws to adjust Flat Flange with Cover. Minimum ceramic tile thickness 3/16" [4,8 mm].

**Figure A**

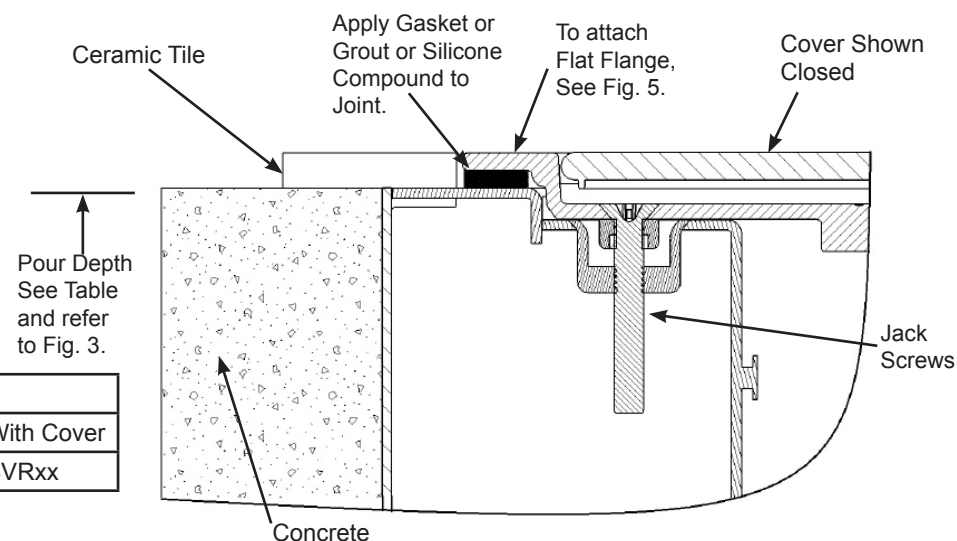

Ceramic Tile or Laminate Flooring		
Floor Box	Pour Depth	Flat Flange With Cover
CFB4G30CI	3-1/4"	24GTCCVRxx

**FLUSH Flange Installation – FLUSH (shown):** Open Cover and turn four Jack Screws to adjust Tile Flange with Cover flush to surface of floor.

**Figure D**

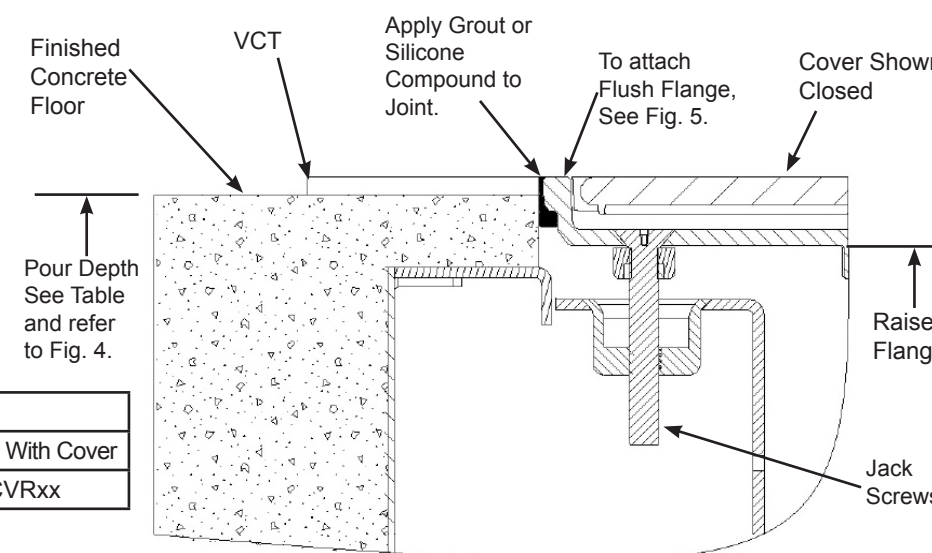

VCT or Finished Concrete Flooring		
Floor Box	Pour Depth	Flush Flange With Cover
CFB4G30CI	3-3/4"	24GTCVRxx

**Flat Flange Installation – SURFACE (shown):** Open Cover and turn four Jack Screws to adjust Flat Flange with Cover flush to surface of tile floor. Minimum VCT thickness 1/8" [3,2 mm].

**Figure B**

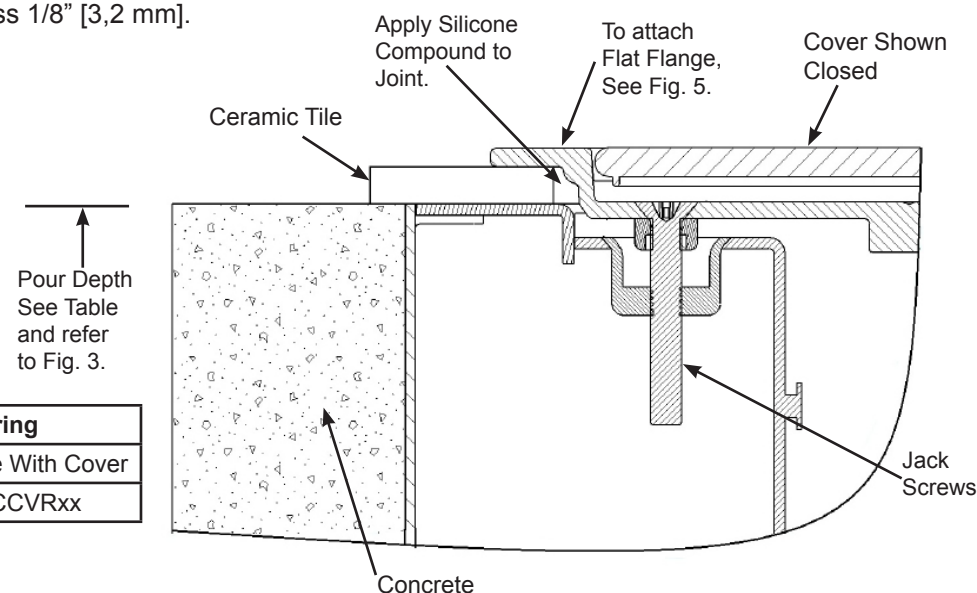

VCT, Ceramic Tile or Laminate Flooring		
Floor Box	Pour Depth	Flat Flange With Cover
CFB4G30CI	3-1/4"	24GTCCVRxx

**Carpet Installation –** Cut opening in carpet as shown for both FLUSH and FLAT flange styles.

**Figure E**

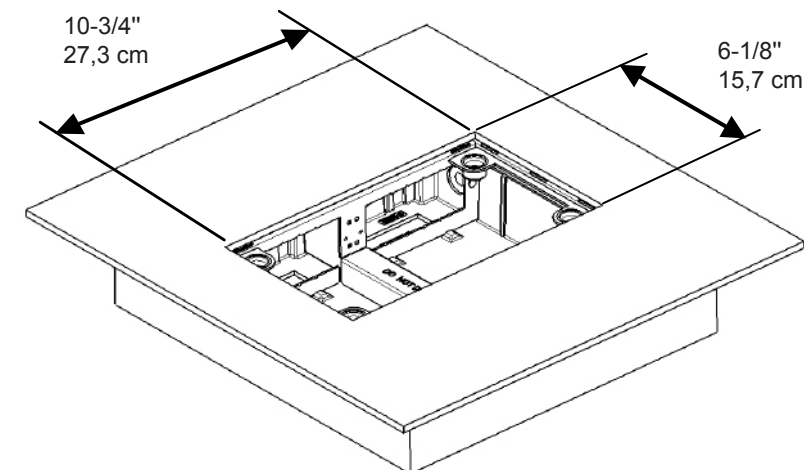

**Flat Flange Carpet Installation – SURFACE (shown):** Open Cover and turn Jack Screws [4] to adjust Flat Flange with Cover flush to surface of carpet.

**Figure C**

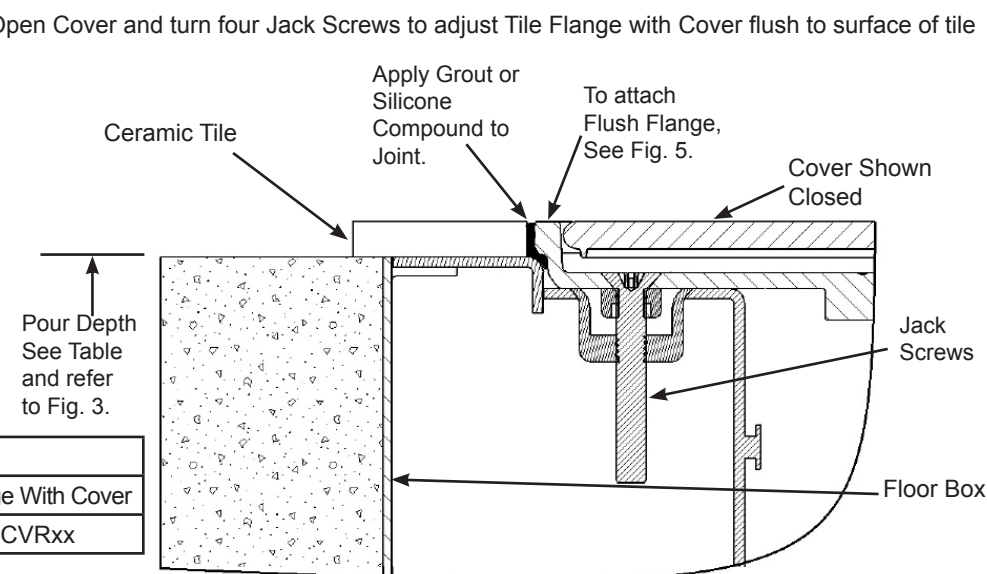

Ceramic Tile		
Floor Box	Pour Depth	Flush Flange With Cover
CFB4G30CI	3-1/4"	24GTCVRxx

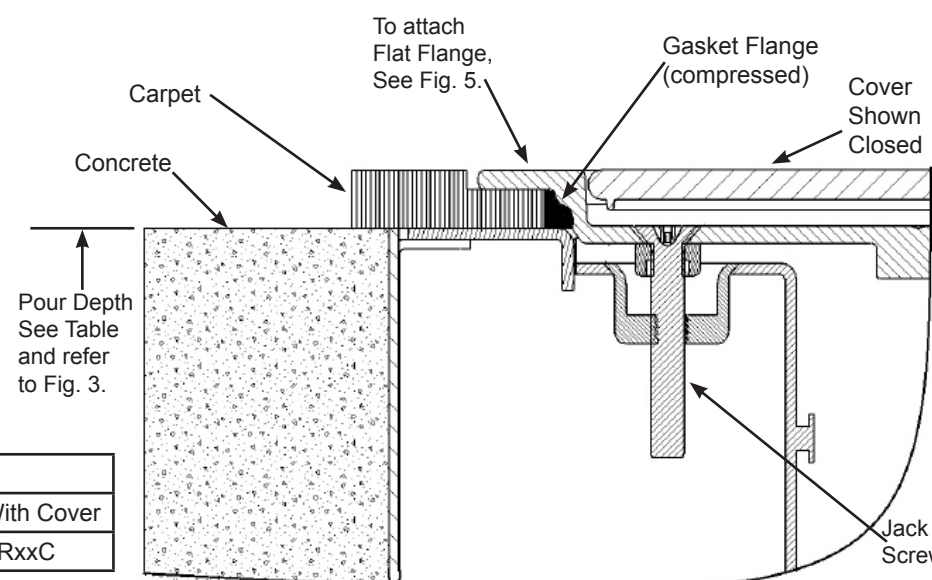

Carpet Flooring		
Floor Box	Pour Depth	Flat Flange With Cover
CFB4G30CI	3-1/4"	24GCCVRxxC