

METAL FACEPLATES FOR 10 GANG FLOOR BOXES

Installation Instructions

Catalog no.'s FB10MPxxx and PWFB10MPxxxxx

English

CAUTION: RISK OF ELECTRIC SHOCK. Disconnect power before installing or servicing.

NOTICE: For installation by a qualified electrician in accordance with national and local electrical codes, communication standards, the following instructions, and any instruction included with individual devices.

NOTICE: Insure data/communications circuits are separated from lighting/power circuits in accordance NEC® and CE code requirements.

FB10MPxxx series faceplates for use AFB10G55, AFB10G55CHI, CFB10G55, CFB10G55CR, and CFB10G55RCR series floor boxes.

PWFB10MPxxx Leaded Receptacle and Faceplate series assemblies for use with AFB10G55, AFB10G55CHI, CFB10G55, CFB10G55CR, and CFB10G55RCR series floor boxes.

CAUTION: PLEASE READ ALL INSTRUCTIONS BEFORE BEGINNING.

See Figures and Table for Faceplate installation.

Figure 1

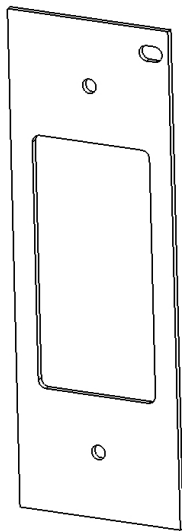

Faceplate
Catalog No. FB10xxxx series
FB10MPREC example shown

Figure 2

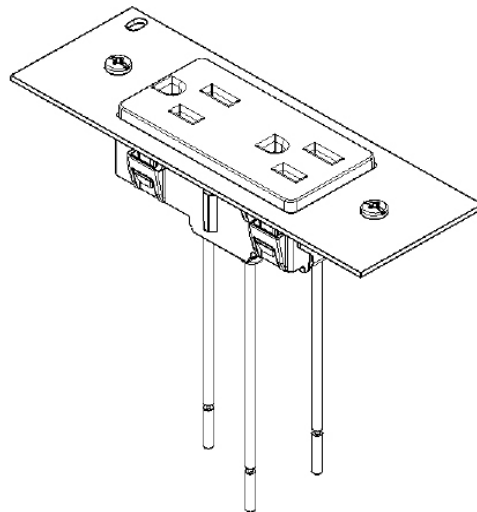

Leaded receptacle with faceplate
Catalog No. PWFB10MPxxxx series
PWFBMPDR15 example shown

Faceplate installation:

1. Catalog No. FB10MPREC (see Fig. 3).
Secure receptacle [1] to faceplate [2] using two #6-32 screws [3] (provided). Tighten screws to 8-10 in.lbs [.90-1.12 N•m] of torque

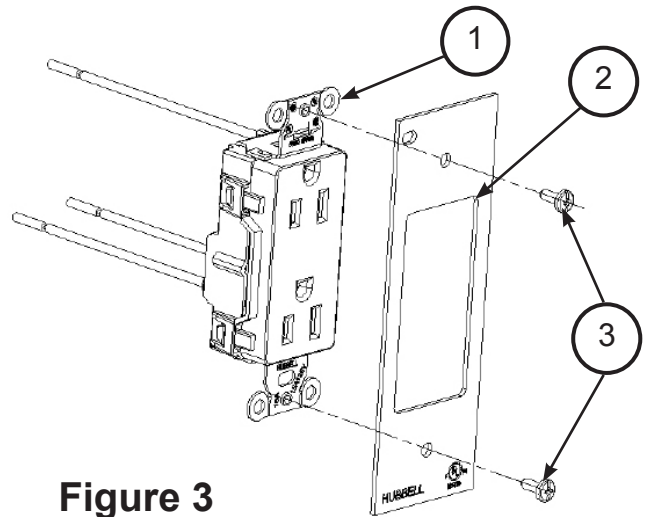

Figure 3

Faceplate installation:

2. Catalog No. FB10MPDUP (see Fig. 4).
Secure duplex receptacle [1] to faceplate [2] using two #6-32 screws [3] and two nuts [4] (provided). Tighten screws to 8-10in.lbs [.90-1.12 N•m] of torque.

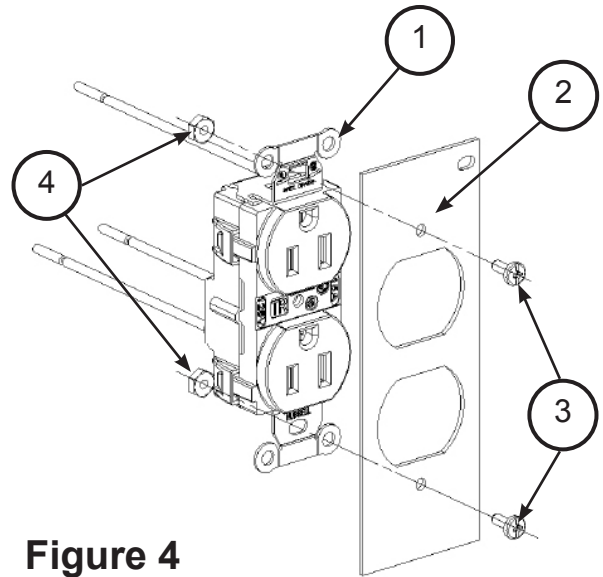

Figure 4

Leaded receptacle with Faceplate installation:

3. Wire device per card instruction PD2313 (provided).
4. Install leaded receptacle with faceplate [4] onto Top mounting flange [5]. (See Fig. 5.)
5. Secure faceplate to Top Mounting Flange using one #6-32 screw [6] (provided). Tighten screw to 8-10 in.lbs [.90-1.12 N•m] of torque.

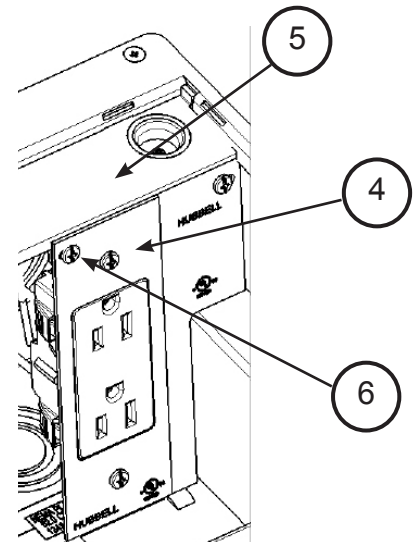

Figure 5