

Hanging Aluminum ADSS Suspension Clamp

Instructions



Hubbell has a policy of continuous product improvement. Please visit hubbellpowersystems.com to confirm current design specifications.

PRODUCT INTENDED USE

The Hubbell Hanging Aluminum Suspension Clamp is intended for use on All Dielectric Selfsupporting (ADSS) fiber optic cable and can be used in tangent suspension for spans up to 600 ft. with 30° max turning angle.

PRODUCT INFORMATION

BODY: Aluminum

INSERT: Polyurethane

HARDWARE: Galvanized steel, Neoprene

ASSEMBLY:

1. 3/8" bolt and washers
2. Clamp top casting
3. Hardware retaining washer
4. Interchangeable inserts
5. Hanging clamp base casting

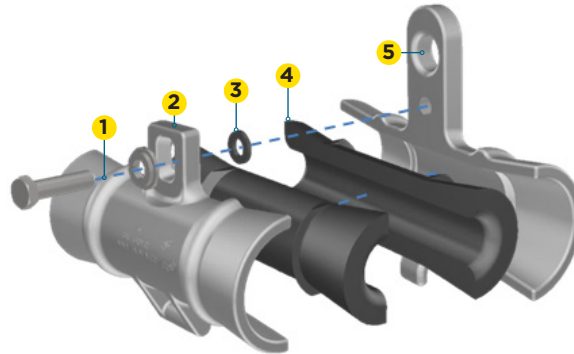

SAFETY INSTRUCTIONS:

The instructions in the document are not intended as a substitute for proper training or adequate experience in the safe installation and operation of the product described. Only competent technicians familiar with this product should install, operate and service it.

PRE-INSTALLATION INSTRUCTIONS

MOUNTING OPTIONS:

The Hubbell Hanging Aluminum Suspension Clamp should be installed with either a J-hook or eye-bolt/eye-nut.

J-HOOK:

For wooden poles or poles with through holes, the suspension clamp is secured to a pole mounted J-hook (HPS Part# PSC2080237) at all intermediate poles with angles less than 30° and perpendicular to the cable route (Figure 1).

EYE BOLT:

For wooden poles or poles with through holes, the suspension clamp is secured to a pole mounted eye-bolt or bolt with eye-nut with two 5/8" anchor shackles at all intermediate poles with angles less than 30° and perpendicular to the cable route (Figure 2). For metal and concrete poles or poles without through holes, a banding bracket accessory with eye-nut can be employed. (HPS Part# CHDBB1511H banding bracket, HPS Part# 6502 eye-nut, and HPS Part# CBAB3840 stainless steel band kit - Figure 3)

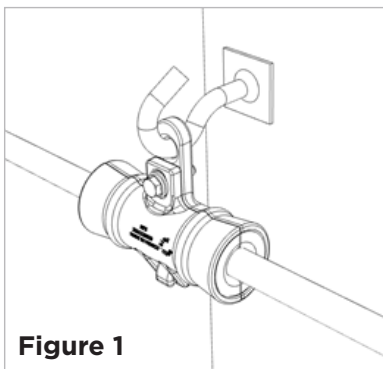

Figure 1

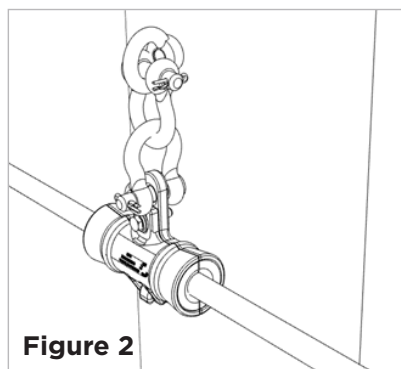

Figure 2

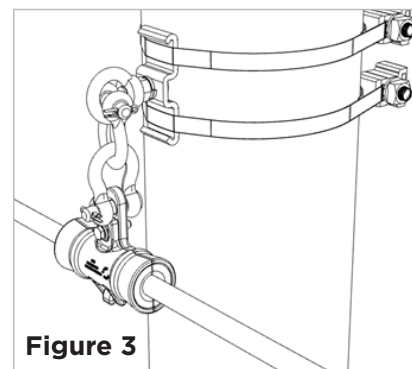

Figure 3

Hubbell has a policy of continuous product improvement. Please visit hubbellpowersystems.com to confirm current design specifications.

PRODUCT INSTALLATION AND USE INSTRUCTIONS

Step 1: After determining proper clamp mounting locations and appropriate mounting method, the Hanging Aluminum Suspension Clamp can be installed on intermediate poles. Prior to installation, inspect the product to ensure all parts are included and without defects. Also, the Suspension Clamp should be sized to fit the specific cable OD being installed. The application OD range is molded into the end of the interchangeable inserts. (See Step 1 Diagram)

NOTICE: Failure to inspect product before installation and failure to confirm suspension clamp is appropriate for specific cable OD being installed could result in failure of product to perform as necessary and/or property damage.

Step 2: Tension and deadend the cable at terminating poles consistent with the cable manufacturer's tension and sag requirements.

Step 3: Open the suspension clamp housing by loosening the assembly's 3/8" bolt (1). The hardware is made captive by a neoprene retaining grommet (2) to prevent loss of hardware. Allow the housing top casting (3) to hinge open enough to allow installation of the cable, ensuring that the interchangeable inserts (4) are properly seated within the two housing castings. (See Step 3 Diagram)

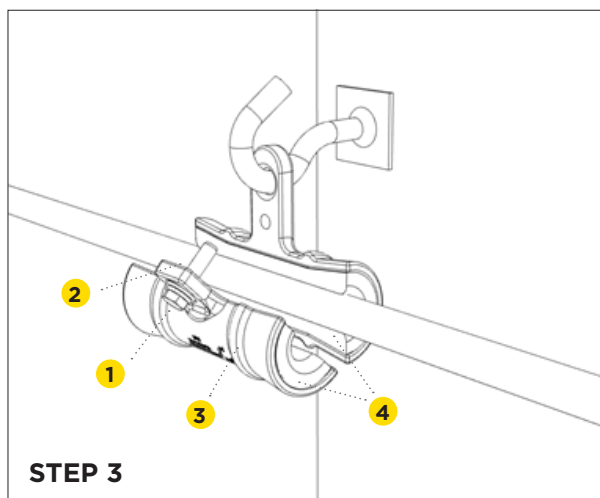
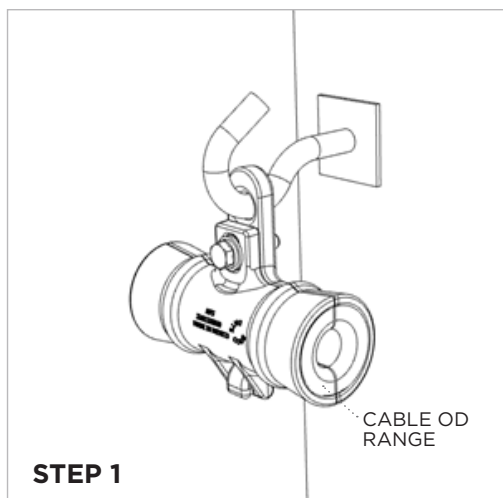

Step 4: After installing cable, close housing and tighten 3/8" bolt to recommended maximum torque of 180 in/lbs. (See Step 4 Diagram)

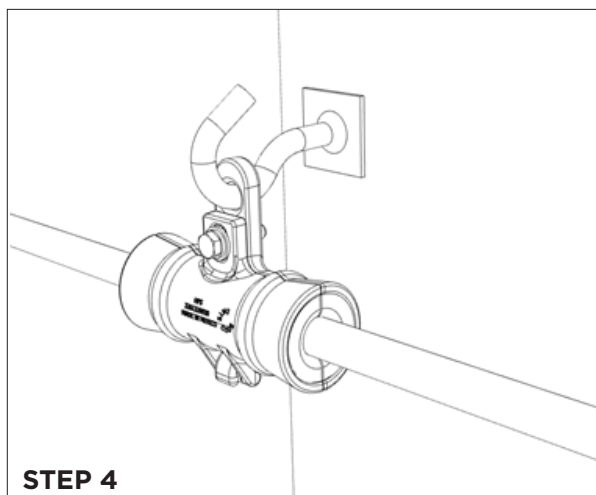

Hanging Aluminum ADSS Suspension Clamp			
HPS Part Number		ADSS Clamp Range	
Complete Assembly	Inserts Only (Pair)	Min (mm)	Max. (mm)
HUBSUSH199	HUB239	0.426 (10.8)	0.475 (12.0)
HUBSUSH200	HUB125	0.476 (12.1)	0.525 (13.3)
HUBSUSH201	HUB126	0.526 (13.4)	0.575 (14.6)
HUBSUSH202	HUB127	0.576 (14.7)	0.625 (15.9)
HUBSUSH203	HUB128	0.626 (16.0)	0.675 (17.1)
HUBSUSH204	HUB129	0.676 (17.2)	0.750 (19.1)
HUBSUSH205	HUB130	0.751 (19.2)	0.825 (21.0)
HUBSUSH206	HUB131	0.826 (21.1)	0.900 (22.9)
HUBSUSH207	HUB132	0.901 (23.0)	0.975 (24.8)
HUBSUSH208	HUB133	0.976 (24.9)	1.050 (26.7)

These instructions do not claim to cover all details or variations in equipment, nor to provide for all possible conditions to be met with concerning installation, operation, or maintenance of this equipment. If further information is desired or if particular problems are encountered which are not sufficiently covered in this guide, contact Hubbell Power Systems, Inc.

Hubbell has a policy of continuous product improvement. Please visit hubbellpowersystems.com to confirm current design specifications.

Hubbell Power Systems, Inc.
1615 Moore's St.
Leeds, AL 35094
(205) 699-2411
www.hubbellpowersystems.com

Hubbell has a policy of continuous product improvement. Please visit hubbellpowersystems.com to confirm current design specifications.