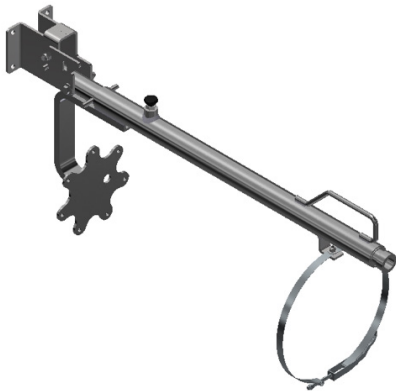


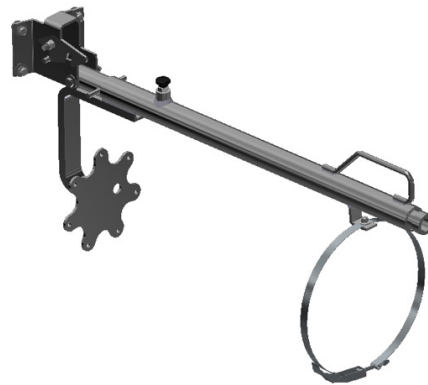
# PSC2080579 SWINGARM (END MOUNT) PSC2060260 SWINGARM (SIDE MOUNT) INSTRUCTIONS

## Product Intended Use:

These instructions are intended to illustrate the installation and operation of the Hubbell Power Systems, Inc. (“Hubbell”) PSC2080579 and PSC2060260 swingarm into a suitable Hubbell vault. This swingarm was designed to be compatible with the Corning LCPe closure and is independent from Corning Inc.



PSC2080579 (END MOUNT)



PSC2060260 (SIDE MOUNT)



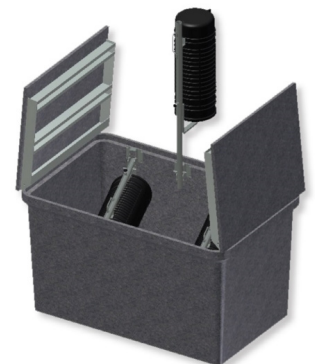
Single End Mount  
shown in PG3060  
Hubbell vault



Dual End Mount  
shown in PG3060  
Hubbell vault



Dual Side Mount  
shown in PG3660  
Hubbell vault



Triple Side Mount  
shown in 36x60  
Hubbell Torsion Assist



## TABLE OF CONTENTS:

	<u>PAGE NO.</u>
Introduction	1
Table of Contents	2
Guide To Warnings	3
Product Information & Pre-Installation Instructions	4
Product Installation & Use Instructions	5 - 10



## GUIDE TO WARNINGS WITHIN MANUAL

The following is a list of warnings used within this manual and should be read in their entirety to ensure safe practices.

### **WARNING**

A **WARNING** refers to operating procedures, techniques, etc., that, if not followed carefully, could **RESULT IN INJURIES OR DEATH**.

### **CAUTION**

A **CAUTION** refers to operating procedures, techniques, etc., that, if not followed carefully, could **RESULT IN DAMAGE TO EQUIPMENT or LOSS OF SERVICE** to customer.

### **NOTICE**

A **NOTICE** refers to information that is considered important, but not hazard-related.

## GUIDE TO WARNINGS FOR THE HUBBELL™ CORNING LCPE SWINGARM

### **WARNING**

When retracting equipment from an extended position, ensure handle on outer tube is firmly held when actuating the spring pin to prevent damage to cables, closure or personal injury.

### **CAUTION**

The equipment covered in these instructions must be used and serviced only by competent, trained personnel familiar with and following approved work and safety practices. This equipment is for use by such personnel and these instructions are not intended as a substitute for adequate training and experience in safe procedures for this type of equipment.

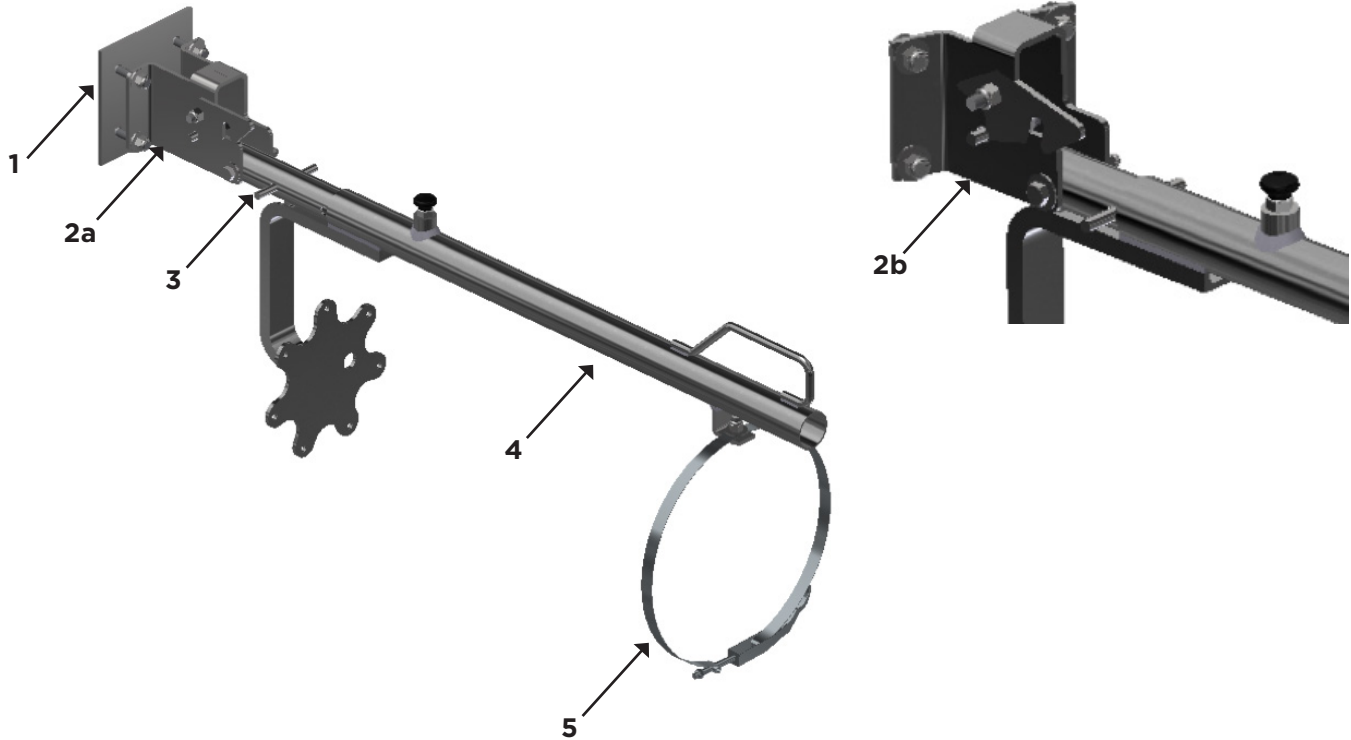
These instructions neither cover all details or situations in equipment use, nor do they provide for every possible contingency to be encountered in relation to installation, operation or maintenance. Should additional information or details be desired or if situations arise which are not covered adequately for the user's purpose, the specifics should be referred to Hubbell Power Systems, Inc.

### **NOTICE**

Before operating the Corning LCPE Swingarm, thoroughly read, understand and follow these instructions. Keep these instructions for future reference.



## PRODUCT INFORMATION



1. Backing Plate
- 2a. Mounting Bracket PSC2080579 (end mount)
- 2b. Mounting Bracket PSC2060260 (side mount)
3. Inner Tube
4. Outer Tube
5. Stainless Steel Strap

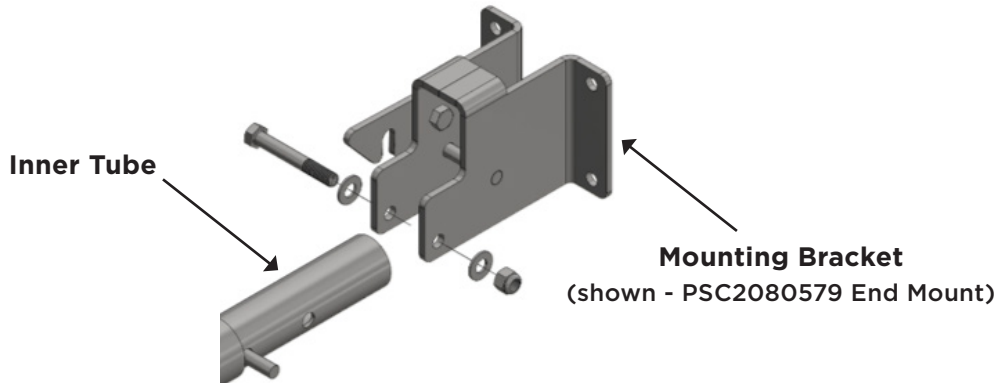
## PRE-INSTALLATION INSTRUCTIONS

When installing the swingarm in a Hubbell vault that is operational in the field, remove the dirt from the outside of the vault in the desired swingarm mounting location. Ensure vault is not damaged in the dirt removal process.



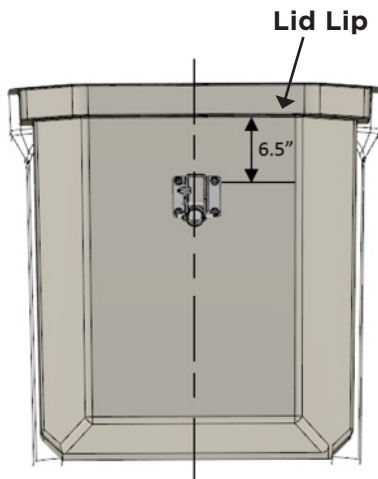
# PRODUCT INSTALLATION AND USE INSTRUCTIONS

1. Disassemble the mounting bracket from the inner tube assembly as shown below in FIGURE 1 (optional)

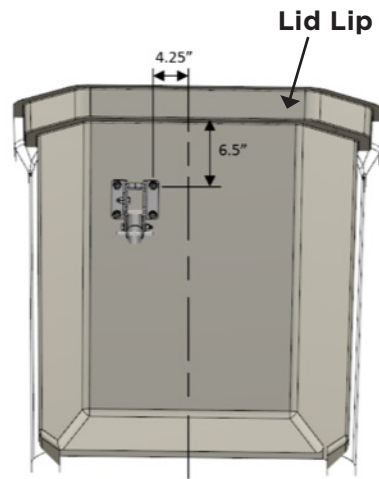


**FIGURE 1**

2. PSC2080579 (END MOUNT):
  - a. For single swingarm: Mark the centerline of the top mounting holes 6.5" from the lid lip as shown in FIGURE 2. Center the mounting holes on the centerline of the vault.  
NOTE: Ensure placement of mounting bracket allows vault lid to close and avoids structural ribs of vault.
  - b. For dual swingarm: Mark the centerline of the top mounting holes 6.5" from the lid lip. Mark the centerline of the hole closest to the centerline of the vault 4.25" from the centerline of the vault (see FIGURE 3).  
NOTE: Ensure placement of mounting bracket allows vault lid to close, avoids structural ribs of vault, and avoids second swingarm.
  - c. For torsion assist cover: No drilling required.



**FIGURE 2**  
**End Mount**  
**Single Mount**



**FIGURE 3**  
**End Mount**  
**Double Mount**



3. PSC2060260 (SIDE MOUNT)

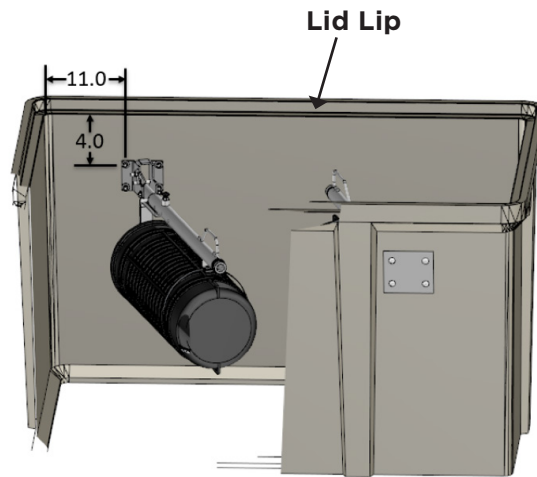
- a. For single swingarm: Mark the centerline of the top mounting holes 4.0" from the lid lip and 11.0" from the inside end wall as shown in FIGURE 4.

NOTE: Ensure placement of mounting bracket allows vault lid to close and avoids structural ribs of vault.

- b. For dual swingarm: Repeat step a. on the opposite side wall (see FIGURE 4).

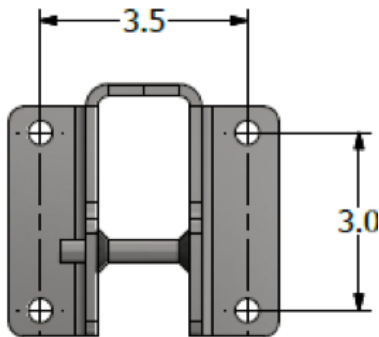
NOTE: Ensure placement of mounting bracket allows vault lid to close, avoids structural ribs of vault, and avoids second swingarm.

- c. For torsion assist cover: No drilling required.

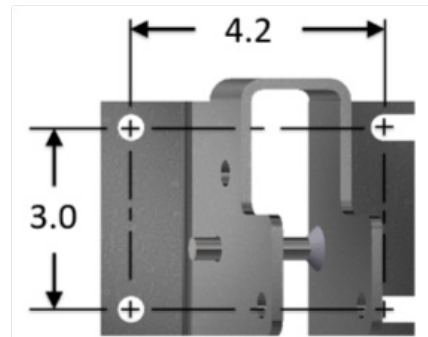


**FIGURE 4**  
**Side Mount**

- 4. Use the mounting bracket as a template to mark (4) hole locations per swingarm mount (see FIGURE 5 and FIGURE 6)



**FIGURE 5**  
**PSC2080579**  
**(END MOUNT)**

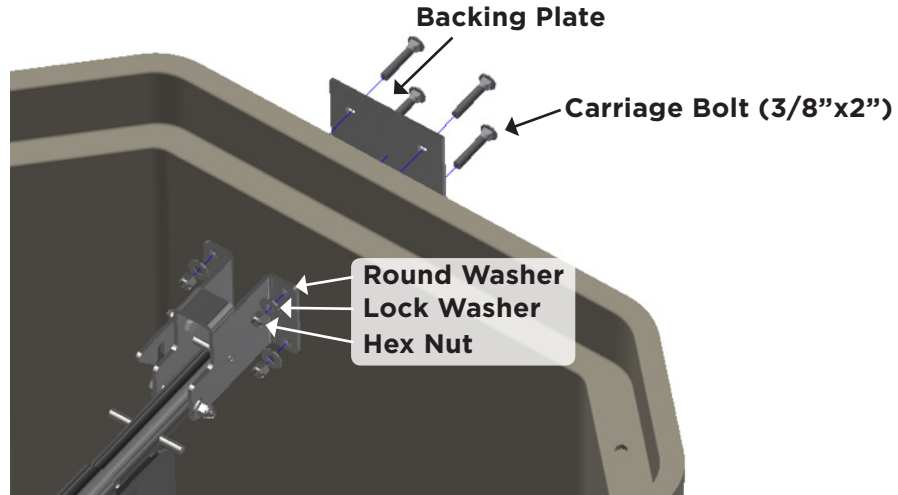


**FIGURE 6**  
**PSC2060260**  
**(SIDE MOUNT)**

- 5. Drill four  $\varnothing 7/16$ " holes per the layout given in. FIGURE 5 and FIGURE 6.

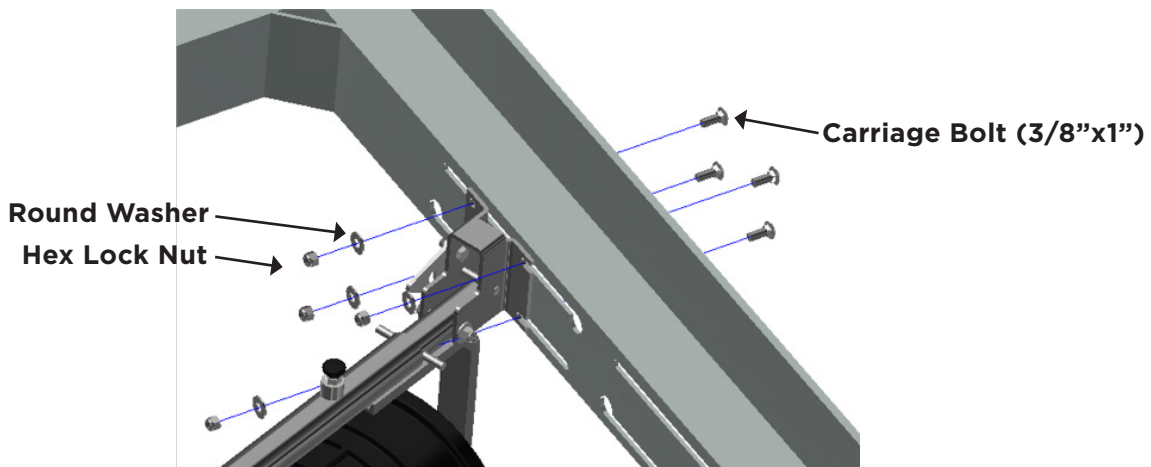


6. Use the provided mounting hardware (3/8" carriage bolts, round washers, lock washers, and hex nuts) to install the mounting bracket as shown in FIGURE 7 or 8
  - a. Polymer concrete enclosure with NO torsion assist cover
    - i. Place the backing plate flush on the outside of the vault
    - ii. Place the head of the bolts on the outside of the vault and through the backing plate
    - iii. Install round washer, lock washer, and hex nut



**FIGURE 7**  
(shown - PSC2080579 End Mount)

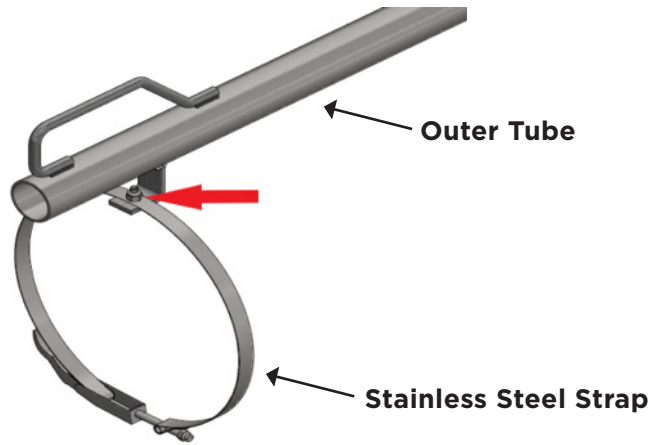
- b. Torsion assist cover
  - i. Place heads of (4) 3/8" x 1" carriage bolts into the slots of the desired swingarm location of the vault torsion cover
  - ii. Install round washer and hex lock nut



**FIGURE 8**  
(shown - PSC2060260 Side mount on torsion assist cover)

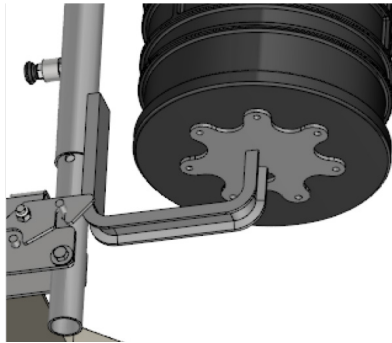


7. Install tube assembly if removed in Step 1.
8. Install stainless steel strap by centering over the top strap bracket on the outer tube with the provided 1/4" bolt and lock nut (see FIGURE 9)



**FIGURE 9**

9. Install Corning LCPe (purchased separately) onto swingarm per manufacturer's recommended installation procedure. Mounting hardware provided with Corning LCPe closure (see FIGURE 10)



**FIGURE 10**

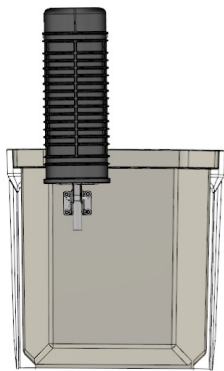


10. Extend/Retract swingarm by gripping swingarm handle and pulling spring pin. Fully retracted and extended positions are shown below in FIGURES 11 & 12.

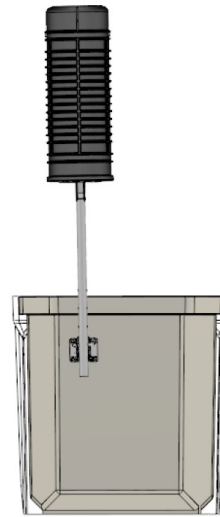
NOTE: Swingarm was designed to have optional hard stops at 3", 6" or 9" extensions when using the provided 3/8" bolt and lock nut.

## WARNING

When retracting equipment from an extended position, ensure handle on outer tube is firmly held while actuating the spring pin to prevent damage to cables, closure, and/or personal injury.



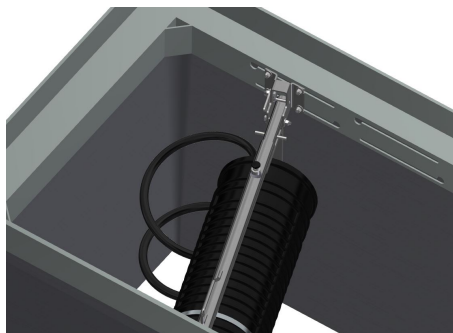
**FIGURE 11**  
**Retracted position**  
(shown - PSC2080579 End Mount)



**FIGURE 12**  
**Extended position**  
(shown - PSC2080579 End Mount)

## CAUTION

When Lowering the swingarm into the vault ensure the fiber cable is coiled as shown in Figure 13 to ensure the minimum bend radius is not violated and to prevent damage to the cables and/or closure.



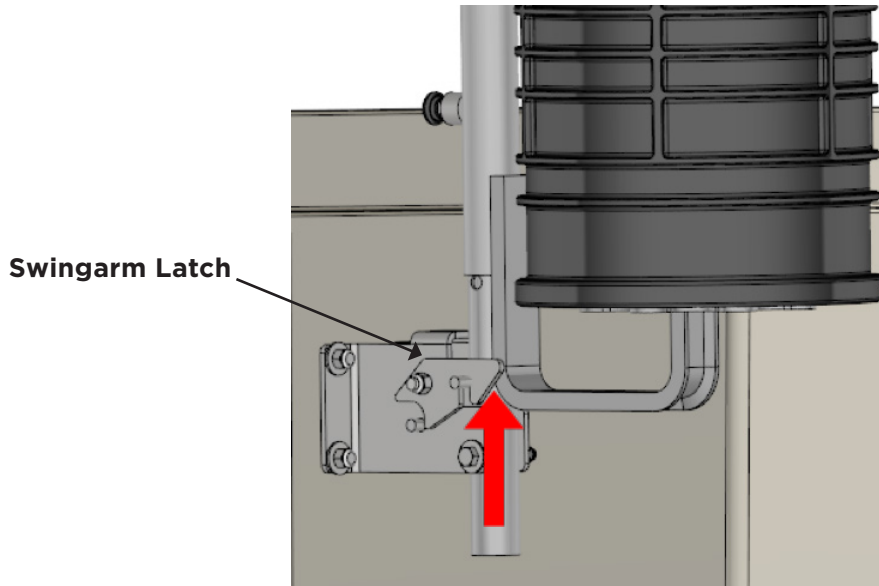
**FIGURE 13**  
(shown - PSC2060260 Side Mount)



11. Lower swingarm into the vault by grasping handle and lifting swingarm latch

**CAUTION**

When lower equipment into vault, ensure handle on outer tube is firmly held while actuating the swingarm latch to prevent damage to cables, closure, and/or vault. SEE FIGURE 14



**FIGURE 14**  
(shown - PSC2080579 End Mount)

12. Maintenance
- a. Ensure all hardware is securely fastened before operation
  - b. Ensure spring pin slides freely

These instructions do not claim to cover all details or variations in equipment nor to provide for all possible conditions to be met with concerning installation, operation, or maintenance of this equipment. If further information is desired or if particular problems are encountered which are not sufficiently covered in this guide, contact Hubbell Power Systems.

