

# VP-AD-ACC DECORATIVE ARM

VIPER ACCESSORY

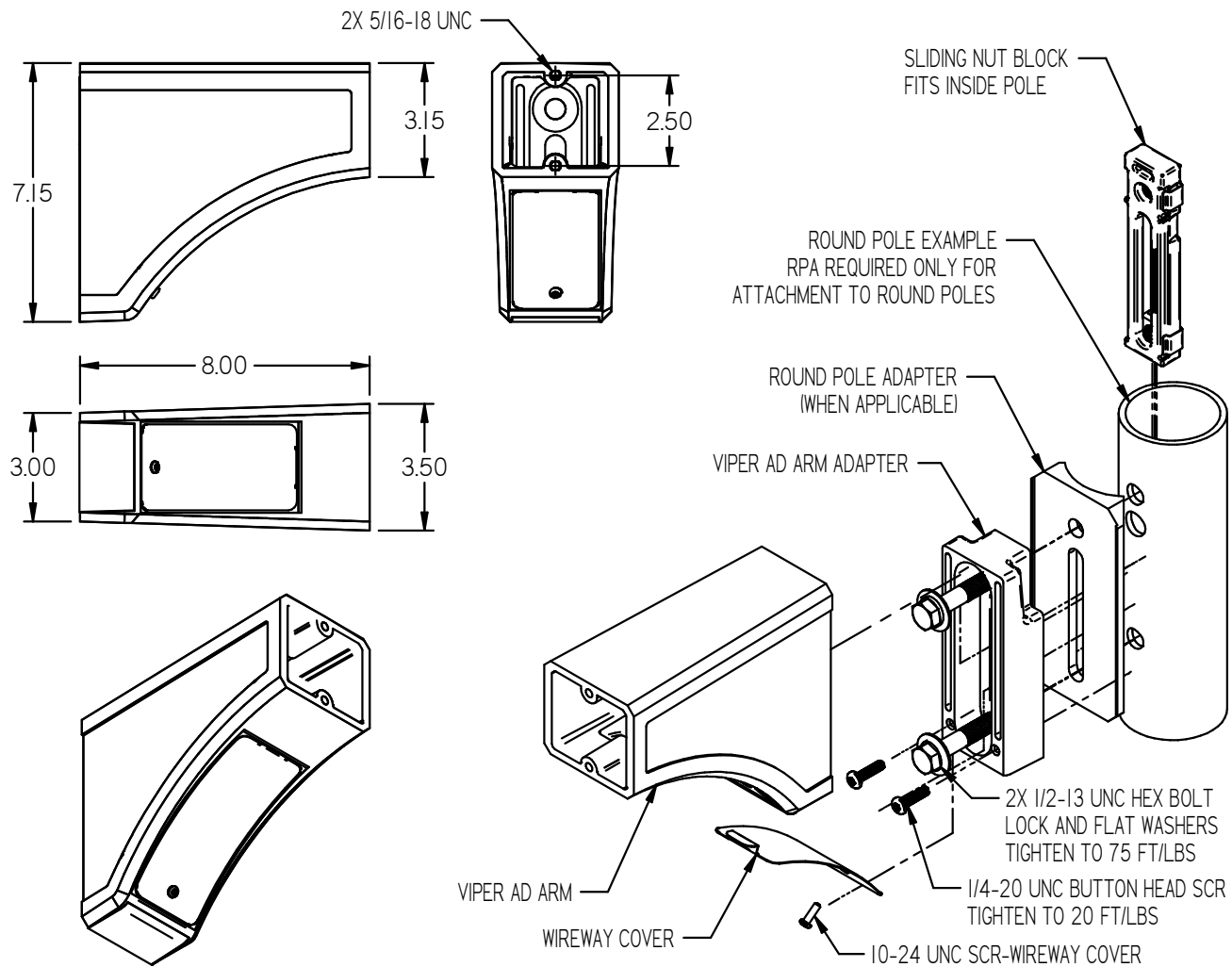

Compatible with: VIPER



## Mounting Notes:

1. Position the Adapter to align top 1/2" hole with the pre-drilled holes in pole.
2. Lower the Sliding Nut Block inside pole noting the side that is placed against the inside pole wall.
3. Place one 1/2-13 Hex Bolt with lock and flat washer through the bottom hole in the pole and tighten into the lower nut on the Sliding Nut Block.
4. Place the second 1/2-13 Hex Bolt with lock and flat washer through the top hole in the pole, locate and tighten into the top nut on the Sliding Nut Block.
5. Secure by torquing (2) 1/2" Bolts at 75 ft-lbs through Arm Adapter and Pole and into the Sliding Nut Block.
6. Feed wires through the pole and adapter so that it can be easily accessed for wiring when the arm is installed.
7. Position Viper Decorative Arm over AD Arm Adapter flush against the pole so that the lugs engage the mating details in the adapter.
8. Secure by torquing (2) 1/4-20 Screws at 20 ft-lbs through Viper Decorative Arm and into threaded holes in the AD Arm Adapter.
9. Secure by torquing (2) 3/8" Set Screws at 20 ft-lbs through Viper AD Arm and end into the AD Arm Adapter.
10. Consult fixture installation instructions to complete the installation.

## Shipping Package Contents:

Viper AD Arm  
Viper AD Arm Adapter  
Viper AD Arm Wireway Cover  
Sliding Nut Block Assembly

1/2-13 Bolts (2)  
1/2 Split Washers (2)  
1/2 Flat Washers (2)  
1/4-20 UNC Button Head Screws (2)  
10-24 UNC Button Head Screw (1)

**Material:** Aluminum  
**Finish:** Powder Paint  
**Weight:** 3 lbs

**Beacon Products**  
a division of Hubbell Lighting Inc.  
2041 58th Avenue Circle East  
Bradenton, FL 34203

Technical Support: (800) 345-4928  
Fax: (941) 751-5535  
www.beaconproducts.com

Catalog Number: VP-AD-ACC-XX  
Instruction Sheet: 93073266