

HUBBELL HOSE REELS

Cat. Nos. HBLHR2550C, HBLHR3835C, HBLHR3850C, HBLHR2535, HBLHR2550

INSTALLATION INSTRUCTIONS

GENERAL INFORMATION

NOTICE: For installation by a qualified individual in accordance with national and local safety codes and the following instructions.

CAUTION: RISK OF EXPLOSION. Not for use with oxygen. Do not convert air hose to oxygen service. Compressed air hoses are often contaminated with an oil coating, which can react explosively when oxygen is introduced.

CAUTION: RISK OF PHYSICAL INJURY OR DEATH. Disconnect and purge all system pressure before installing or uninstalling reel.

Check that the supplied system pressure does not exceed the maximum working pressure rating of the reel (300 psi).

Ensure that reel is properly installed before connecting system pressure.

A high-tension spring assembly is enclosed in a tamper resistant compartment. Do not open. Exercise extreme caution when unwinding or rewinding hose. If reel ceases to unwind or rewind, remove system pressure immediately. Do not pull or jerk on the hose.

Inspect the hose for rupture or damage before each use. Pull hose from reel by grasping the hose, not the attached tool.

If a leak should occur in the hose or reel, remove system pressure immediately.

DIMENSIONAL DATA

	A	E	G	X	Y	INLET
HBLHR2550C	5.75	16.50	17.63	2.25	6.00	3/8 NPTF
HBLHR2535	5.75	16.50	17.63	2.25	6.00	3/8 NPTF
HBLHR2550	5.75	16.50	17.63	2.25	6.00	3/8 NPTF
HBLHR3835C	5.75	16.50	17.63	2.25	6.00	3/8 NPTF
HBLHR3850C	6.25	16.50	17.63	2.25	6.00	1/2 NPTF

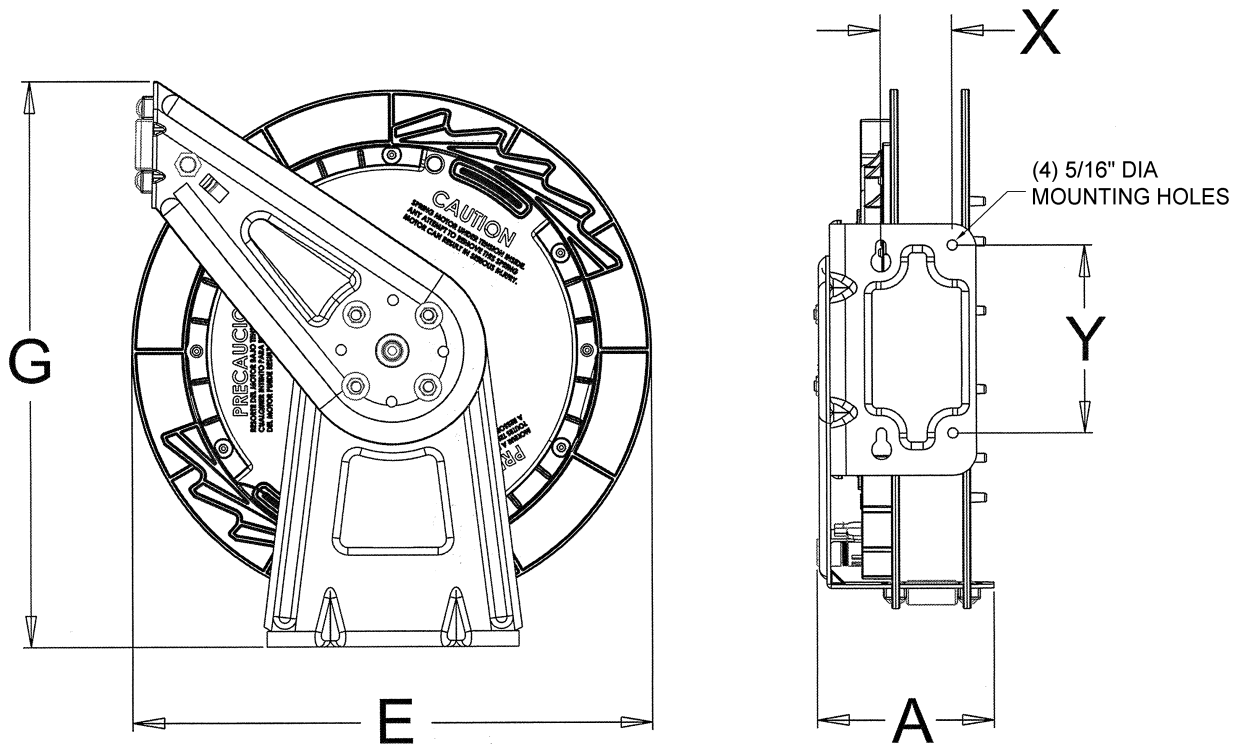

FIG. 1



MOUNTING

NOTICE: Maximum installation height is 16 feet (4.87 m). Do not exceed this distance.

1. Unpack and inspect reel for shipping damage. Turn by hand to check for smooth operation.
2. The reel can be mounted on the floor, wall or ceiling. Depending on where the reel is placed, it may be necessary to adjust the hose bumper and guide arm position to dispense the hose properly.
CAUTION: RISK OF INJURY. Spring winding mechanism is under tension. REMOVE tension as follows. Pull out hose until latch pawl is engaged. Remove bumper by removing slotted screws (item 4, Fig. 2). Carefully disengage latch pawl while maintaining a firm hold on the spool. Turn spool by hand approximately two or three revolutions in the direction of the drive spring until all tension is removed. Remove guide arm (item 2, Fig. 2) and spool by removing the 4 nuts (Item 1, Fig. 2).
3. Position the base to floor, wall or ceiling. Secure into place using four (customer supplied) fasteners (item 3, Fig. 2).
CAUTION: Reel is heavy – mount securely! Recommended mounting hardware: 1/4" X 1 1/2" (6mm X 40mm) lag screws with washers. If mounting over head, provide safety chain between reel base and mounting surface to prevent accidental reel drop.
For installation on a wood, drywall or stucco surface, mount the reel to a 2" (51 mm) thick piece of lumber that has been fastened into studs. For installation on a brick, cement, cinder block or other hard surface, insert aluminum anchors into the hard mounting surface before mounting the reel.
4. Determine new guide arm location and return spool and guide arm to base by replacing and securely tightening the 4 nuts. Tighten the drive spring by turning the spool two or three revolutions and then engage the latch pawl. Pull hose through the roller opening in the guide arm and replace the hose bumper.
5. Connect a (customer supplied) flexible hose supply line (item 5, Fig 2) to inlet. Do not use rigid plumbing. Apply pipe thread sealant to threads and do not overtighten the connection. Torque should not exceed 70 ft-lbs.

ADJUSTMENTS

HOSE BUMPER

Pull out hose until latch pawl is engaged. Adjust hose bumper by loosening slotted screws. Slide the bumper to desired position and tighten the screws before pulling hose to disengage latch pawl.

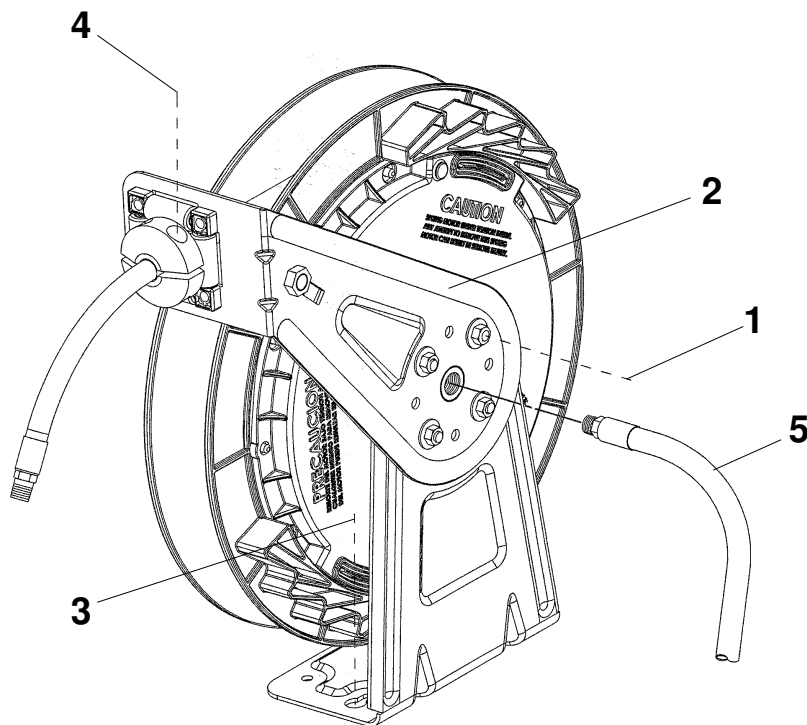

FIG. 2