

INSTALLATION INSTRUCTIONS

CATALOG NUMBER

EPA-T

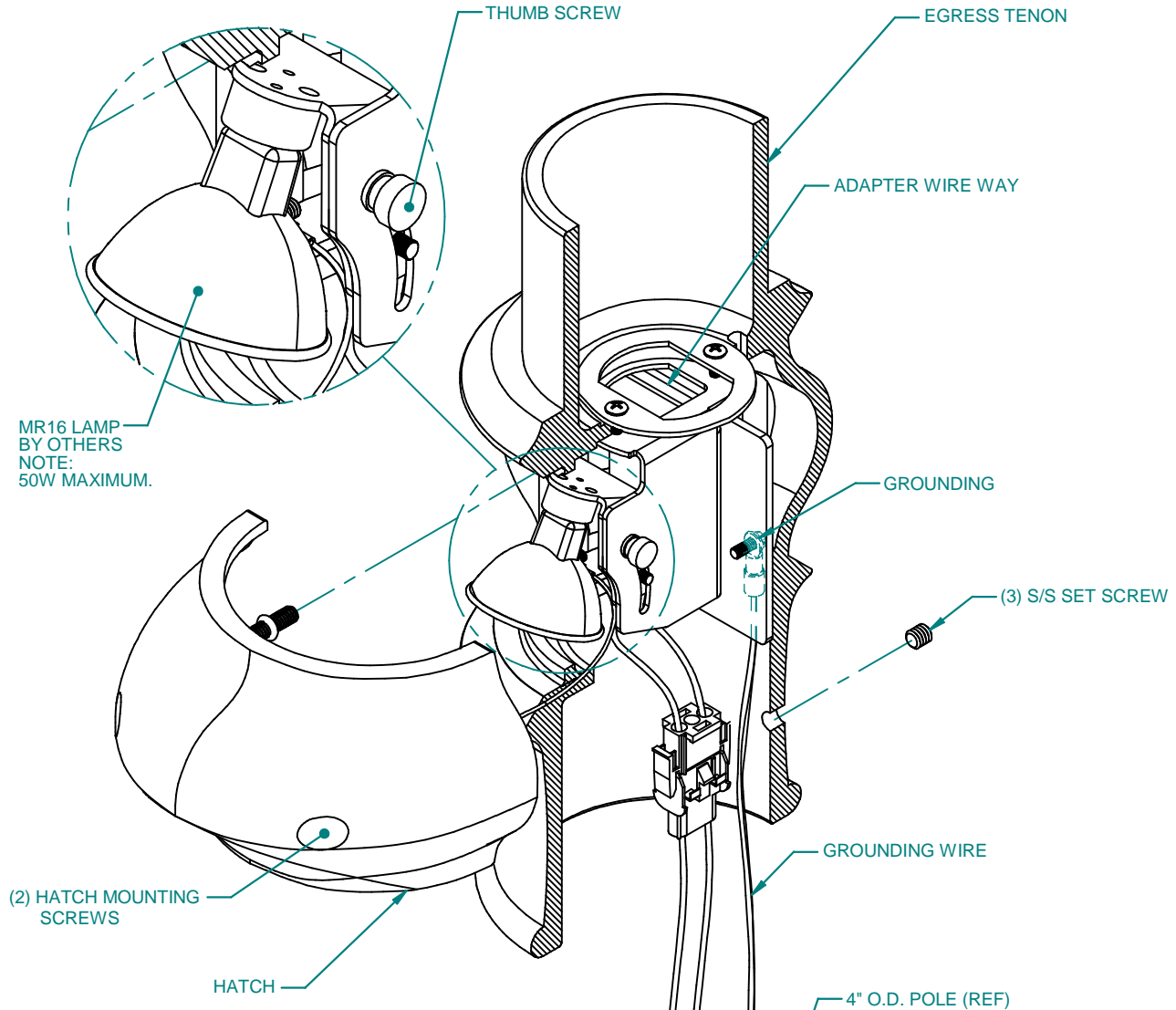

INSTALLATION INSTRUCTIONS:

1. TURN OFF ALL POWER.
2. CONNECT THE LEADS FROM THE EGRESS POST TOP ADAPTER TO THE AUXILIARY POWER SUPPLY AND PASS THE MAIN POWER SUPPLY LEADS THROUGH THE ADAPTER WIREWAY.
3. PLACE THE EGRESS POST TOP ADAPTER ON THE POLE TOP BUT DO NOT TIGHTEN YET.
4. LOOSEN (2) HATCH MOUNTING SCREWS. REMOVE HATCH.
5. INSTALL (1) MR16 (50 WATT MAX) LAMP PROVIDED BY OTHERS.
6. LOOSEN (1) THUMB SCREW AND ADJUST THE VERTICAL LAMP POSITION TO THE DESIRED LOCATION. TIGHTEN (1) THUMB SCREW.
7. REPLACE HATCH ON THE EGRESS POST TOP ADAPTER AND TIGHTEN (2) HATCH MOUNTING SCREWS.
8. ROTATE EGRESS POST TOP ADAPTER ON POLE TOP IN ORDER TO ADJUST THE HORIZONTAL LAMP POSITION. TIGHTEN (3) S/S SET SCREWS TO SECURE ADAPTER.
9. CONNECT THE LEADS FROM THE MAIN POWER SUPPLY TO THE POST TOP FIXTURE. PLACE THE POST TOP FIXTURE OVER THE EGRESS TENON AND SECURE THE FIXTURE TO THE EGRESS TENON. (BY OTHERS)

INSTALLATION INSTRUCTIONS

CATALOG NUMBER

EPA-C

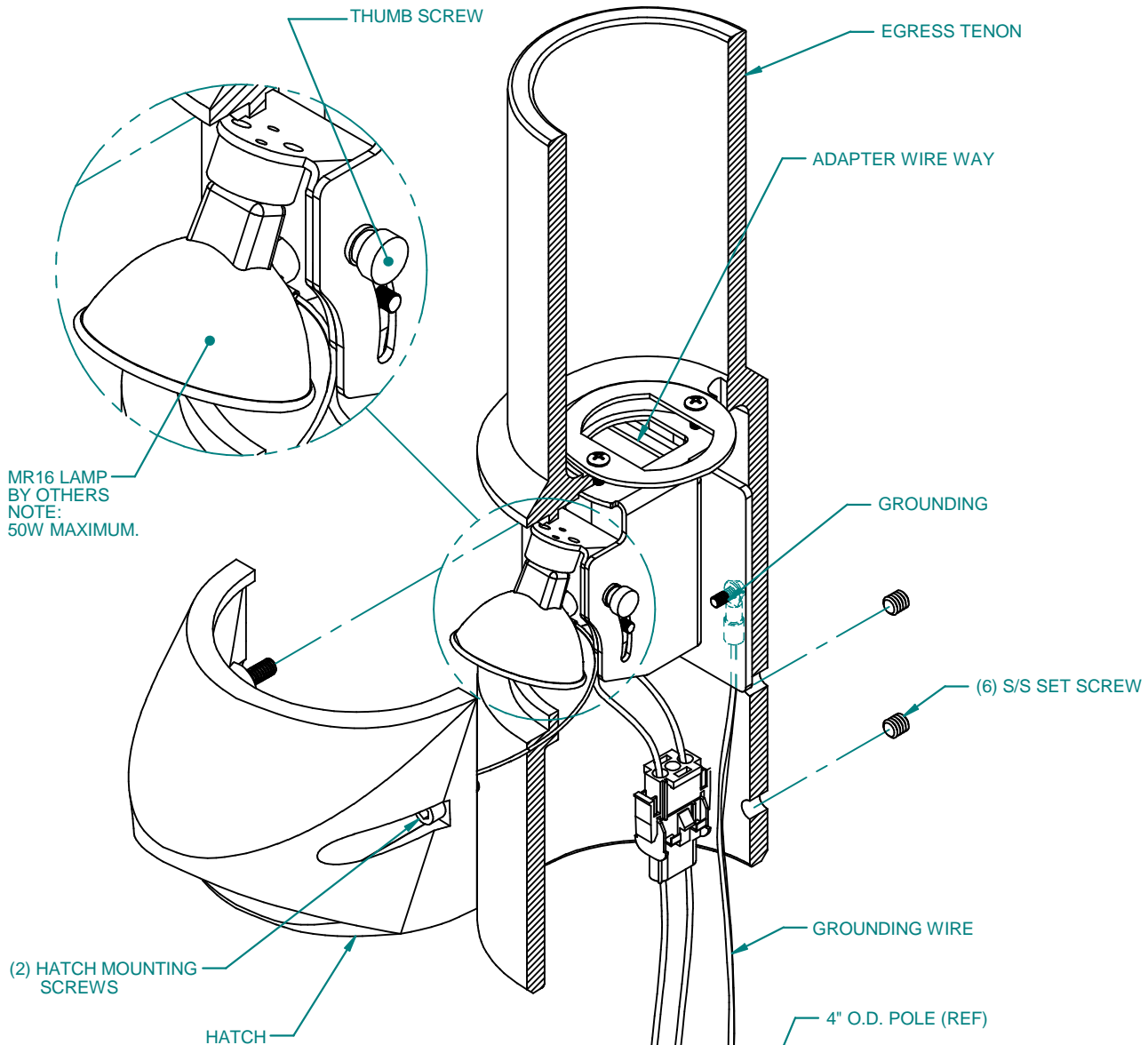

INSTALLATION INSTRUCTIONS:

1. TURN OFF ALL POWER.
2. CONNECT THE LEADS FROM THE EGRESS POST TOP ADAPTER TO THE AUXILIARY POWER SUPPLY AND PASS THE MAIN POWER SUPPLY LEADS THROUGH THE ADAPTER WIREWAY.
3. PLACE THE EGRESS POST TOP ADAPTER ON THE POLE TOP BUT DO NOT TIGHTEN YET.
4. LOOSEN (2) HATCH MOUNTING SCREWS. REMOVE HATCH.
5. INSTALL (1) MR16 (50 WATT MAX) LAMP PROVIDED BY OTHERS.
6. LOOSEN (1) THUMB SCREW AND ADJUST THE VERTICAL LAMP POSITION TO THE DESIRED LOCATION. TIGHTEN (1) THUMB SCREW.
7. REPLACE HATCH ON THE EGRESS POST TOP ADAPTER AND TIGHTEN (2) HATCH MOUNTING SCREWS.
8. ROTATE EGRESS POST TOP ADAPTER ON POLE TOP IN ORDER TO ADJUST THE HORIZONTAL LAMP POSITION. TIGHTEN (6) S/S SET SCREWS TO SECURE ADAPTER.
9. CONNECT THE LEADS FROM THE MAIN POWER SUPPLY TO THE POST TOP FIXTURE. PLACE THE POST TOP FIXTURE OVER THE EGRESS TENON AND SECURE THE FIXTURE TO THE EGRESS TENON. (BY OTHERS)

IMPORTANT SAFEGUARDS

When using electrical equipment, basic safety precautions should always be followed, including the following:

- a) READ AND FOLLOW ALL SAFETY INSTRUCTIONS.
- b) Do not mount near gas or electrical heaters.
- c) Equipment should be mounted in locations and at heights where it will not readily be subjected to tampering by unauthorized personnel.
- d) The use of accessory equipment not recommended by the manufacturer may cause an unsafe condition.
- e) CAUTION: Halogen cycle lamp(s) are used in this equipment. To avoid shattering: Do not operate lamp in excess of rated voltage, protect lamp against abrasion and scratches and against liquids when lamp is operating, dispose of the lamp with care.
- f) Halogen cycle lamps operate at high temperatures. Do not store or place flammable materials near lamp.
- g) Do not use this equipment for other than intended use.

SAVE THESE INSTRUCTIONS