

## VSB1C-LED/VSB2C-LED Vandal Resistant Square Concrete Bollard LED Installation Instructions

**WARNING:** Fixtures must be grounded in accordance with local codes or the National Electrical Code. Failure to do so may result in serious personal injury.

**NOTE:** All electrical work must be done by a qualified electrician.

**KEEP THIS SHEET FOR FUTURE REFERENCE.**

- Tools Required:**
- 3/16" Hex Key
  - 5/32" Hex Key
  - 7/16" Socket
  - 9/16" Open End Wrench
  - Ratchet with 9/16" Deep Socket

**!** Make certain electrical supply is **OFF** before starting fixture installation.

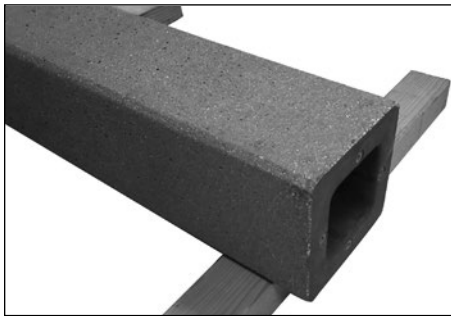

**1.** To protect finish, lay concrete bollard horizontally on wood blocks.

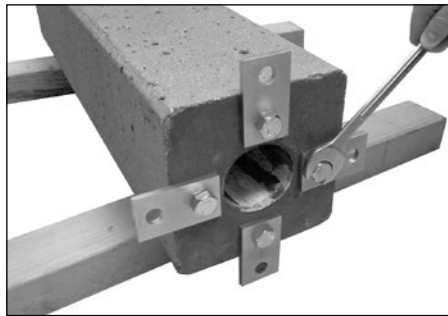

**2.** Install four anchor plates using 15/16" wrench with four 5/8-11 hex head bolts provided. Position the anchor plates straight from center on round bollards (see plan view below).

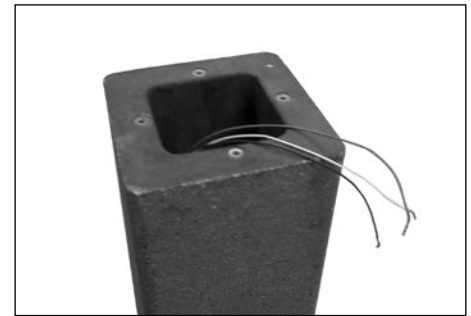

**3.** Route field wires through and out of top of bollard. Concrete bollards are heavy; use adequate means to lift bollard and set onto anchor bolts without dropping. Install flat washers and 1/2" nuts.

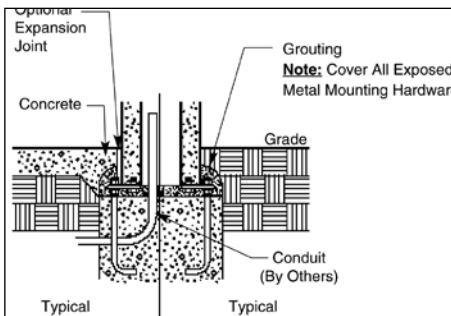

**4.** Make final adjustments to level bollard by turning the bottom nuts on the anchor bolts. The bollard must have full contact with concrete foundation by grouting. Mounting hardware must

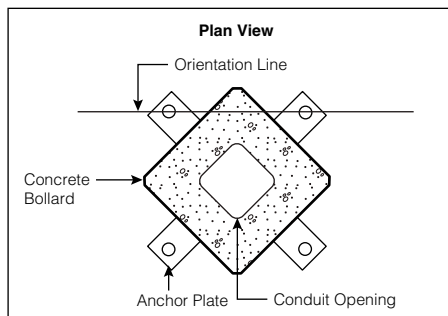

not be in contact with soil or other corrosive elements. If luminaire will not be installed on lit bollard, cover top of bollard so water and debris will not collect inside.



**5.** Locate two 1/4-20 button head top cap screws (180 degrees apart) concealed under top cap. Feel for screw heads approximately 3/4" up under top cap between vertical ribs. The screw heads are only visible from low angles near the fixture body. Loosen - do not remove - screws with 5/32" allen wrench. Turn top cap counter-clockwise and lift up to remove.

# VS B1C-LED/VS B2C-LED Vandal Resistant Square Concrete Bollard LED Installation Instructions

(cont. from p.1)



**6.** Using 7/16" wrench, remove two 1/4-20 nuts securing retaining strap. Remove retaining strap and glass globe.

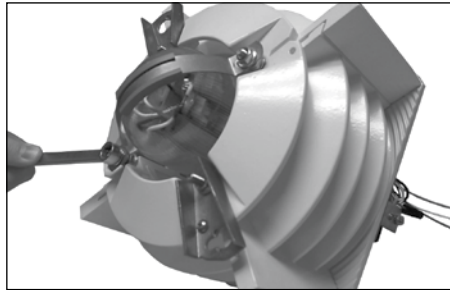

**7.** Using 7/16" wrench, remove four 1/4-20 hex nuts securing louver stack. Slide louver stacks off rods and set aside.

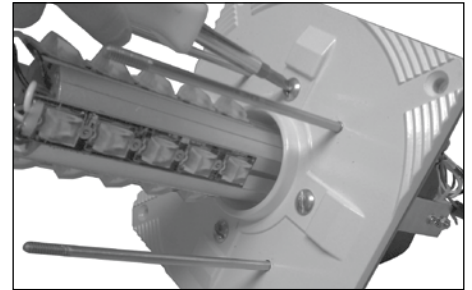

**8.** Using a flat blade screwdriver, loosen four 1/4-20 screws and remove mounting plate/driver assembly from bottom casting.

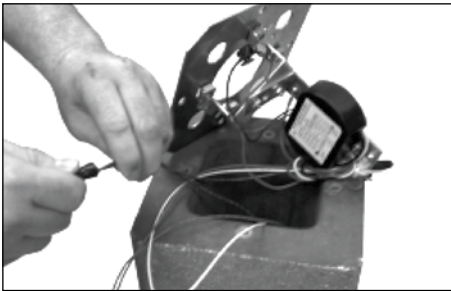

**9.** Make connections between the driver assembly and field wires, i.e. green-to-ground, white-to-common and black-to-voltage.

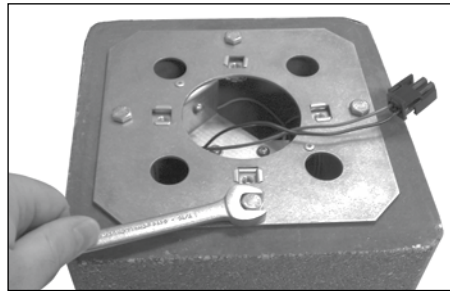

**10.** Using 7/16" wrench, install mounting plate with four 1/4-20 bolts provided.

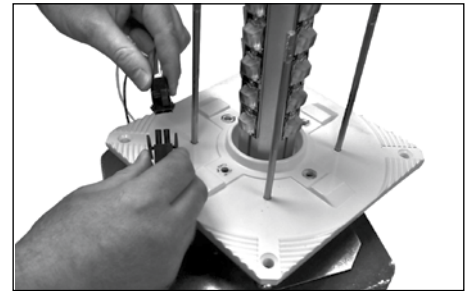

**11.** Join the disconnect plugs between driver assembly and optical assembly. Tuck extra wire into riser ensuring no wires get pinched during next step.

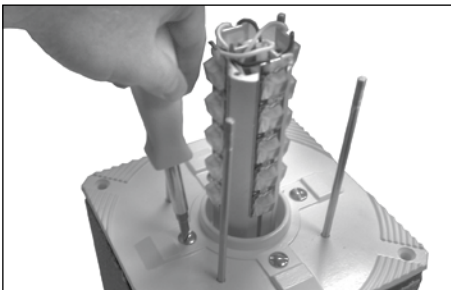

**12.** Using a flat blade screwdriver reattach the bottom casting/optical assembly to the mounting plate with four 1/4-20 screws.



**13.** Louver installation: Install two louver stacks without retainer bracket first, 180° apart by sliding onto the tension rods. Next, install the two louver stacks containing the retainer brackets 180° apart by sliding onto the tension rods.

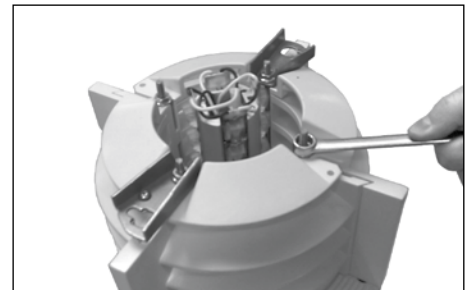

**14.** Using 7/16" wrench, secure louver stacks by replacing four 1/4-20 hex nuts and tighten.



**15.** Using 7/16" wrench, replace retaining strap and tighten with two 1/4-20 nuts.

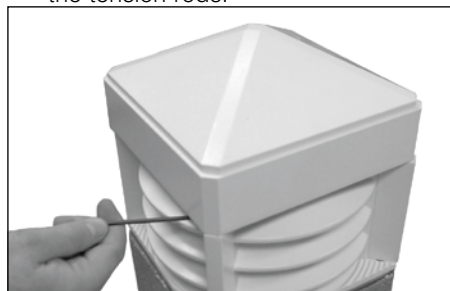

**16.** Replace top cap and turn clockwise, locking top cap in place. Using 5/32" hex key, locate and tighten two 1/4-20 button head top cap screws.

# VSB1C-LED/VSB2C-LED Vandal Resistant Square Concrete Bollard LED Installation Instructions

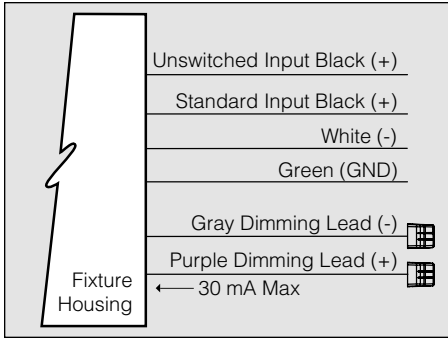

## 0-10V DIMMING

Driver has a 0-10V dimming interface with a dimming range of 10-100%. Is compatible with most control systems including Hubbell Building Automation wiHUBB™. Approved dimmers include Lutron Diva AVTV, Lutron Nova NFTV and NTFTV. Note: Not compatible with current sourcing dimmers. Controls compatible via Gray and Purple dimming lead.

## BATTERY BACKUP

If your fixture includes Battery Backup Option, an additional power wire is included labeled “Unswitched Power”. This lead must be connected to an unswitched power source running 120-277 VAC to function properly.

## LED BOLLARD WARRANTY

When properly installed and under normal conditions of use, Kim Lighting warrants LED Bollard products (“Product(s)”) sold by Kim Lighting to be free from defects in material and workmanship for (i) a period of five (5) years for metal parts, (ii) a period of ten (10) years for exterior housing paint finish(s), and, (iii) a period of six (6) years for LED Light Engines ( ) and, (iv) a period of five (5) years for LED power components (LED Driver), from the date of sale of such goods to the buyer as specified in Kim Lighting shipment documents for each Product(s). The buyer agrees to make all claims regarding defects or deficiencies in the Product(s) according to the terms of Kim Lighting’s official warranty. Warranty claims must be made in writing according to Kim Lighting procedures existing at the time of the claim. Valid warranty claims must be made within the warranty period specified herein above, and submitted within thirty (30) days of discovery of the damage or defect. No FIELD labor, repair, DISMANTLE, or installation charges are included with this warranty. Kim Lighting may repair or replace any Product(s) covered by this warranty at its sole discretion and in accordance with its procedure. Any unauthorized return, repair, replacement or modification of the Product(s) shall void this warranty. This warranty applies only to the use of the Product(s) as intended by Kim Lighting and does not cover any misapplication or misuse of said Product(s), or installation in hazardous or corrosive environments. In no event shall Kim Lighting’s total liability for any reason arising hereunder exceed the purchase price paid to Kim Lighting for the product purchased by the buyer hereunder. Contact Kim Lighting for complete warranty language, exceptions, and limitations.

### General Product Limited Warranty Coverage

All material and component parts used in the manufacture of Kim Products, are warranted to be free from defects of material and/or workmanship for a period of 1 year from date of sale, with the following exceptions:

### Auxiliary Equipment

All auxiliary equipment (such as drivers and battery backup) provided by and/or included in Kim Products shall carry the component manufacturer’s warranty.

### Aluminum Landscape Components

Aluminum Landscape fixture components not in direct contact with soil, shall be warranted against defects of material and/or workmanship for a period of 3 years from date of sale. Aluminum fixture components in direct contact with soil shall be warranted from defects of material and failure from corrosion for a period of 1 year from date of sale.

### Limit of Liability and General Conditions

Only products which are installed, used and maintained in accordance with applicable Kim instructions, specifications and accepted trade practices, are covered by the Kim Warranty. During the warranty period, with proof of purchase, Kim will repair or replace with the same or similar product, at Kim’s option, without charge. Labor costs are the owner’s responsibility and are excluded from this warranty. This warranty is void if the product is modified, tampered with, misapplied, poorly installed, improperly maintained, or subjected to abnormal conditions.

Repair or replacement as provided under this warranty is the exclusive remedy of the purchaser. This warranty is in lieu of all other warranties, expressed or implied, including any implied warranty of fitness for a particular application. Kim Lighting shall not be liable to the purchaser for indirect or consequential damages.