



## ECLIPSE X

LED Highbay

The Eclipse X is designed to minimise installation and maintenance activities whilst increasing photometric and electrical efficiency. The detachable hinge system allows installation and wiring to the mounting and terminal arrangement without the need to support the body, control gear and lamp assembly; enabling the installation process to be completed by a single installer.

The Eclipse X can also be easily retro-fit into existing Eclipse II applications with minimal installation time. Next generation energy efficient control gear and LED array provides the Eclipse X with sustainable credentials required of a modern LED fixture. With a range of lumen outputs, mounting options and a copper-free (epoxy painted) aluminium housing the Eclipse X will operate efficiently and effectively in the most arduous of environments.

CE

International Approvals

### Mounting Options:

Ceiling. Stanchion. Wall. Pendant. High Bay. Medium Bay. Low Bay.

## Standard Specification

Eclipse X Industrial LED Highbay

Enclosure	Copper free aluminium enclosure, epoxy painted (RAL 7008) with glass globe and diffuser guard
Cable Entry	4 x M20 cable entries c/w 3x plastic blanking plugs and 1x plastic travel plug
Termination	3 core 4mm <sup>2</sup> max. conductor with looping
Installation	Surface/Ceiling mounted 2 x 8.5mm dia holes
Control Gear	Electronic Driver
Optical Distribution	Wide Beam
Colour Temperature (CCT)	5000K (Cool White)
Colour Rendering Index (Ra)	>70
Maintenance	Barrel nut fastener
LED Lifetime @ 55°C Ambient L70	>100,000 hours
Ingress Protection	IP66
Surge Protection	6kV
Electrical Supply	120-277V AC, 50/60Hz

## Features

- ◆ Highly **Energy Efficient** up to 134 lm/W
- ◆ Instant on crisp white light output
- ◆ Simple retrofit to existing installations
- ◆ New light weight technology
- ◆ Wide ambient applications from -40°C to +55°C
- ◆ L70 greater than 100,000 hours at 55°C

Std. Cat No.	Delivered Output	Power Consumption	Ambient °C	Weight
ECXI/05L/LE	5,052 lm	40W	-40 to +55	4.9 kg
ECXI/09L/LE	9,430 lm	75W	-40 to +55	4.9 kg
ECXI/18L/LE	17,873 lm	140W	-40 to +55	6.1 kg
ECXI/28L/LE	26,977 lm	250W	-40 to +55	11.5 kg

Note: other ouputs may be available upon request.

Options - Suffix to Catalogue No.

/M25	M25 Cable entries (surface mount only)	/ST	Stanchion mounted version (25°)
/WM	Wall mounted version (2xM20 and 2xM25 entries)	/PE	Pendant mounted version (for M25 conduit)

Accessories (order separately)

	Order Code
Dome Reflector	SECXO-0001
30° Angled Reflector	SECXO-0002

ECXI/05L/LE & ECXI/09L/LE

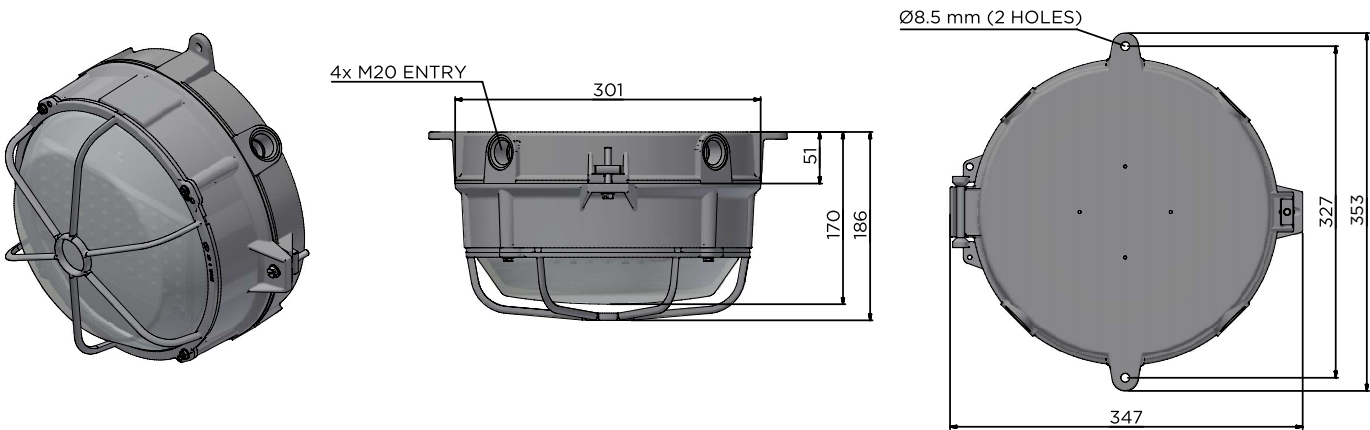

ECXI/18L/LE

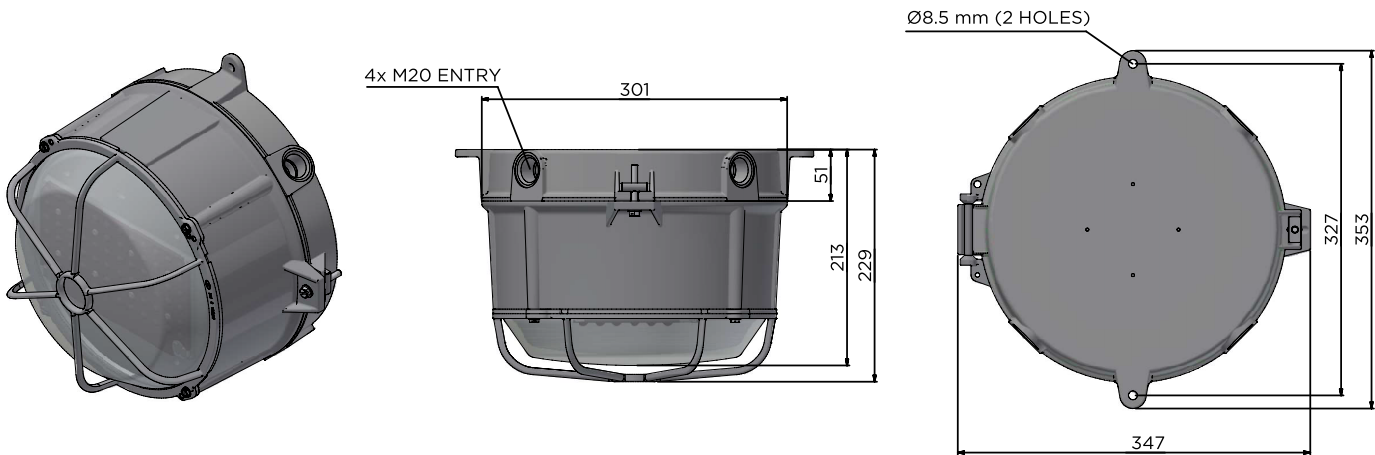

ECXI/28L/LE

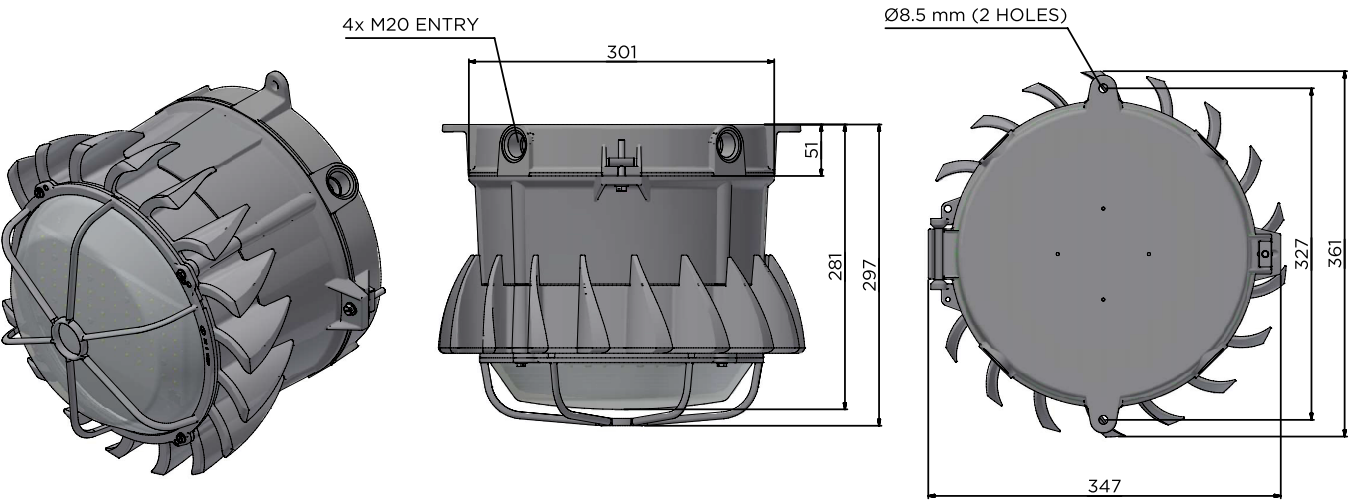

Reflector Options

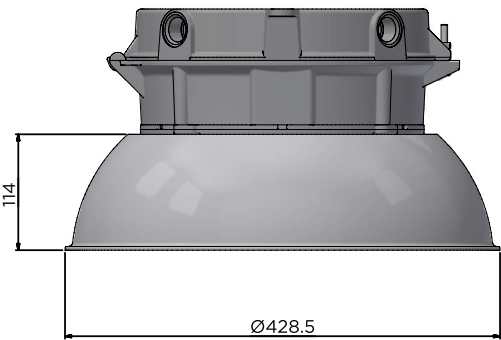

Dome Reflector  
(SECXO-0001)

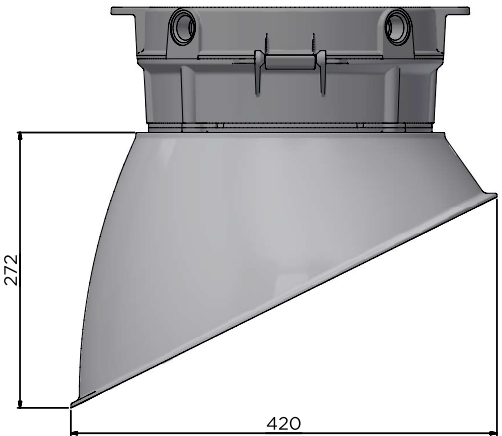

Angled Reflector  
(SECXO-0002)

Mounting Options

Wall Mount  
(/WM)

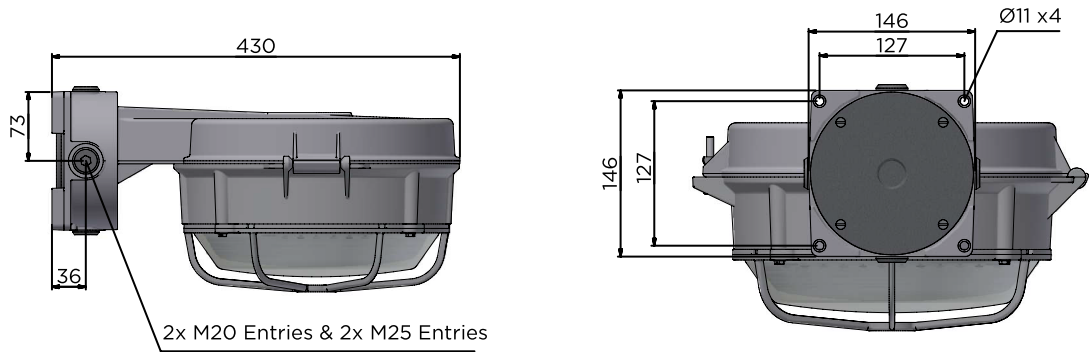

Pendant Mount  
(/PE)

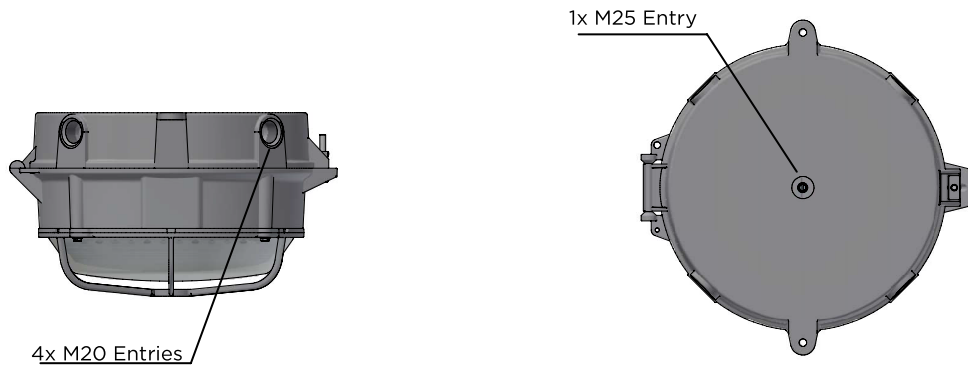

Stanchion Mount  
(/ST)

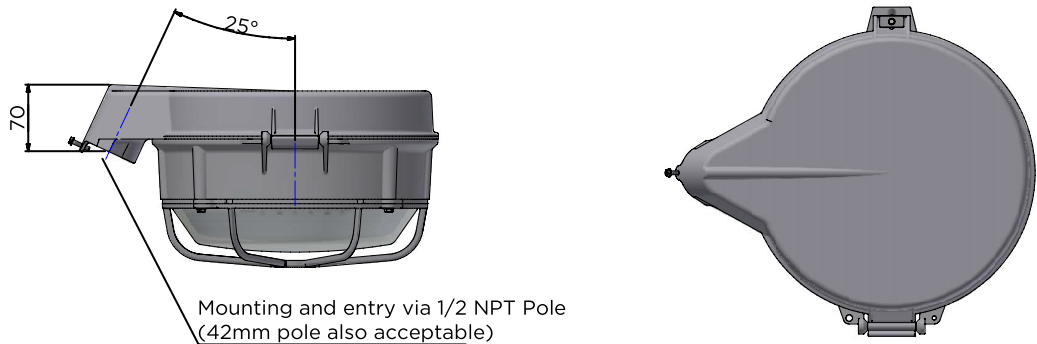

A proud member of the Hubbell family.