

**HUBBELL®**  
Wiring Device-Kellems





## Space Control



# Hubbell Room C

## Distributed Control



## Centralized Control



# Load:Logic® Controller



## Distributed Intelligence

- The Load:Logic® Room Controller is a microprocessor based unit that interfaces with sensing devices, such as occupancy sensors and photocells, smart switches, dimmers and load control receptacles by means of RJ45 connections.
- The controller optimizes a full range of control functions such as switching, daylight harvesting, and dimming required in an occupied space.

## Flexible Control

- The controller intelligently recognizes connected devices and assigns the most energy efficient operation mode.
- The Load:Logic Room Controller can be installed individually or in combination with other room controllers.
- Contains two independently controlled relays.
- A dimming version featuring two 0-10V channels for a full range of control is also available.

## Easy to Use

- Integrates automatic and manual control of lighting with the simplicity of plug-in installation.
- The controller's intelligent RJ45 ports reduce wiring errors and provide auto-configuration of sensors and switches.

## Increase Control

- Comprehensive configuration of functions through Bluetooth® technology and a free app available for Android® and iOS® devices.
- The controller automatically identifies devices as they are connected, and only shows connected devices for configuration.
- Foundation of a self-contained, scalable system delivers everything required for efficient control of a space.





# Hubbell Load:Logic® Room Controller

## Meet Energy Efficiency Standards

Easy selection of controllers with preconfigured operational modes in accordance with the latest energy codes and standards.

## Create Your Own Atmosphere

Includes options to enhance your personal experience with dimmers, preset light levels, customized light output, daylight harvesting, and more.

## Manual Control

Addressable Smart Switches that require no configuration out of the box, yet can be configured easily to your requirements.

## Effortless Experience Customization

The Load:Logic Room Controller NX App features a point-and-drop user interface, as found in today's iOS and Android devices. Only connected devices are shown for configuration.

## Basic System Configuration

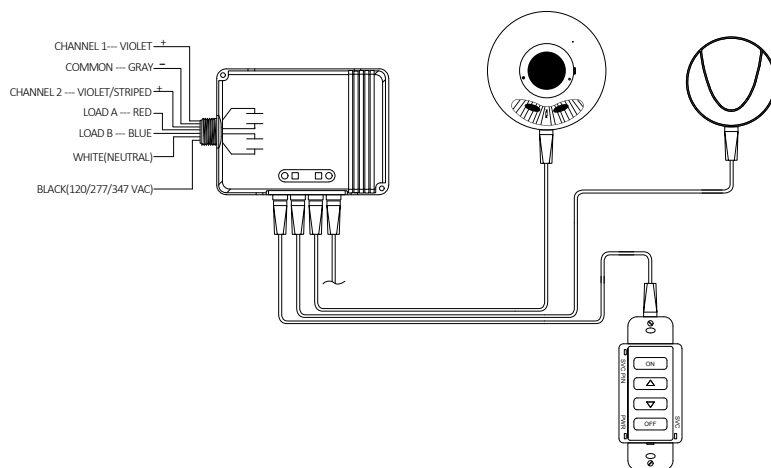
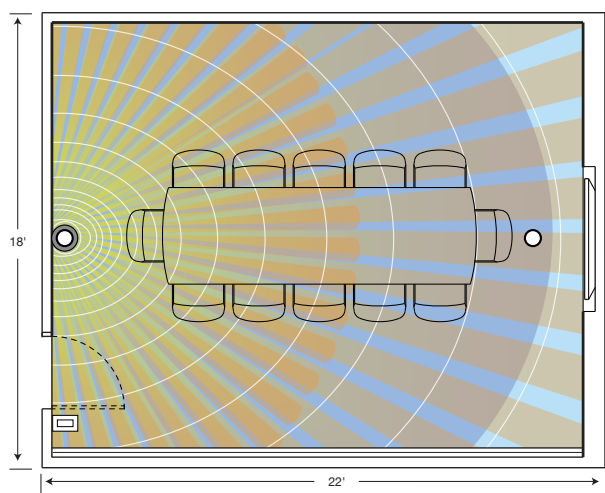

## Classroom or Office with Automatic Receptacle Control

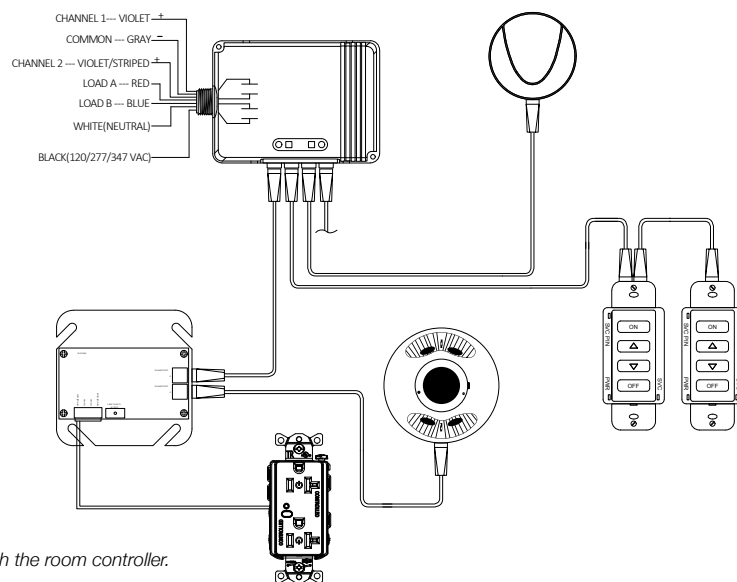
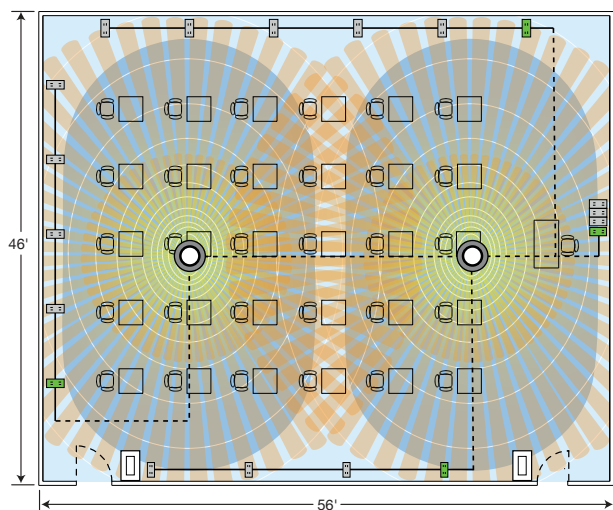

Note: Some devices require HBLRJ45A10 and/or BR241444 adapters to interface with the room controller. See ordering information for more details.

## Flexibility

Smart devices provide manual control and simple integration with external systems, such as HVAC and AV.

## Beyond Lighting Control

Hubbell Wiring Device-Kellems' comprehensive offering of Automatic Receptacle Control, wireless devices and HVAC and AV integration solutions complete the Load:Logic Room Controller system.



## Open Space with 2 Lighting Circuits and ARC

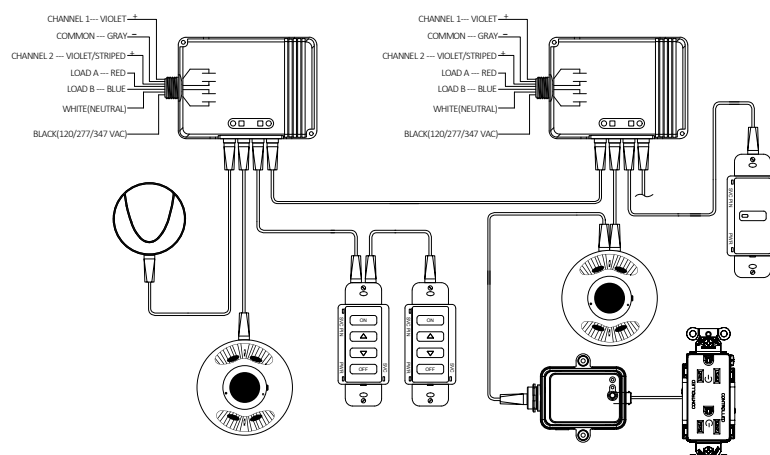
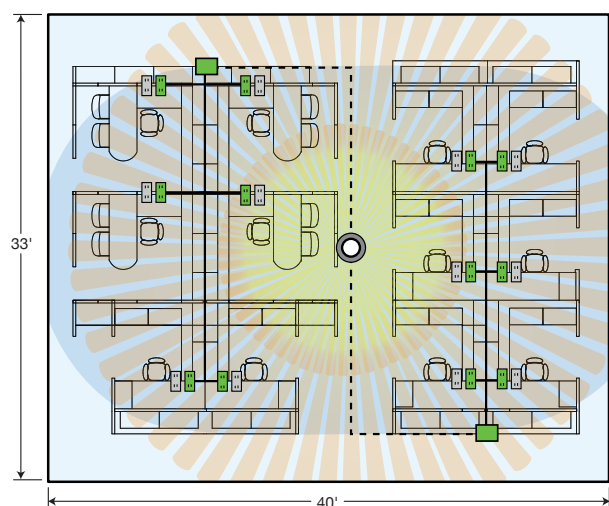

## Computer Lab with 2 Lighting Circuits and Wireless ARC

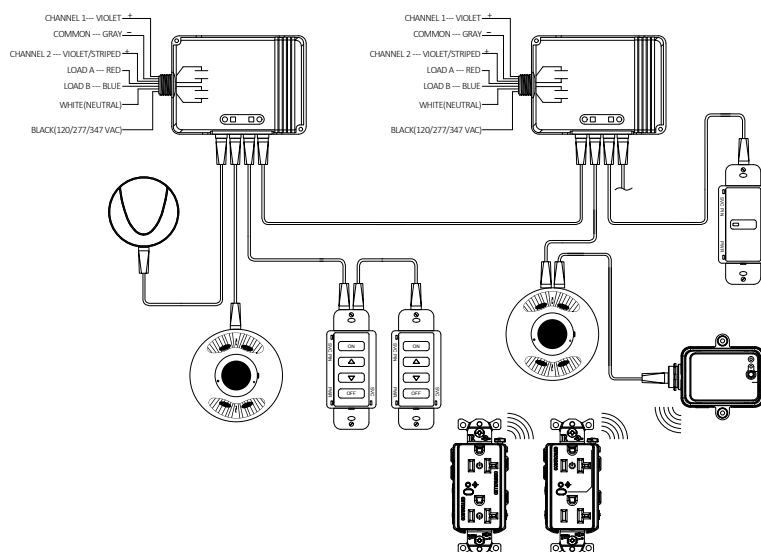
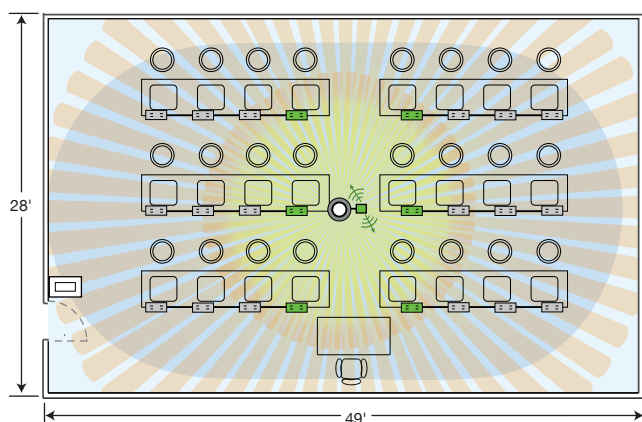

Note: Some devices require HBLRJ45A10 and/or BR241444 adapters to interface with the room controller.  
See ordering information for more details.

# Ordering Information

## Selecting Load:Logic - Easy as 1, 2, 3

- 1 Select the room controller
- 2 Select the appropriate sensors
- 3 Select the required smart switch
- 4 Select a wired or wireless switched receptacle for Automatic Receptacle Control, if required
- 5 Select desired interface cards (output to HVAC, wireless output, etc)

## Load:Logic® Room Controller

### Room Controllers

Description	Catalog Number
120/277V AC 2 Relays	<b>LLC2R</b>
120/277V AC 2 Relays with 2 0-10V Dimming Channels	<b>LLC2RD</b>



**LLC2R**



**LLC2RD**

## Sensing Devices

### Daylight Sensors

Description	Catalog Number
Daylight Sensor, Indoor	<b>RCDP</b>
Daylight Sensor, Outdoor	<b>RCODP</b>



**RCDP**

### Dual Technology Sensors

Description	Catalog Number
Ceiling Sensor, 1,000 sq.ft.	<b>ATD1000CRP</b>
Ceiling Sensor, 2,000 sq.ft.	<b>ATD2000C</b>
Wall Mount Sensor, 1,600 sq.ft.	<b>ATD1600WRP</b>

*Note: Requires (1) HBLRJ45A10*



**ATD2000C**



**ATD1600WRP**

## Smart Switches

### Room Controller Switches

Description	Black	Gray	Ivory	Light Almond	White
1 button with pilot light	<b>RCS1BK</b>	<b>RCS1GY</b>	<b>RCS1I</b>	<b>RCS1LA</b>	<b>RCS1W</b>
2 button with pilot light	<b>RCS2BK</b>	<b>RCS2GY</b>	<b>RCS2I</b>	<b>RCS2LA</b>	<b>RCS2W</b>
3 button with pilot light	<b>RCS3BK</b>	<b>RCS3GY</b>	<b>RCS3I</b>	<b>RCS3LA</b>	<b>RCS3W</b>
4 button with pilot light	<b>RCS4BK</b>	<b>RCS4GY</b>	<b>RCS4I</b>	<b>RCS4LA</b>	<b>RCS4W</b>
6 button with pilot light	<b>RCS6BK</b>	<b>RCS6GY</b>	<b>RCS6I</b>	<b>RCS6LA</b>	<b>RCS6W</b>



**RCS1W**



**RCS2W**



**RCS3W**



**RCS4W**



**RCS6W**

## Specialty Room Controller Switches

Description	Black	Gray	Ivory	Light Almond	White
4 button, no pilot light, ON/Raise/Lower/OFF	<b>RCSNRLFBK</b>	<b>RCSNRLFGY</b>	<b>RCSNRLFI</b>	<b>RCSNRLFLA</b>	<b>RCSNRLFW</b>
6 button, no pilot light, Scene	<b>RCSSCBK</b>	<b>RCSSCGY</b>	<b>RCSSCI</b>	<b>RCSSCLA</b>	<b>RCSSCW</b>
2 button, no pilot light, Raise/Lower	<b>RCSRLBK</b>	<b>RCSRLGY</b>	<b>RCSRLI</b>	<b>RCSRLLA</b>	<b>RCSRLW</b>
1 button with pilot light, Time to ON	<b>RCSTOBK</b>	<b>RCSTOGY</b>	<b>RCSTOI</b>	<b>RCSTOLA</b>	<b>RCSTOW</b>
2 button, no pilot light, ON/OFF	<b>RCSNFBK</b>	<b>RCSNGY</b>	<b>RCSNFI</b>	<b>RCSNFLA</b>	<b>RCSNFW</b>



**RCSNRLFW**



**RCSSCW**



**RCSRLW**



**RCSTOW**



**RCSNFW**

## Automatic Receptacle Control

### Wired Switched Receptacles

Description	Catalog Number
Split Controlled, 20A, White	<b>HBL5362LC1W</b>
Full Controlled, 20A, White	<b>HBL5362LC2W</b>

### Wireless Switched Receptacles

Description	Catalog Number
Split Controlled, 20A, White	<b>HBL5362RFC1W</b>
Full Controlled, 20A, White	<b>HBL5362RFC2W</b>

### Wireless Transmitter

Description	Catalog Number
Wireless transmitter with Clear Connect™*	<b>WLCA</b>

*Note: Requires (1) HBLRJ45A10*



**HBL5362LC1W**



**HBL5362LC2W**



**WLCA**

## Interface Card and Modules

### Interface Cards

Description	Catalog Number
Room Controller Dry Contact Input Interface	<b>RCDISP</b>
Room Controller NC/NO Output Interface	<b>RCSPOR</b>



**RCDISP**



**RCSPOR**

### Modules

Description	Catalog Number
Room Controller Bluetooth® Module	<b>RCBTM</b>
RJ45 Adapter for non native RJ45 devices (10-pack)	<b>HBLRJ45A10</b>
3-way Bridging Adapter (connects 2 devices sharing a signal)	<b>BR241444</b>



**RCBTM**



**HBLRJ45A10**

### UTP Cat. 5e Patch Cords, Plenum, No Boot

Description	Catalog Number
P-cord, NS, yellow, 3 FT	<b>NSC5EY03PNB</b>
P-cord, NS, yellow, 10 FT	<b>NSC5EY10PNB</b>
P-cord, NS, yellow, 25 FT	<b>NSC5EY25PNB</b>
P-cord, NS, yellow, 50 FT	<b>NSC5EY50PNB</b>
P-cord, NS, yellow, 100 FT	<b>NSC5EY100PNB</b>



**BR241444**



**NSC5EY03PNB**

\*Clear Connect™ is a registered trademark of Lutron Electronics Co., Inc



# Load:Logic® Room Controller



## Resources | Online

Hubbell offers a landing page dedicated to energy savings. Be sure to visit the Hubbell Wiring-Device Kellems website for more information.

## Also Online | Literature

Hubbell offers an extensive literature library for product support. Downloadable PDFs are available online.

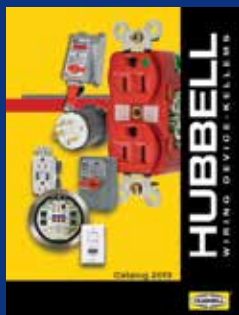

Hubbell  
Wiring Device-Kellems  
Catalog



Permanently Marked  
Receptacles for ARCS



Load Control Duplex  
Receptacles for ARCS



Hubbell H-MOSS®  
Occupancy Sensor  
Application Guide



Hubbell Load:Logic®  
Control Panels

**HUBBELL®**  
Wiring Device-Kellems

[www.hubbell-wiring.com](http://www.hubbell-wiring.com)

