

8/10-Gang Floor Boxes, for Concrete and Raised Access or Wood Floors

Hubbell's CFB10G and AFB10G Series 10-gang boxes can be utilized as 8-gang boxes by using Hubbell's NEMA mounting plates. The plates allow for an open system wiring, which means the boxes and mounting plates can be used with all NEMA spaced Data/AV devices.

FB10MPNEMA4G is a single service 4-gang mounting plate with NEMA spacing and can be used with all power devices or all Data/AV devices.

FB10MPNEMA2XG is a double 2-gang mounting plate with NEMA spacing on each of the 2-gang openings that ships with a low voltage divider and is well suited for mixing 2-gang active AV modules and 2-gang power. Ideal for Crestron[®] DM-TX style products.







FEATURES

- NEMA mounting plates allow for custom device configurations
- FB10MPNEMA4G; 4-gang single service NEMA spaced mounting plate
- FB10MPNEMA2XG; double 2-gang NEMA spaced mounting plate includes low voltage divider
- Standard metallic or non-metallic wallplates can be used with NEMA mounting plates
- Boxes, covers and mounting plates are cULus listed
- NEMA mounting plates can be used with concrete and access/wooden floor boxes
- Standard concrete and access/wooden floor boxes include NPT knockouts ranging from 1/2" to 2"
- Industry metallic or non-metallic wallplates to be used with NEMA mounting plates

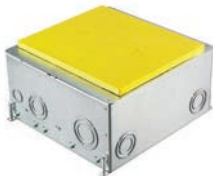

8/10-Gang Floor Boxes

8/10-Gang Floor Boxes for Concrete Floors

Rectangular Cover		Round Cover	
			
Standard CFB10G55	Corrosion-Resistant (On-grade) CFB10G55CR	Standard CFB10G55R	Corrosion-Resistant (On-grade) CFB10G55RCR

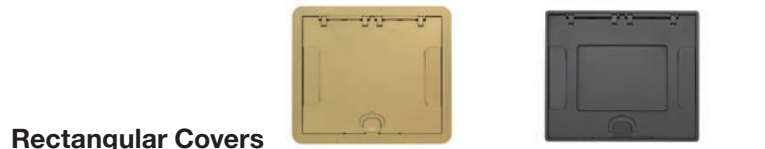

Rectangular Covers

Finish	Surface Cover dimensions 11½ in. x 10 in.	
	Without Insert	With Insert
Aluminum Powder Coat	610GCCVRALU	610GCCVRALUC
Black Powder Coat	610GCCVRBK	610GCCVRBKC
Brass Powder Coat	610GCCVRBRS	610GCCVRBRSC
Bronze Powder Coat	610GCCVRBRZ	610GCCVRBRZC
Satin Nickel Powder Coat	610GCCVRNKC	610GCCVRNKC

Finish	Flush Cover dimensions 10½ in. x 9 in.	
	Without Insert	With Insert
Aluminum Powder Coat	610GTCVRALU	610GTCVRALUC
Black Powder Coat	610GTCVRBK	610GTCVRBKC
Brass Powder Coat	610GTCVRBRS	610GTCVRBRSC
Bronze Powder Coat	610GTCVRBRZ	610GTCVRBRZC
Satin Nickel Powder Coat	610GTCVRNKC	610GTCVRNKC

8 Inch Round Covers

Finish	Surface
Brushed Aluminum	CFBS1R8CVRALU
Black Powder Coat	CFBS1R8CVRBLK
Brass Plated	CFBS1R8CVRBRS
Bronze Plated	CFBS1R8CVRBRZ
Gray Powder Coat	CFBS1R8CVRGRY
Satin Nickel Plated	CFBS1R8CVRNKL

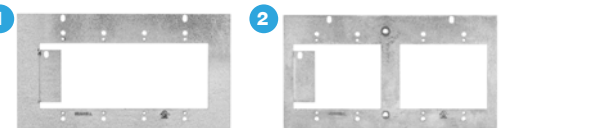

CFB/AFB Mounting Plates

Uses Five Gang Space - NEMA Mounting

- 1 FB10MPNEMA4G** (4) Single service openings utilizing 4-gang NEMA wallplate
- 2 FB10MPNEMA2XG** (2) 2-gang; meets NEMA spacing utilizing 2-gang NEMA wallplates

Uses One Gang Space

- FB10MPREC** (1) Decorator opening
- FB10MPDUP** (1) Duplex opening
- FB10MPBNK** (1) Blank
- FB10MPKEY** Decorator opening, including Hubbell ISF6GY 6-port frame
- FB10MPTRAC** (2) Openings to accommodate (6) Ortronics® TracJack®
- FB10MPFT** (1) Feed through opening with bushing

Uses Two Gang Space

- FB10MP2A** (2) Decorator openings
- FB10MP2E** (2) Duplex openings
- FB10TLX** (1) Simplex 1.40 in. opening
- FB10TLA** (1) Twist-Lock® 1.60 in. opening
- FB10MP2B** For (6) 1 Unit Hubbell iStation modules
- FB10MPAAP** For (4) Extron® AAP modules
- FB10MPMAAP** For (4) Extron® MAAP modules

Uses Three Gang Space

- FB10TLY** (2) Simplex 1.40 in. openings
- FB10TLB** (2) Twist-Lock® 1.60 in. openings
- FB10MP3GAPP** (1) Opening for appliance receptacle

Uses Five Gang Space

- FB10TLZ** (3) Simplex 1.40 in. openings
- FB10TLC** (3) Twist-Lock® 1.60 in. openings

Replacement Spacer

- FB10MPX** Replacement spacer around wire-way

8/10-Gang Floor Boxes for Raised Access or Wood Floors

	
Standard AFB10G55	Chicago AFB10G55CHI



Surface Rectangular Covers (for use with raised access tiles and wood floors)

Finish	Without Insert	With Insert
Aluminum Powder Coat	10GAFBCVRALU	10GAFBCVRALUC
Black Powder Coat	10GAFBCVRBK	10GAFBCVRBKC
Brass Powder Coat	10GAFBCVRBRS	10GAFBCVRBRSC
Bronze Powder Coat	10GAFBCVRBRZ	10GAFBCVRBRZC
Satin Nickel Powder Coat	10GAFBCVRNKC	10GAFBCVRNKC

Extron® is a registered trademark of Extron Electronics.
TracJack®, Series II® and Ortronics® are registered trademarks of Ortronics/Legrand.

Note: For more detailed product information visit our website.