



## FIRE ALARM STATIONS



XAL  
Pull Ring



XAS  
Break Glass

Class I, Div. 1 & 2, Groups C, D  
 Class I, Zones 1 & 2, Groups IIB, IIA  
 Class II, Div. 1 & 2, Groups E, F, G  
 Class III  
 NEMA 7 (C, D) 9 (E, F, G)

### FEATURES-SPECIFICATIONS

#### Applications

- Hazardous areas due to the presence of flammable gases or vapors, combustible dusts or easily ignitable fibers or flyings
- Installation at petroleum refineries, chemical and petrochemical plants, storage areas, and other processing facilities where hazardous substances are handled or stored
- Areas where emergency control of fire alarm or signal circuits is required

#### Features

- Enclosure is made of copper free aluminum alloy
- Conduit openings are 3/4" NPT feed through
- Red, textured powder epoxy paint finish is standard on box and cover and provides high visibility for alarm station
- XAL-458 has (2) normally open and (2) normally closed contacts.
- Bilingual nameplates included per CSA requirement
- Internal ground screw is standard

REPLACEMENT PARTS	
CATALOG NUMBER	DESCRIPTION
YOKK15214	XAS REPL. GLASS
KIT-232	XAS REP. HAMMER & CHAIN

#### Operation

**XAL:** The alarm station is activated by lifting the front cover and pulling down ring. This quick, easy to use two-step process prevents unintentional operation.

**XAS:** Breaking glass with hammer provided activates alarm. Reset by replacing glass.

#### XAL Series:

LISTED - File E50498

Listed - CE69

Certified - File LR31085

Listed - California State Fire Marshall #7150-1439:100

#### XAS Series:

LISTED - File E50498

Certified - File LR31085  
 See files for details or call Killark.

XAL FIRE ALARM STATION		
CATALOG NUMBER	OPERATION TYPE	CONTACT BLOCKS
XAL-53	PULL RING	(1) NO/NC
XAL-458	PULL RING	(2) NO/NC
XAS-53	BREAK GLASS	(1) NO/NC

CONTACT BLOCK RATING								
AC						DC		
VOLTS	MAKE AMPERES	VA	BREAK AMPERES	VA	CONTINUOUS CARRYING AMPERES	VOLTS	MAKE BREAK	CONTINUOUS CARRYING AMPERES
120	60	7200	6	720	10	125	1.1	5.0
240	30	7200	3	720	10	250	0.55	5.0
480	15	7200	1.5	720	10	600	0.2	5.0
600	12	7200	1.2	720	10	—	—	—

#### Dimensions

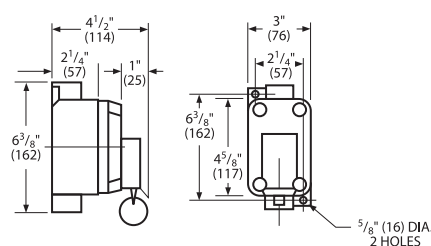

XAL-53

Note: On XAL-458 the overall depth is 5-9/16"

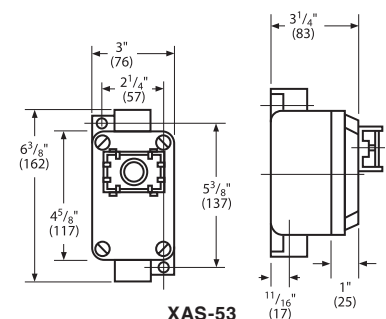

XAS-53