



Wire Management Solutions

ACME CABLE CLIPS CABLE TIES

GENERIC INSTALLATION INSTRUCTIONS For *Utility Scale Solar* only

BURNDY recommends that the sufficient details of the installation be submitted to the AHJ for approval before any work is started.

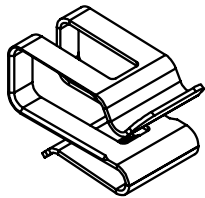

ACC-FLD

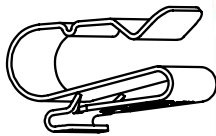

ACC-PV

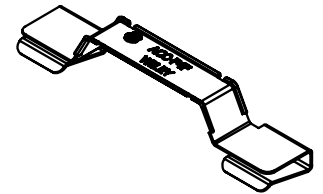

ACC-F4F

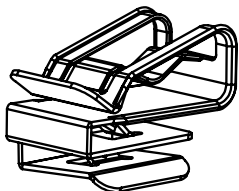

ACC-F90-1

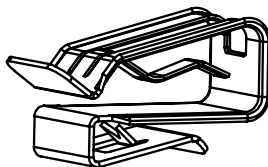

ACC-FPV

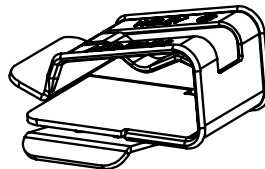

ACC-FPV90

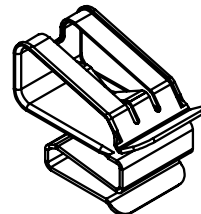

ACC-FPV180

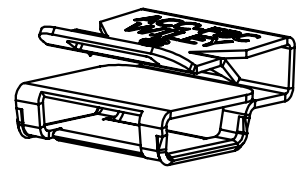

ACC-FBC

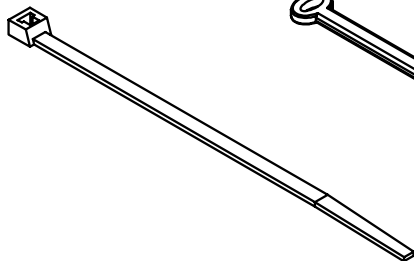

UNIRAP™

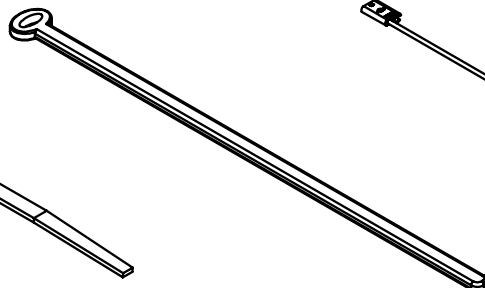

WIS

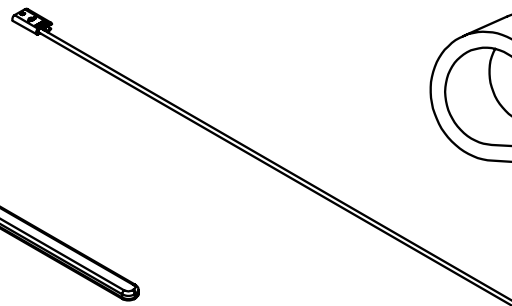

WBS

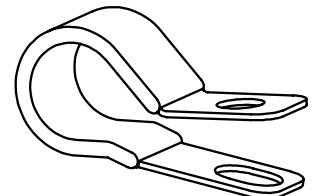

WIPC



Products are tested to UL 1565 & CSA C22.2 No. 18.5-13, US/Canadian standards for safety Positioning Device.



WIRE MANAGEMENT PRODUCTS-FEATURES

ACME CABLE CLIPS-SOLUTIONS

Engineered for high-quality wire management solutions, Wiley Cable Clips simplify wire management and lead to safer and more reliable wiring of the solar PV array.

The clips are made of corrosion resistant 304 stainless steel, which makes them a durable, long lasting and reliable solution for all environments.

Wiley Cable Clips are designed for easy installation with no tool required and they are reusable.

Custom designs are available upon request. For more information regarding module compatibility, please see the technical documents section of our website.

Coined edges to prevent damage to cable insulation

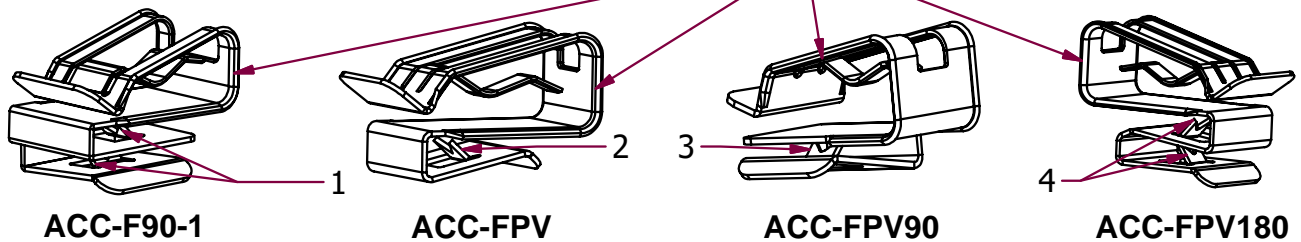

Coined edges to prevent damage to cable insulation

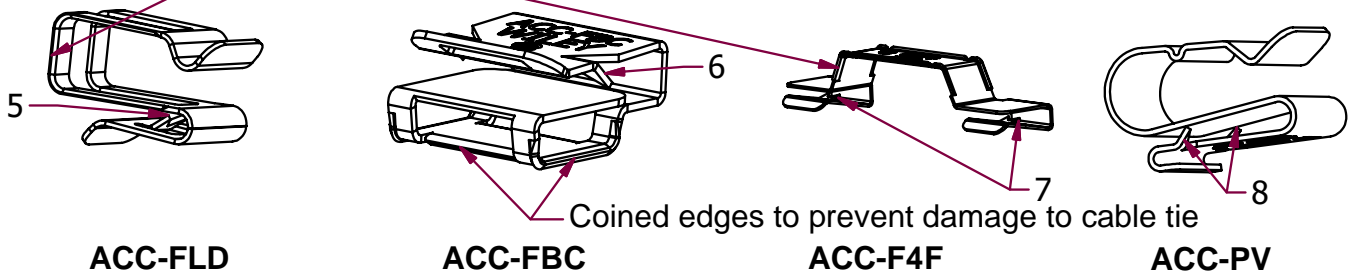

*The above mentioned 1, 2, 3, 4, 5, 6, 7 and 8 are special tabs for easy installation and removal.

ACME CABLE CLIPS-COMPATIBILITY

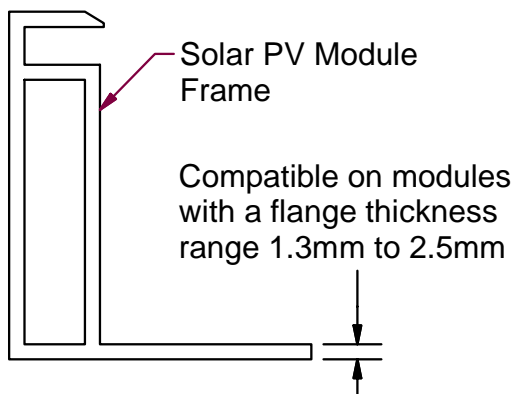

Note:

Application: Module frame flange mounting

CABLE TIES (WIS, WBS, WIPC & UNIRAP)

For information regarding Wiley cable ties, please see the technical documents section of our website.

SYSTEM OVERVIEW

WIRE MANAGEMENT PRODUCTS - FEATURES

UTILITY SCALE SOLAR - TRACKER - PORTRAIT-1

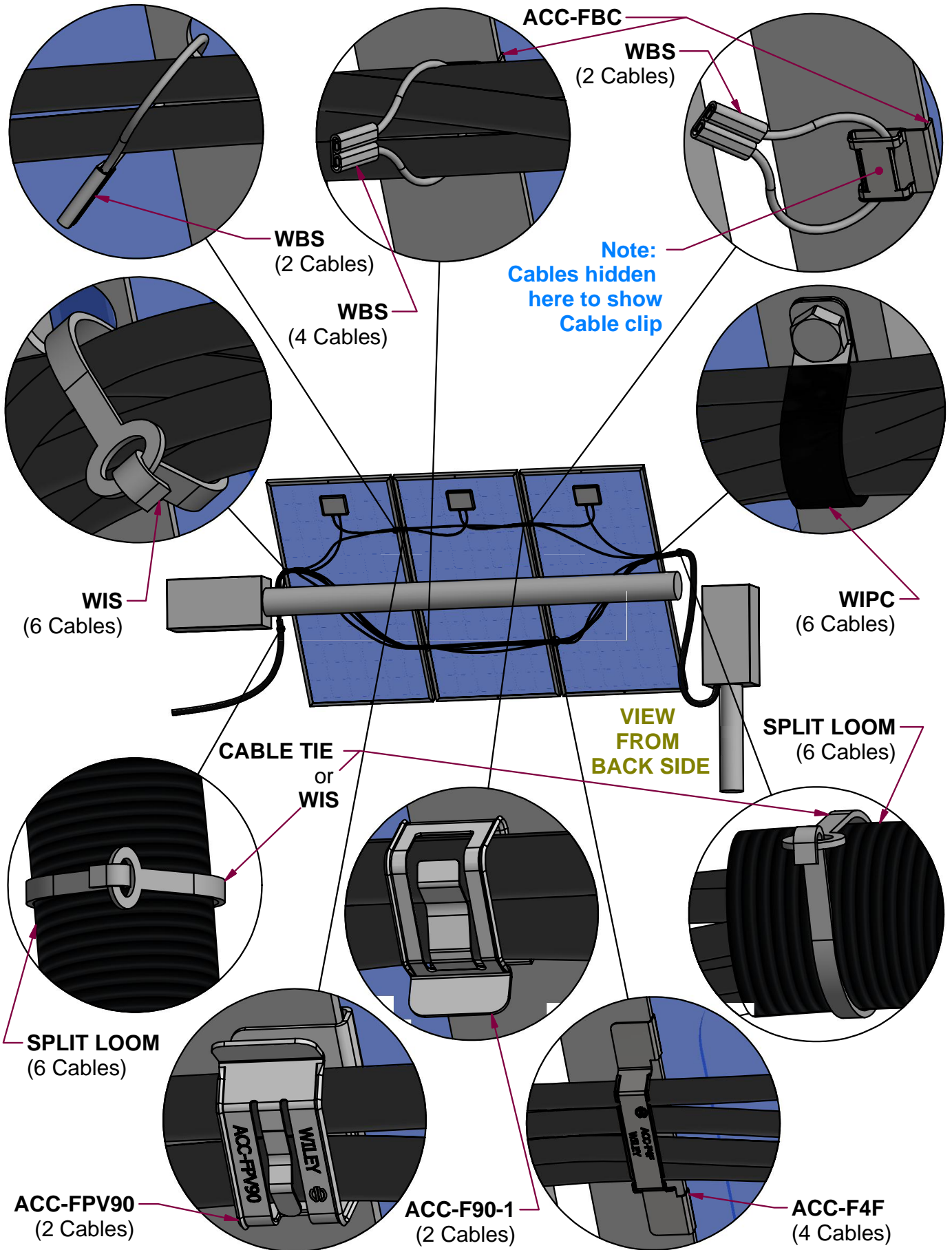

SYSTEM OVERVIEW

WIRE MANAGEMENT PRODUCTS - FEATURES

UTILITY SCALE SOLAR - TRACKER - PORTRAIT-2

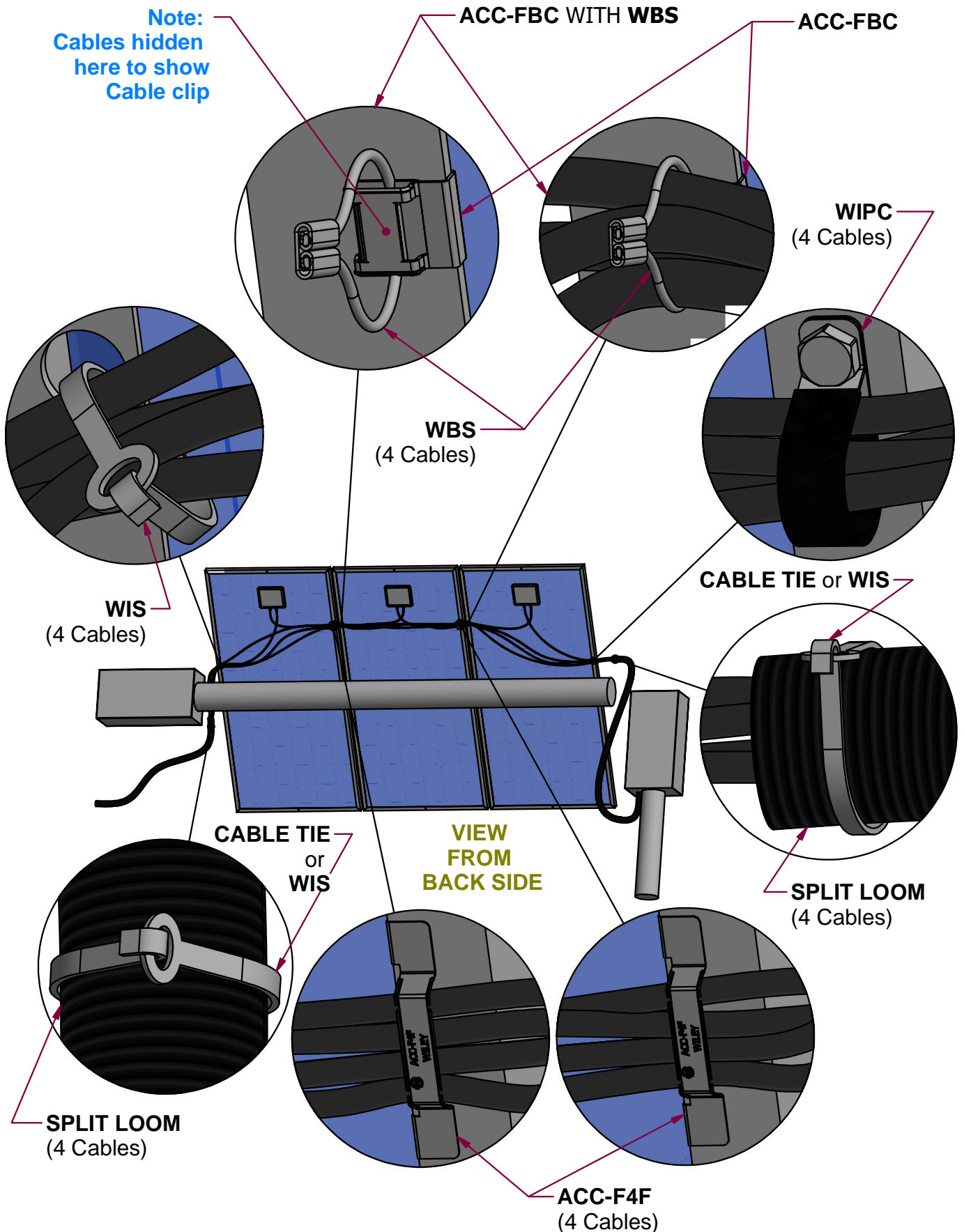

SYSTEM OVERVIEW

WIRE MANAGEMENT PRODUCTS - FEATURES

UTILITY SCALE SOLAR - FIXED TILT - LANDSCAPE

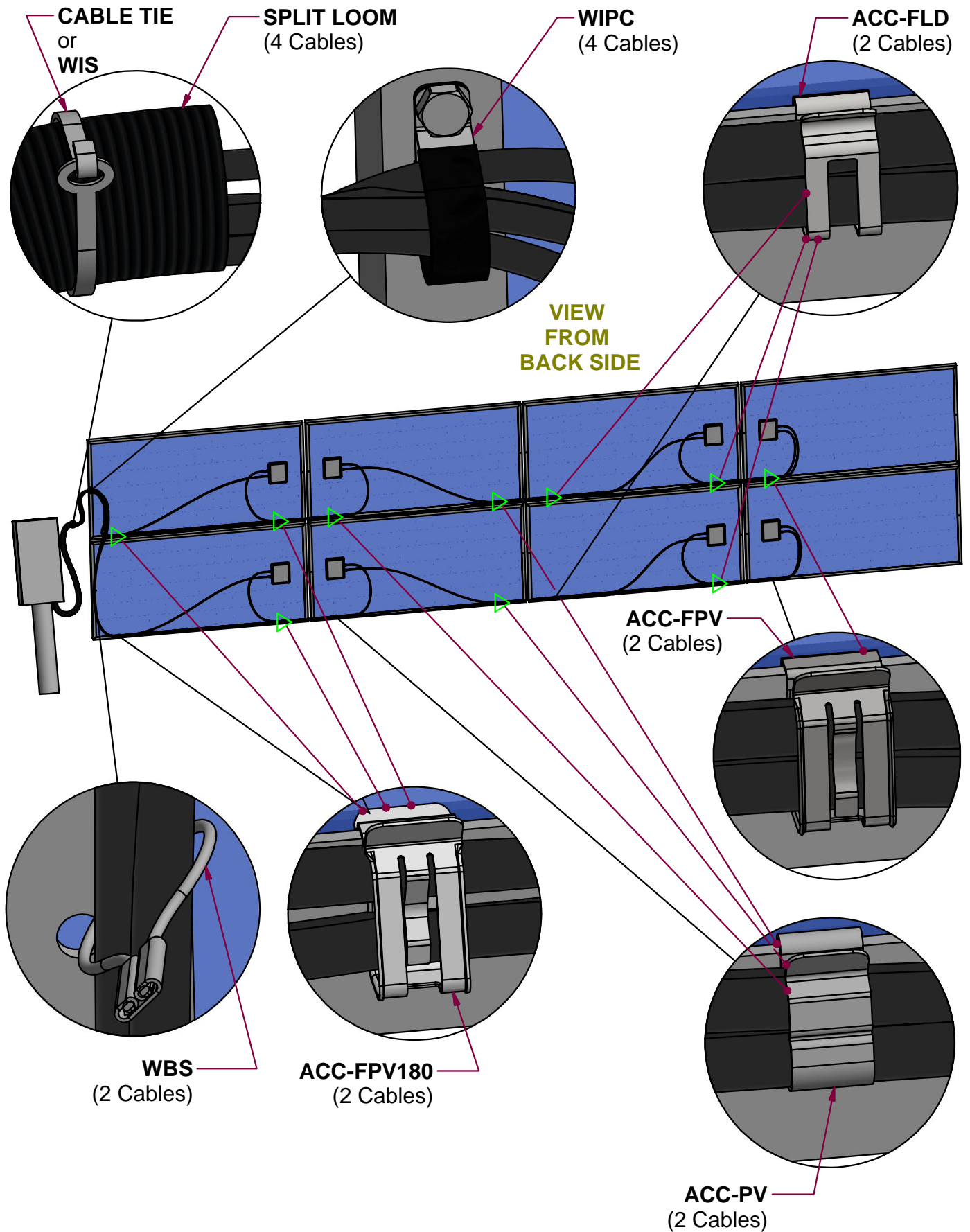

SYSTEM OVERVIEW

WIRE MANAGEMENT PRODUCTS - FEATURES

UTILITY SCALE SOLAR - FIXED TILT - PORTRAIT

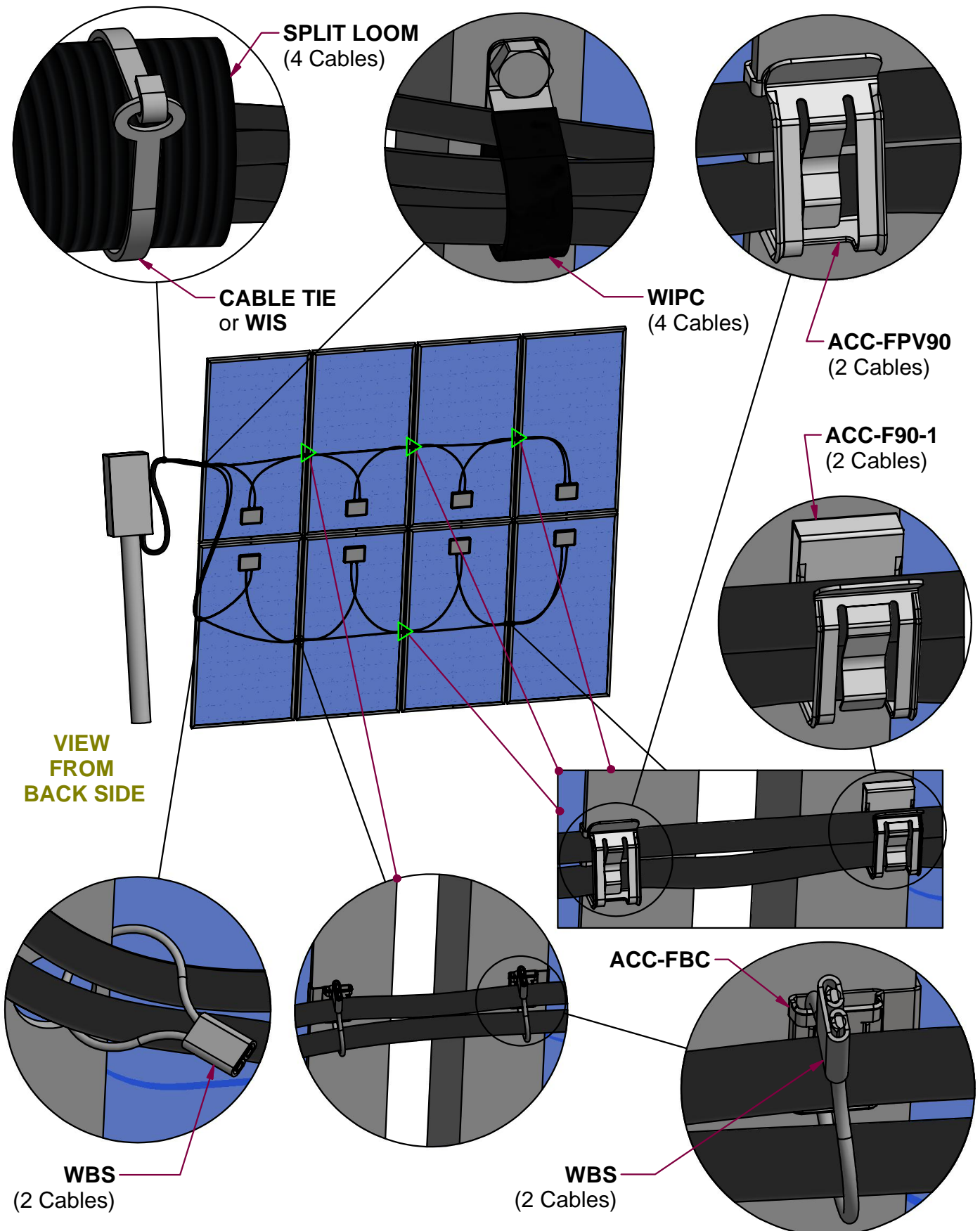

WIRE MANAGEMENT LAYOUTS

VIEWS FROM FRONT SIDE

LAYOUT-1 (TRACKER - PORTRAIT-1)

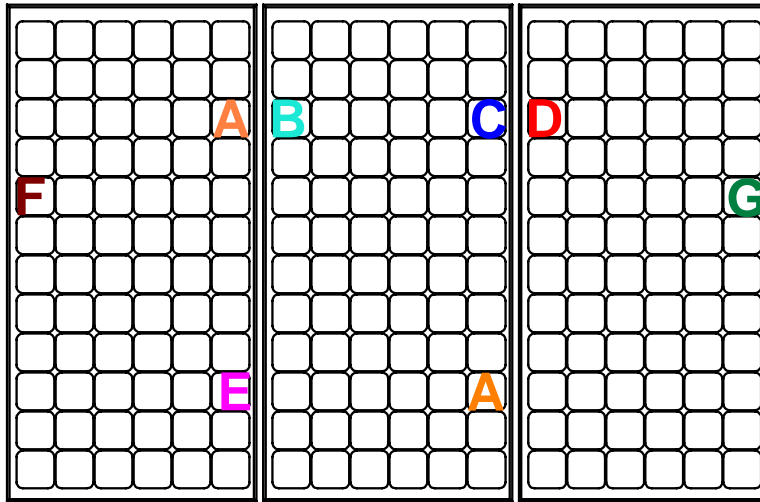

A DENOTES PLACES TO INSTALL **ACC-FBC** WITH **WBS**

B DENOTES PLACE TO INSTALL **ACC-F90-1**

C DENOTES PLACE TO INSTALL **ACC-FPV90**

D DENOTES PLACE TO INSTALL **WBS**

E DENOTES PLACE TO INSTALL **ACC-F4F**

F DENOTES PLACE TO INSTALL **WIPC**

G DENOTES PLACE TO INSTALL **WIS**

LAYOUT-2 (TRACKER - PORTRAIT-2)

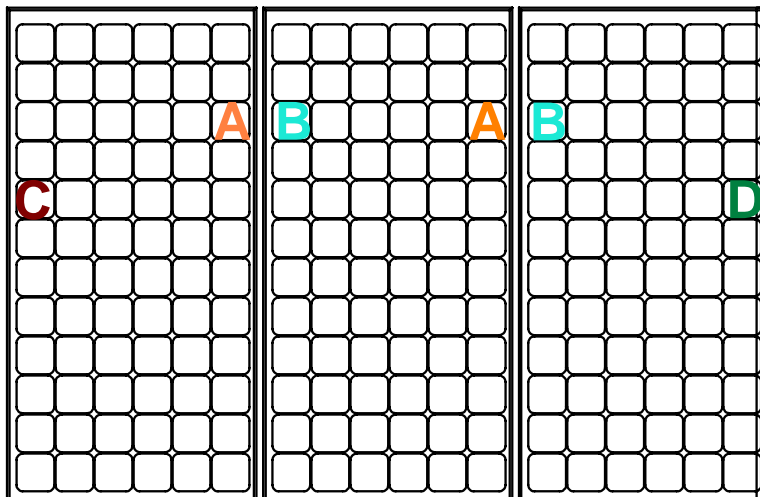

A DENOTES PLACES TO INSTALL **ACC-FBC** WITH **WBS**

B DENOTES PLACE TO INSTALL **ACC-F4F**

C DENOTES PLACE TO INSTALL **WIPC**

D DENOTES PLACE TO INSTALL **WIS**

WIRE MANAGEMENT LAYOUTS

VIEWS FROM FRONT SIDE

LAYOUT-3 (FIXED TILT - LANDSCAPE)

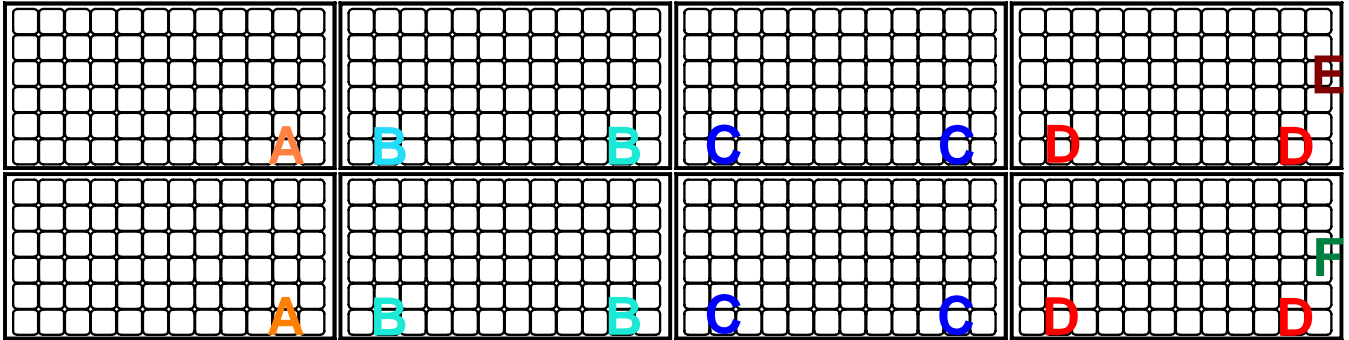

- A DENOTES PLACES TO INSTALL ACC-FPV
- B DENOTES PLACES TO INSTALL ACC-FLD
- C DENOTES PLACES TO INSTALL ACC-PV
- D DENOTES PLACES TO INSTALL ACC-FPV180
- E DENOTES PLACE TO INSTALL WIPC
- F DENOTES PLACE TO INSTALL WIS / WBS

LAYOUT-4 (FIXED TILT - PORTRAIT)

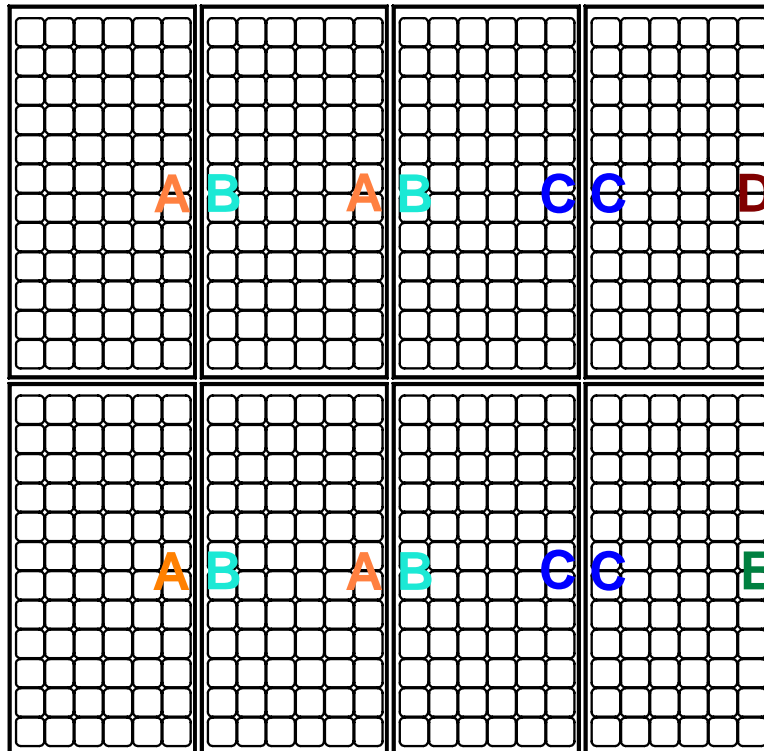

Customer Service Department
 7 Aviation Park Drive
 Londonderry, NH 03053
 1-800-346-4175
 1-603-647-5299 (International)

- A DENOTES PLACES TO INSTALL ACC-F90-1
- B DENOTES PLACES TO INSTALL ACC-FPV90
- C DENOTES PLACES TO INSTALL ACC-FBC WITH WBS
- D DENOTES PLACE TO INSTALL WIPC
- E DENOTES PLACE TO INSTALL WIS / WBS