



Washer, Electrical Equipment Bond

WEEB

INSTALLATION INSTRUCTIONS *For TerraSmart TERRAFARM only* Please read carefully before installing.

Burndy LLC. recommends that the sufficient details of the installation be submitted to the AHJ for approval before any work is started.

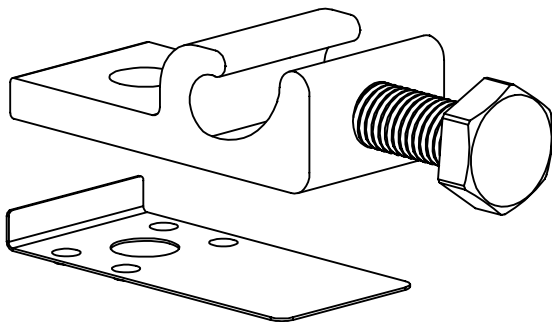

WEEBLug-6.7

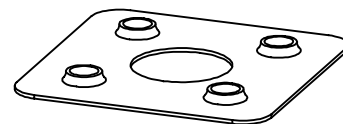

WEEB-UIR

Products are tested to UL 467, CAN/CSA-C22.2 No. 41
US/Canadian standards for safety grounding and bonding equipment



3098177

WEEB COMPATIBILITY

The WEEB family of products can be used to bond anodized aluminum, galvanized steel, steel and other electrically conductive metal structures. All installations shall be in accordance with NEC requirements in the USA and with CSA C22.1 in Canada. The WEEBs are for use with modules that have a maximum series fuse rating of less than 25A.

Bottom Mounting Modules

The WEEBs used for bonding the PV modules to the mounting rails are compatible with various cross-sections of module frames. The following is an example of a module frame that is compatible. Notice that the WEEB teeth are positioned completely under the edge of the module frame.

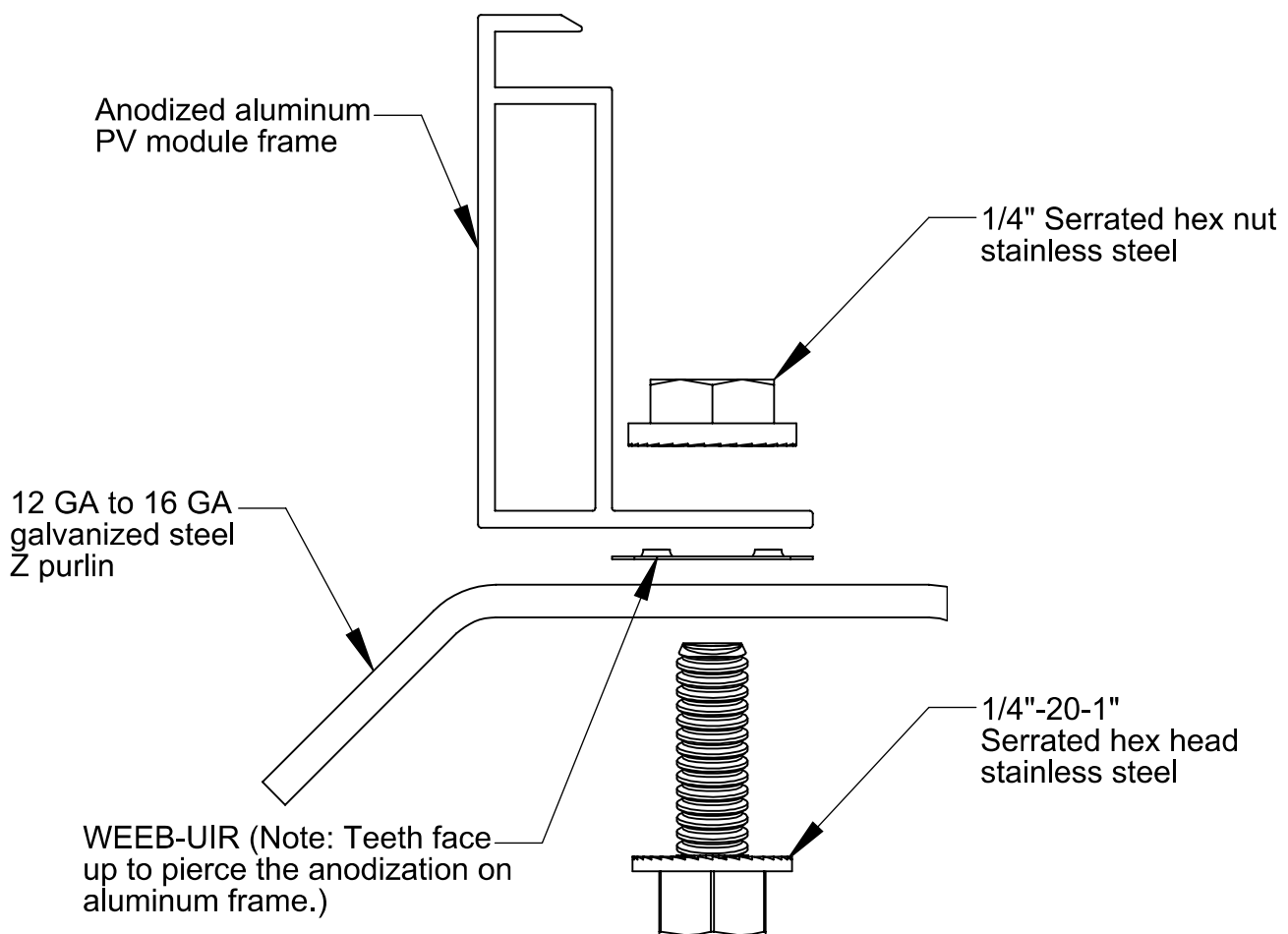

Important Note:

Inspect each module frame used with a WEEB to ensure that the bottom mounting face of the frame is flat, and that there are no hinderances to embedding WEEB teeth. Do not use a module with a frame that prevents the WEEB teeth from embedding fully.

Alternate Configuration

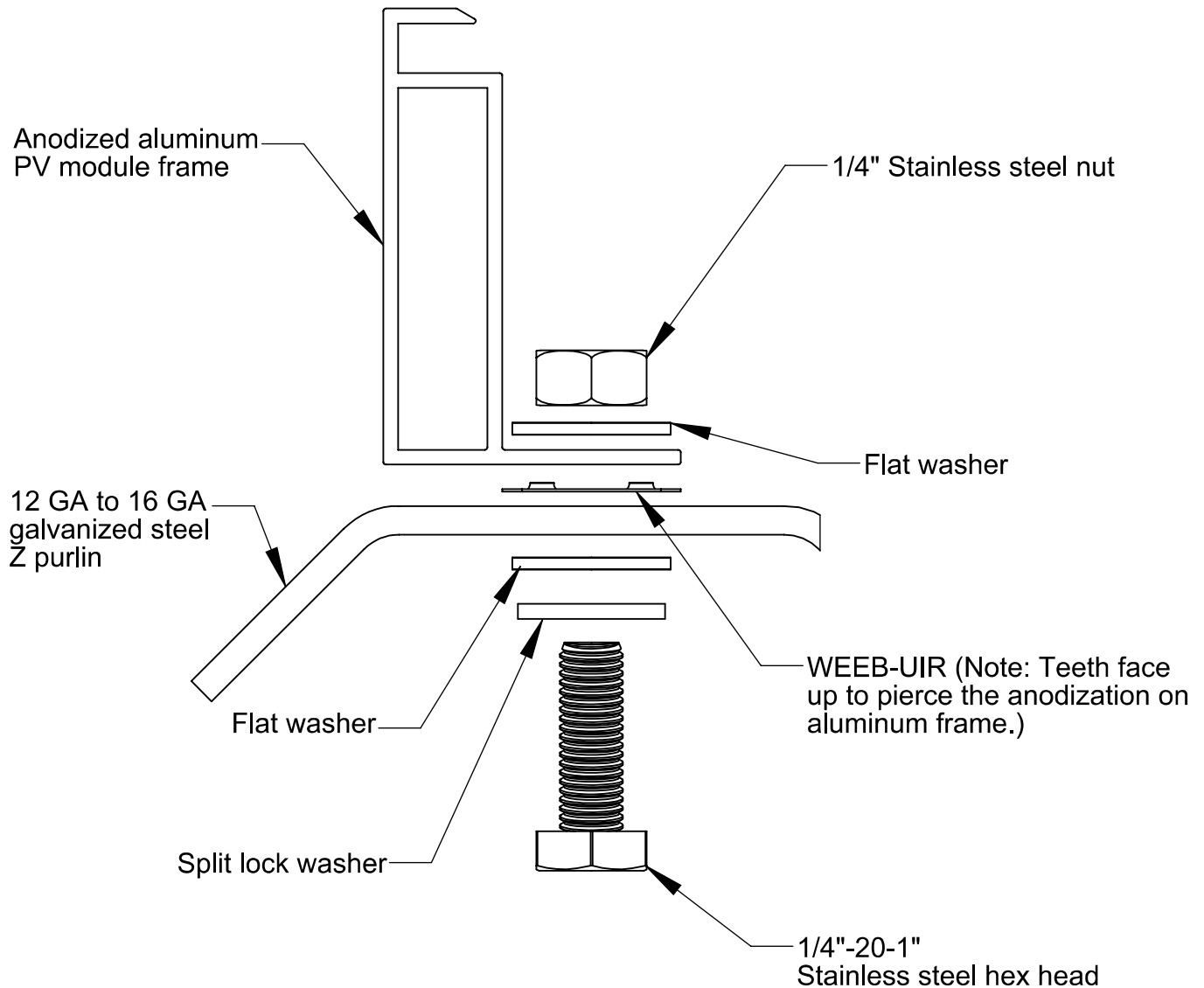

SYSTEM OVERVIEW

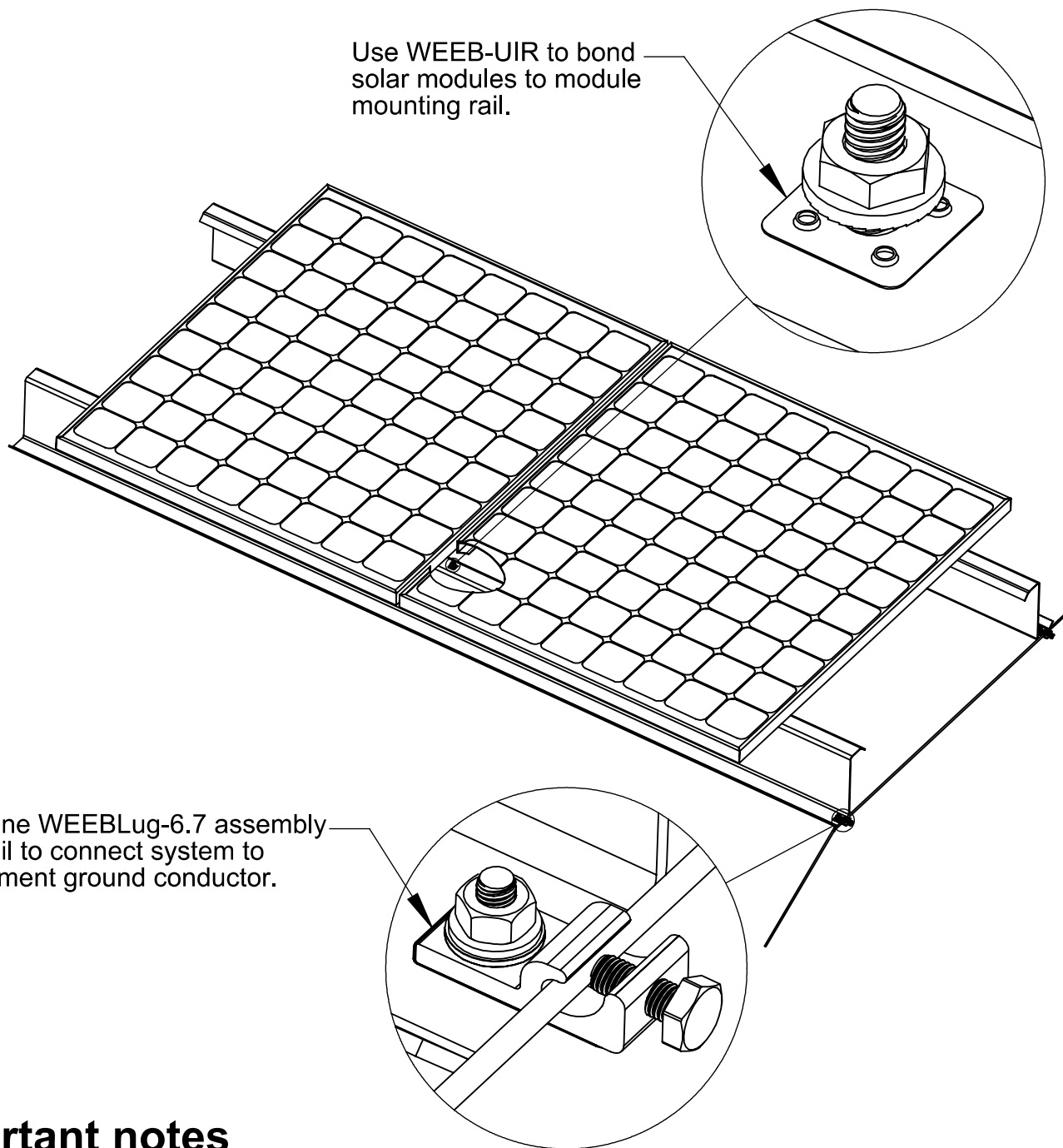

Important notes

1. Use general purpose anti-seize compound on fastener threads when installing WEEBs.
2. The NEC section 690.43 states, "Exposed non-current carrying metal parts of module frames, equipment, and conductor enclosures shall be grounded in accordance with 250.134 or 250.136(A) regardless of voltage."
3. WEEBs are intended for **SINGLE USE ONLY**. Functionality will not be guaranteed if reused.

WEEB-UIR ASSEMBLY

①

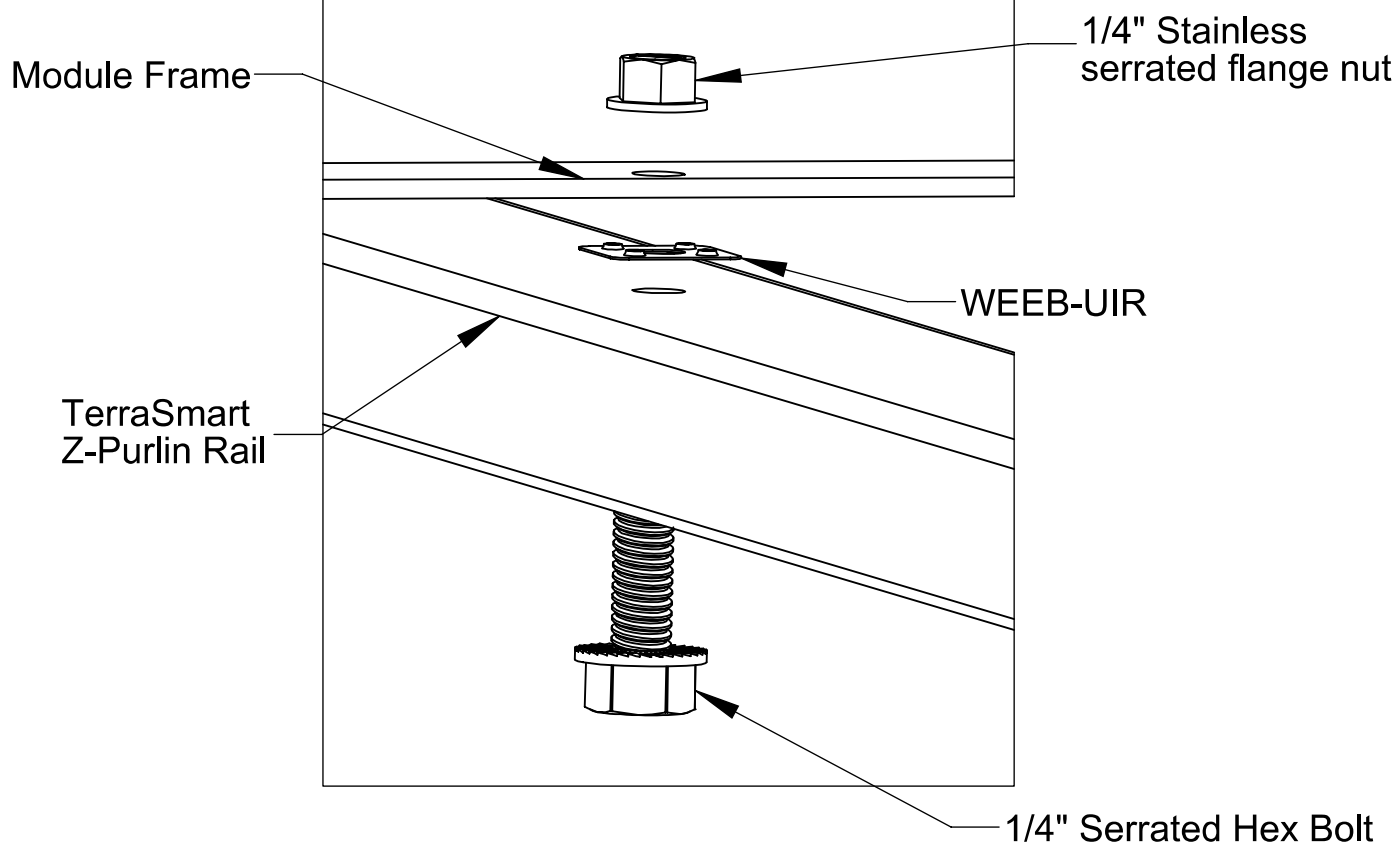

②

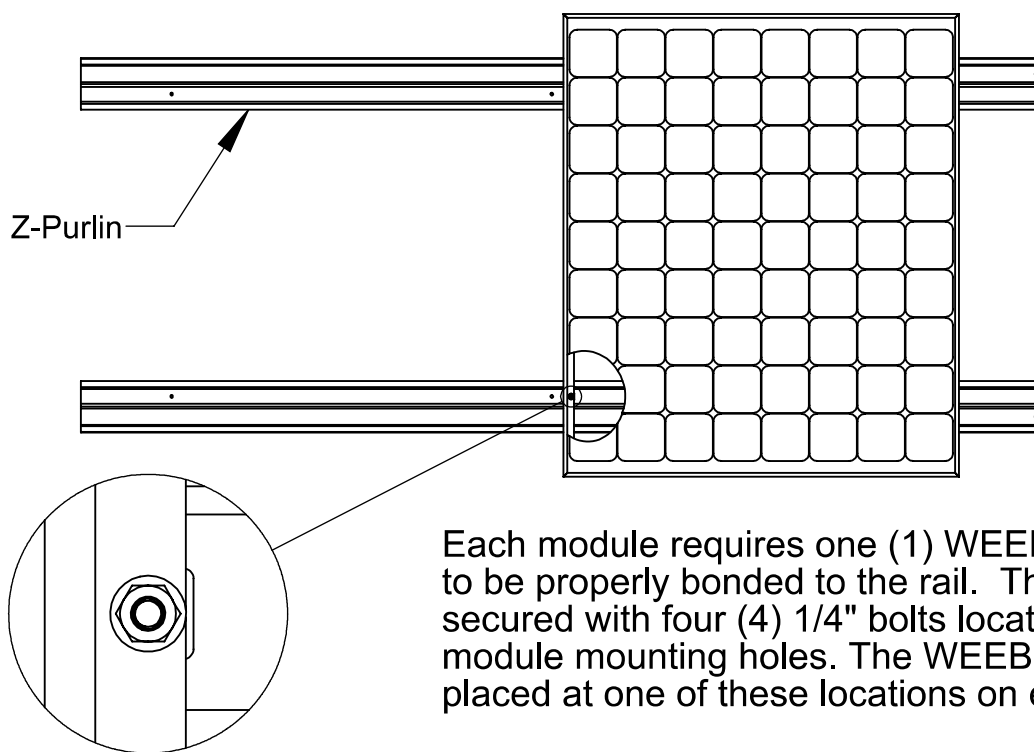

Each module requires one (1) WEEB-UIR in order to be properly bonded to the rail. The modules are secured with four (4) 1/4" bolts located at the module mounting holes. The WEEB-UIR must be placed at one of these locations on each module.

WEEB-UIR ASSEMBLY

3

The WEEB-UIR must be underneath the module frame and on top of the TerraSmart Z-Purlin.

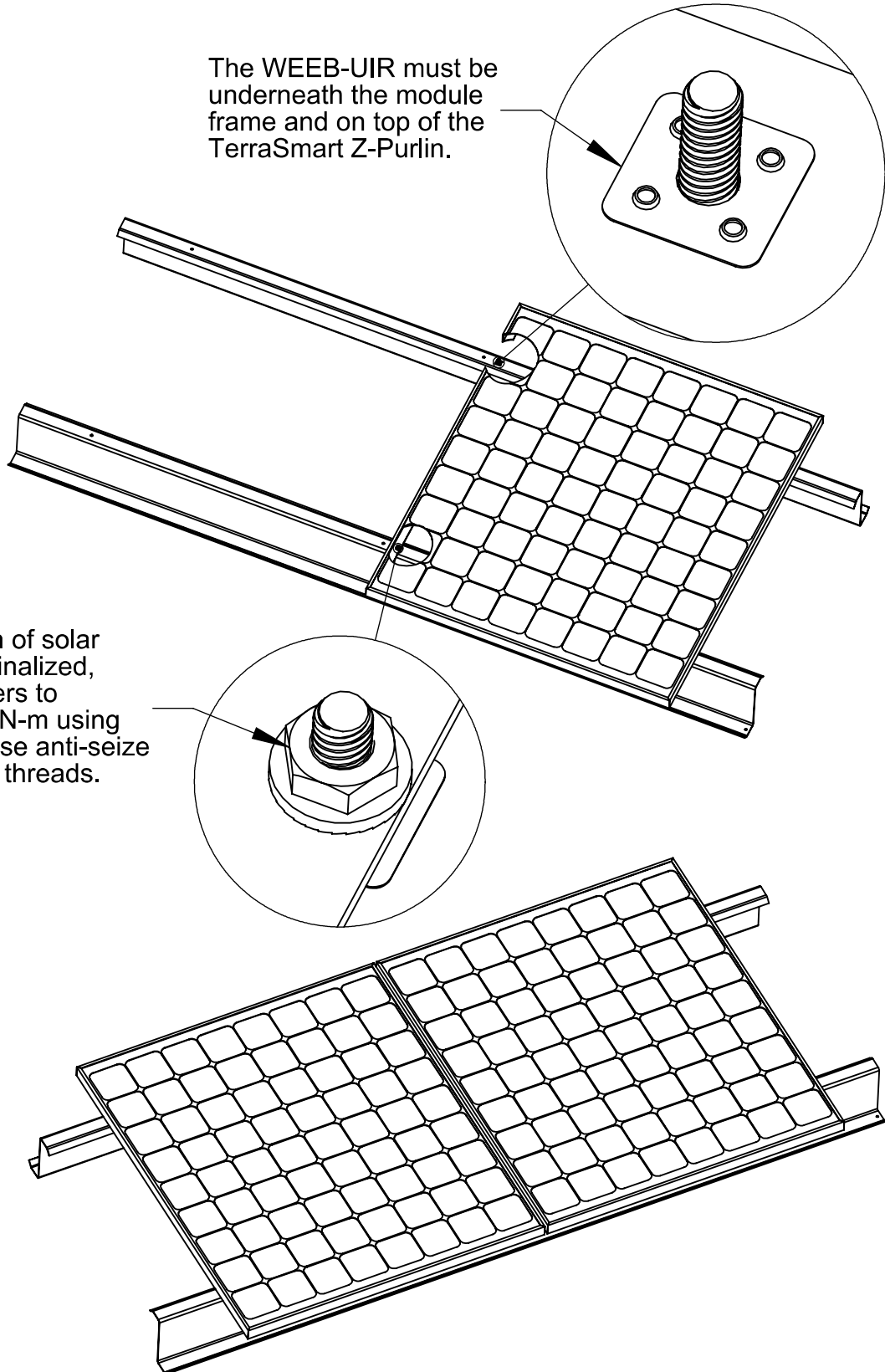

Important note:

WEEBs are for SINGLE USE ONLY! Do not torque fasteners down if position of solar modules is not finalized. Only slightly tighten fasteners to keep modules in place.

WEEB-UIR LAYOUT

When using galvanized Z purlins and PV modules with round mounting holes.

④

EVEN NUMBER OF MODULES IN ROW

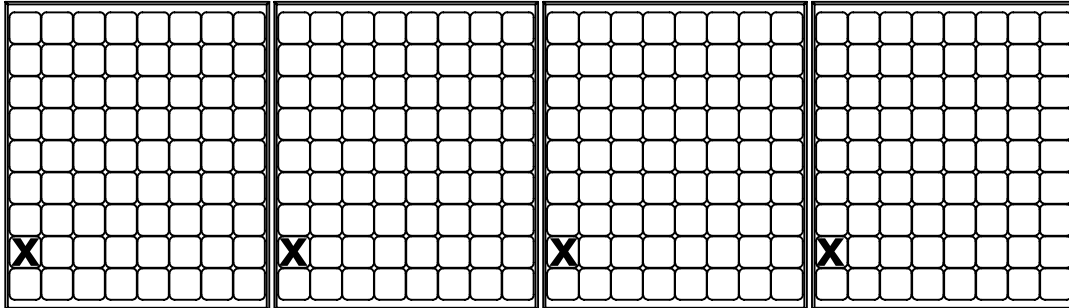

X DENOTES PLACES TO INSTALL WEEB-UIR

$$C \times R = 4 \times 1$$

$$\text{WEEB-UIR NEEDED} = C \times R = 4 \times 1 = 4$$

ODD NUMBER OF MODULES IN ROW

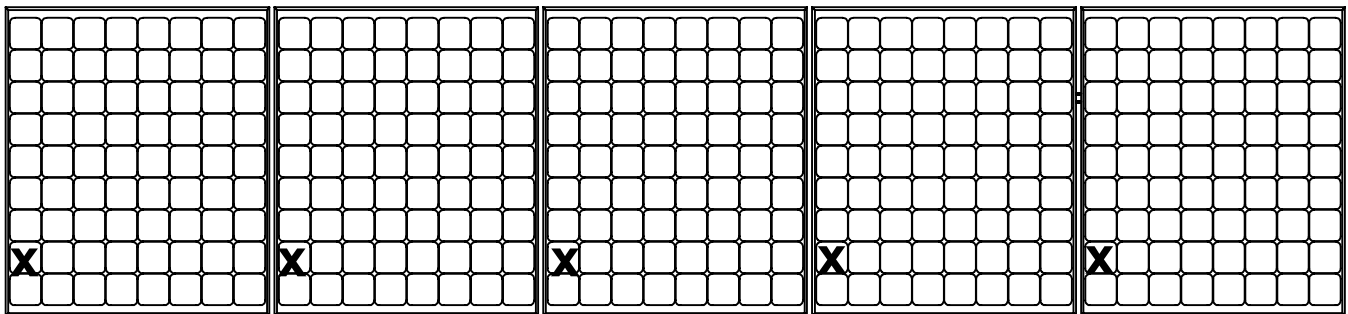

X DENOTES PLACES TO INSTALL WEEB-UIR

$$C \times R = 5 \times 1$$

$$\text{WEEB-UIR NEEDED} = [C+1] \times R = [5+1] \times 1 = 5$$

Note:

Please follow racking and module manufacturer's recommendations to maintain the ground path from rails to modules that are being removed for maintenance.

WEEB-UIR LAYOUT

When using galvanized Z purlins and PV modules with slotted mounting holes.

5

EVEN NUMBER OF MODULES IN ROW

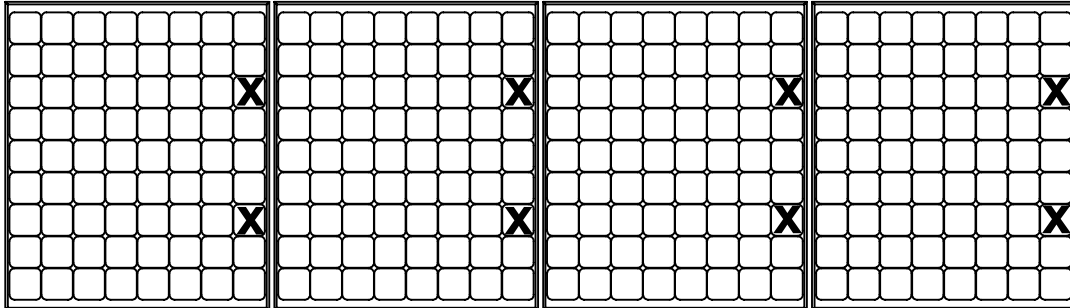

X DENOTES PLACES TO INSTALL WEEB-UIR

$$C \times R = 8 \times 1$$

$$\text{WEEB-UIR NEEDED} = C \times R = 8 \times 1 = 8$$

ODD NUMBER OF MODULES IN ROW

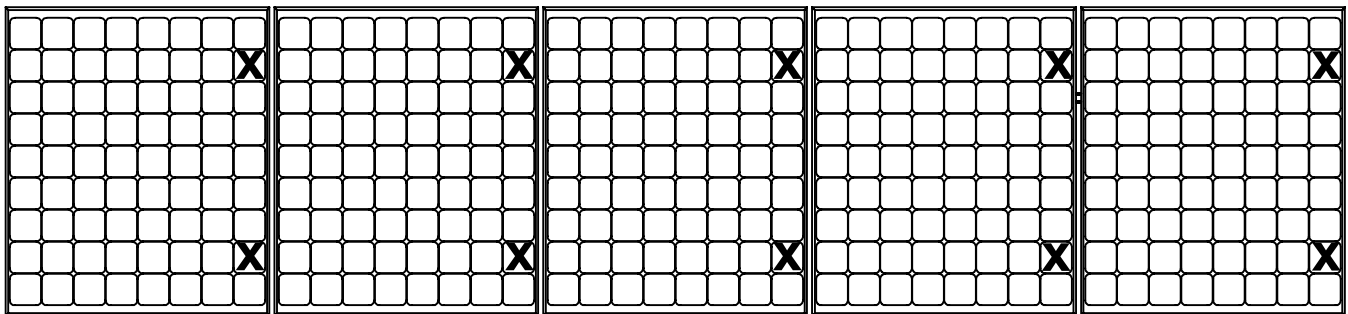

X DENOTES PLACES TO INSTALL WEEB-UIR

$$C \times R = 10 \times 1$$

$$\text{WEEB-UIR NEEDED} = [C+1] \times R = [10+1] \times 1 = 10$$

Note:

Please follow racking and module manufacturer's recommendations to maintain the ground path from rails to modules that are being removed for maintenance.

WEEBLUG ASSEMBLY

6

Assemble WEEBLug-6.7 assembly and torque fasteners to 10ft-lb / 13.5 N-m using general purpose anti-seize compound on threads.

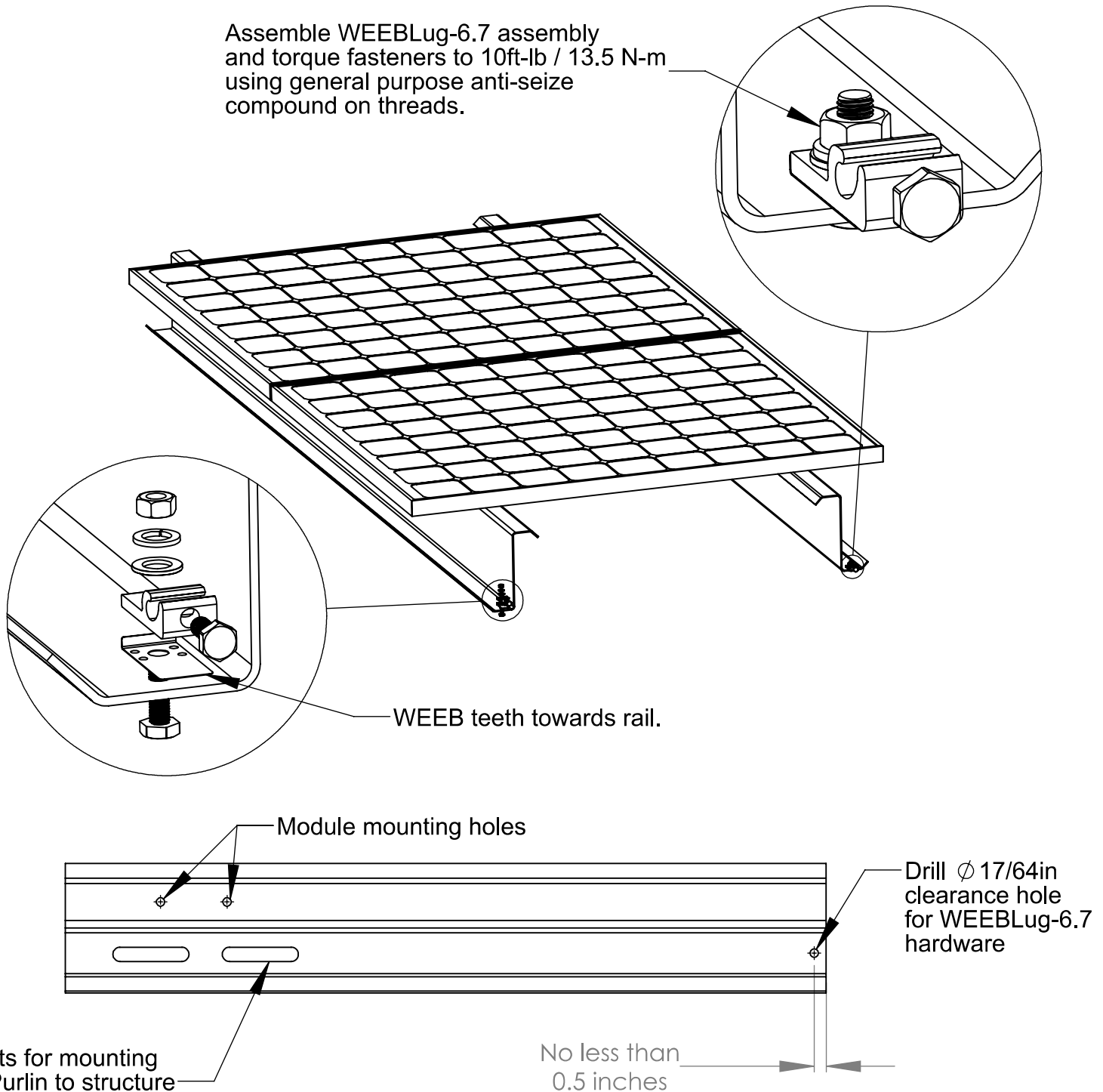

Important note:

1. The location of the WEEBLug is the same regardless of module orientation.
2. WEEB-6.7 that sits under the WEEBLug is for **SINGLE USE ONLY**. Ensure position is correct before tightening down.
3. The WEEBLug-6.7 may be used with a maximum equipment ground wire of 6 AWG.

WEEB Lug 6.7 Locations

7

Install WEEBLug 6.7's at the following marked locations. Lug position is the same in both portrait and landscape configurations.

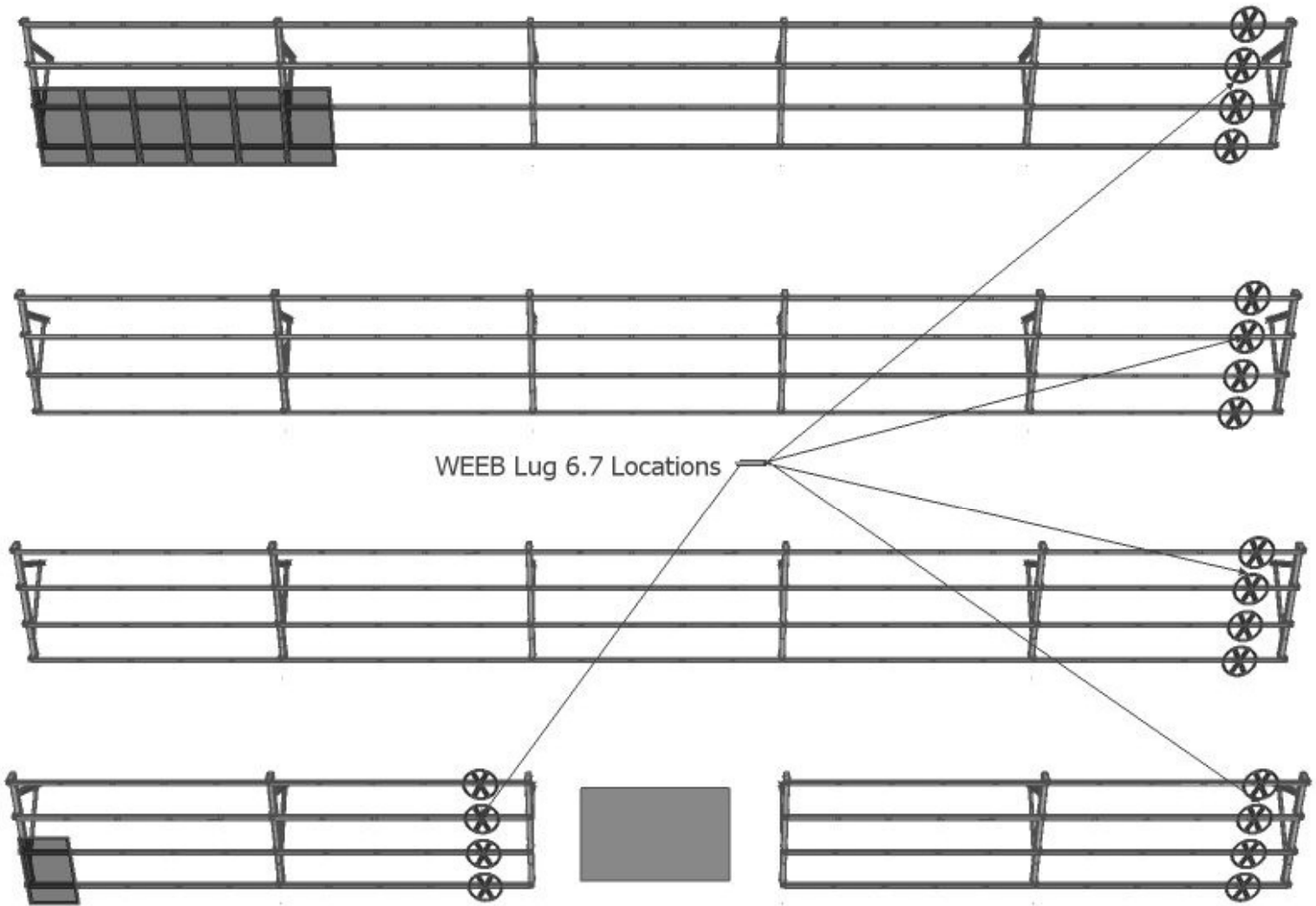

GROUND CONDUCTOR ASSEMBLY

8

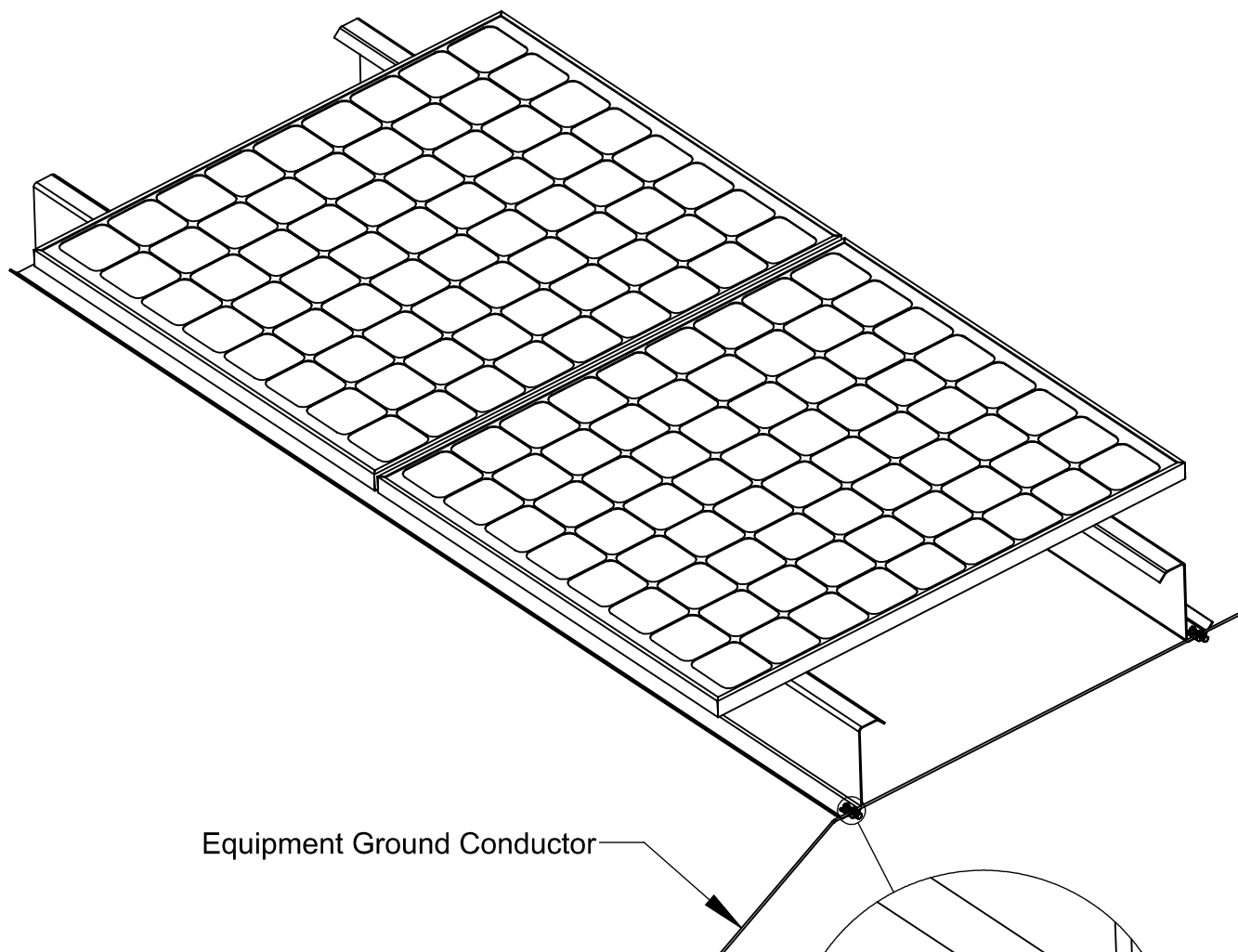

Equipment Ground Conductor

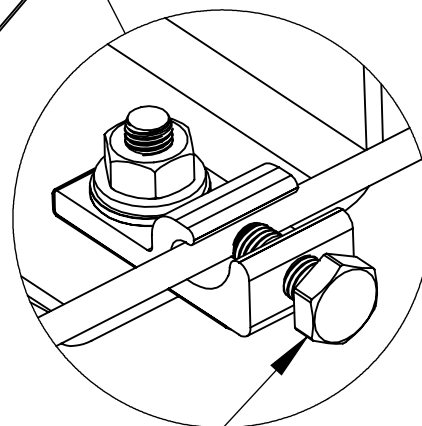

Lay in equipment ground conductor
and tighten bolt to 7 ft-lb / 10 N-m.

Customer Service Department

7 Aviation Park Drive
Londonderry, NH 03053

1-800-346-4175

1-603-647-5299 (International)

Document Number 104-0404-000080-005

© 2012 BURNDY LLC.

Page 11 of 11