



Washer, Electrical Equipment Bond

WEEB

INSTALLATION INSTRUCTIONS

For AET T6 Pitched

Roof Mount only

Please read carefully before installing.

BURNDY LLC recommends that the sufficient details of the installation be submitted to the AHJ for approval before any work is started.

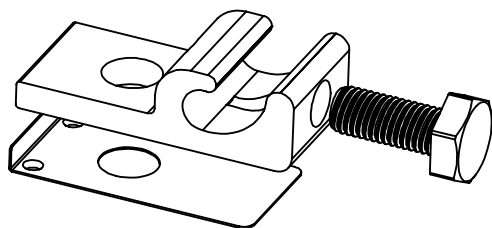

WEEBLug-15.8 assembly

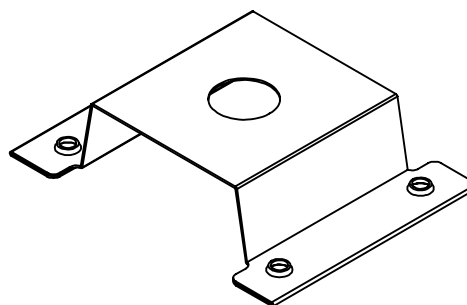

WEEB-ATF

Products are tested to UL 467, CAN/CSA-C22.2 No. 41
US/Canadian standards for safety grounding and bonding equipment



3098177

WEEB COMPATIBILITY

The WEEB family of products can be used to bond anodized aluminum, galvanized steel, steel and other electrically conductive metal structures. All installations shall be in accordance with NEC requirements in the USA and with CSA C22.1 in Canada. The WEEBs are for use with modules that have a maximum series fuse rating of less than 25A.

Standard Top Down Clamps

The WEEBs used for bonding the PV modules to the mounting rails are compatible with various cross-sections of module frames. The following are examples of module frames that are compatible. Notice that the WEEB teeth are positioned completely under the edge of the module frame.

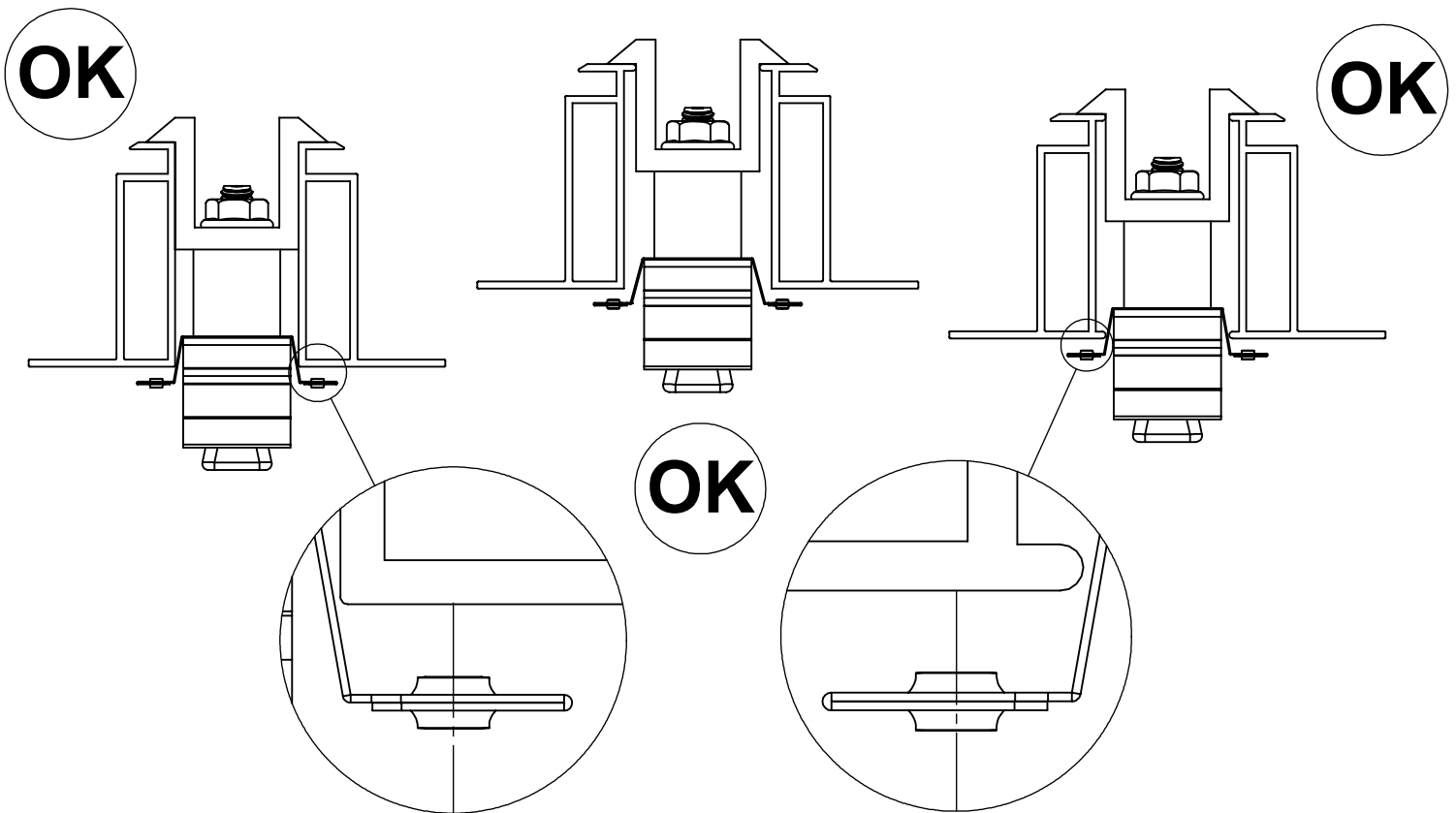

C-shaped module frames, like the one shown here, are incompatible with the WEEB-ATF

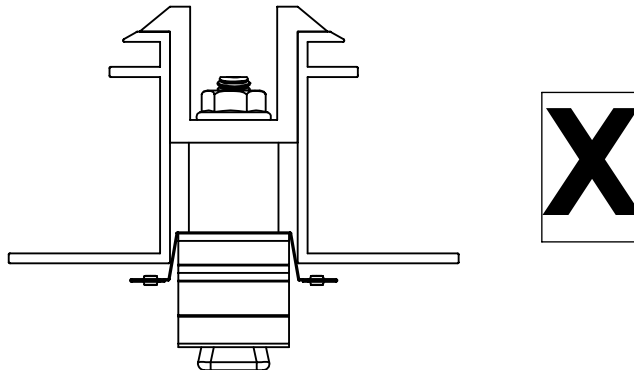

WEEB COMPATIBILITY

Module frames like those shown here may have a ridge or lip on the bottom edge of the frame that would prevent the WEEB teeth from fully embedding.

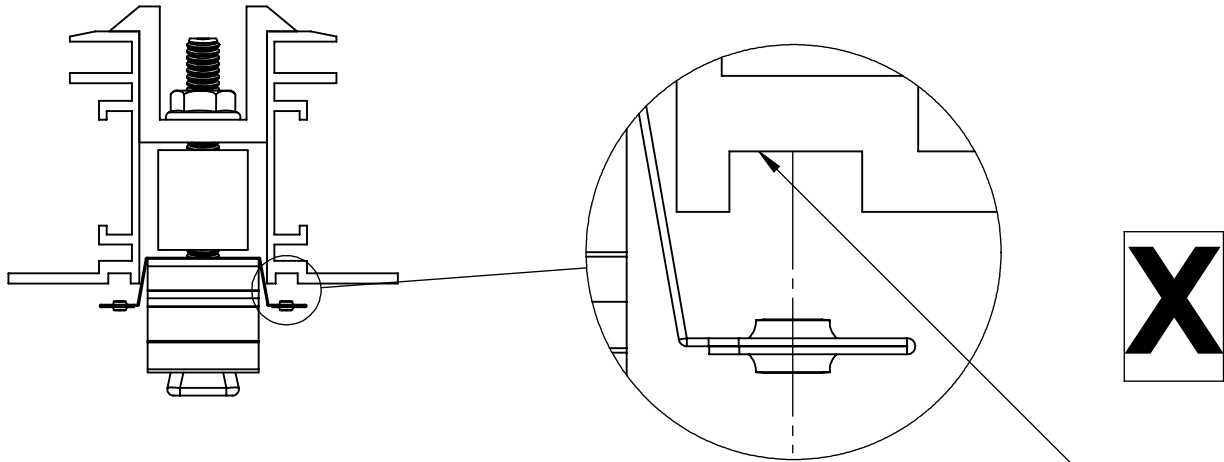

Shown here is an example of a groove that will prevent the WEEB teeth from properly penetrating the module frame. This type of frame is not compatible with the WEEB.

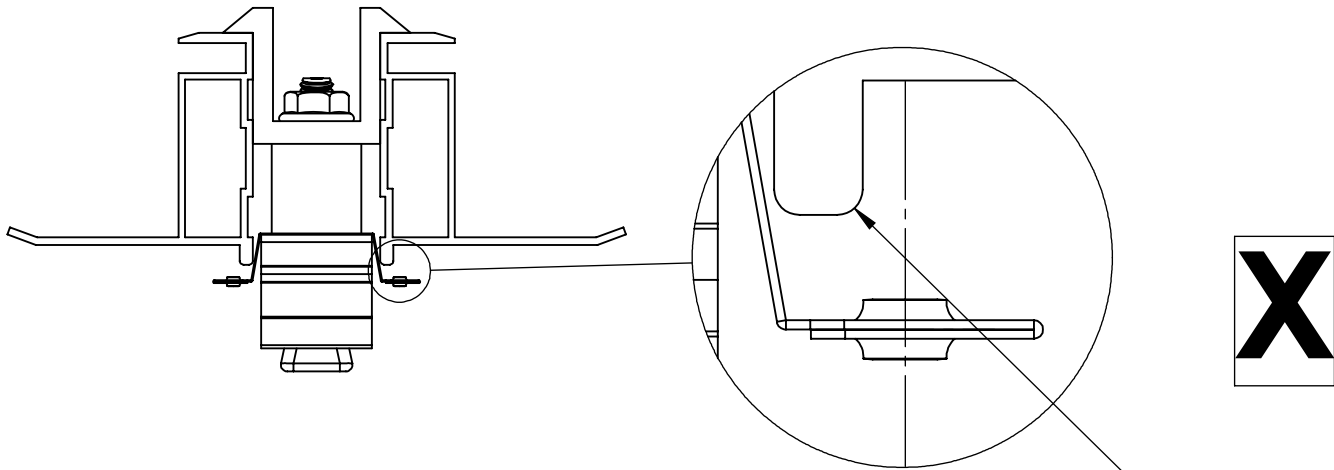

Shown here is an example of a lip that will prevent the WEEB teeth from properly penetrating the module frame. This type of frame is not compatible with the WEEB.

Important Note:

Inspect each module frame used with a WEEB to ensure that the bottom mounting face of the frame is flat, and that there are no hinderances to embedding WEEB teeth. Do not use a module with a frame that prevents the WEEB teeth from embedding fully.

WEEB-ATF on Boxed Module Frames

Certain module frames do not have enough structural strength to withstand the force required to embed a WEEB. These frames will deform and therefore not allow sufficient penetration of the WEEB teeth. The general requirements for minimum module frame thickness of "boxed" type module frames are illustrated below.

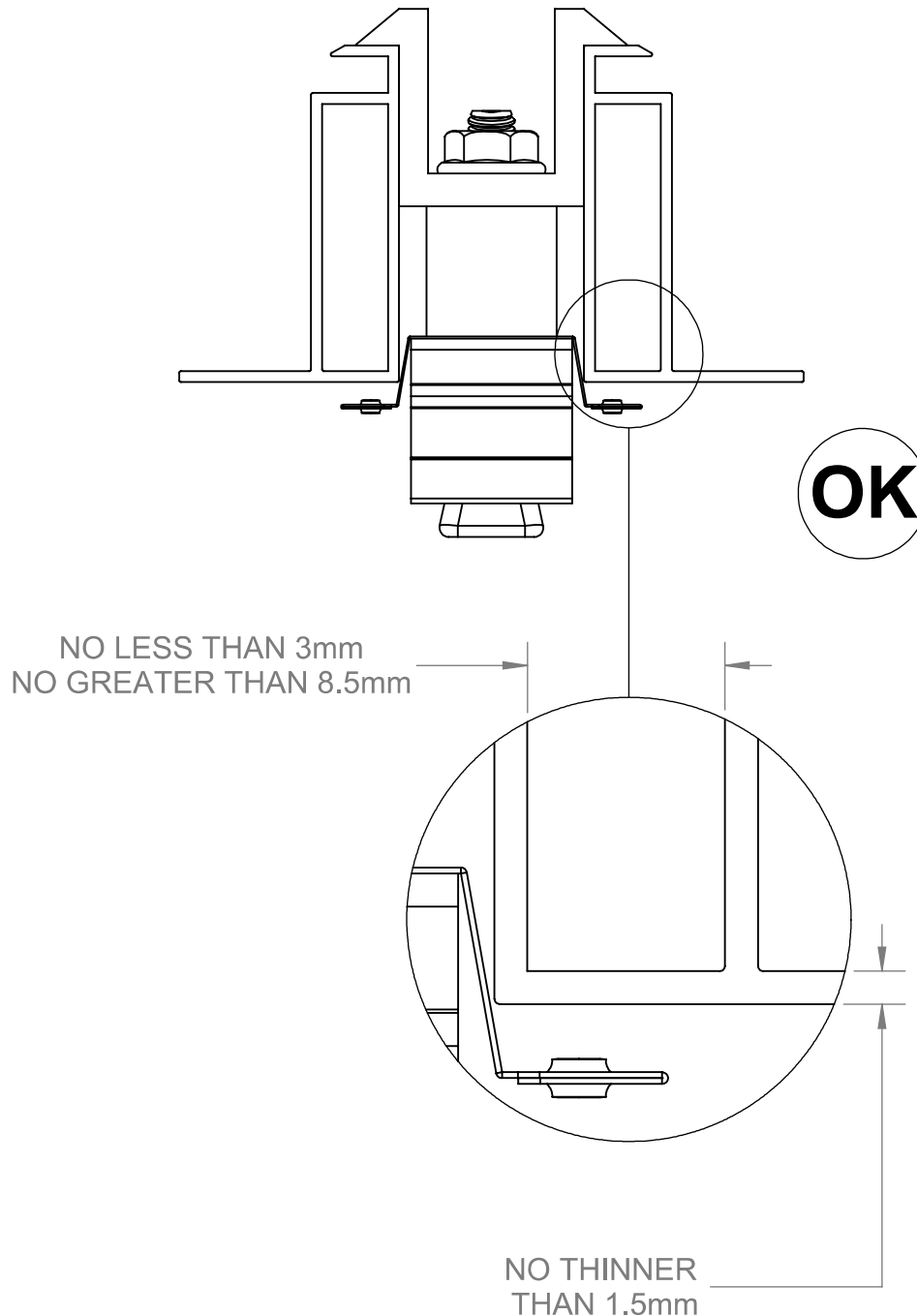

SYSTEM OVERVIEW

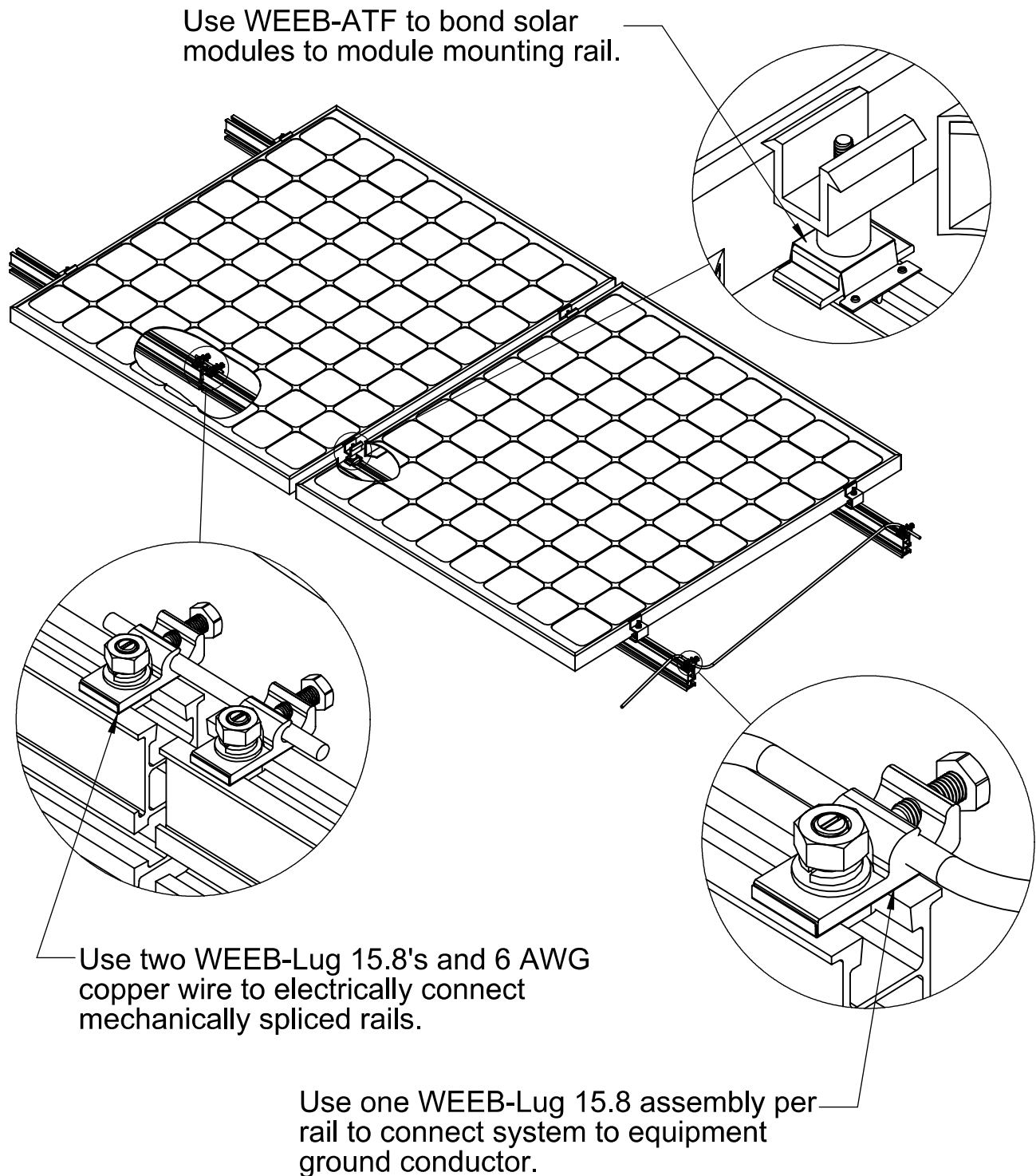

Important notes

1. Use general purpose anti-seize compound on fastener threads when installing WEEBs.
2. WEEBs are intended for **SINGLE USE ONLY**. Functionality will not be guaranteed if reused.

WEEB-ATF ASSEMBLY

①

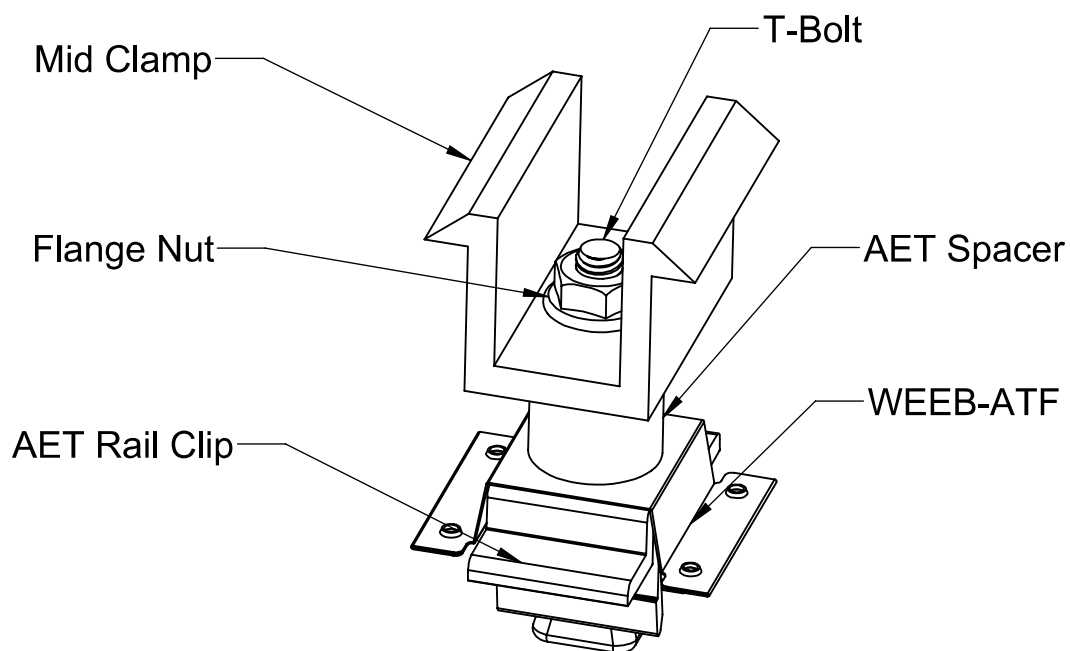

②

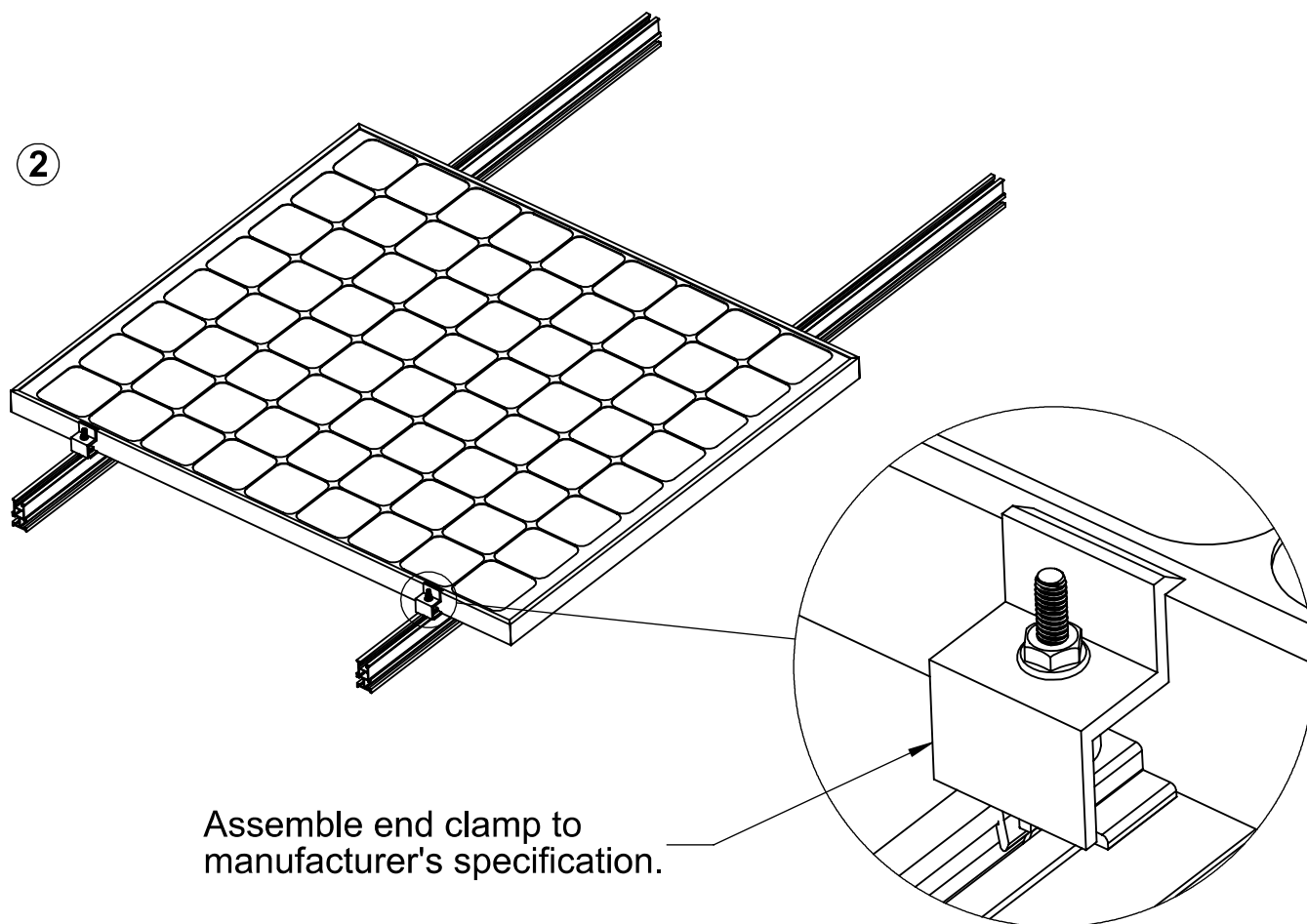

3

Slide pre-assembled
WEEB-ATF and mid clamp
assembly into position.

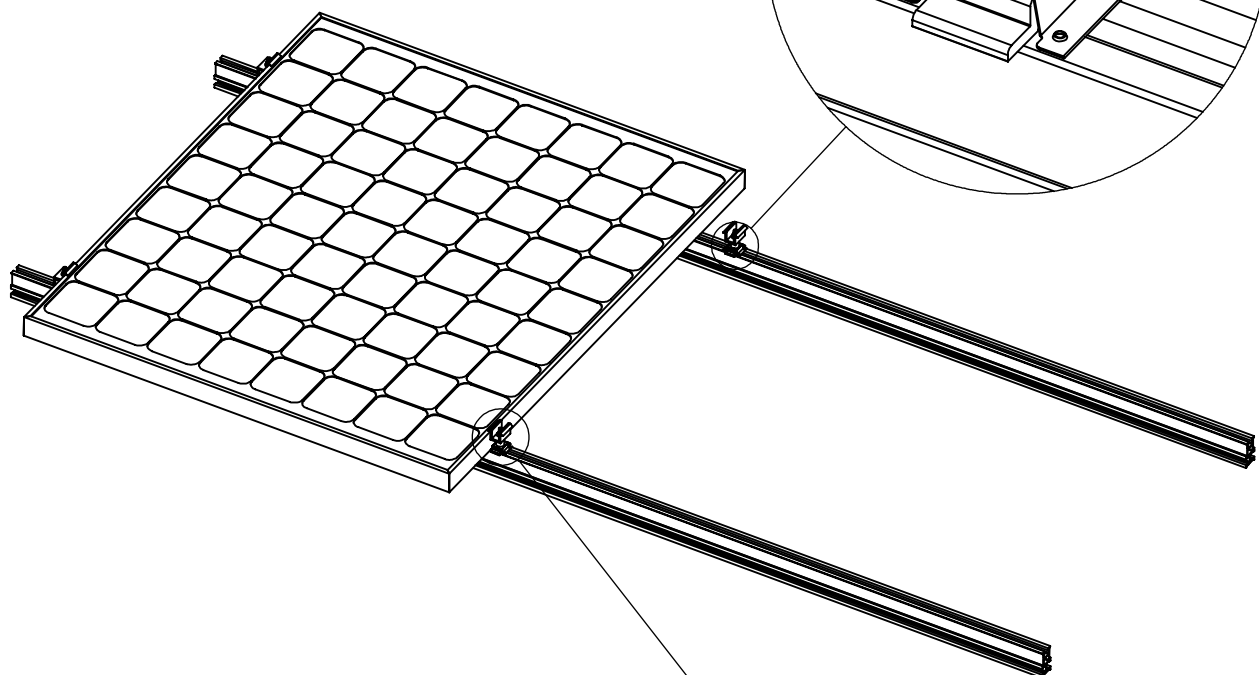

Slightly lift solar module and
slide WEEB-ATF and mid clamp
assembly into position.
WEEB teeth will automatically
be aligned under the edge of
the module when the mid clamp
assembly is correctly installed.

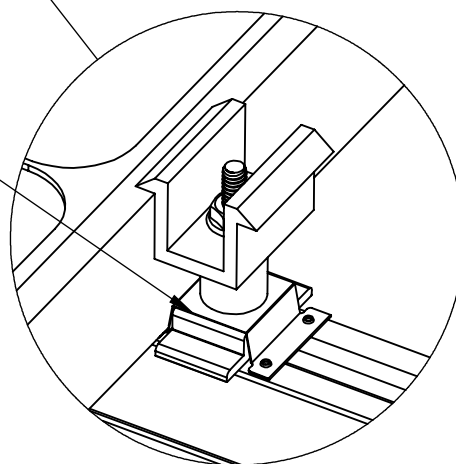

Important note:

To correctly install WEEB-ATF, ensure the modules fully cover the WEEB teeth. If the module frame does not fall flat on the teeth then the WEEB may not create a safe and proper bond. Check with module manufacturer for any additional installation requirements.

Important note:

WEEBs are for **SINGLE USE ONLY!** Do not torque fasteners down if position of solar modules is not finalized. Only slightly tighten fasteners to keep modules in place.

4

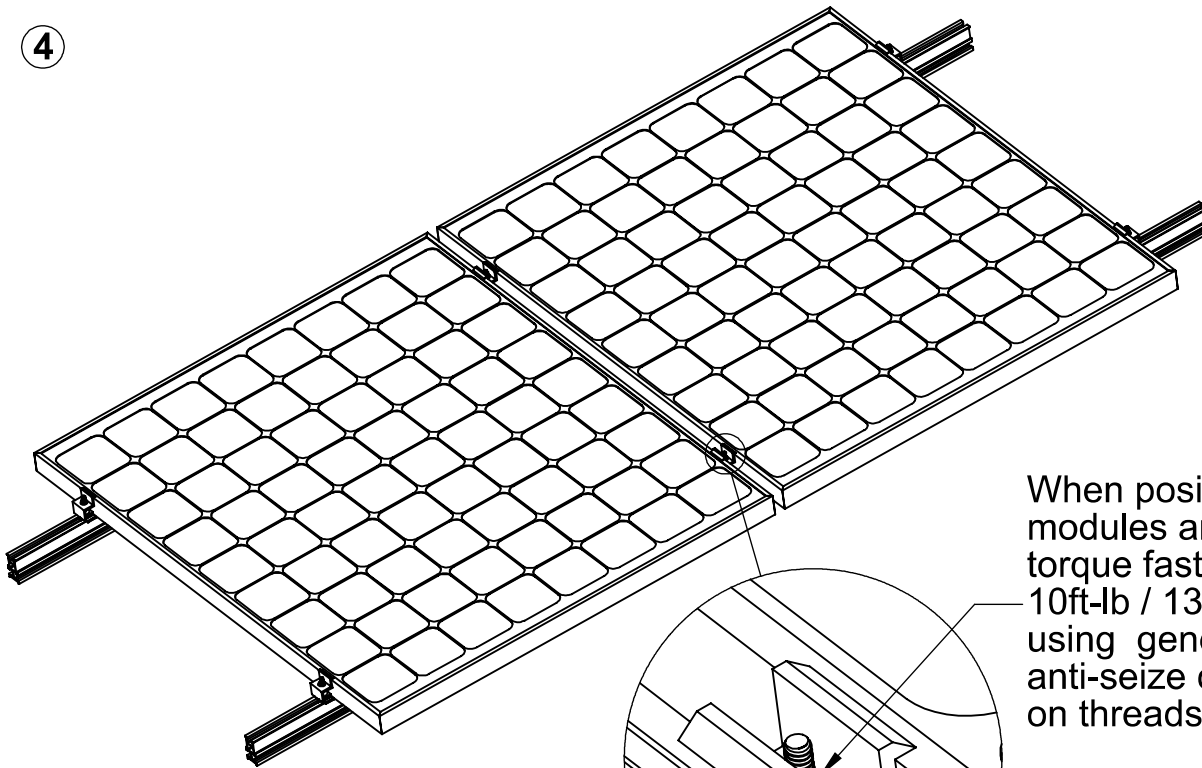

When position of solar modules are finalized, torque fasteners to 10ft-lb / 13.5 N-m using general purpose anti-seize compound on threads.

5

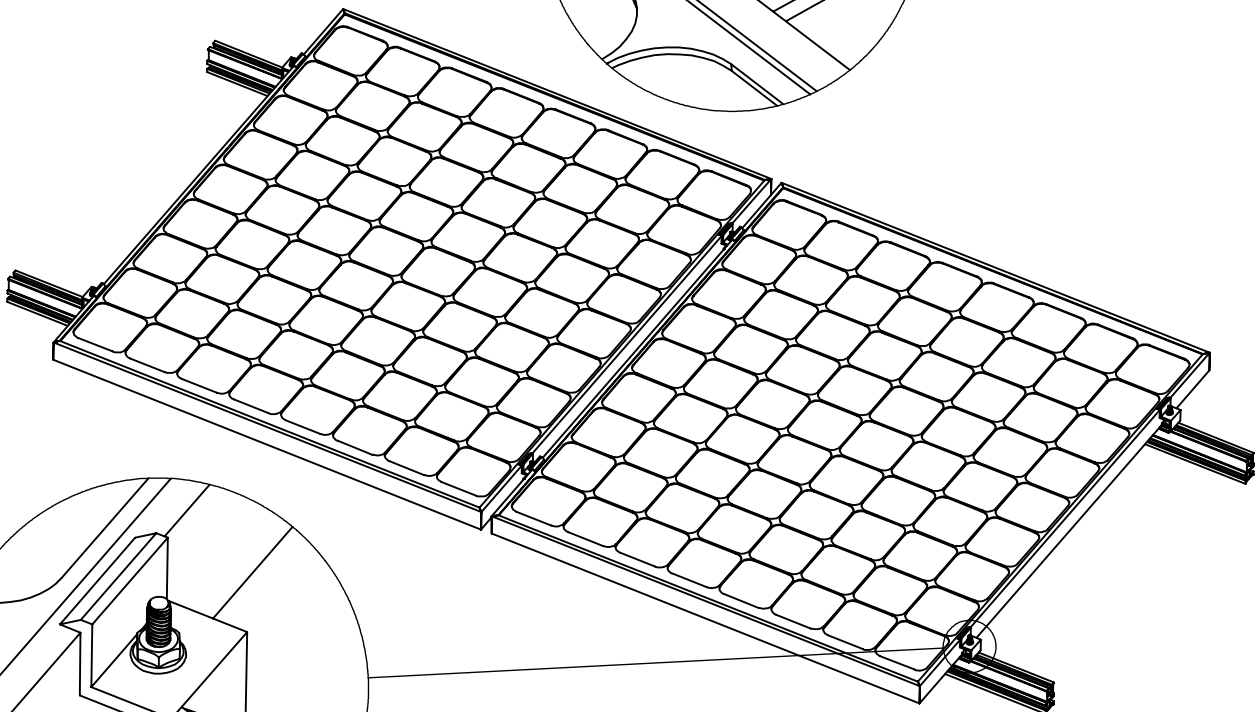

Assemble end clamp to manufacturer's specifications.

⑥

WEEB-ATF LAYOUT

EVEN NUMBER OF MODULES IN ROW

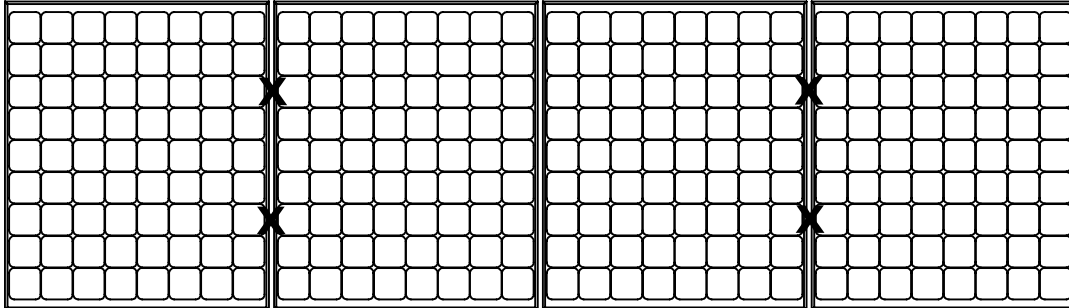

X DENOTES PLACES TO INSTALL WEEB-ATF

$$C \times R = 4 \times 1$$

$$\text{WEEB-ATF NEEDED} = C \times R = 4 \times 1 = 4$$

ODD NUMBER OF MODULES IN ROW

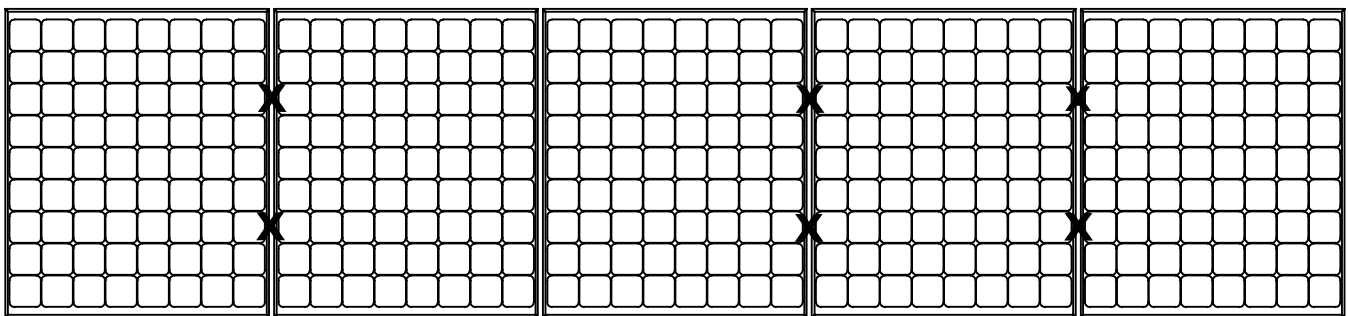

X DENOTES PLACES TO INSTALL WEEB-ATF

$$C \times R = 5 \times 1$$

$$\text{WEEB-ATF NEEDED} = [C+1] \times R = [5+1] \times 1 = 6$$

Note:

When replacing a single faulty module, also remove the adjacent module which contacts the same WEEBs as the faulty module. This will ensure that there are never ungrounded modules in the array.

WEEBLUG ASSEMBLY

7

WEEB teeth towards rail

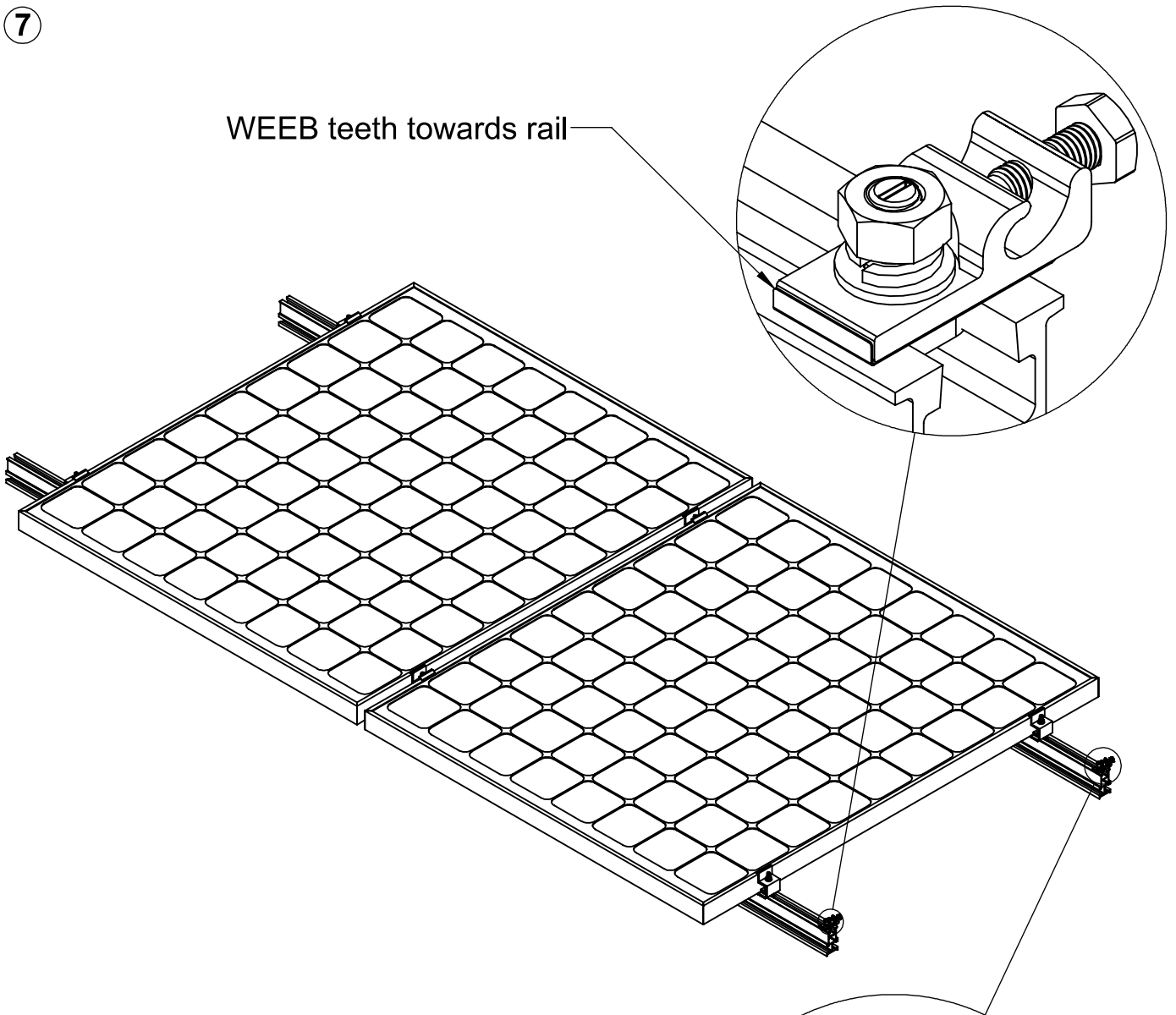

Assemble WEEBLug - 15.8 assembly and tighten fasteners to 10ft-lb / 13.5 N-m, using general purpose anti-seize on threads.

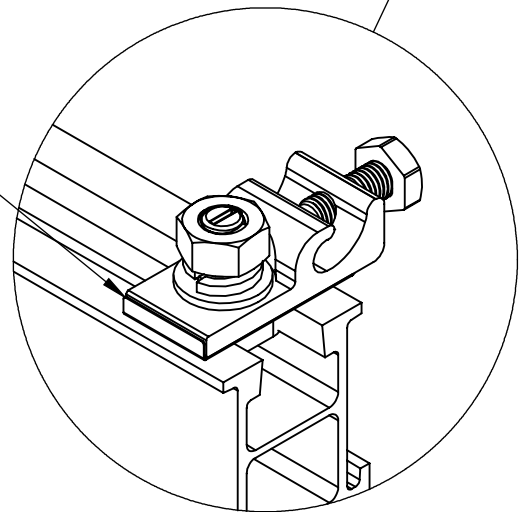

Important note:

**WEEB-15.8 that sits under the WEEBLug is for SINGLE USE ONLY!
Ensure position is correct before tightening.**

GROUND CONDUCTOR ASSEMBLY

8

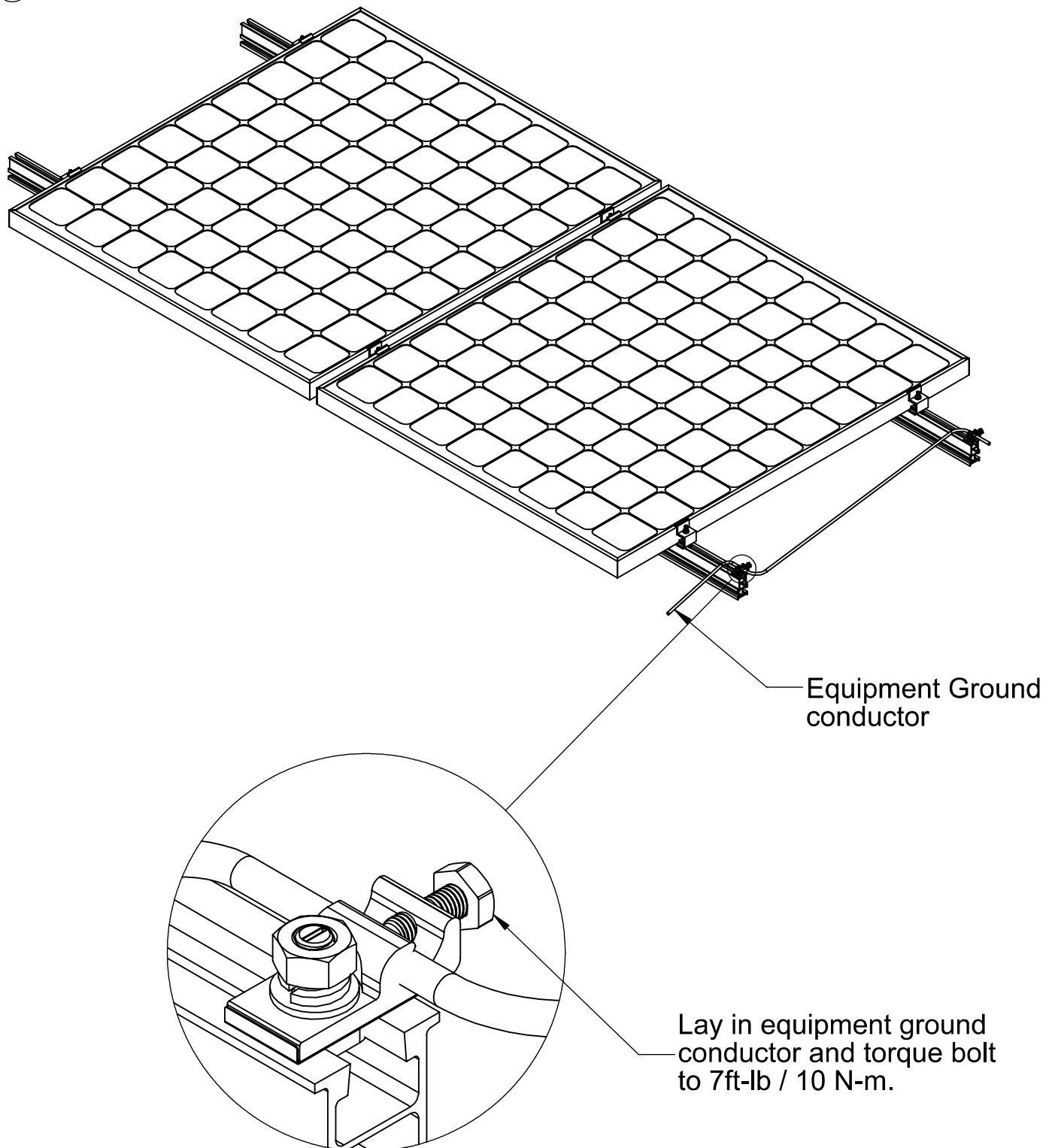

WEEB-ATF SPLICE KIT ASSEMBLY

- ⑨ Use two WEEBLug-15.8's and copper wire to electrically connect mechanically spliced rails.

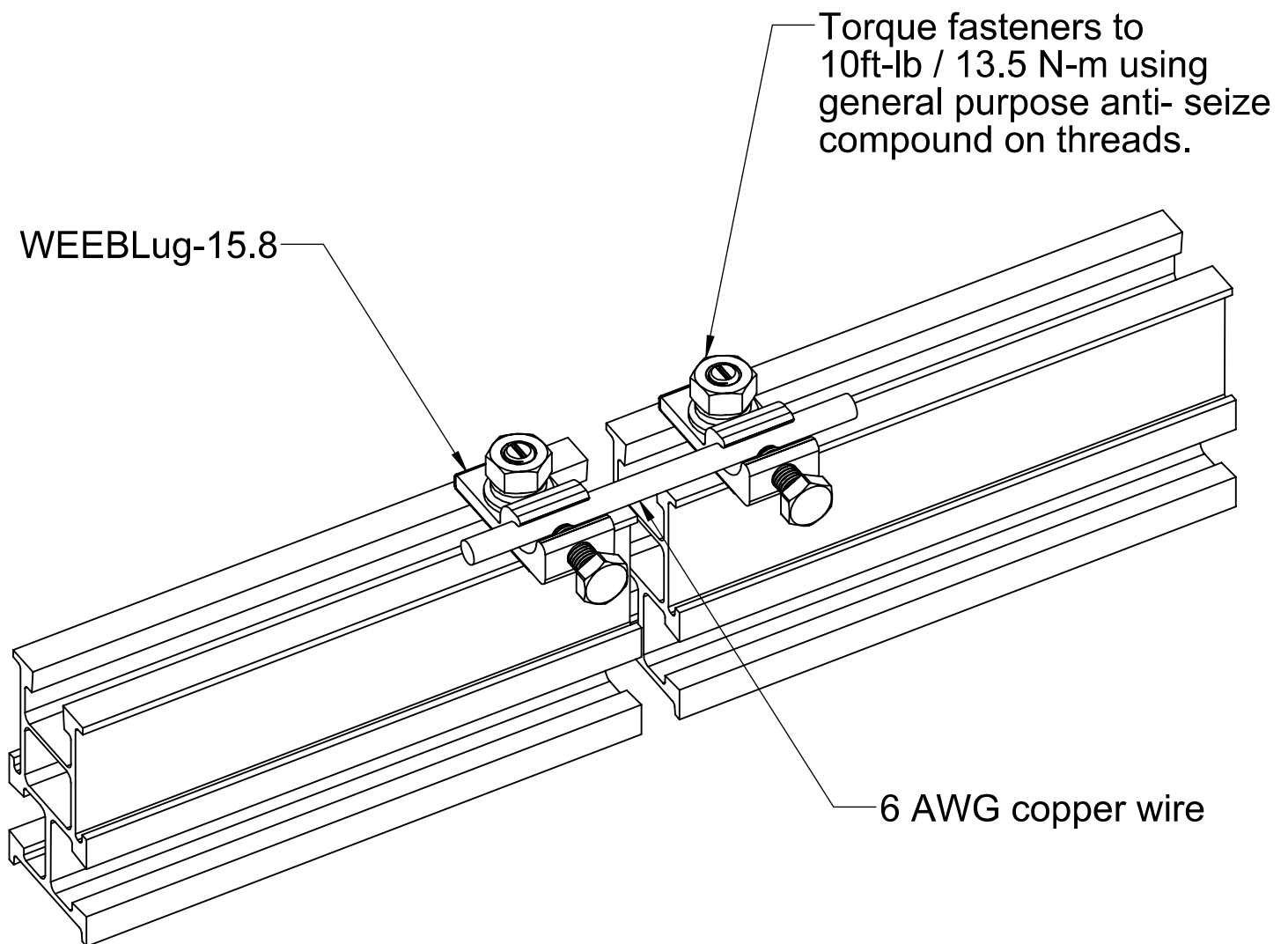

WEEBLUG-15.8 ASSEMBLY

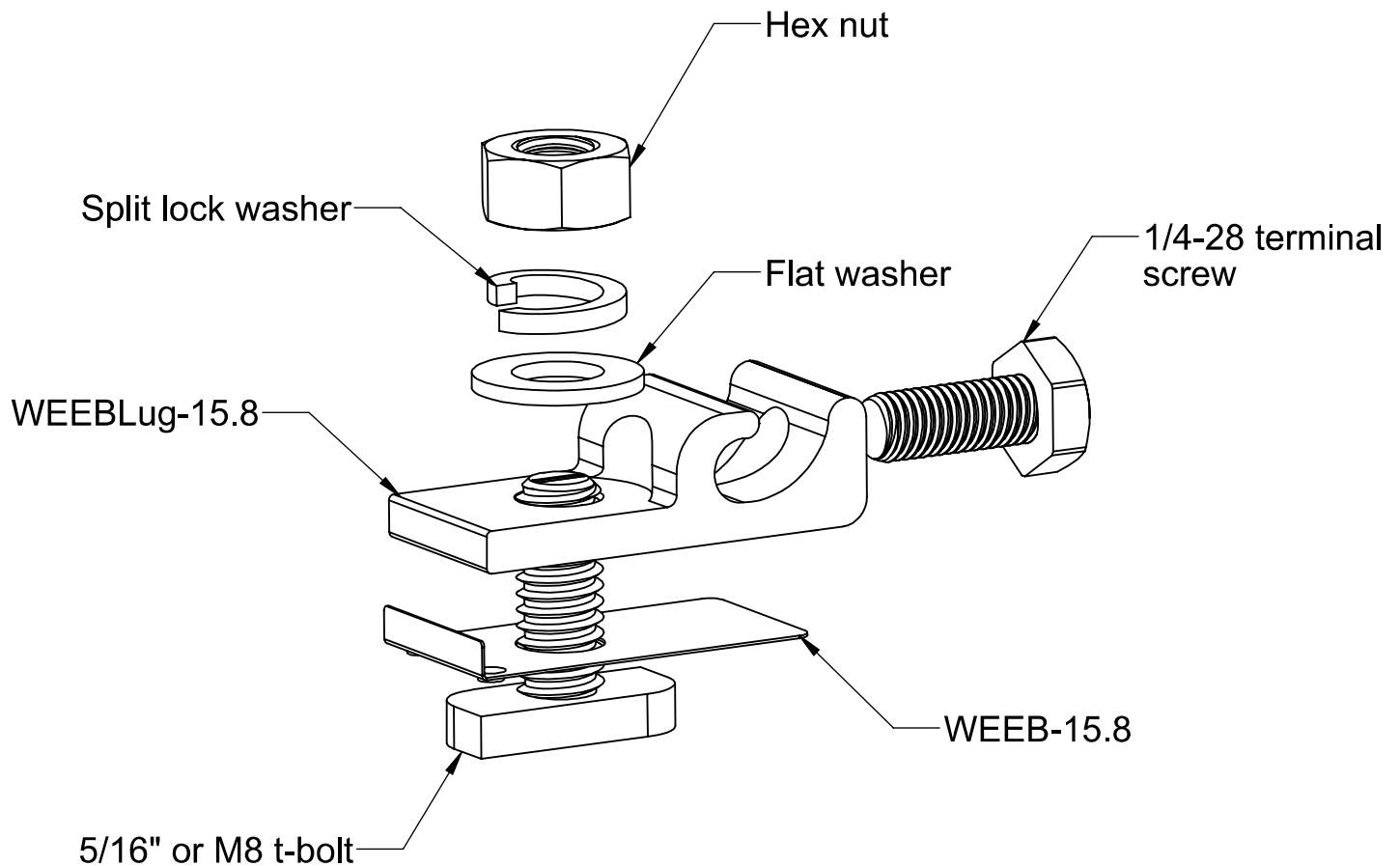

Important note:

1. Use general purpose anti-seize compound on fastener threads when installing WEEBLugs.

Customer Service Department

7 Aviation Park Drive
Londonderry, NH 03053
1-800-346-4175
1-603-647-5299 (International)