



## Installation Instructions

**WARNING – Avoid Personal Injury or Product Damage**

1. **Read and follow all instructions before installation** as indicated in this manual. This publication is based on information that was available at the time it was printed. We reserve the right to make changes to the products and/or publications at any time without notice and without obligation.
2. DIN Rail Connection: as per local electrical codes and recommended wire sizes.
3. DIN Rail mounted per VDE0160. Please see diagram as noted below.
4. This power supply is designed for professional indoor systems. During operation the power supply must not be accessible. Install and put into service by qualified personnel only.
5. **Do not operate without Protective Earth (PE) connection!** To comply with EMC and safety standards (CE mark, approvals) the power supply must be operated only if PE terminal is connected to the non-fused earth conductor.
6. **Do not cover any ventilation holes.** The correct mounting position for optimal cooling performance must be observed. All free space requirements and power de-rating as specified at the beginning of this manual must be observed.
7. Installation must be in a POLLUTION DEGREE 2 environment as covered by standard IEC-60950.
8. **WARNING** The internal fire safety fuse is not accessible. This fuse is not to be replaced by the user. For continued protection against risk of fire, **NO REPLACEMENT OF FUSE IS ALLOWED REGARDLESS.** If this internal fuse has blown, the power supply has a serious internal defect, and for safety reasons, must be discarded, or if under warranty, returned.
9. **Please ensure that the power supply will be recycled properly at the end of its life.** Some components of this power supply may be suitable for recycling, including some that require special disposal.

### Cooling, Airflow and Free Space Clearances

1. Airflow must be upward as shown in figure.
2. Always maintain operation conditions within output power and temperature ratings.
3. All units are rated for convectional cooling and require free space on both sides and above / below unit for proper airflow and heat dissipation.
4. Do not to block vent holes because by doing so, it may overheat and damage the unit.

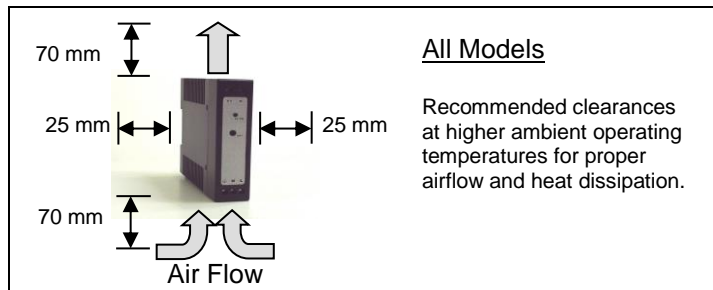

### Names and Descriptions

1. **+** Positive output (50W unit has two terminals)
2. **-** Negative output (50W unit has two terminals)
3. **DC OK** Indicator
4. **ADJ** DC output voltage adjustment
5. **⊕** Safety Ground
6. **N** AC mains (Neutral)
7. **L** AC mains (Line)
8. Din Rail rear mounting clip.

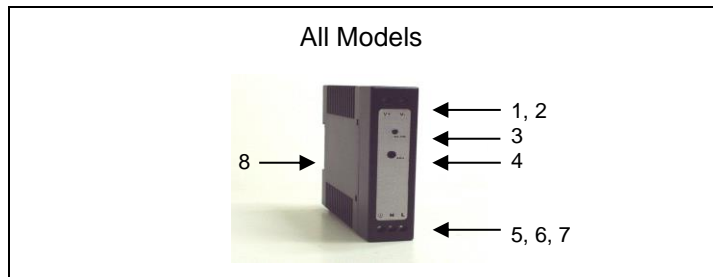

### Installation Procedure

1. **Do not connect wiring until after unit is firmly in place.**
2. Locate mounting bracket clip on back of unit. A sliding spring release clip is built into the lower channel.
3. First slip the top mounting lip of the clip over the top edge of Din Rail as shown in the figure. (The bottom of the unit should be tilted out about 10°)
4. From the front side, insert a screwdriver and pull the release lever all the way downward and hold it.
5. Apply a downward pressure keeping the top lip firmly seated into the top of the Din Rail.
6. Finally, swing the bottom of the unit downward and slide the release clip over the bottom of the Din Rail. Move the release clip upward to ensure a firm fit with the Din rail.

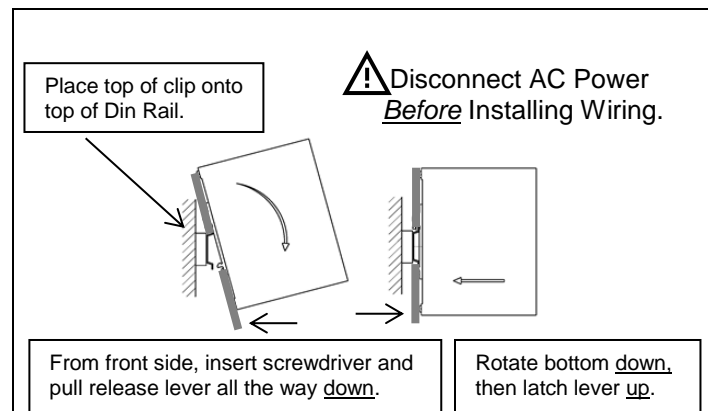

### Un-Install and Removal Procedure

1. **Turn off all AC power and disconnect from its source.** Disconnect all wiring connections from Power supply.
2. With a screwdriver, pull down the release clip and disengage the bottom channel of the unit from the bottom edge of the Din Rail. Insert pressure downward on the unit and tilt the bottom outward.
3. Lift the unit and detach it from the top edge of the Din Rail.

