

Hubbell's 22.5mm oil-tight push buttons and selector switches offer clean styling with simple installation. Hubbell's push buttons are designed to save space in modular designed panel installations. All of the devices mount from the rear of panel in a 22.5mm (7/8") diameter hole, and are secured from the front by an octagonal mounting nut.

Hubbell's push button components are designed to be used in the machine tool, food services and many heavy industries. These components offer NEMA 4X rating for use where corrosion resistance, water/oil/dust tight switching mechanisms are required. Their simple standardized mounting configuration makes them an excellent selection for all kinds of equipment where panel mounting is possible—indoor or outdoor.

Hubbell's push button switches allow for quick and easy conversion of button/pilot colors and number of contacts; allowing you to reduce the amount of component inventory necessary for normal maintenance. In addition to the push buttons and selector switches, Hubbell carries a complete line of pendant stations, enclosures and other wiring devices to complete your installation.

## Specifications

### International Standards/Approvals

- UL Listed - File #100646
- CSA Certified - Class #3211 07, Application LR-12268-77
- UL508, CSA 22.2, NEMA

### Environmental and Operating Conditions

- NEMA Type 1, 2, 3/3R, 4/4X, 12, 13 when mounted in enclosure rated for those same applications.
- Ambient Temperature Range  
 Operating: -4° F (-20° C) to +140° F (+60° C)  
 Storage: -40° F (-40° C) to +176° F (+80° C)

### Contact Block Specifications

- NEMA A600, A300, B300 for AC & P300 for DC ratings
- UL486A & B - Terminal secureness test
- Protected (shrouded) terminals
- Positive drive operation on NC contacts
- Terminal marking - US Standard (NEMA)

Description	Voltage AC				Voltage DC		
	120V	240V	480V	600V	24/28V	125V	250V
Make & Emergency Interrupting Capacity	60.0	30.0	15.0	12.0	5.7	1.1	0.55
Normal Load Break	5.0	3.0	1.5	1.2	5.7	1.1	0.55
Continuous Amperes	10.0	10.0	10.0	10.0	5.0	5.0	5.0
Volt-amperes - Make & Emerg. Inter. Cap.	7200	7200	7200	7200	138	138	138
Volt-amperes - Normal Load Break	720	720	720	720	138	138	138





### Standard Pushbuttons

Hubbell's standard 22.5mm pushbuttons feature polyester construction for superior corrosion resistance, and the #6 terminal screws have self-lifting captive wire clamps to accommodate #22 through 2 - #12 wires per terminal. The pushbuttons mount in a round 22mm or 7/8" hold and directly interchange with competitive units. These pushbuttons are rated for NEMA 1, 2, 3/3r, 4/4X, 12 and 13 installations and are UL/CSA approved.

No. of Speeds	No. of Contacts		Button Color	Part Number
	N.O.	N.C.		
One	1	1	Black	2040-80320-100
One	1	1	Red	2040-80320-101
One	1	1	Green	2040-80320-102
One	1	0	Black	2040-80320-103
One	0	1	Red	2040-80320-104
One	1	0	Green	2040-80320-105
Two	2	0	Black	2040-80320-110
One	2	2	Black	2040-80320-400
One	2	2	Red	2040-80320-401
One	2	2	Green	2040-80320-402



### Mushroom Head Pushbuttons

Hubbell's mushroom head pushbuttons are constructed to the same standards and quality as the standard pushbuttons. Mushroom heads are available in black, red, green, or a special "Stop" red. Mushroom caps are easily replaced or interchanged in the field without special tools.

No. of Speeds	No. of Contacts		Button Color	Part Number
	N.O.	N.C.		
One	1	1	Black	2040-80322-100
One	1	1	Red	2040-80322-101
One	1	1	Green	2040-80322-102
One	1	1	"Stop" Red	2040-80322-103
One	2	2	Black	2040-80322-400
One	2	2	Red	2040-80322-401
One	2	2	Green	2040-80322-402
One	2	2	"Stop" Red	2040-80322-403



### Maintained Pushbuttons

Hubbell's maintained pushbuttons are available in two variations. Single button mushroom head "push-pull" units are stand alone buttons that are commonly used for a maintained "emergency stop" function which has "push-to-stop/push-to-start" operation. Single maintained buttons are used with another operator and an MRI "maintained reset interlock" to provide two button operations for either "maintained/maintained" or "maintained/momentary" action.

No. of Speeds	No. of Contacts		Button Color	Part Number
	N.O.	N.C.		
"Push-Pull"	1	1	Black	2040-80323-100
"Push-Pull"	1	1	Red	2040-80323-101
"Push-Pull"	1	1	Green	2040-80323-102
Button	1	1	Black	2040-80323-103
Button	1	1	Red	2040-80323-104
Button	1	1	Green	2040-80323-105

### Selector & Toggle Switches

Hubbell's selector switches are available in 2 or 3 position maintained or spring return operators. Hubbell also has a 2-position toggle switch that is rated at 10 amps.

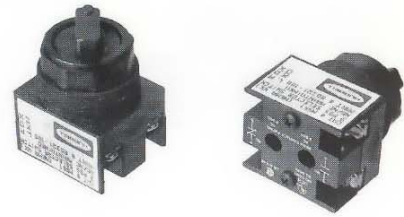

Circuits			Operator	Type of Return			Part Number
↖	↑	↗		↖	↑	↗	
X		O	Selector Toggle	M		M	2040-80321-100
O		X		M		M	2040-80321-101
X	X	O	Selector	M	M	M	2040-80321-301
O	X	X		M	M	M	
X	O	O	Selector	M	M	M	2040-80321-302
O	X	O		M	M	M	
O	O	X		M	M	M	
X	O	O	Selector	M	M	M	2040-80321-303
O	O	X	Selector	S	M	S	2040-80321-304
O	O	X	Selector	S	M	M	2040-80321-305
O	O	X	Selector	M	M	S	2040-80321-306

M – Maintained Position  
 S – Spring Return Position  
 X – Contact Closed  
 O – Contact Open

### Illuminated Pilot Lights

Hubbell's pilot lights are available in either 120V AC/DC or 250V AC/DC and are constructed to the same standards and quality as the pushbuttons. The pilot light bulb and lenses are easily removed for maintenance. Additional color lenses are available.

Type of Bulb	Voltage AC/DC	Lens Colors	Part Number
Neon	120V	Red	2040-80324-100
Neon	120V	Amber	2040-80324-101
Neon	120V	Green	2040-80324-102
Incandescent	120V	Red	2040-80324-210
Incandescent	120V	Amber	2040-80324-211
Incandescent	120V	Green	2040-80324-212
Incandescent	250V	Red	2040-80324-213
Incandescent	250V	Amber	2040-80324-214
Incandescent	250V	Green	2040-80324-215



### Two Button - Three and Five Speed Element

Hubbell's two button - three and five speed element is specifically designed to meet the most severe conditions. The two buttons are mechanically interlocked which prevents both buttons from being depressed simultaneously. These switches are ideal for pendant or other control applications that require multi-speed operation.

No. of Speeds	No. of Contacts	Button Color	Part Number
Three	4-NO/Button Sequentially Closed	Black	2040-80825-100*
Five	6-NO/Button Sequentially Closed	Black	2040-80825-000*

\*CSA Approved

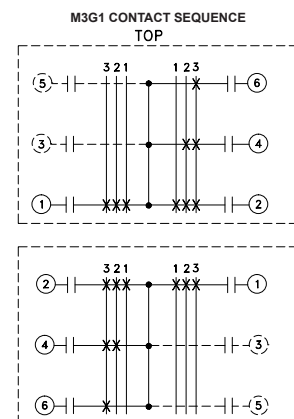
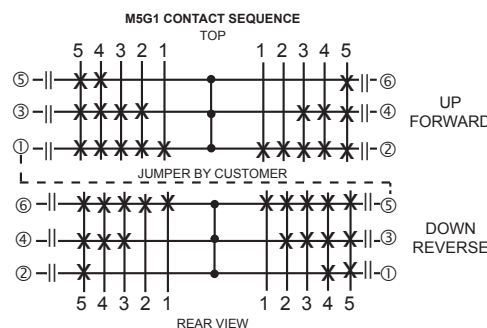

Specification Sheet

Accessories



**Rubber Boots & Mushroom Caps**

Hubbell has a large assortment of replacement boots, buttons, push-pull caps, and mushroom caps in red, green, yellow and black. They also have specially marked "Stop" caps.



**Pilot Light Lenses/Bulbs**

Hubbell has red, amber, green, white, blue, and clear pilot light lenses that are interchangeable with the original lenses. They also have replacement incandescent and neon bulbs.



**Cord Connector Kits**

Hubbell has the patented Gotcha® Ring that grips the cord like a vise when the fitting is tightened. With the addition of the neoprene brushing, Hubbell's connectors are unsurpassed in liquid-tight performance and pull-out protection.

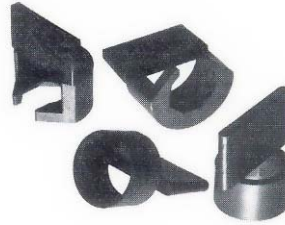

**Nut Wrenches**

Hubbell has nut wrenches specifically designed to simplify the installation of pushbuttons and selector switches, even those with mushroom heads.



**Name Plates**

Hubbell has nameplates made from chemically resistant fiber. They are available as blanks or with special engravings.

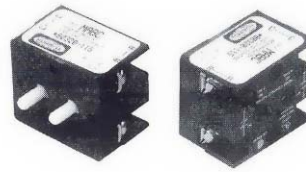

**Add-A-Block Contacts**

Hubbell has Add-A-Block contacts, which can add additional circuits to a 22mm pushbutton. With the addition of an Add-A-Block it is possible to construct pushbuttons with a total of six circuits. Available in 2-NO, 2-NC and NO/NC combinations schemes.

Dimensional Illustrations

Standard Pushbuttons

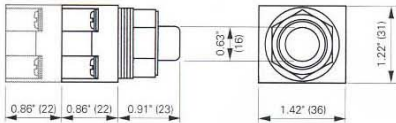

Mushroom Head Pushbuttons

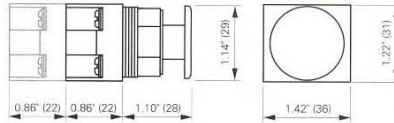

Pilot Lights

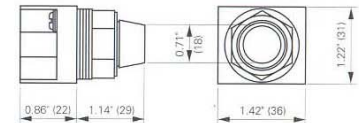

Selector Switches

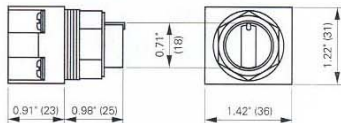

Maintained Pushbuttons

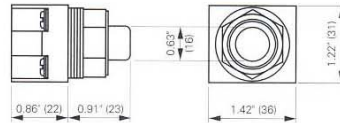

Two Button - Three & Five Speed Elements

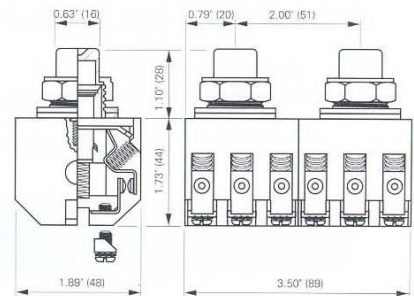

Toggle Switches

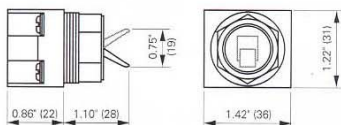

Maintained "Push-Pull" Buttons

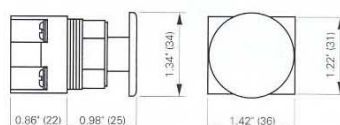

**Hubbell Industrial Controls, Inc.**

a subsidiary of Hubbell Incorporated

4301 Cheyenne Drive, Archdale, NC 27263

Phone (336) 434-2800 | Fax (336) 434-2801

www.hubbell-icd.com

sales@hubbell-icd.com