

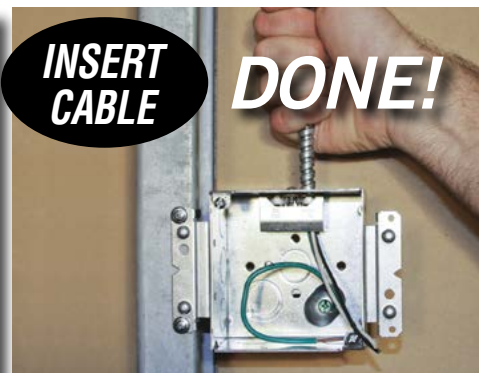

The Fastest way to terminate MC into a Box

EASY AS 1...2...3

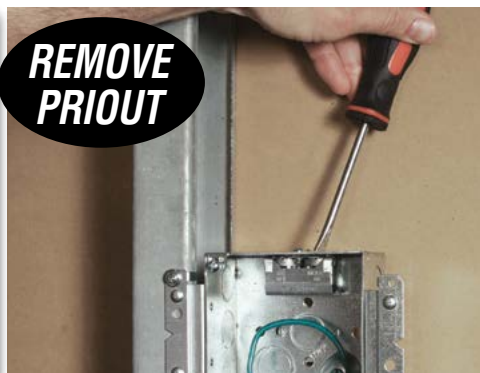

RACO STAB-IT® boxes **built-in cable connectors** for flexible armored cable. The patent pending design locks the cable in place quickly and easily to increase production on every job.

Application

- For any job where flexible armored cable is being used (see selection chart below)

Product Features

- Designed to quickly install of flex, MC, MCI, MCI-A, AC, HCF
- Accepts cable sizes from 14/2 up to 10/3 for most cable types
- **3 TIMES FASTER** than traditional connectors
- Available in 4" sq. 2-1/8" deep boxes with 1 or 2 STAB-IT® connectors

- Available in 2-1/2" deep switch boxes for new work, old work, and stud mounting
- 4" Square Boxes available with built-in cable management clip for first means of support
- UL Listed for use without a plastic bushing (except for AC Cable)
- Each STAB-IT® connector accommodates two cables
- 4" Square Boxes available with "H" or "M" brackets for stud mounting
- Pre-installed 8" solid #12 pigtail for faster installation
- Suitable for use without a bonding jumper in circuits up to 600 volts
- Cable easily removed, allows connector to be reused
- UL listed
- Patent Pending
- Designed in USA



Reduce SKU's

Manage fewer inventory SKU's

Reduce Work Site Waste

Fewer SKU's on site means less trash to dispose of

Increase Productivity

Cut down on installation time by 3X!

Cable Types and Ranges for STAB-IT® Clamp	
Cable Type	Cable Range
AC Steel & Aluminum	14-2, 14-3, 14-4, 12-2, 12-3, 12-4, 10-2, 10-3
HCF AC Steel	14-2, 14-3, 14-4, 12-2, 12-3, 10-2, 10-3
HCF AC Aluminum	12-2, 12-3, 12-4, 10-2, 10-3
MC Steel & Aluminum	14-2, 14-3, 14-4, 12-2, 12-3, 12-4, 10-2, 10-3
MCI-A Steel & Aluminum	14-2, 14-3, 14-4, 12-2, 12-3, 12-4, 10-2, 10-3
HCF MCI-A Steel	12-2, 12-3, 10-2
HCF MCI-A Aluminum	14-2, 14-3, 14-4, 12-2, 12-3, 12-4, 10-2, 10-3
Cable Range .400" Dia. Min. to .605" Dia. Max.	
Cable Armor must comply with NEC 250.96	
To remove cable, unscrew clamp from the box then pull clamp off cable.	
To install more cables, use any of the RACO® REDI-LOC® connectors.	



A BOX FOR EVERY APPLICATION

WITH BUILT-IN FIRST MEANS OF SUPPORT



Ideal for PREFAB Applications



Gangable



232MSCM



232SCM



232S

232MS

232SCM

232MSCM

244S

244SCM

244MS

244MSCM

248S

248HS

248MS

518S

523S

524S

618S

623S

624S

CAT. NO.	DESCRIPTION	CU. IN. CAP.	CTN. QTY.	CTN. DIMS.	KNOCKOUTS		UPC-A
					SIDES	BOTTOM	
232S	4" Sq., 2-1/8" Dp., (1) STAB-IT® Connector, w/Pigtail	30.3	25	18.75L x 7.375W x 8.625H	(6) 1/2", (3) 1/2"-3/4" TKO	(1) 1/2", (1) 1/2"-3/4" TKO	050169500705
232MS	4" Sq., 2-1/8" Dp., (1) STAB-IT Connector, M Bracket, w/Pigtail	30.3	25	20.875L x 8.5W x 8.75H	(6) 1/2", (3) 1/2"-3/4" TKO	(1) 1/2", (1) 1/2"-3/4" TKO	050169500736
232SCM	4" Sq., 2-1/8" Dp., (1) STAB-IT Connector, w/Pigtail and Cable Management Clip	30.3	25	18.75L x 7.375W x 8.625H	(6) 1/2", (3) 1/2"-3/4" TKO	(1) 1/2", (1) 1/2"-3/4" TKO	050169892329
232MSCM	4" Sq., 2-1/8" Dp., (1) STAB-IT Connector, M Brkt, w/Pigtail and Cable Management Clip	30.3	25	20.875L x 8.5W x 8.75H	(6) 1/2", (3) 1/2"-3/4" TKO	(1) 1/2", (1) 1/2"-3/4" TKO	050169922323
244S	4" Sq., 2-1/8" Dp., (2) STAB-IT Connectors on top, w/Pigtail	30.3	25	18.75L x 7.375W x 8.5H	(6) 1/2", (3) 1/2"-3/4" TKO	(1) 1/2", (1) 1/2"-3/4" TKO	050169982440
244SCM	4" Sq., 2-1/8" Dp., (2) STAB-IT Connectors on top, w/Pigtail and (2) Cable Management Clips	30.3	25	18.75L x 7.375W x 8.5H	(6) 1/2", (3) 1/2"-3/4" TKO	(1) 1/2", (1) 1/2"-3/4" TKO	050169962442
244MS	4" Sq., 2-1/8" Dp., (2) STAB-IT Connectors on top, M Bracket, w/Pigtail	30.3	25	20.875L x 8W x 8.5H	(6) 1/2", (3) 1/2"-3/4" TKO	(1) 1/2", (1) 1/2"-3/4" TKO	050169992449
244MSCM	4" Sq., 2-1/8" Dp., (2) STAB-IT Connectors on top, M Bracket, w/Pigtail and (2) Cable Management Clips	30.3	25	20.875L x 8W x 8.5H	(6) 1/2", (3) 1/2"-3/4" TKO	(1) 1/2", (1) 1/2"-3/4" TKO	050169972441
248S	4" Sq., 2-1/8" Dp., (2) STAB-IT Connectors, w/Pigtail	30.3	25	19L x 7.75W x 8.75H	(4) 1/2", (2) 1/2"-3/4" TKO	(1) 1/2", (1) 1/2"-3/4" TKO	050169500712
248HS	4" Sq., 2-1/8" Dp., (2) STAB-IT Connectors, H Bracket, w/Pigtail	30.3	25	20.875L x 8.5W x 8.75H	(4) 1/2", (2) 1/2"-3/4" TKO	(1) 1/2", (1) 1/2"-3/4" TKO	050169501122
248MS	4" Sq., 2-1/8" Dp., (2) STAB-IT Connectors, M Bracket, w/Pigtail	30.3	25	20.875L x 8.5W x 8.75H	(4) 1/2", (2) 1/2"-3/4" TKO	(1) 1/2", (1) 1/2"-3/4" TKO	050169500798
518S	3" x 2" x 2-1/2" Dp., Old Work Switch Box (1) STAB-IT Connector, w/Pigtail	12.5	25	12.875L x 8.75W x 5.375H	—	(1) 1/2"	050169500781
523S	3" x 2" x 2-1/2" Dp., Old Wk Switch Bx (1) STAB-IT Cnctr, w/Old Wk Clips, w/Pigtail	12.5	25	11.25L x 8.5W x 8.25H	—	(1) 1/2"	050169500514
524S	3" x 2" x 2-1/2" Dp., Old Wk Switch Bx (1) STAB-IT Cnctr, w/TS Bracket, w/Pigtail	12.5	50	20.0L x 13.5W x 7.25H	—	(1) 1/2"	050169500729
618S	3" x 2" x 3-1/2" Dp., Old Work Switch Box (1) STAB-IT Connector, w/Pigtail	18.0	25	11.125L x 10W x 8.375H	—	(1) 1/2"	050169966181
623S	3" x 2" x 3-1/2" Dp., Old Wk Switch Bx (1) STAB-IT Cnctr, w/Old Wk Clips, w/Pigtail	18.0	25	13.125L x 10W x 8.375H	—	(1) 1/2"	050169966235
624S	3" x 2" x 3-1/2" Dp., Old Wk Switch Bx (1) STAB-IT Cnctr, w/TS Bracket, w/Pigtail	18.0	25	16.125L x 11.25W x 7.625H	—	(1) 1/2"	050169966242

1 STAB-IT® connector can accommodate up to 2 cables. 2 STAB-IT® connectors can accommodate up to 4 cables



COMMERCIAL CONSTRUCTION
A Division of Hubbell Incorporated (Delaware)

RACO
3902 W. Sample St.
South Bend, IN 46619
574-234-7151
www.hubbell.com/raco/en

