

DRAWING NO.
10042673

CATALOG NUMBER	ITEM NUMBER	STRANDED COPPER CONDUCTOR ACCOMMODATED			BOLT SIZE	METRIC BOLT SIZE	B	C	H REF.	K DIA.	L	N	O.D.	T REF.	Z MIN.
		CODE (AWG)	NAVY	METRIC SIZE (CLASS 2)											
YA32L-TC78-270	10040323	400 kcmil	400	---	7/8	22	1.19 [30]	1.40 [36]	3.45 [88]	.94 [24]	2.19 [56]	.88 [22]	.95 [24]	.19 [5]	.97 [25]
YA32-L-270	10040324				5/8	16	1.19 [30]	1.40 [36]	3.45 [88]	.69 [18]	1.95 [50]	.66 [17]	.95 [24]	.19 [5]	.95 [24]
YA36-L-270	10040325	600 kcmil	---	300mm ² STR [23.1]	5/8	16	1.38 [35]	1.74 [44]	3.66 [93]	.69 [18]	2.06 [52]	.66 [17]	1.19 [30]	.26 [7]	.95 [24]
YA36L-TC78-270	10052763				7/8	22	1.38 [35]	1.74 [44]	3.66 [93]	.94 [24]	2.40 [61]	.88 [22]	1.19 [30]	.26 [7]	1.07 [27]

REV.	DATE	DESCRIPTION	ECO	BY	C'K'D.
F	11/22/13	DRAWING RELEASED	34115	YM	MB

CONNECTOR SIZE	TOLERANCES					
	B	C	K DIA.	L	N	O.D.
32	±.08	±.04	±.02	±.12	±.03	±.01
36	±.09	±.06	±.02	±.15	±.06	±.01

TOLERANCE BLOCK

CATALOG NUMBER	COLOR CODE	DIE INFORMATION		MECHANICAL		HYDRAULIC						DIELESS (# CRIMPS)	WIRE STRIP LENGTH	
		DIE INDEX	TYPE	MD6--R2	MD7-34R	BCT500 Y500CT PAT600	Y34A Y34B Y34BH	Y35, Y39 Y750, PAT35 PAT750	Y46	Y45	Y48B			Y60BHU
YA32L-TC78-270 YA32-L-270	BLUE	19 470	BLUE DIE SET NEST INDENTOR	W32RT (2) W32VT (2)	W32VT (2)	W32RT (2) W32VT (2)	---	U32RT (2) U30ART (2)	U32RT (2) U30ART (2)	U32RT (2) U30ART (2)	C32R (1) C30AR (1)	L32RT (1) L30ART (1)	HYDRAULIC: Y644M (1) BAT644M (1) PAT644M (1)	1-1/4"
YA36L-TC78-270 YA36-L-270	GREEN	22 472	GREEN DIE SET NEST INDENTOR	---	---	---	---	U36RT (2) U36ART (2)	U36RT (2) U32ART (2)	U36RT (2) U32ART (2)	C36R (1) C32AR (1)	L36RT (1) L32ART (1)		

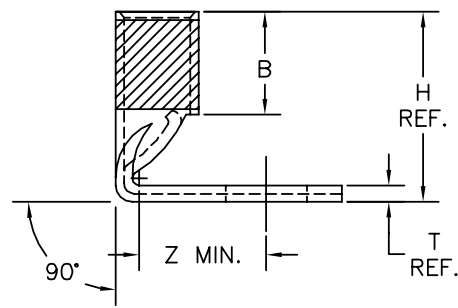
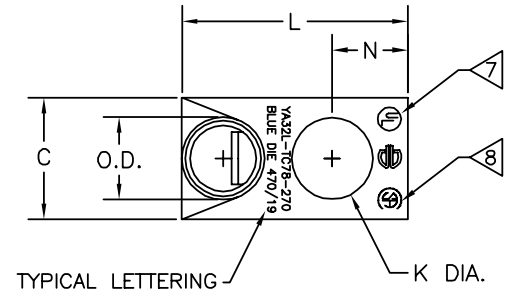

NOTES:

- MATERIAL: COPPER TUBING
- FINISH: TIN PLATED
- CATALOG # PT6515 ADAPTOR IS REQUIRED TO USE "U" DIES IN Y45 SERIES TOOLS.
- CATALOG # PUADP-1 ADAPTOR IS REQUIRED TO USE "U" DIES IN Y46 SERIES TOOLS.
- DIMENSIONS IN BRACKETS [] ARE IN MILLIMETERS ROUND OFF TO THE NEAREST MILLIMETER, UNLESS OTHERWISE NOTED, AND ARE FOR REFERENCE ONLY.
- FOR USE BY CUSTOMERS THAT HAVE THIS HYPRESS™ NO NEW Y34A HYPRESS™ TOOLS ARE BEING PROCESSED. Y34A USES A--D NEST DIES ONLY.
- CONNECTORS ARE "UL" LISTED.
- CONNECTORS ARE "CSA" CERTIFIED.
- "W-RT", "W-VT", "U" & "L" DIE SETS ARE COLOR CODED. "A", "B" AND "C" DIES ARE NOT COLOR CODED. NEST AND INDENTOR TYPE ARE NOT COLOR CODED.

<p>TO ORDER BURNDY® PRODUCTS CALL</p> <p>UNITED STATES: 1-800-346-4175 (LONDONDERRY, NH)</p> <p>CANADA: 1-800-361-6975 (QUEBEC) 1-800-387-6487 (ALL OTHER PROVINCES)</p> <p>FOR PRODUCT INFO: http://www.burndy.com</p>		HYLUG™	
		ITEM NO: TABLE	CAT NO: YA--L--270 (TABLE)
<p>SCALE: 1/1</p> <p>DRAWN BY: P LAPONIUS 6/25/04</p> <p>CHECKER: P LAPONIUS 6/30/04</p> <p>DSN APPVL: J MICHAUD</p> <p>MFG APPVL: ---</p> <p>QC APPVL: J BRODEUR</p> <p>MKT APPVL: R ROBICHEAU</p> <p>PROD FAM: ---</p> <p>PROJECT #: ---</p> <p>DOCUMENT TYPE: Sales</p> <p>REL LEVEL: AutoCAD</p>		<p>BURNDY</p> <p>DRAWING NO: 10042673</p> <p>REV: F</p> <p>SHEET 1 OF 1</p>	