

DRAWING NO.
10051641

REV.	DATE	DESCRIPTION	ECO	BY	C'K'D.
B	12/03/12	DRAWING LOGO CHANGED.	29615	YM	MB

BURNDY MOLD CAT. NO.	BURNDY ITEM NUMBER	BUS BAR SIZE	CABLE SIZE	WELD METAL	HANDLE CLAMPS
B-692	10049335	1/4" X 3"	1/0	115	B-106
B-693	10049336	1/4" X 3"	2/0	115	B-106
B-694	10049337	1/4" X 3"	4/0	150	B-106
B-695	10049338	1/4" X 3"	250 kcmil	150	B-106
B-696	10049339	1/4" X 3"	300 kcmil	200	B-106
B-697	10049340	1/4" X 3"	350 kcmil	200	B-106
B-699	10049341	1/4" X 3"	500 kcmil	250	B-106
B-700	10049342	1/4" X 3"	750 kcmil	2-200	B-107
B-701	10049343	1/4" X 3"	1000 kcmil	500	B-107
B-702	10049344	3/8" X 2"	1/0	115	B-106
B-703	10049345	3/8" X 2"	2/0	115	B-106
B-704	10049346	3/8" X 2"	4/0	150	B-106
B-705	10049347	3/8" X 2"	250 kcmil	150	B-106
B-706	10049348	3/8" X 2"	300 kcmil	200	B-106
B-707	10049349	3/8" X 2"	350 kcmil	200	B-106
B-709	10049350	3/8" X 2"	500 kcmil	250	B-106
B-710	10049351	3/8" X 2"	750 kcmil	2-200	B-107
B-711	10049352	3/8" X 2"	1000 kcmil	500	B-107
B-712	10049353	3/8" X 2" & WIDER	1/0	115	B-106
B-713	10049354	3/8" X 2" & WIDER	2/0	115	B-106
B-714	10049355	3/8" X 2" & WIDER	4/0	150	B-106
B-715	10049356	3/8" X 2" & WIDER	250 kcmil	150	B-106
B-716	10049357	3/8" X 2" & WIDER	300 kcmil	200	B-106
B-717	10049358	3/8" X 2" & WIDER	350 kcmil	200	B-107
B-719	10049359	3/8" X 2" & WIDER	500 kcmil	250	B-106
B-720	10049360	3/8" X 2" & WIDER	750 kcmil	2-200	B-107
B-721	10049361	3/8" X 2" & WIDER	1000 kcmil	500	B-107
B-722	10049362	1/2" X 2"	1/0	150	B-106
B-723	10049363	1/2" X 2"	2/0	150	B-106
B-724	10049364	1/2" X 2"	4/0	200	B-106
B-725	10049365	1/2" X 2"	250 kcmil	200	B-106
B-726	10049366	1/2" X 2"	300 kcmil	250	B-106
B-727	10049367	1/2" X 2"	350 kcmil	250	B-106
B-729	10049368	1/2" X 2"	500 kcmil	2-150	B-106
B-730	10049369	1/2" X 2"	750 kcmil	500	B-107
B-731	10049370	1/2" X 2"	1000 kcmil	3-200	B-107
B-732	10049371	1/2" X 3" & WIDER	1/0	150	B-106
B-733	10049372	1/2" X 3" & WIDER	2/0	150	B-106
B-734	10049373	1/2" X 3" & WIDER	4/0	200	B-106
B-735	10049374	1/2" X 3" & WIDER	250 kcmil	200	B-106
B-736	10049375	1/2" X 3" & WIDER	300 kcmil	250	B-106
B-737	10049376	1/2" X 3" & WIDER	350 kcmil	250	B-106
B-739	10049377	1/2" X 3" & WIDER	500 kcmil	2-150	B-107
B-740	10049378	1/2" X 3" & WIDER	750 kcmil	500	B-107
B-741	10049379	1/2" X 3" & WIDER	1000 kcmil	3-200	B-107

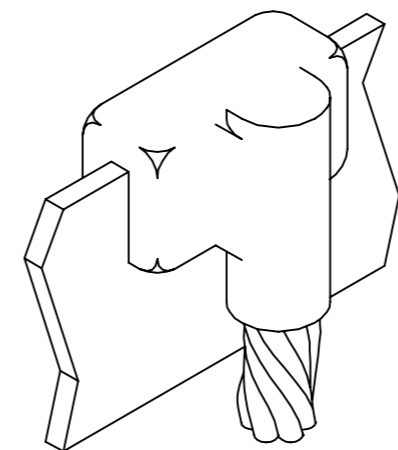

NOTES:

- BCB-3 TYPE MOLDS ARE USED TO CONNECT A VERTICAL CABLE TAP TO A HORIZONTAL COPPER BUS BAR ON ITS EDGE.
- SIZE RANGE IS 1/0 THROUGH 1000 kcmil SOLID OR CONCENTRIC STRANDED COPPER CONDUCTORS. BUS SIZE RANGE IS FROM 1/8" X 1" THROUGH 1/2" X 3" AND WIDER.
- MOLDS LISTED ARE FOR CONCENTRIC STRANDED CABLE. ADD SUFFIX "-S" TO MOLD NUMBER FOR SOLID CONDUCTORS.
- FOR HEAVY DUTY MOLDS, ADD SUFFIX "H" TO THE MOLD NUMBER.
- REQUIRED TOOLS:
HANDLE CLAMPS (SEE TABLE FOR CORRECT HANDLES). FOR HANDLES SEE DRAWING 10051615.
B38-0309-00: FLINT IGNITOR (DRAWING 10051616).
- OTHER RECOMMENDED ACCESSORIES: DRAWING 10051616.
B38-3922-00: MOLD CLEANING BRUSH
B38-0135-00: CABLE CLEANING BRUSH

<p>TO ORDER BURNDY® PRODUCTS CALL UNITED STATES: 1-800-346-4175 (LONDONDERRY, NH) CANADA: 1-800-361-6975 (QUEBEC) 1-800-387-6487 (ALL OTHER PROVINCES) FOR PRODUCT INFO: http://www.burndy.com</p>		BURNDYweld™ VERTICAL DROP TAP TO HORIZONTAL BUS	
		ITEM NO: N/A	
<p>CAT NO: BCB-3 SERIES</p>		SCALE: N/A	
		<p>DRAWN BY: P LAPONIUS 12/8/04 CHECKER: D SHIBILIA 1/3/05 DSN APPVL: D SHIBILIA 1/13/05 MFG APPVL: --- QC APPVL: J BRODEUR 1/14/05 MKT APPVL: R ROBICHEAU 1/18/05</p>	
<p>PROJECT #: --- DOCUMENT TYPE: Sales REL LEVEL: AutoCAD</p>		DRAWING NO	
		10051641	
<p>SIZE: D</p>		REV	
		B	
<p>SHEET 2 OF 2</p>			