

REV	DATE	DESCRIPTION	ECO	BY	CHECK
C	10/01/2012 20:00:00 PM	CAT. # BG14N ADDED.	28963	SP	MB

CATALOG NUMBER	ITEM NUMBER	L
BG8D50N	001111	8.50 [216]
BG8D75N	332934	8.75 [222]
BG9D50N	332587	9.50 [241]
BG9D75N	30013240	9.75 [248]
BG10D25N	332903	10.25 [260]
BG11D25N	002423	11.25 [286]
BG12N	33288G	12.00 [305]
BG14N	50009613	14.00 [356]
BG17N	50005410	17.00 [432]
BG18N	332248	18.00 [457]
BG19N	50005402	19.00 [483]
BG21N	50005394	21.00 [533]
BG22N	50005386	22.00 [559]
BG24N	33284L	24.00 [610]
BG25N	10043240	25.00 [635]
BG26N	10076995	26.00 [660]
BG28N	10021134	28.00 [711]
BG30N	332702	30.00 [762]
BG36N	332703	36.00 [914]
BG42N	33213R	42.00 [1067]
BG48N	000193	48.00 [1219]
BG60N	332950	60.00 [1524]
BG72N	332592	72.00 [1829]
BG84N	25020920	84.00 [2134]
BG96N	25003664	96.00 [2438]
BG288N	33205G	288.00 [7315]
BG1200N	10090548	1200.00 [30480]

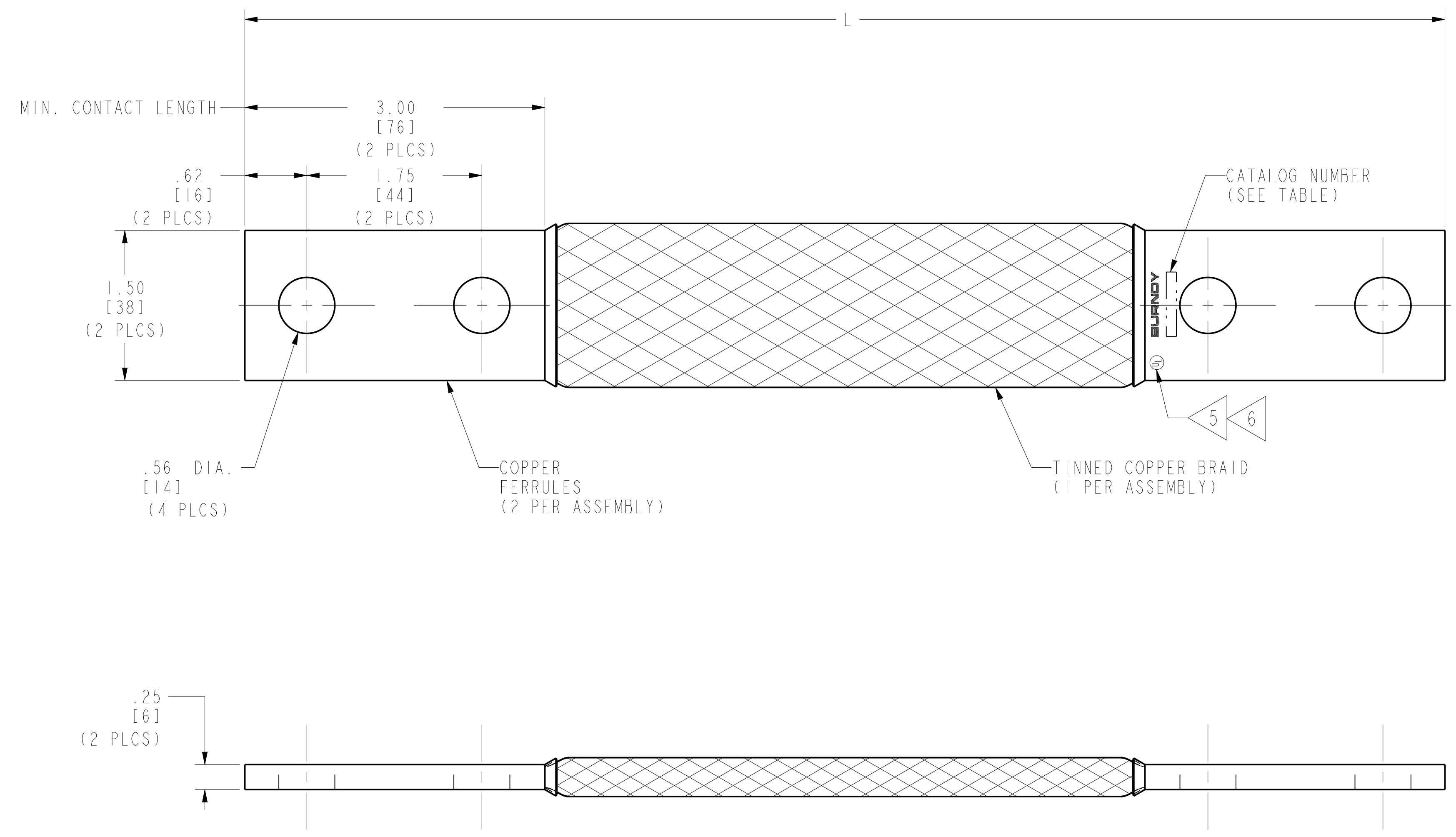

- NOTES:
- APPROXIMATE AMP. RATING: 415 INDOOR, 495 OUTDOOR. THIS RATING MAY VARY WITH AMBIENT CONDITIONS, ORIENTATION OF THE BRAID AND OTHER SERVICE CONDITIONS.
 - DIMENSIONS IN BRACKETS [] ARE IN MILLIMETERS ROUNDED OFF TO THE NEAREST MILLIMETER, UNLESS OTHERWISE SPECIFIED, AND ARE FOR REFERENCE ONLY.
 - CAN BE ORDERED WITH PLATED FERRULES BY ADDING SUFFIX AS SHOWN BELOW:
 "NK" - FOR NICKEL PLATING
 "SV" - FOR SILVER PLATING
 "TN" - FOR TIN PLATING
 "W" - FOR HOT TIN DIPPED
 - CAN BE ORDERED WITH UNDRILLED FERRULES BY ADDING SUFFIX "U".
 - ALL SIZES ARE LISTED TO UL467 GROUNDING & BONDING EQUIPMENT STANDARDS.
 - BRAID SIZES MAY BE DESIGNATED BY SUFFIXES REPRESENTING VARIATIONS IN LENGTH, QUANTITY & SIZE OF MOUNTING HOLES, PAD SIZE AND FINISH. (REF. NOTE 5)

TO ORDER BURNDY® PRODUCTS CALL
 UNITED STATES
 1-800-346-4175 (LONDONDERRY, NH)
 CANADA:
 1-800-361-6975 (QUEBEC)
 1-800-387-6487 (ALL OTHER PROVINCES)
 FOR PRODUCT INFO: <http://www.burndy.com>

BRAID	
ITEM NO:	SEE TABLE
CAT. NO:	BG--N (TABLE)
DRAWN BY:	T. BALAN 04/19/11
CHECKER:	E. MARTIN 04/18/11
DSN APPVL:	E. MARTIN 04/18/11
MFG APPVL:	O. GUALBERTO 05/05/11
QA APPVL:	J. BRODEUR 04/19/11
MKT APPVL:	--
PROD FAM:	MECHANICAL GROUNDING
PROJECT #:	--
DOCUMENT TYPE:	Sales
REL LEVEL:	Released

DRAWING NO	10077022
SCALE	5:8
SHEET	1 OF 1



REV: PEC200