

REV.	DATE	DESCRIPTION	ECO	BY	C'H'K.
D	06/01/2015 00:00:00 AM	ADD HIW716ENFSRP10 TO TABLE	40407	TRF	MAC

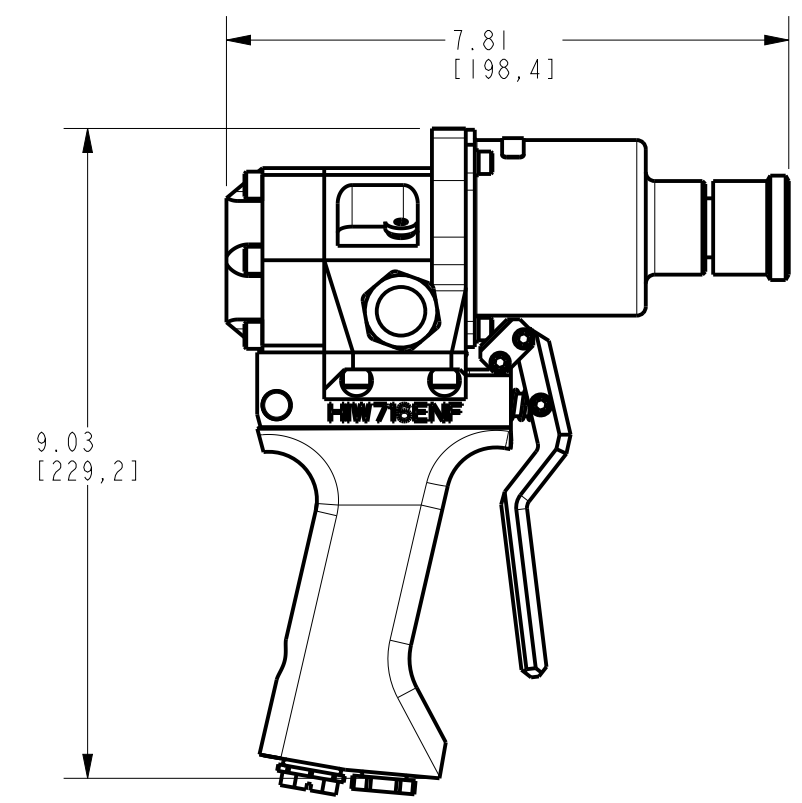
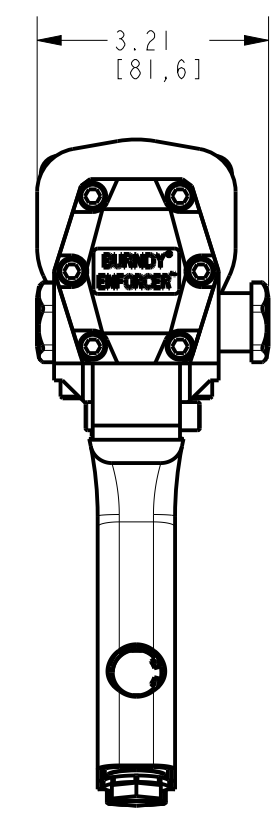
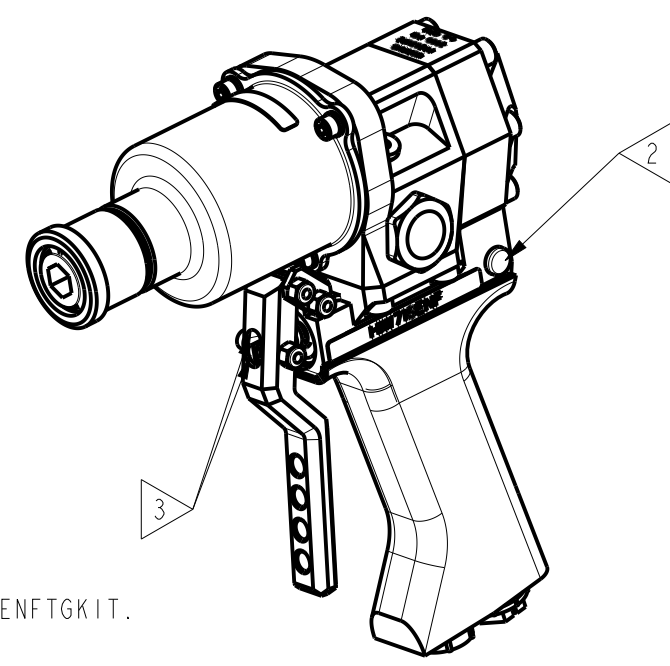
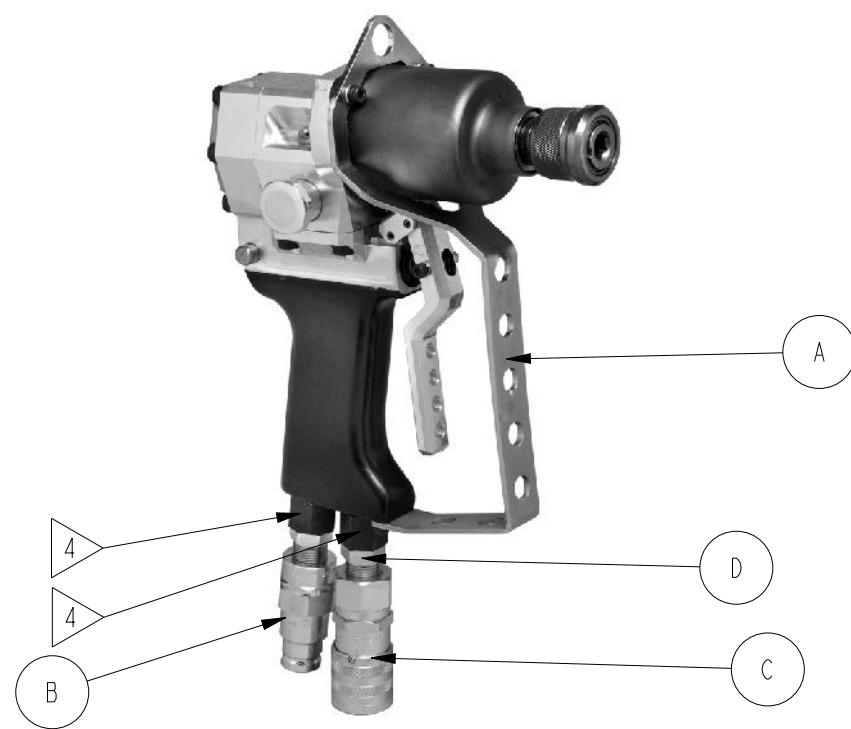

REF	CATALOG NUMBER	DESCRIPTION
A	HIW716ENFTGKIT	TRIGGER GUARD ASSEMBLY KIT
B	LPHTHTMANOSE66	MALE COUPLING 3/8" NPT
C	LPHTHTMABODY66	FEMALE COUPLING 3/8" NPT
D	LPHTADPMMOP66	MALE TO MALE ADAPTOR 3/8" NPT
E	HIW716ENFSRP10	HIW716ENF WITH 3/8 X 10 FT NON-CONDUCTIVE HOSES (HARD PLUMBED, WITH COUPLERS ON THE ENDS)

* CATALOG NUMBER HIW716ENFTG IS ALSO AVAILABLE AND IS AN HIW716ENF WRENCH PROVIDED WITH A FACTORY INSTALLED HIW716ENFTGKIT.

SPECIFICATIONS:

CHUCK TYPE: 7/16" QUIK™ CHANGE
 OPTIMAL PRESSURE: 750 - 2000 PSI
 OPTIMAL FLOW RANGE: 4-8 GPM
 OPERATION: OPEN / CLOSED OPTION
 TORQUE: 515 FT-LBS
 WEIGHT: 5.95 LBS

NOTES:

1. TOOL MACHINED FROM SOLID BILLET HIGH GRADE ALUMINUM ALLOY THAT PROVIDES SUPERIOR STRENGTH AND RELIABILITY.
2. VARIABLE TORQUE OPTION FROM HIGH TO LOW - SIMPLY PRESS TORQUE OPTION BUTTON TO DESIRED SETTING.
3. TO CHANGE THE OPERATION FROM OPEN TO CLOSED OR VICE VERSA, SIMPLY REMOVE THE NUT AND BOLT AND ROTATE THE TRIGGER SHAFT TO THE DESIRED OPERATION IDENTIFIED BY "O" FOR OPEN AND "C" FOR CLOSED. ONCE SET, REPLACE THE NUT AND BOLT TO LOCK THE SETTING IN PLACE. THE DEFAULT SETTING FROM THE FACTORY IS OPEN.
4. REMOVAL OF ADAPTORS VOIDS ANY WARRANTY. THE ADAPTORS ARE ADDED TO PROTECT THE WRENCH FROM EXCESSIVE FLOWS AND /OR REVERSE HYDRAULIC FLOW.

TO ORDER BURNDY® PRODUCTS CALL
 UNITED STATES:
 1-800-346-4175 (LONDONDERRY, NH)
 CANADA:
 1-800-361-6975 (QUEBEC)
 1-800-387-6487 (ALL OTHER PROVINCES)
 FOR PRODUCT INFO: <http://www.burndy.com>

HYDRAULIC IMPACT WRENCH	
ITEM NO:	10092969
CAT. NO:	HIW716ENF
DRAWN BY:	T. FAUCHER 10/01/2008
CHECKER:	M. CHIASSON 10/01/2008
DSN APPVL:	M. CHIASSON 10/31/2008
MFG APPVL:	T. BONINA 10/31/2008
QA APPVL:	J. AYER 10/31/2008
MKT APPVL:	R. ROBICHEAU 10/31/2008
PROD FAM:	TOOLS, HYDRAULIC
PROJECT #:	13740
DOCUMENT TYPE:	Sales
REL LEVEL:	Released
SCALE:	3:8
DRAWING NO:	10092031
REV:	D
SHEET 1 OF 1	

REV: PE0200