

BURNDY® PRODUCTS - HYLUG™ & HARDWARE

REV	DATE	DESCRIPTION	ECO	BY	C'H'K.
F	12/16/2013 14:34:00 PM	DRAWING UPDATED AS PER MARK-UP	33286	GP	MB

ITEM NUMBER	CATALOG NUMBER	FIG NO	ACCOMMODATES ACCC® CONDUCTOR		5 CONTAINS HARDWARE KIT CAT #	CTC NUMBER	DIMENSIONS						7 INSTALLATION TOOLING (NOT INCLUDED) TOOLS, DIE SETS				APPROXIMATE WEIGHT LBS.										
			CODE WORD	SIZE			C	D	L	N	O.D.	I.D.	T	DIE INDEX													
														Y45	Y46	Y60											
10093852	BYNA32RTHACCC	1	LINNET ORIOLE COPENHAGEN REYKJAVIK	431 Kcmil 438 Kcmil 230 mm ² 235 mm ²	TMH24	600-153-1-0D	3.25 [82]	4.50 [114]	15.5 [393]	1.12 [29]	1.19 [30]	.80 [20]	.50 [13]	717	S717	P717	L717W	2.3									
10093851	BYNA32RTACCC				--																						
10093959	BYNA36RTHACCC	1	HAWK CASABLANCA LISBON	611 Kcmil 285 mm ² 325 mm ²	TMH24	600-153-3-0D										15.8 [402]			1.41 [36]	.92 [23]		720	S720	P720	L720W		
10093958	BYNA36RTACCC				--																						
10093963	BYNA39RTHACCC	1	DOVE OSLO AMSTERDAM	713 Kcmil 330 mm ² 380 mm ²	TMH24	600-153-5-0D										16.2 [411]			1.50 [38]	.97 [25]		722	S722	P722	L722W		
10093962	BYNA39RTACCC				--																						
10093966	BYNA43RTHACCC	1	GROSBEAK BRUSSELS	816 Kcmil 430 mm ²	TMH24	600-153-7-0D			16.2 [412]		1.61 [41]	1.05 [27]		724	S724	P724	L724W										
10093965	BYNA43RTACCC				--																						
10093969	BYNA451RTHACCC	2	8 DRAKE STOCKHOLM WARSAW DUBLIN	1020 Kcmil 470 mm ² 530 mm ² 540 mm ²	TMH24	600-253-5-0D	3.22 [82]	3.95 [100]	15.3 [389]	.63 [16]	1.80 [46]	1.18 [30]	.45 [11]	725	S725	P725	L725W										
10093968	BYNA451RTACCC	2			--																						
10093972	BYNA49RTHACCC	2	CARDINAL VIENNA BUDAPEST PRAGUE	1222 Kcmil 650 mm ² 690 mm ² 710 mm ²	TMH24	600-253-7-0D										15.6 [397]		1.97 [50]	1.32 [33]	.52 [13]	727	--	--	L727W			
10093971	BYNA49RTACCC	2			--																						
10093975	BYNA52RTHACCC	2	LONDON BITTERN PARIS	780 mm ² 1572 Kcmil 840 mm ²	TMH9	600-253-11-0D		4.12 [105]	17.1 [435]		2.25 [57]	1.46 [37]	.71 [18]	728	--	--	L728W										
10103107	BYNA52RTACCC				--																						

CATALOG NO. TMH9
HARDWARE KIT CONSIST OF

QTY.	DESCRIPTION
4	BOLT, HEX HEAD 1/2"-13 X 2 1/4" LONG
4	HEX NUT, 1/2"-13
4	FLAT WASHER 1/2"
4	RESILIENT WASHER 1/2"

CATALOG NO. TMH24
HARDWARE KIT CONSIST OF

QTY.	DESCRIPTION
4	BOLT, HEX HEAD 1/2"-13 X 2" LONG
4	HEX NUT, 1/2"-13
4	FLAT WASHER 1/2"
4	RESILIENT WASHER 1/2"

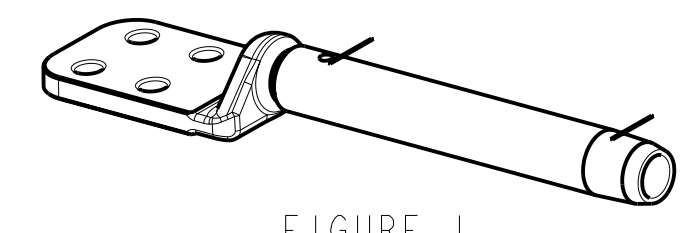

FIGURE 1
3D VIEW
SCALE 1:4

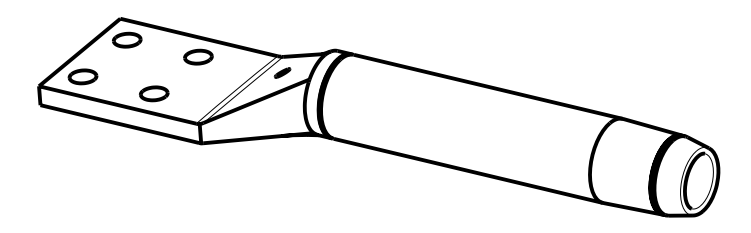
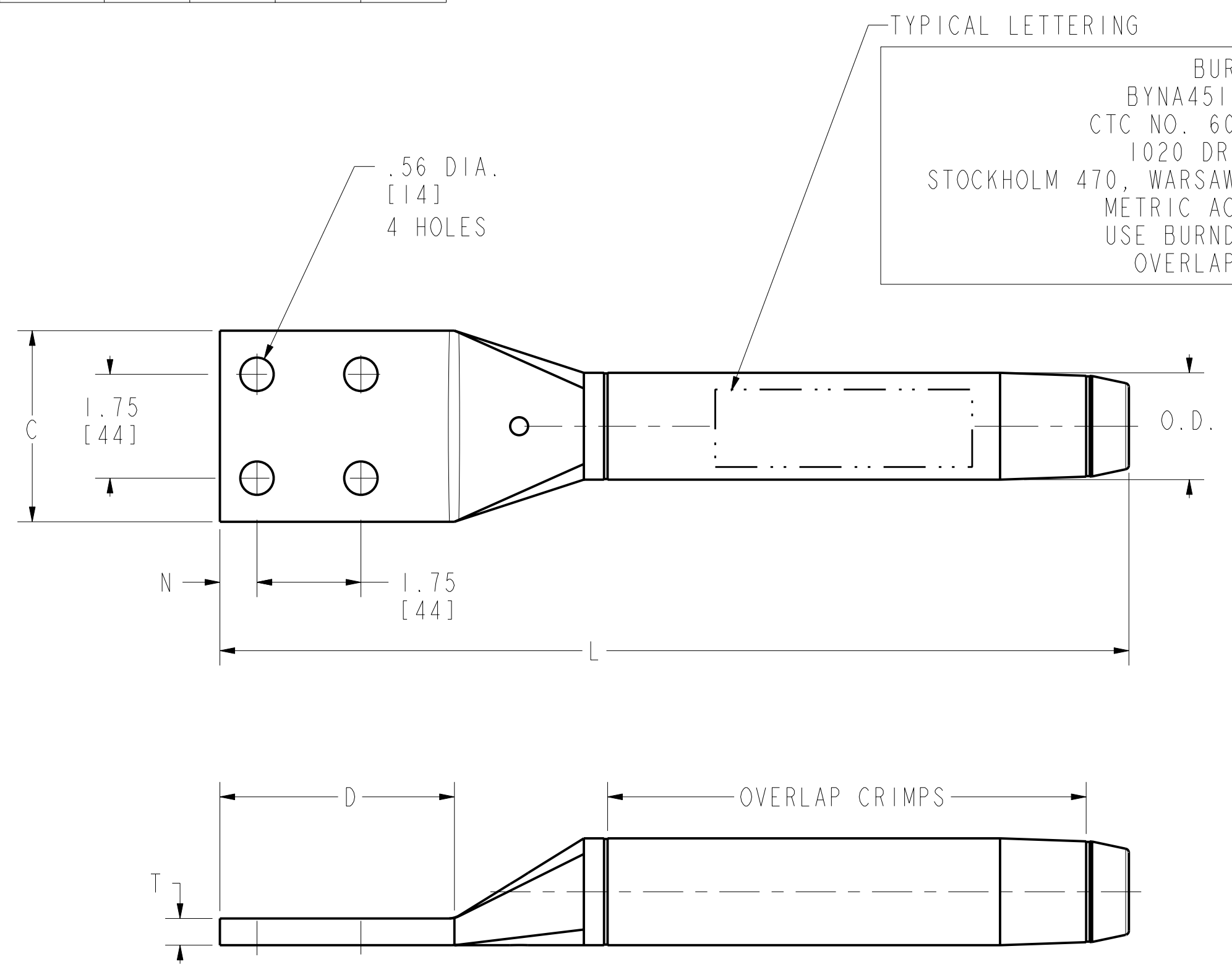

FIGURE 2
3D VIEW
SCALE 1:4



- NOTES:
- MATERIAL:
- CONNECTOR, ALUMINUM ALLOY, NO-OX-ID COATED
- ALUMINUM FILLER PLUG
- TMH9 & TMH24 HARDWARE
- BOLTS, NUTS AND FLAT WASHERS, ALUMINUM ALLOY
- RESILIENT WASHERS, GALVANIZED STEEL
 - DIMENSIONS IN BRACKETS [] ARE IN MILLIMETERS ROUNDED OFF TO THE NEAREST MILLIMETER, UNLESS OTHERWISE SPECIFIED AND ARE FOR REFERENCE ONLY.
 - DESIGNED FOR CORONA FREE OPERATION TO 230 KV NO ACCESSORIES REQUIRED.
 - CONNECTOR SHALL BE SHIPPED UN-ASSEMBLED.

- 5 RECOMMENDED TIGHTENING TORQUE: 1/2-13 ALUMINUM HARDWARE: 300 LBS-IN [34NM]
- 6 CATALOG NUMBER FOR HYLUG™ WITHOUT HARDWARE ARE CATALOG NUMBERS WITHOUT "H".
- 7 REFERENCE: 10092621, CONNECTOR INSTALLATION
- 8 ACCOMMODATES METRIC ACSR 435/55.

TO ORDER BURNDY® PRODUCTS CALL
UNITED STATES
1-800-346-4175 (LONDONDERRY, NH)
CANADA:
1-800-361-6975 (QUEBEC)
1-800-387-6487 (ALL OTHER PROVINCES)
FOR PRODUCT INFO: <http://www.burndy.com>

COMPRESSION TERMINAL CONNECTOR FOR
(ACCC®) ALUMINUM CONDUCTOR COMPOSITE CORE

0 DEG HYLUG™ & HARDWARE	
ITEM NO:	SEE TABLE
CAT. NO:	SEE TABLE
DRAWN BY:	D. GANESH 11/19/2008
CHECKER:	P. WALTZ 11/22/2008
DSN APPVL:	P. WALTZ 11/22/2008
MFG APPVL:	--
QA APPVL:	J. BRODEUR 11/24/2008
MKT APPVL:	D. HAMILTON 11/22/2008
PROD FAM:	Transmission/YNA
PROJECT #:	SIZE
DOCUMENT TYPE:	Sales
REL LEVEL:	Released

SCALE: 1:2
DRAWING NO: 10093977
SHEET 1 OF 1
REV: F

