

NOTES:

- 1 CREEPAGE DISTANCE: 66.2" / 1683mm
- 2 ARC DISTANCE: 27.4" / 698mm
- 3 NOMINAL VOLTAGE: 46kV
- 4 NOMINAL CURRENT: 1400A
- 5 VOLTAGE WITHSTAND, 60 sec.: 105kV
- 6 B.I.L.: 250kV
- 7 ROUTINE TEST ACCORDING TO: IEEE C57.19.01
- 8 MAX. TORQUE APPLIED ON FLANGE BOLTS: 40 lbf·ft / 54.2 N·m
- 9 WEIGHT: 104 lb / 47.2 kg
- 10 INSULATION THERMAL LIMIT: 130°C. BUSHING RATED PER IEEE C57.19.00 USUAL SERVICE CONDITIONS. (B)

REVISIONS					
ZONE	REV.	DESCRIPTION	DRAWN BY	DATE	APPR.
C3, F5	A	ADD SHEDS AND INCREASE CREEPAGE DISTANCE ACCORDINGLY	M. FORGET	2021-10-28	J.V.
E4	B	NOTE #10 UPDATED	M. FORGET	2022-05-31	J.V.

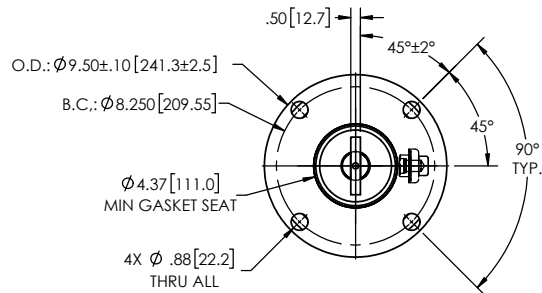
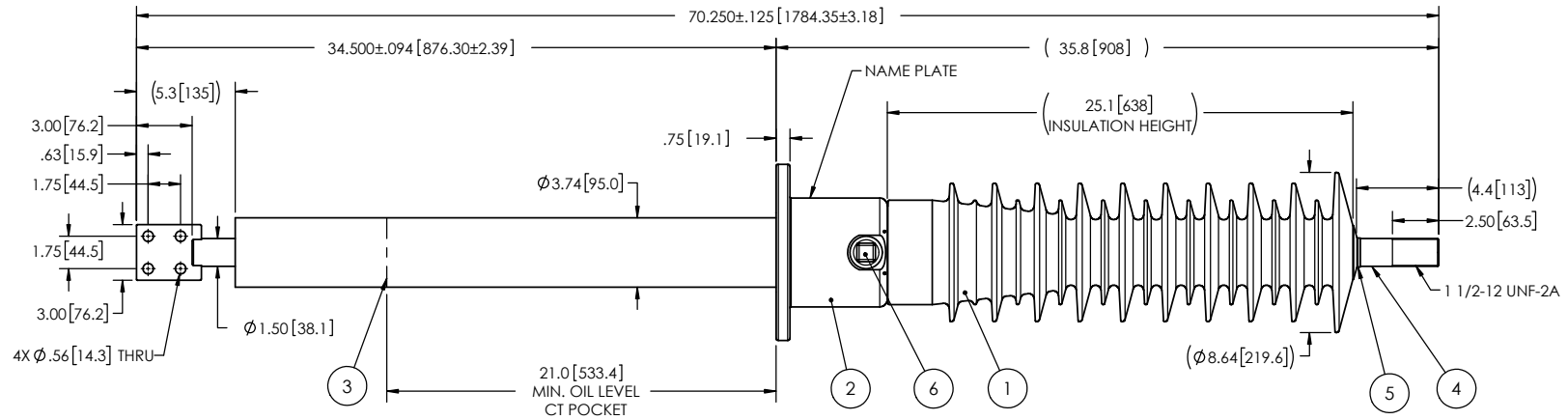

VIEW A-A

This drawing is the proprietary property of Electro Composites (2008) ULC, not part of the public domain, and is issued with the express understanding and agreement that it is not to be reproduced or copied in whole or in part or issued for furnishing information to others, or used directly or indirectly, in any way detrimental to the interest of Electro Composites (2008) ULC and is to be returned upon request by Electro Composites (2008) ULC. All Rights Reserved.

ITEM NO.	QTY	DRAWING NO.	PART NO.	DESCRIPTION	NOTE / MAT'L
6	1	S-1001-2022		CAPACITANCE TAP ASSEMBLY	ALUMINUM
5	1	S-1001-0007		CAP	COPPER
4	1	S-4765-9552		ROD ASSEMBLY	COPPER
3	1	S-4765-9551		SHIELD ASSEMBLY	COPPER
2	1	S-4765-9550		FLANGE	ALUMINUM
1	1	S-4765-9549	-001	CASTING, CYCLOALIPHATIC RESIN	EC-APG-15NA

PARTS LIST

GENERAL TOLERANCES (UNLESS OTHERWISE SPECIFIED)

X.	±0.125
.X	±0.094
.XX	±0.063
.XXX	±0.010
ANGLES	±0.25°
RADIUS	0.031

REMOVE BURRS AND BREAK SHARP EDGES

DIMENSIONS ARE IN INCHES (UNLESS OTHERWISE SPECIFIED)

DRAWN BY: A.SAVARD DATE: 2017/12/12

CHECK BY:

PROJECT MGR.:

**Electro Composites™**  
**solid HV bushings solution**

TITLE: SDC® BUSHING 46kV, 1400A  
 MODEL: 250-014-T-1012-00

FORMAT: A	CAGE CODE	DRAWING NO.: S-4765-9549	REVISION: B
SCALE: 1:10	GENERATED BY: SolidWorks 2021	SHEET: 1 of 1	