

NOTES:

- 1 CREEPAGE DISTANCE: 19.6" / 499mm
- 2 ARC DISTANCE: 9.3" / 235mm
- 3 NOMINAL VOLTAGE: 15kV
- 4 NOMINAL CURRENT: 1200A
- 5 VOLTAGE WITHSTAND, 60 sec.: 50kV
- 6 BIL: 110kV
- 7 ROUTINE TEST ACCORDING TO: IEEE C57.19.01
- 8 MAX. TORQUE APPLIED ON FLANGE BOLTS: 40 lbf · ft / 54.2 N · m
- 9 WEIGHT: 69 lb / 31.3 kg
- 10 SILVER PLATED, AS PER ASTM B700, TYPE 1, GRADE D, CLASS N, NO NICKEL LAYER, FROM 13 TO 20 MICROMETERS THICKNESS
- 11 MAXIMUM OPERATING TEMPERATURE: 130°C

REVISIONS					
ZONE	REV.	DESCRIPTION	DRAWN BY	DATE	APPR.
B1	A	LA RÉSINE CYCLOALIPHATIQUE EC-APG-02 EST RÉVISÉE EN EC-APG-15NA	M. FORGET	2019-08-26	Y.V.

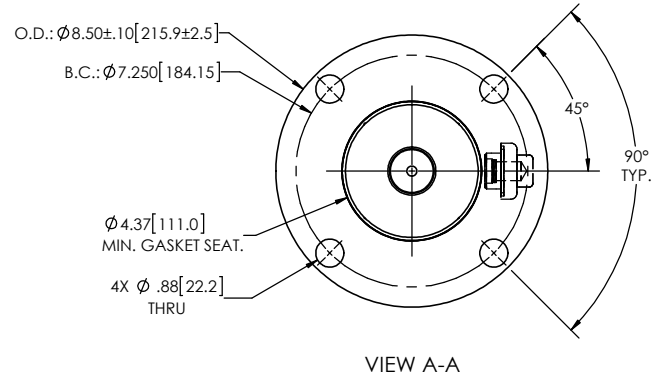
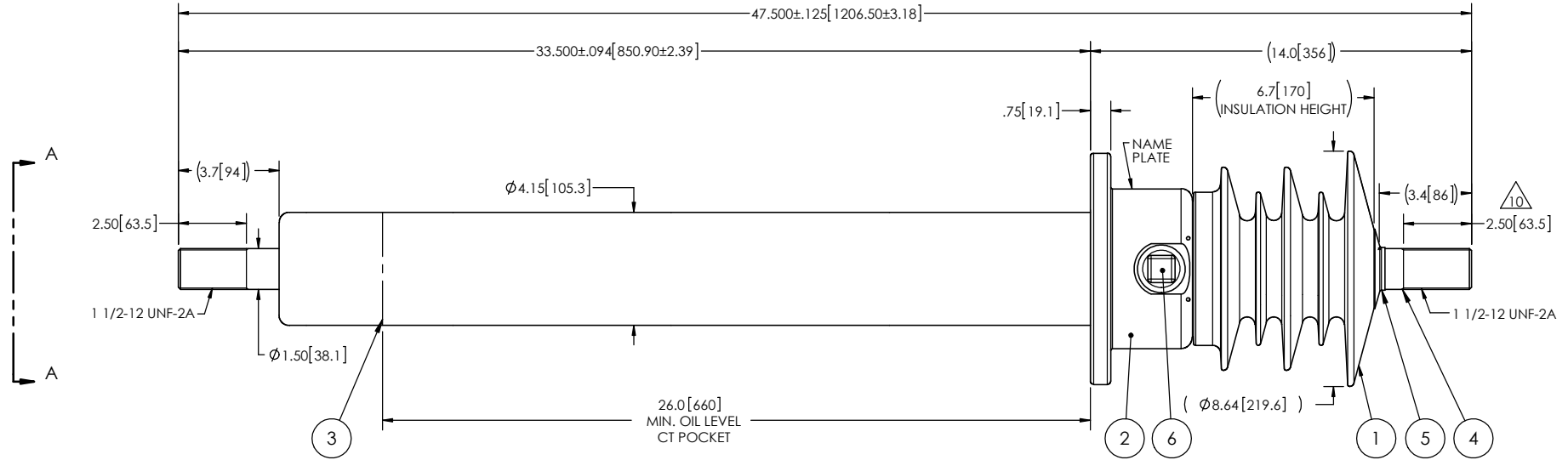

ITEM NO.	QTY	DRAWING NO.	PART NO.	DESCRIPTION	NOTE / MAT'L
6	1	S-1001-2022		CAPACITANCE TAP ASSEMBLY	ALUMINUM
5	1	S-1001-0007		CAP	COPPER
4	1	S-4585-10003		ROD ASSEMBLY	COPPER
3	1	S-4585-10002		SHIELD ASSEMBLY	COPPER
2	1	S-5408-5057		FLANGE	ALUMINUM
1	1	S-4585-10001	-001	CASTING, CYCLOALIPHATIC RESIN.	EC-APG-15NA

PARTS LIST							
GENERAL TOLERANCES (UNLESS OTHERWISE SPECIFIED)			<p>Electro Composites solid HV bushings solution</p> <p>TITLE: SDC® BUSHING 15kV, 1200A MODEL: 110-012-T-1049-00</p>				
X.	±0.125	DRAWN BY: A.SAVARD CHECK BY: PROJECT ENG.: PROJECT MANAGER:				DATE: 2019/08/08 SCALE: 1:6 GENERATED BY: SolidWorks 2013	SHEET: 1 of 1
.X	±0.094						
.XX	±0.063						
.XXX	±0.031						
ANGLES	±0.25°	REMOVE BURRS AND BREAK SHARP EDGES					
RADIUS	±0.031	DIMENSIONS ARE IN INCHES (UNLESS OTHERWISE SPECIFIED)					

This drawing is the proprietary property of Electro Composites (2008) ULC, not part of the public domain, and is issued with the express understanding and agreement that it is not to be reproduced or copied in whole or in part or issued for furnishing information to others, or used directly or indirectly, in any way detrimental to the interest of Electro Composites (2008) ULC and is to be returned upon request by Electro Composites (2008) ULC. All Rights Reserved.