

- NOTES:
- | | | |
|--|----------------------|-------------------|
| 1 CREEPAGE DISTANCE: | OUT: 47.1" / 1197mm | IN: 21.1" / 536mm |
| 2 ARC DISTANCE: | OUT: 19.0" / 482mm | IN: 13.3" / 339mm |
| 3 NOMINAL VOLTAGE: | 34.5kV | |
| 4 NOMINAL CURRENT: | 1250A | |
| 5 VOLTAGE WITHSTAND, 60 sec.: | 80kV | |
| 6 BIL : | 200kV | |
| 7 ROUTINE TEST ACCORDING TO: | IEEE C57.19.01 | |
| 8 MAX. TORQUE APPLIED ON FLANGE BOLTS: | 30 lbf·ft / 40.7 N·m | |
| 9 WEIGHT: | 63 lb / 28.6 kg | |

REVISIONS					
ZONE	REV.	DESCRIPTION	DRAWN BY	DATE	APPR.

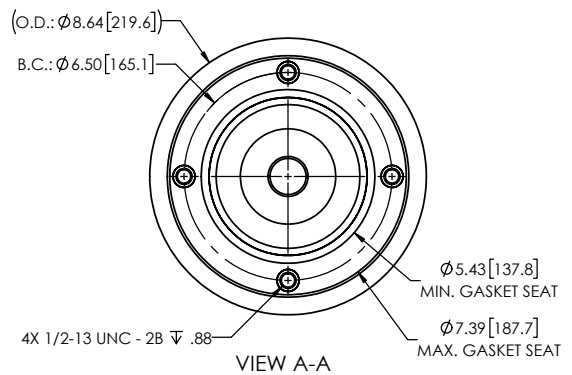
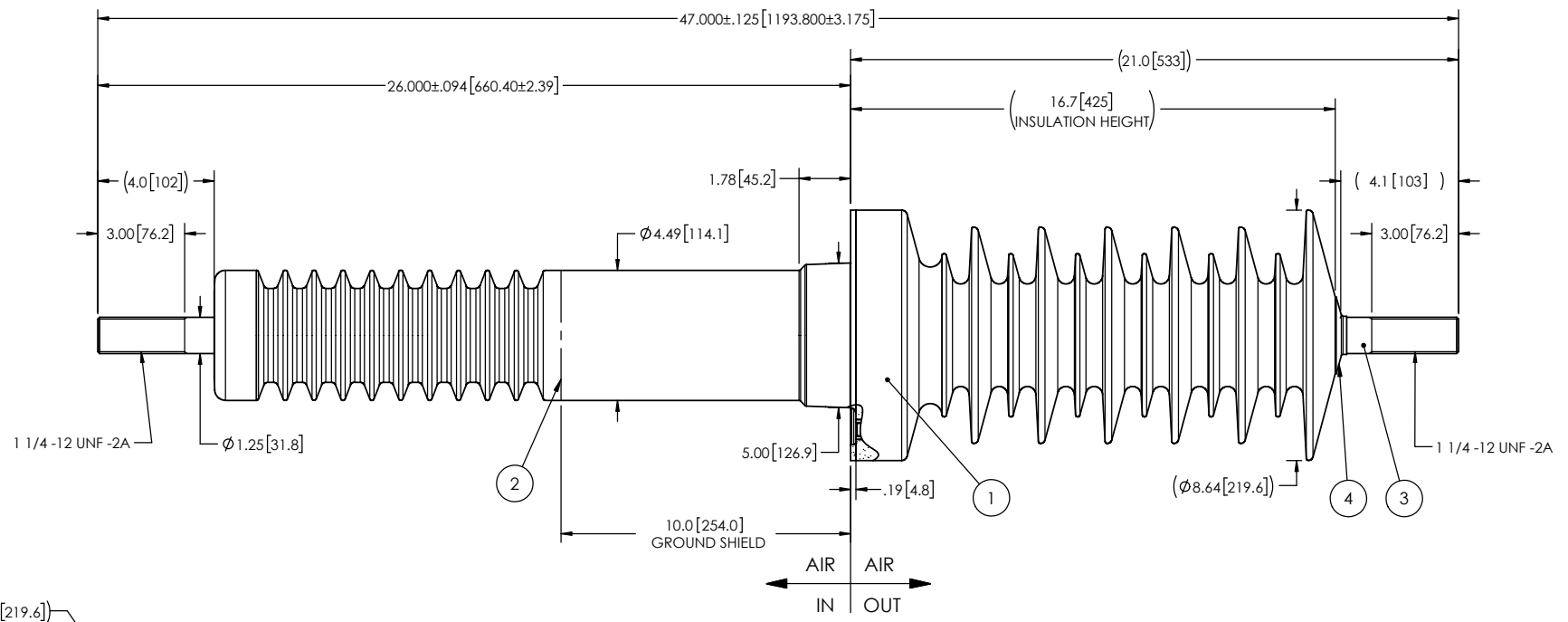

This drawing is the proprietary property of Electro Composites (2008) ULC, not part of the public domain, and is issued with the express understanding and agreement that it is not to be reproduced or copied in whole or in part or issued for furnishing information to others, or used directly or indirectly, in any way detrimental to the interest of Electro Composites (2008) ULC and is to be returned upon request by Electro Composites (2008) ULC. All Rights Reserved.

ITEM NO.	QTY	DRAWING NO.	PART NO.	DESCRIPTION	NOTE / MAT'L
4	1	S-1016-0008		CAP	COPPER
3	1	S-7676-10276		ROD ASSEMBLY	COPPER
2	1	S-7676-10275		SHIELD ASSEMBLY	COPPER
1	1	S-7676-10274	-001	CASTING, CYCLOALIPHATIC RESIN	EC-APG-02

PARTS LIST					
GENERAL TOLERANCES (UNLESS OTHERWISE SPECIFIED)		EQUIVALENT TO:		Electro Composites™ solid HV bushings solution	
X.	±0.125				
.X	±0.094			TITLE: SDC® BUSHING 34.5kV, 1250A 200-012-W-1081-00	
.XX	±0.063				
.XXX	±0.031				
ANGLES	±0.25°				
RADIUS	±0.031				
REMOVE BURRS AND BREAK SHARP EDGES		DRAWN BY: M. FORGET		DATE: 2021/05/13	
DIMENSIONS ARE IN INCHES (UNLESS OTHERWISE SPECIFIED)		CHECK BY:		FORMAT: A	
		PROJECT ENG.:		CAGE CODE: S-7676-10274	
		PROJECT MANAGER:		DRAWING NO.:	
				REVISION: NR	
				SCALE: 1:6	
				GENERATED BY: SolidWorks 2020	
				SHEET: 1 of 1	