

NOTES:

- 1 CREEPAGE DISTANCE: 20.1" / 511mm
- 2 ARC DISTANCE: 9.7" / 245mm
- 3 NOMINAL VOLTAGE: 15kV
- 4 NOMINAL CURRENT: 3000A
- 5 VOLTAGE WITHSTAND, 60 sec.: 50kV
- 6 BIL: 110kV
- 7 ROUTINE TEST ACCORDING TO: CSA C88.1-96
- 8 MAX. TORQUE APPLIED ON FLANGE BOLTS: 70 lbf·ft / 94.9 N·m
- 9 WEIGHT: 135 lb / 61.2 kg
- 10 SILVER PLATED, AS PER ASTM B700, TYPE 1, GRADE D, CLASS N, NO NICKEL LAYER, FROM 13 TO 20 MICROMETERS THICKNESS

REVISIONS					
ZONE	REV.	DESCRIPTION	DRAWN BY	DATE	APPR.

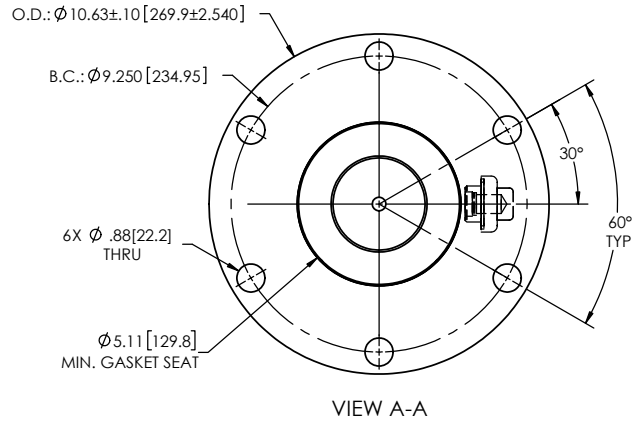
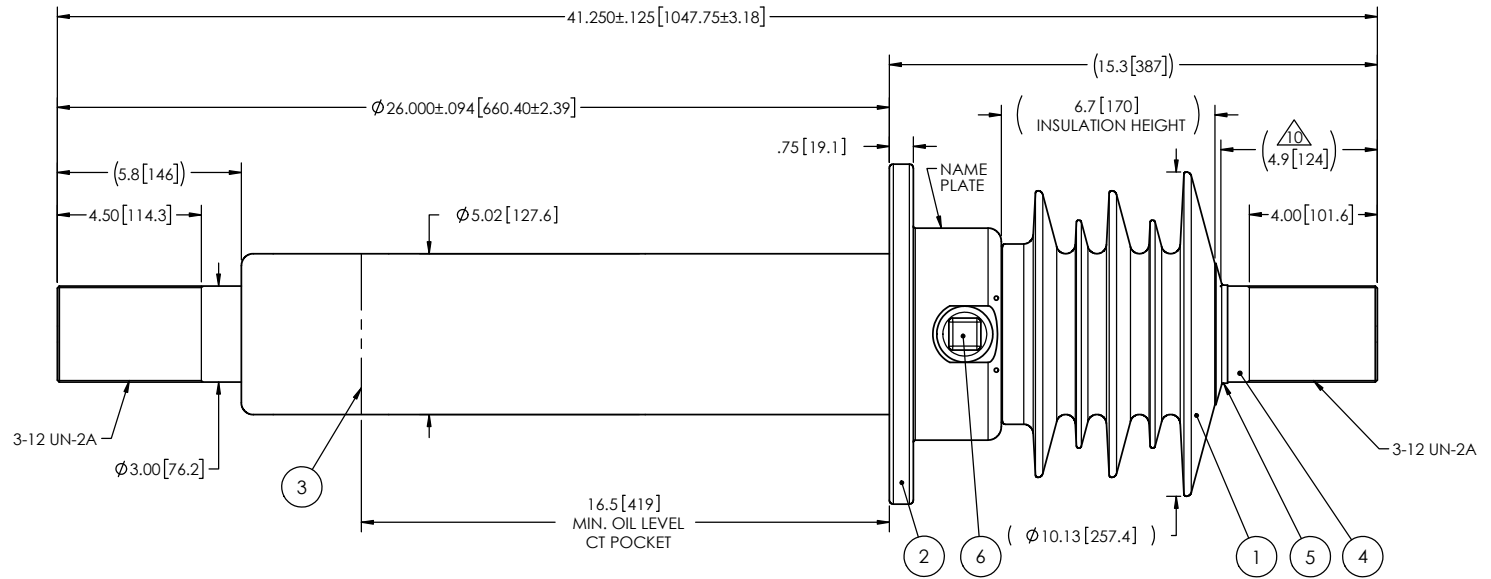

ITEM NO.	QTY	DRAWING NO.	PART NO.	DESCRIPTION	NOTE / MAT'L
6	1	S-1001-2022		CAPACITANCE TAP ASSEMBLY	ALUMINUM
5	1	S-3529-2532-0		CAP	COPPER
4	1	S-1796-10316		ROD ASSEMBLY	COPPER
3	1	S-6307-5915		SHIELD ASSEMBLY	COPPER
2	1	S-7434-7202		FLANGE	ALUMINUM
1	1	S-1796-10306	-001	CASTING, CYCLOALIPHATIC RESIN	EC-APG-02

PARTS LIST					
GENERAL TOLERANCES (UNLESS OTHERWISE SPECIFIED)			Electro Composites™ solid HV bushings solution		
X.	±0.125	TITLE: SDC® BUSHING 15kV, 3000A MODEL: 110-030-T-1087-00			
.X	±0.094		DRAWN BY: M. FORGET DATE: 2021/08/25		
.XX	±0.063	CHECK BY:			
.XXX	±0.031	PROJECT ENG.:			
ANGLES	±0.25°	PROJECT MGR.:			
RADIUS	±0.031	SCALE: 1:6			
REMOVE BURRS AND BREAK SHARP EDGES DIMENSIONS ARE IN INCHES (UNLESS OTHERWISE SPECIFIED)			GENERATED BY: SolidWorks 2020	REVISION: NR	SHEET: 1 of 1

This drawing is the proprietary property of Electro Composites (2008) ULC, not part of the public domain, and is issued with the express understanding and agreement that it is not to be reproduced or copied in whole or in part or issued for furnishing information to others, or used directly or indirectly, in any way detrimental to the interest of Electro Composites (2008) ULC and is to be returned upon request by Electro Composites (2008) ULC. All Rights Reserved.