

CONDUCTOR	INSTALLATION TOOLING (# CRIMPS)			
	HYDRAULIC			
Y750 Y35	4	3	WIRE STRIP LENGTH	
BAT35, BAT750 Y39	Y46	Y45		
2/0 WELD 325/24	U26RT (1)	U26RT (1)	U26RT (1)	7/8"

REV.	DATE	DESCRIPTION	BY	C'K'D.
0	6/9/99	DRAWING RELEASED (PER ECO 4988)	PL	KH

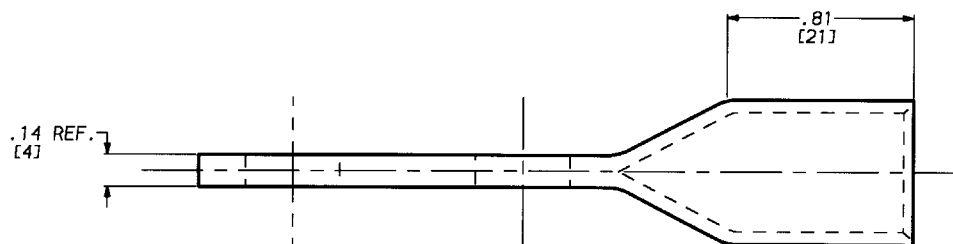
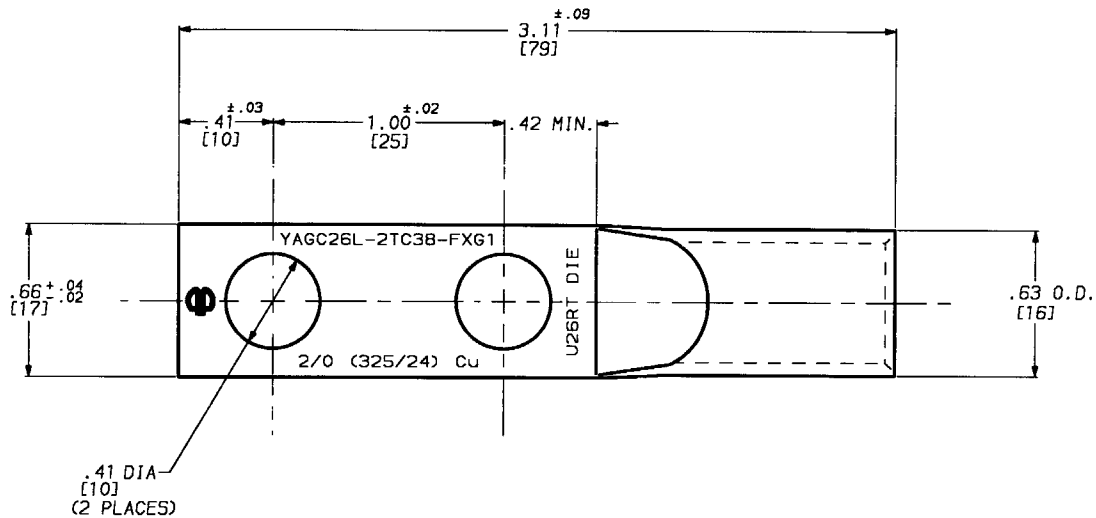

NOTES:

1. MATERIAL; COPPER TUBING.
2. FINISH; ELECTRO-TIN PLATED.
3. CATALOG # PT6515 ADAPTOR IS REQUIRED TO USE "U" DIES IN Y45 SERIES TOOLS.
4. CATALOG # PUADP-1 ADAPTOR IS REQUIRED TO USE "U" DIES IN Y46 SERIES TOOLS.
5. DIMENSIONS IN BRACKETS [] ARE IN MILLIMETERS ROUNDED OFF TO THE NEAREST MILLIMETER, UNLESS OTHERWISE NOTED, AND ARE FOR REFERENCE ONLY.

HYLUG™		SCALE
CAT NO: YAGC26L2TC38FXG1		NTS
DRAWN: B. MICHAUD	5/25/99	CHECKED: K HENRY
5/25/99		5/25/99
DSGN APPVL: B. MACDONALD	5/25/99	MFG APPVL: N/A
Q.A. APPVL: J. BRODEUR	6/11/99	MKTS APPVL: R. ROBICHEAU
5/25/99		5/25/99
CAD FILE: SE212201-01_0		PH REF: N/A
MOL REF: N/A		
PROJECT: 0T99174		
DRAWING NO.		REV
SE212201		0
SHEET 1 OF 1		

